



State of Ohio  
**Public Works Commission**  
*Application for Financial Assistance*

IMPORTANT: Please consult "Instructions for Financial Assistance for Capital Infrastructure Projects" for guidance in completion of this form.

**Applicant**

Applicant: Village of Walbridge Subdivision Code: 173-80486

District Number: 5 County: Wood Date: 08/28/2018

Contact: Edward Kolanko, Mayor Phone: (419) 666-1830  
(The individual who will be available during business hours and who can best answer or coordinate the response to questions)

Email: mayor@walbridgeohio.org FAX: (419) 661-8458

**Project**

Project Name: Elm Street Improvements Phase 2 Zip Code: 43465

Subdivision Type <small>(Select one)</small>	Project Type <small>(Select single largest component by \$)</small>	Funding Request Summary <small>(Automatically populates from page 2)</small>
<input type="checkbox"/> 1. County	<input checked="" type="checkbox"/> 1. Road	Total Project Cost: <u>128,121</u> .00
<input type="checkbox"/> 2. City	<input type="checkbox"/> 2. Bridge/Culvert	1. Grant: <u>47,405</u> .00
<input type="checkbox"/> 3. Township	<input type="checkbox"/> 3. Water Supply	2. Loan: <u>47,405</u> .00
<input checked="" type="checkbox"/> 4. Village	<input type="checkbox"/> 4. Wastewater	3. Loan Assistance/ Credit Enhancement: <u>0</u> .00
<input type="checkbox"/> 5. Water (6119 Water District)	<input type="checkbox"/> 5. Solid Waste	Funding Requested: <u>94,810</u> .00
	<input type="checkbox"/> 6. Stormwater	

**District Recommendation** (To be completed by the District Committee)

Funding Type Requested <small>(Select one)</small>		
<input type="checkbox"/> State Capital Improvement Program	SCIP Loan - Rate: _____ % Term: _____ Yrs	Amount: _____ .00
<input type="checkbox"/> Local Transportation Improvement Program	RLP Loan - Rate: _____ % Term: _____ Yrs	Amount: _____ .00
<input type="checkbox"/> Revolving Loan Program	Grant:	Amount: _____ .00
<input type="checkbox"/> Small Government Program	LTIP:	Amount: _____ .00
District SG Priority: _____	Loan Assistance / Credit Enhancement:	Amount: _____ .00

**For OPWC Use Only**

STATUS	Grant Amount: _____ .00	Loan Type: <input type="checkbox"/> SCIP <input type="checkbox"/> RLP
Project Number: _____	Loan Amount: _____ .00	Date Construction End: _____
	Total Funding: _____ .00	Date Maturity: _____
Release Date: _____	Local Participation: _____ %	Rate: _____ %
OPWC Approval: _____	OPWC Participation: _____ %	Term: _____ Yrs

1.0 Project Financial Information (All Costs Rounded to Nearest Dollar)

1.1 Project Estimated Costs

Engineering Services

Preliminary Design:	_____	1,185 .00	
Final Design:	_____	7,465 .00	
Construction Administration:	_____	8,195 .00	
Total Engineering Services:	a.) _____	16,845 .00	17 %
Right of Way:	b.) _____	.00	
Construction:	c.) _____	98,886 .00	
Materials Purchased Directly:	d.) _____	.00	
Permits, Advertising, Legal:	e.) _____	2,500 .00	
Construction Contingencies:	f.) _____	9,890 .00	10 %
Total Estimated Costs:	g.) _____	128,121 .00	

1.2 Project Financial Resources

Local Resources

Local In-Kind or Force Account:	a.) _____	.00	
Local Revenues:	b.) _____	33,311 .00	
Other Public Revenues:	c.) _____	.00	
ODOT / FHWA PID: _____	d.) _____	.00	
USDA Rural Development:	e.) _____	.00	
OEPA / OWDA:	f.) _____	.00	
CDBG:	g.) _____	.00	
<input type="checkbox"/> County Entitlement or Community Dev. "Formula"			
<input type="checkbox"/> Department of Development			
Other: _____	h.) _____	.00	
Subtotal Local Resources:	i.) _____	33,311 .00	26 %

OPWC Funds (Check all requested and enter Amount)

Grant: <u>50</u> % of OPWC Funds	j.) _____	47,405 .00	
Loan: <u>50</u> % of OPWC Funds	k.) _____	47,405 .00	
Loan Assistance / Credit Enhancement:	l.) _____	0 .00	
Subtotal OPWC Funds:	m.) _____	94,810 .00	74 %
Total Financial Resources:	n.) _____	128,121 .00	100 %

### 1.3 Availability of Local Funds

Attach a statement signed by the Chief Financial Officer listed in section 5.2 certifying all local resources required for the project will be available on or before the earliest date listed in the Project Schedule section. The OPWC Agreement will not be released until the local resources are certified. Failure to meet local share may result in termination of the project. Applicant needs to provide written confirmation for funds coming from other funding sources.

### 2.0 Repair / Replacement or New / Expansion

2.1 Total Portion of Project Repair / Replacement:	_____ 128,121 .00	_____ 100 %
2.2 Total Portion of Project New / Expansion:	_____ 0 .00	_____ 0 %
2.3 Total Project:	_____ 128,121 .00	_____ 100 %

A Farmland Preservation letter is required for any impact to farmland.

### 3.0 Project Schedule

3.1 Engineering / Design / Right of Way	Begin Date: <u>07/15/2019</u>	End Date: <u>12/15/2019</u>
3.2 Bid Advertisement and Award	Begin Date: <u>01/01/2020</u>	End Date: <u>03/01/2020</u>
3.3 Construction	Begin Date: <u>03/01/2020</u>	End Date: <u>07/01/2020</u>

Construction cannot begin prior to release of executed Project Agreement and issuance of Notice to Proceed.

Failure to meet project schedule may result in termination of agreement for approved projects. Modification of dates must be requested in writing by project official of record and approved by the Commission once the Project Agreement has been executed.

### 4.0 Project Information

If the project is multi-jurisdictional, information must be consolidated in this section.

#### 4.1 Useful Life / Cost Estimate / Age of Infrastructure

Project Useful Life: 15 Years      Age: 1969 (Year built or year of last major improvement)

*Attach Registered Professional Engineer's statement, with seal or stamp and signature confirming the project's useful life indicated above and detailed cost estimate.*

#### 4.2 User Information

Road or Bridge:      Current ADT 492      Year 2018      Projected ADT \_\_\_\_\_      Year \_\_\_\_\_

Water / Wastewater: Based on monthly usage of 4,500 gallons per household; attach current ordinances.

Residential Water Rate      Current \$ \_\_\_\_\_      Proposed \$ \_\_\_\_\_

Number of households served: \_\_\_\_\_

Residential Wastewater Rate      Current \$ \_\_\_\_\_      Proposed \$ \_\_\_\_\_

Number of households served: \_\_\_\_\_

Stormwater: Number of households served: \_\_\_\_\_

## 4.3 Project Description

- A: **SPECIFIC LOCATION** (Supply a written location description that includes the project termini; a map does not replace this requirement.) 500 character limit.

The Village of Walbridge is requesting OPWC funding for the improvement of Elm Street from North Main Street to Dixon Street, a distance of approximately 1,285 feet.

- B: **PROJECT COMPONENTS** (Describe the specific work to be completed; the engineer's estimate does not replace this requirement) 1,000 character limit.

The improvements include surface planing the existing pavement to an approximate depth of 1 1/2 inches, spot full depth pavement replacement as needed, asphalt resurfacing, and placement of stabilized crushed aggregate berm.

- C: **PHYSICAL DIMENSIONS** (Describe the physical dimensions of the existing facility and the proposed facility. Include length, width, quantity and sizes, mgd capacity, etc in detail.) 500 character limit.

370 SY Full Depth Asphalt Pavement Repair - as directed by Owner or Engineer  
3695 SY Pavement Planing - Variable Depth  
222 GAL Non-Tracking Tack Coat on Planed Asphalt - 0.06 GAL/SY  
154 CY Asphalt Concrete Surface Course, Type 1, PG 64-22 (1 1/2" compacted thickness)  
103 CY Asphalt Concrete Intermediate/Scratch Course, Type 1, PG 64-22 (1" avg compacted thickness)  
48 CY Stabilized/Compacted Crushed Aggregate Berm



## 5.0 Project Officials

Changes in Project Officials must be submitted in writing from an officer of record.

### 5.1 Chief Executive Officer (Person authorized in legislation to sign project agreements)

Name: Edward Kolanko  
Title: Mayor  
Address: 705 North Main Street  
  
City: Walbridge State: OH Zip: 43465  
Phone: (419) 666-1830  
FAX: (419) 661-8458  
E-Mail: mayor@walbridgeohio.org

### 5.2 Chief Financial Officer (Can not also serve as CEO)

Name: Patricia Crawford  
Title: Fiscal Officer/Tax Commissioner  
Address: 705 North Main Street  
  
City: Walbridge State: OH Zip: 43465  
Phone: (419) 666-1830  
FAX: (419) 661-8458  
E-Mail: taxcommissioner@walbridgeohio.org

### 5.3 Project Manager

Name: J. James Bishop  
Title: Village Administrator  
Address: 705 North Main Street  
  
City: Walbridge State: OH Zip: 43465  
Phone: (419) 666-1830  
FAX: (419) 661-8458  
E-Mail: villageadministrator@walbridgeohio.org

## 6.0 Attachments / Completeness review

Confirm in the boxes below that each item listed is attached (Check each box)

- A certified copy of the legislation by the governing body of the applicant authorizing a designated official to sign and submit this application and execute contracts. This individual should sign under 7.0, Applicant Certification, below.
- A certification signed by the applicant's chief financial officer stating the amount of all local share funds required for the project will be available on or before the dates listed in the Project Schedule section. If the application involves a request for loan (RLP or SCIP), a certification signed by the CFO which identifies a specific revenue source for repaying the loan also must be attached. Both certifications can be accomplished in the same letter.
- A registered professional engineer's detailed cost estimate and useful life statement, as required in 164-1-13, 164-1-14, and 164-1-16 of the Ohio Administrative Code. Estimates shall contain an engineer's seal or stamp and signature.
- A cooperative agreement (if the project involves more than one subdivision or district) which identifies the fiscal and administrative responsibilities of each participant.
- Farmland Preservation Review - The Governor's Executive Order 98-IV, "Ohio Farmland Protection Policy" requires the Commission to establish guidelines on how it will take protection of productive agricultural and grazing land into account in its funding decision making process. Please include a Farm Land Preservation statement for projects that have an impact on farmland.
- Capital Improvements Report. CIR Required by O.R.C. Chapter 164.06 on standard form.
- Supporting Documentation: Materials such as additional project description, photographs, economic impact (temporary and/or full time jobs likely to be created as a result of the project), accident reports, impact on school zones, and other information to assist your district committee in ranking your project. Be sure to include supplements which may be required by your local District Public Works Integrating Committee.

## 7.0 Applicant Certification

The undersigned certifies: (1) he/she is legally authorized to request and accept financial assistance from the Ohio Public Works Commission as identified in the attached legislation; (2) to the best of his/her knowledge and belief, all representations that are part of this application are true and correct; (3) all official documents and commitments of the applicant that are part of this application have been duly authorized by the governing body of the applicant; and, (4) should the requested financial assistance be provided, that in the execution of this project, the applicant will comply with all assurances required by Ohio Law, including those involving Buy Ohio and prevailing wages.

**Applicant certifies that physical construction on the project as defined in the application has NOT begun, and will not begin until a Project Agreement for this project has been executed with the Ohio Public Works Commission. Action to the contrary will result in termination of the agreement and withdrawal of Ohio Public Works Commission funding from the project.**

Edward Kolanko, Mayor

Certifying Representative (Printed form, Type or Print Name and Title)

 9/4/2018

Original Signature / Date Signed

**RESOLUTION AUTHORIZING THE MAYOR OF THE VILLAGE OF WALBRIDGE TO PREPARE AND SUBMIT AN APPLICATION TO PARTICIPATE IN THE OHIO PUBLIC WORKS COMMISSION STATE CAPITAL IMPROVEMENT AND/OR LOCAL TRANSPORTATION IMPROVEMENT PROGRAMS AND TO EXECUTE CONTRACTS AS REQUIRED AND DECLARING AN EMERGENCY.**

**Elm Street Phase Two.**

**WHEREAS**, the State Capital Improvement Program and the Local Transportation Improvement Program both provide financial assistance to political subdivisions for capital improvements to public infrastructure, and

**WHEREAS**, The Village of Walbridge is planning to make capital improvements for resurfacing project, Elm Street- phase two.

**WHEREAS**, the infrastructure improvement herein above described is considered to be a priority need for the community and is a qualified project under the OPWC programs;

**NOW, THEREFORE, BE IT ORDAINED BY THE COUNCIL OF THE VILLAGE OF WALBRIDGE, WOOD COUNTY, OHIO:**

**SECTION 1.** That the Mayor of the Village of Walbridge is authorized to apply to the OPWC for funds as described above. The Mayor is further authorized to enter any agreements as may be necessary and appropriate for obtaining this financial assistance.

**SECTION 2.** It is found and determined that all formal actions of Council concerning or relating to the passage of this Resolution were adopted in an open meeting of the Council, and that all deliberations of this Council and any of its committees, that resulted in such formal actions, were in meetings open to the public in compliance with all legal requirements of the Village of Walbridge and the State of Ohio.

**SECTION 3.** That this Resolution constitutes an emergency measure because timely application for OPWC funds to make capital improvements is necessary for the immediate preservation of the public peace, safety, and welfare of our citizens. This ordinance shall be in full force and effect immediately after its passage.

Vote to suspend rules: For: 5 Against: 0

Vote on emergency clause: For: 5 Against: 0

Vote on final adoption: For: 5 Against: 0

**ADOPTED** 8/15/18 As an emergency measure.

ATTEST:

  
Clerk of Council

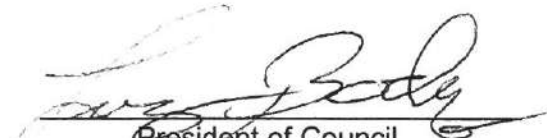
  
President of Council

APPROVED AS TO FORM:  
  
Village Attorney

APPROVED:  
  
Mayor





## Village of Walbridge, Ohio, County of Wood

*"Remembering the Past, on Track for the Future"*

705 N. Main Street, Walbridge, Ohio 43465

Telephone: (419) 666-1830 Fax: (419) 661-8458

www.walbridgeohio.org

**Mavor**

Edward A. Kolanko

**Police Chief**

Kenneth Campbell

**Fiscal Officer**

Patty Crawford

**Village Administrator**

J. James Bishop

**Council**

Sue Hart-Douglas

Ryan Weaver

Sarah Valasek

Larry Boday

Joe Weissenberger

September 4, 2018

State of Ohio  
Public Works Commission

Re: Village of Walbridge Funding Request  
Project: Elm Street Improvements, Phase 2

Dear OPWC:

I, Patricia Crawford, Fiscal Officer of the Village of Walbridge, hereby certify that the Village of Walbridge has the amount of \$47,405.00 in the General Fund and that this amount will be used to pay the local for the Elm Street Improvements, Phase 2 when it is required.

In addition, I hereby certify that the Village of Walbridge will have and/or collect the amount of \$47,405.00 in the General Fund and that this amount will be used to repay the Ohio Public Works Commission SCIP or RLP loan requested for this project over the stated term .

If you have questions or if you require additional information, please do not hesitate to contact me at any time. Thank you for your funding consideration.

Sincerely,

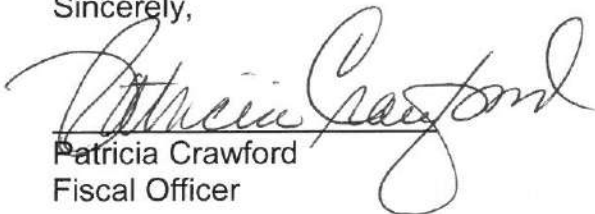
  
Patricia Crawford  
Fiscal Officer



Preliminary Opinion of Probable Project Cost  
 Elm Street Improvements Phase 2 - Main St to Dixon St Resurface  
 Walbridge, Ohio  
 August 26, 2018

Poggemeyer Design Group, Inc.  
 Proposal No. : 195000-00032  
 2020 Construction  
 Approximate Project Length=1285'

Ref. No.	Description	Probable Quantity	Unit	Unit Price	Total Price
1	624 Mobilization	1	L.S.	\$9,500.00 *	\$9,500.00
2	Spec. Bond	1	L.S.	\$2,370.00	\$2,370.00
3	832 Erosion Control	1	L.S.	\$700.00	\$700.00
4	204 Proofroll	1	HR.	\$95.00	\$95.00
5	253 Full Depth Asphalt Pavement Repair - as directed by Owner or Engineer	370	S.Y.	\$55.00	\$20,350.00
6	254 Pavement Planing - Variable Depth	3,695	S.Y.	\$4.00	\$14,780.00
7	407 Non-Tracking Tack Coat on Planed Asphalt - 0.06 GAL/SY	222	GAL.	\$3.00	\$666.00
8	448 Asphalt Concrete Surface Course, Type 1, PG64-22 (1 1/2" compacted thickness)	154	C.Y.	\$185.00	\$28,490.00
9	448 Asphalt Concrete Intermediate/Scratch Course, Type 1, PG64-22 (1" avg compacted thickness)	103	C.Y.	\$185.00	\$19,055.00
10	411 Stabilized/Compacted Crushed Aggregate Berm	48	C.Y.	\$60.00	\$2,880.00
11	Subtotal Probable Construction				<u>\$98,886.00</u>
12	Contingency @ 10%				<u>\$9,890.00</u>
13	Total Probable Construction Cost				<u>\$108,776.00</u>
	Technical Services:				
14	Preliminary Engineering/Topographic Survey				\$1,185.00
15	Final Engineering				\$6,030.00
16	Bidding				\$1,435.00
17	Construction Eng./Adm.				\$1,235.00
18	Construction Observation - Part Time				\$3,460.00
19	Subtotal Technical Services				<u>\$13,345.00</u>
	Other Costs:				
20	Advertising, Legal, etc.				\$2,500.00
21	Construction Testing - Proofroll, Asphalt Compaction, Concrete				\$3,500.00
22	Subtotal Other				<u>\$6,000.00</u>
23	Total Preliminary Probable Project Costs				<u>\$128,121.00</u>

The estimated useful life of the Elm Street Improvements Phase 2 project is 15.0 years

Jack A. Jones, P.E., E-41523



Note: This estimate does not include interest during construction, finance fees, bond counsel, assessment fees, bond insurance, or other miscellaneous expenses which can add up to 5% to 10% of the total cost once actual financing sources are finalized.

**Poggemeyer Design Group**

1168 North Main Street  
Bowling Green, Ohio 43402  
419-352-7537

Elm Street near N. Main Street  
Walbridge, Ohio  
Station ID:  
Site Code: 4  
Date Start: 21-Aug-18  
Date End: 22-Aug-18

Start Time	21-Aug-18 Tue	E to W		Hour Totals		W to E		Hour Totals		Combined Totals			
		Morning	Afternoon	Morning	Afternoon	Morning	Afternoon	Morning	Afternoon	Morning	Afternoon		
12:00		*	1			*	4						
12:15		*	5			*	5						
12:30		*	5			*	4						
12:45		*	5		0 16	*	5		0 18	0	34		
01:00		*	2			*	6						
01:15		*	2			*	4						
01:30		*	3			*	5						
01:45		*	4		0 11	*	3		0 18	0	29		
02:00		*	3			*	5						
02:15		*	5			*	2						
02:30		*	5			*	2						
02:45		*	1		0 14	*	3		0 12	0	26		
03:00		*	3			*	3						
03:15		*	3			*	6						
03:30		*	5			*	6						
03:45		*	0		0 11	*	7		0 22	0	33		
04:00		*	7			*	8						
04:15		*	2			*	5						
04:30		*	2			*	7						
04:45		*	5		0 16	*	7		0 27	0	43		
05:00		*	3			*	8						
05:15		*	8			*	5						
05:30		*	6			*	8						
05:45		*	5		0 22	*	2		0 23	0	45		
06:00		*	9			*	8						
06:15		*	8			*	4						
06:30		*	4			*	4						
06:45		*	2		0 23	*	3		0 19	0	42		
07:00		*	2			*	2						
07:15		*	2			*	7						
07:30		*	2			*	4						
07:45		*	1		0 7	*	2		0 15	0	22		
08:00		*	0			*	6						
08:15		*	0			*	3						
08:30		*	0			*	5						
08:45		*	2		0 2	*	4		0 18	0	20		
09:00		*	3			*	4						
09:15		*	1			*	3						
09:30		*	1			*	1						
09:45		*	1		0 6	*	1		0 9	0	15		
10:00		*	2			*	2						
10:15		*	0			*	0						
10:30		*	2			*	3						
10:45		7	2		7 6	2	1		2 6	9	12		
11:00		3	2			4	0						
11:15		6	1			1	2						
11:30		3	1			3	0						
11:45		1	1			5	2						
<b>Total</b>		<b>20</b>	<b>139</b>		<b>13</b>	<b>5</b>	<b>15</b>	<b>191</b>		<b>13</b>	<b>4</b>	<b>26</b>	<b>9</b>
<b>Percent</b>		<b>12.6%</b>	<b>87.4%</b>				<b>7.3%</b>	<b>92.7%</b>		<b>9.6%</b>		<b>330</b>	<b>90.4%</b>

**Poggemeyer Design Group**  
 1168 North Main Street  
 Bowling Green, Ohio 43402  
 419-352-7537

Elm Street near N. Main Street  
 Walbridge, Ohio  
 Station ID:  
 Site Code: 4  
 Date Start: 21-Aug-18  
 Date End: 22-Aug-18

Start Time	22-Aug-18 Wed	E to W		Hour Totals		W to E		Hour Totals		Combined Totals	
		Morning	Afternoon	Morning	Afternoon	Morning	Afternoon	Morning	Afternoon	Morning	Afternoon
12:00		1	*			0	*				
12:15		1	*			1	*				
12:30		0	*			0	*				
12:45		0	*	2	0	0	*	1	0	3	0
01:00		0	*			0	*				
01:15		0	*			0	*				
01:30		0	*			0	*				
01:45		0	*	0	0	0	*	0	0	0	0
02:00		0	*			1	*				
02:15		0	*			2	*				
02:30		0	*			0	*				
02:45		0	*	0	0	0	*	3	0	3	0
03:00		0	*			0	*				
03:15		0	*			0	*				
03:30		0	*			1	*				
03:45		0	*	0	0	0	*	1	0	1	0
04:00		0	*			0	*				
04:15		1	*			0	*				
04:30		0	*			0	*				
04:45		0	*	1	0	0	*	0	0	1	0
05:00		1	*			0	*				
05:15		0	*			0	*				
05:30		1	*			1	*				
05:45		2	*	4	0	1	*	2	0	6	0
06:00		2	*			0	*				
06:15		8	*			0	*				
06:30		3	*			0	*				
06:45		1	*	14	0	3	*	5	0	19	0
07:00		1	*			1	*				
07:15		6	*			0	*				
07:30		8	*			2	*				
07:45		1	*	16	0	5	*	8	0	24	0
08:00		6	*			2	*				
08:15		2	*			1	*				
08:30		7	*			1	*				
08:45		2	*	17	0	4	*	8	0	25	0
09:00		4	*			5	*				
09:15		5	*			1	*				
09:30		5	*			3	*				
09:45		7	*	21	0	2	*	11	0	32	0
10:00		2	*			1	*				
10:15		*	*			*	*				
10:30		*	*			*	*				
10:45		*	*			*	*				
11:00		*	*			*	*				
11:15		*	*			*	*				
11:30		*	*			*	*				
11:45		*	*			*	*				
Total		77	0			40	0			114	0
Percent		100.0%	0.0%			100.0%	0.0%			100.0%	0.0%
Grand Total		97	139			55	191			149	330
Percent		41.1%	58.9%			22.4%	77.6%			31.1%	68.9%

ADT

ADT 492

AADT 492









VILLAGE OF WALBRIDGE

WOOD COUNTY, OHIO

EXISTING STORM SEWER SYSTEM

1978

Project Location

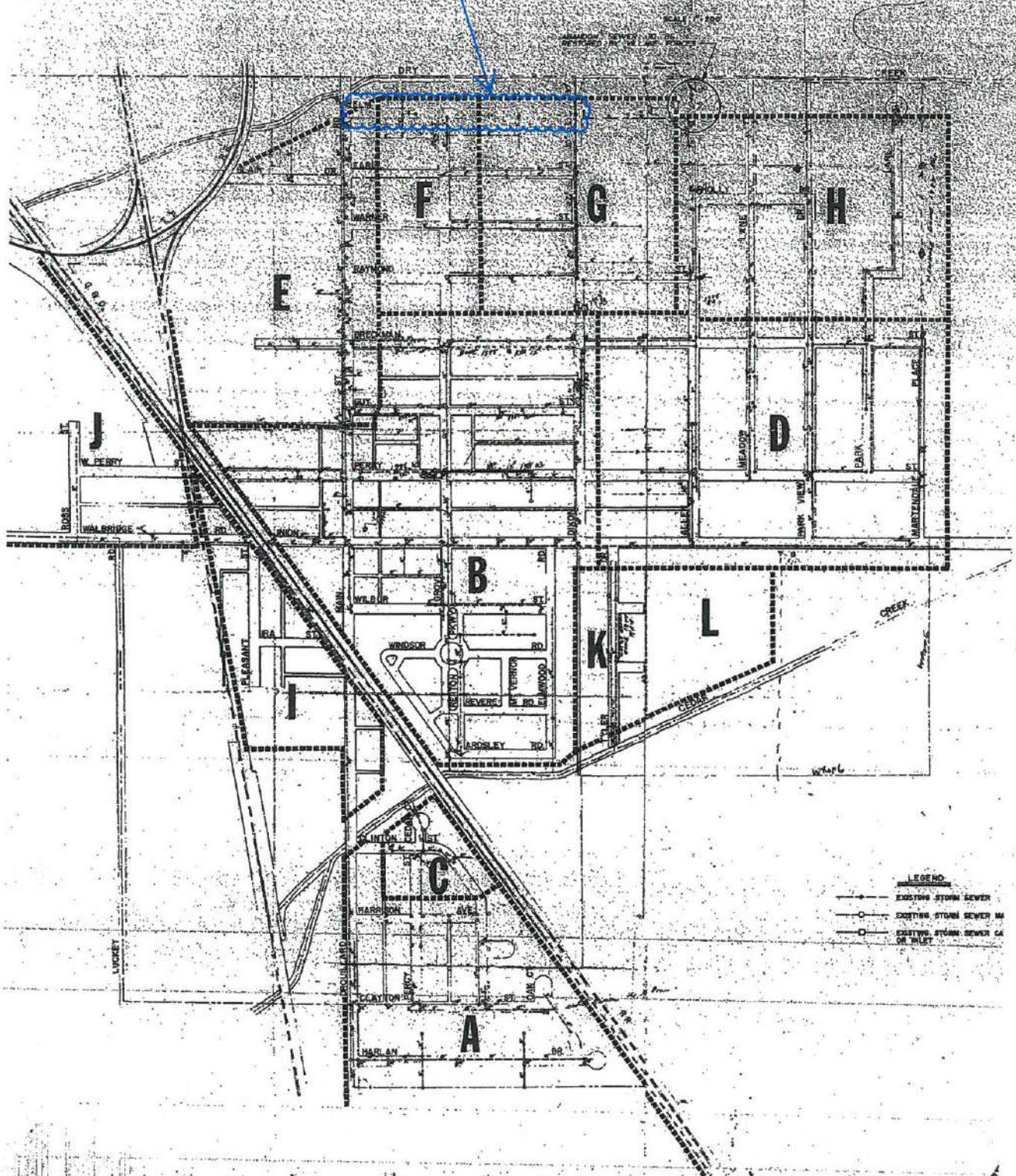



**VILLAGE OF WALBRIDGE  
ELM STREET IMPROVEMENTS PHASE 2  
PROJECT NARRATIVE**

---

The Village of Walbridge is requesting OPWC funding for the improvement of Elm Street from North Main Street to Dixon Street, a distance of approximately 1,285 feet.

The improvements include surface planing the existing pavement to an approximate depth of 1½ inches, spot full depth pavement replacement as needed, asphalt resurfacing, and placement of stabilized crushed aggregate berm.

Elm Street is a loop street located within a fully developed residential subdivision and is used to some extent by local residents to "bypass" the downtown area for travel to/from North Main Street and East Union Street. The Average Daily Traffic for Elm Street is 492 vehicles per day based on a recent traffic count completed in August 2018.

This section of Elm Street provides primary access to 32 single family homes and secondary access for more than 25 single family homes along Elm St north of Dixon Street and along parts of Allen Street, Dixon Street, and Grove Street.

The project will replace aged asphalt which is believed to be more than 50 years old based a 1969 zoning map of the Village which is included herewith for reference.

Recent photos for Elm Street from North Main Street to Dixon Street have also been included for reference showing pavement deterioration and rutting.

The total probable cost for this project is \$128,121. At this time the Village is unable to finance a project of this magnitude without some financial assistance. As an indication of their desire to proceed with the project, the Village is prepared to commit to 26% (\$33,311) of the project funding utilizing local funds on hand and is hoping for an OPWC grant/loan combination (\$47,405 and \$47,405 respectively) for the remaining 74% of the project.



District 5  
 Capital Improvement Project  
 Priority Rating Sheet, Round 33

Revised 04/17/18

COUNTY: Wood		PROJECT NUMBER														
PROJECT: Elm Street Improvements Phase 2																
EST. COST: \$128,121																
No.	"A" WEIGHT FACTOR	CRITERIA TO BE CONSIDERED	"B" PRIORITY FACTORS					"A"x"B"	Priority Factors						No.	
			0	2	4	6	8		10	0	2	4	6	8		10
1	1	(Repair or Replace) vs. (New or Expansion)	0	2	4	6	8	10	10	0% + Repair or Replacement	20% + Repair or Replacement	40% + Repair or Replacement	60% Repair or Replacement	80% + Repair or Replacement	100% + Repair or Replacement	1
2	1.5	Existing Physical Condition;  Must submit substantiating documentation and CIR (100% New or Expansion = 0 Points)	0	2	4	6	8	10	9	Excellent	Good	Fair	Poor	Critical	Closed or Not Operating	2
3	2	Public Health and/or Public Safety Concerns  Submittals without supporting documentation will receive 0 points for this question	0	2	4	6	8	10	12	No Impact	Minimal	Moderate	Major	Critical	Extremely Critical	3
4	2	Percentage of Local Share (Local funds are funds derived from the applicant budget or a loan to be paid back through the applicant budget assessments, rates or tax revenues)*	0	2	4	6	8	10	20	0%+	10%+	20%+	30%+	40%+	50%+	4
5	1	OTHER FUNDING SOURCES  (Excluding Issue II Funds)  (Grants and other revenues not contributed or collected through taxes by the applicant, including Gifts, Contributions, etc. - must submit copy of award or status letter)	0	2	4	6	8	10		0%+	10%+	20%+	30%+	40%+	50%+	5
No.	"A" WEIGHT FACTOR	CRITERIA TO BE CONSIDERED	"B" PRIORITY FACTORS					"A"x"B"	Priority Factors						No.	
			0	2	4	6	8		10							
										-9	-8	0	8	9	10	
										Grant or Loan Only						
6	2	OPWC Grant and Loan Funding Requested; Please refer to Item 6 on Questionnaire for Clarification	-9	-8	0	8	9	10		\$500,001 or more	\$400,001 to \$500,000	\$325,001 to \$400,000	\$275,001 to \$325,000	\$175,001 to \$275,000	\$175,000 or less	6
	2									Grant/Loan Combination						
			-9	-8	0	8	9	10	20	\$750,000 or more	\$600,001 to \$750,000	\$487,501 to \$600,000	\$412,501 to \$487,500	\$262,501 to \$412,500	\$262,500 or less	
When scoring a project that is only grant or only loan. Please use the chart labeled "Grant or Loan Only". When scoring a grant/loan combination, score the project for the grant in the first chart, then use the second chart labeled "Grant/Loan Combination" to score the total (grant and loan combined). Use the lower of the two as the score.																
No.	"A" WEIGHT FACTOR	CRITERIA TO BE CONSIDERED	"B" PRIORITY FACTORS					"A"x"B"	Priority Factors						No.	
			0	2	4	6	8		10	0	2	4	6	8		10
7	1	Will the Proposed Project Create Permanent jobs or retain jobs that would otherwise be permanently lost (Written Documentation Required)	0	2	4	6	8	10		0+ jobs	7+ jobs	15+ jobs	25+ jobs	50+ jobs	100+ jobs	8
8	1	Benefits to Existing User such as households, (Equivalent dwelling units), traffic Counts, etc.	0	2	4	6	8	10	4	0+	100+	350+	500+	750+	1000+	9
9		SUBTOTAL RANKING POINTS (MAX. = 115)						75	Other Info: Does this project have a significant impact on productive farmland? YES NO X Attach impact statement if yes. Is the Applicant ready to proceed to bids after State Approval within 6 months? YES X NO							
10		COUNTY PRIORITY POINTS (25-20 -15)														
11		DISCRETIONARY POINTS (BY DISTRICT ONLY) (MAX=12)														
12		GRAND TOTAL RANKING POINTS														

\* Applicants must certify local share contribution. Specify, all funding sources to be utilized as local share at the time of application submittal.

Revised: April 17, 2018

**DISTRICT 5  
CAPITAL IMPROVEMENT PROJECTS  
QUESTIONNAIRE  
ROUND 33**

Name of Applicant: Village of Walbridge  
Project Title: Elm Street Improvements Phase 2

The following questions are to be answered for each application submitted for State Issue II SCIP, LTIP and Loan Projects. Please provide specific information using the best documentation available to you. Justification of your responses to these questions will be required if your project is selected for funding, so please provide correct and accurate responses. **Communities and Townships under 5,000 in population should also complete Small Government Criteria.**

1. What percentage of the project in repair A= 100 %, replacement B= \_\_\_%, expansion C= \_\_\_%, and new D= \_\_\_%? (Use dollar amounts of project to figure percentages and make sure the total equals one hundred (100) percent) A+B= 100 % C+D= \_\_\_%

Repair/Replacement = Repair or Replacement of public facilities owned by the government (any subdivision of the state).

New/Expansion = Replacement of privately owned wells, septic systems, private water or wastewater systems, etc.

2. **Give the physical condition rating :** Poor

Closed or Not Operating: The condition is unusable, dangerous and unsafe. The primary components have failed. The infrastructure is not functioning at all.

Critical: The condition is causing or contributing to a serious non-compliance situation and is threatening the intended design level of service. The infrastructure is functioning at seriously diminished capacity. Imminent failure is anticipated within 18 months. Repair and/or replacement is required to eliminate the critical condition and meet current design standards. **(For Road Projects structural repair items would represent a minimum of 25% of the total Project Cost).**

Poor: The condition is substandard and requires repair/replacement in order to return to the intended level of service and comply with current design standards. Infrastructure contains a major deficiency and is functioning at a diminished capacity.

Fair: The condition is average, not good or poor. The infrastructure is still functioning as originally intended. Minor deficiencies exist requiring repair to continue to function as originally intended and/or to meet current design standards.

Good: The condition is safe and suitable to purpose. Infrastructure is functioning as originally intended, but requires minor repairs and/or upgrades to meet current design standards.



Excellent: The condition is new, or requires no repair. Or, no supporting documentation has been submitted.

- **In order to receive points provide supporting documentation (e.g. photos, a narrative, maintenance history, or third party findings) to justify the rating.**

3. If the proposed project is not approved what category would best represent the impact on the general health and/or public safety?

## ROADS

Extremely Critical:	Resurfacing, Restoration, Rehabilitation and Reconstruction (4R) of a Major Access Road.*
Critical:	Resurfacing, Restoration and Rehabilitation (3R) of a Major Access Road.*
Major:	Resurfacing, Restoration, Rehabilitation and Reconstruction (4R) of a Minor Access Road.*
Moderate:	Resurfacing, Restoration and Rehabilitation (3R) of a Minor Access Road.*
Minimal:	Preventative Maintenance of a Major Access Road.
No Impact:	Preventative Maintenance of a Minor Access Road.

**Projects that have a variety of work will be scored in the LOWEST category of work contained in the Construction Estimate.**

### *Road/Street Classifications:*

*Major Access Road:* Roads or streets that have a dual function of providing access to adjacent properties and providing through or connecting service between other roads.

*Minor Access Road:* Roads or streets that primarily provide access to adjacent properties without through continuity, such as cul-de-sacs or loop roads or streets.

*Preventative Maintenance:* Non Structural Pavement work such as chip sealing, cape sealing, microsurfacing, crack sealing, etc.

\*(3R) Resurfacing, Restoration and Rehabilitation - Improvements to existing roadways, which have as their main purpose, the restoration of the physical features (pavement, curb, guardrail, etc.) without altering the original design elements.

\*(4R) Resurfacing, Restoration, Rehabilitation and Reconstruction - Much like 3R, except that 4R allows for the complete reconstruction of the roadway and alteration of certain design elements (i.e., lane widths, shoulder width, SSD, etc.).



## BRIDGES SUFFICIENCY RATING

Extremely Critical:	0-25, or a General Appraisal rating of 3 or less.
Critical:	27-50, or a General Appraisal rating of 4.
Major:	51-65 or a General Appraisal rating of 5 or 6.
Moderate:	66-80 or a General Appraisal rating of 7.
Minimal:	81-100 or a General Appraisal rating of more than 7.
No Impact:	Bridge on a new roadway.

## WASTEWATER TREATMENT PLANTS

Extremely Critical:	Environmental Protection Agency (EPA) orders in the form of a consent decree, findings and orders or court order. Health Department Construction Ban.
Critical:	Improvements ordered by the Environmental Protection Agency (EPA) in the form of NPDES Orders.
Major:	Replace deficient appurtenances. Update existing processes due to EPA recommendations.
Moderate:	Increase capacity to meet current needs or update processes to improve effluent quality.
Minimal:	New/Expansion project to meet a specific development proposal.
No Impact:	New/Expansion to meet future or projected needs.

## WATER TREATMENT PLANT

Extremely Critical:	EPA orders in the form of a consent decree, findings and orders or court order.
Critical:	Improvements to meet Environmental Protection Agency (EPA) Safe Drinking Water Regulations and/or NPDES Orders.
Major:	Replace deficient appurtenances. Update existing processes due to EPA recommendations.
Moderate:	Increase capacity to meet current needs or update processes to improve water quality.
Minimal:	New/Expansion project to meet a specific development proposal.
No Impact:	New/Expansion to meet future or projected needs.

COMBINED SEWER SEPARATIONS (May be construction of either new storm or sanitary sewer as long as the result is two separate sewer systems.)

- Extremely Critical: EPA orders in the form of a consent decree, findings and orders or court order. Health Department Construction Ban.
- Critical: Separate, due to chronic backup or flooding in basements.
- Major: Separate, due to documented water quality impairment, or due to EPA recommendations.
- Moderate: Separate, due to specific development proposal within or upstream of the combined system area.
- Minimal: Separate, to conform to current design standards.
- No Impact: No positive health effect.

STORM SEWERS

- Extremely Critical: EPA orders in the form of a consent decree, findings and orders or court order.
- Critical: Chronic flooding (structure damage).
- Major: Inadequate capacity (land damage).
- Moderate: Inadequate capacity with no associated damage.
- Minimal: New/Expansion to meet current needs.
- No Impact: New/Expansion to meet future or project needs.

CULVERTS

- Extremely Critical: Structurally deficient or functionally obsolete. Deterioration has already caused a safety Critical: hazard to the public.
- Critical: Inadequate capacity with land damage and the existing or high probability of property damage.
- Major: Inadequate capacity (land damage).
- Moderate: Inadequate capacity with no associated damage.
- Minimal: New/Expansion to meet current needs.
- No Impact: New/Expansion to meet future or projected needs.

## SANITARY SEWERS

- Extremely Critical: EPA orders in the form of a consent decree, findings and orders or court order. Health Department Construction Ban.
- Critical: Replace, due to chronic pipe failure, chronic backup or flooding in basements. Improvements ordered by the Environmental Protection Agency (EPA) in the form of NPDES Orders.
- Major: Replace, due to inadequate capacity or infiltration, or due to EPA recommendations.
- Moderate: Rehabilitate to increase capacity to meet current needs or to reduce inflow and infiltration.
- Minimal: New/Expansion project to meet a specific development proposal.
- No Impact: New/Expansion to meet future or projected needs.

## SANITARY LIFT STATIONS AND FORCE MAINS

- Extremely Critical: Structurally deficient. Deterioration has already caused a safety/health hazard to the public, or, EPA orders in the form of a consent decree, findings and orders or court order.
- Critical: Inadequate capacity with actual or a high probability of property damage. Improvements ordered by the Environmental Protection Agency (EPA) in the form of NPDES Orders.
- Major: EPA recommendations, or, reduces a probable health and/or safety problem.
- Moderate: Rehabilitate to increase capacity to meet current needs.
- Minimal: New/Expansion to meet a specific development proposal.
- No Impact: New/Expansion to meet future or projected needs.

## WATER PUMP STATIONS

- Extremely Critical: Structurally deficient. Deterioration has already caused a safety hazard to the public, or, EPA orders in the form of a consent decree, findings and orders or court order.
- Critical: Inadequate capacity with the inability to maintain pressure required for fire flows.
- Major: Replace due to inadequate capacity or EPA recommendations.
- Moderate: Rehabilitate to increase capacity to meet current needs.
- Minimal: New/Expansion to meet a specific development proposal.
- No Impact: New/Expansion to meet future or projected needs.



WATER LINES/WATER TOWERS

- Extremely Critical: Solve low water pressure or excessive incidents of main breaks in project area.
- Critical: Replace, due to deficiency such as excessive corrosion, etc.
- Major: Replace undersized water lines as upgrading process.
- Moderate: Increase capacity to meet current needs.
- Minimal: New/Expansion project to meet a specific development proposal.
- No Impact: New/Expansion to meet future or projected needs.

OTHER

- Extremely Critical: There is a present health and/or safety threat.
- Critical: The project will provide immediate health and/or safety benefit.
- Major: The project will reduce a probable health and/or safety problem.
- Moderate: The project will delay a health and/or safety problem.
- Minimal: A possible future health and/or safety problem mitigation.
- No Impact: No health and/or safety effect.

*NOTE: Combined projects that can be rated in more than one subset may be rated in the other category at the discretion of the District 5 Executive Committee. In general, the majority of the cost or scope of the project shall determine the category under which the project will be scored.*

(Submittals without supporting documentation will receive 0 Points for this question.)

Extremely Critical \_\_\_\_, Critical \_\_\_\_, Major X, Moderate \_\_\_\_, Minimal \_\_\_\_, No Impact \_\_\_\_ . Explain your answer. Reconstruction of a minor access road (4R)

---

(Additional narrative, charts and/or pictures should be attached to questionnaire)

4. Identify the amount of local funds that will be used on the project as a percentage of the total project cost.

A.) Amount of Local Funds = \$ 80,716

B.) Total Project Cost = \$ 128,121

RATIO OF LOCAL FUNDS DIVIDED by TOTAL PROJECT COSTS (A/B)= 63 %

Note: Local funds should be considered funds derived from the applicant budget or loans funds to be paid back through local budget, assessments, rates or tax revenues collected by the applicant.

5. Identify the amount of other funding sources to be used on the project, excluding State Issue II or LTIP Funds, as a percentage of the total project cost.

Grants \_\_\_% Gifts \_\_\_%, Contributions \_\_\_%

Other \_\_\_% (explain) \_\_\_\_\_ , Total \_\_\_%

Note: Grant funds and other revenues not contributed or collected through taxes by the applicant should be considered other funds. The Scope of Work for each Funding Source must be the same.

6. Total Amount of SCIP and Loan Funding Requested- An Applicant can request a grant per the categories below for points as indicated on the Priority Rating Sheet. If the Applicant is including a loan request equal to, but not exceeding 50% of the OPWC funding amounts listed below, there will be no point penalty. If loan funds requested are more than 50%, points as listed in the Priority Rating Sheet will apply.

- \_\_\_\_\_ \$500,001 or More
- \_\_\_\_\_ \$400,001-\$500,000
- \_\_\_\_\_ \$325,001-\$400,000
- \_\_\_\_\_ \$275,001-\$325,000
- \_\_\_\_\_ \$175,001-\$275,000
- X   \$175,000 or Less

There are times when the District spends all of the grant money and has loan money remaining. When this happens, the district makes a loan offer in the amount of the requested grant to the communities that were not funded. The offers are made in the order of scoring. We need to know if you are not successful in obtaining grant dollars for your project if you would be interested in loan money:

YES   X   NO \_\_\_\_\_

(This will only be considered if you are not funded with grant money and there is remaining loan money.) **Please note: if you answer “no” you will not be contacted, only if you answer “yes” will an offer be made in the event that there is loan money remaining.**

7. If the proposed project is funded, will its completion directly result in the creation of permanent full-time equivalent (FTE) jobs (FTE jobs shall be defined as 35 hours/week) ? Yes \_\_\_ No   X  . If yes, how many jobs within eighteen months? \_\_\_ Will the completed project retain jobs that would otherwise be permanently lost? Yes \_\_\_ No   X  . If yes, how many jobs \_\_\_\_\_ **will be created/retrained** within 18



months **following the completion of the improvements?**

(Supporting documentation in the form of letter from affected industrial or commercial enterprises that specify full time equivalent jobs that will be retained or created directly by the installation or improvement of Public infrastructure. Additional items such as; 1) newspaper articles or other media news accounts, 2) public meeting minutes, and/or 3) a letter from the County Economic Development Director or State of Ohio Economic Development Professional that alludes to the requirement for the infrastructure improvement to support the business. Submittals without supporting documentation will receive 0 points for this question.)

8. What is the total number of existing users that will directly benefit from the proposed project if completed? 492 (Use households served, traffic counts, etc. and explain the basis by which you arrived at your number.)

9. Is subdivision's population less than 5,000 Yes X No    

If yes, continue. You may want to design your project per Small Government Project Evaluation Criteria, released for the current OPWC Round to assist in evaluating your project for potential Small Government Funding. The Small Government Criteria is available on the OPWC website at <http://www.pwc.state.oh.us/Meth.SG.PDF> If No, skip to Question 11.

10. **OHIO PUBLIC WORKS COMMISSION SMALL GOVERNMENT PROGRAM GUIDELINES**

All projects that are sponsored by a subdivision with a population of 5,000 or less, and not earning enough points for District Funding from SCIP or LTIP Funds, are then rated using the Small Government Program Rating Criteria for the corresponding funding round. In order to be rated the entity must submit the Small Government Supplement and their required budgets with their application. **Only infrastructure that is village- or township- owned is eligible for assistance.** The following policies have been adopted by the Small Government Commission:

- District Integrating Committees may submit up to seven (7) applications for consideration by the Commission. All 7 must be ranked, however, only the top five (5) will be scored. The remaining two (2) will be held as contingency projects should an application be withdrawn.
- Grants are limited to \$500,000. Any assistance above that amount must be in the form of a loan.
  - Grants for new or expanded infrastructure cannot exceed 50% of the project estimate.
- The Commission may deny funding for water and sewer systems that are deemed to be more cost-effective if regionalized.
- If a water or sewer project is determined to be affordable, the project will be offered a loan rather than a grant. Pay special attention to the **Water & Wastewater Affordability Supplemental and the Small**





---

(DO NOT INCLUDE SCHOOL TAXES)

SPECIFIC PROJECT AREA INFORMATION.

Median household income \$39,826

Monthly utility rate:      Water                     

   Sewer                     

   Other                     

List any special user fees or assessment (be specific)

\_\_\_\_\_  
\_\_\_\_\_  
\_\_\_\_\_

---

POLITICAL SUBDIVISION= Village of Walbridge

COUNTY= Wood

DISCRETIONARY POINTS (BY DISTRICT COMMITTEE ONLY)= \_\_\_\_\_

(25-20-15)

---

Date:

9/16/18  
Michael Hister

Signature:

Title:

Project Administration Assistant

Address:

1168 North Main Street, Bowling Green, Ohio 43402

Phone:

419-352-7537

FAX:

419-353-0187

Email:

histerm@poggemeyer.com

## Small Government Commission Application Checklist

Use of the following checklist with the Applicants Manual will help ensure that your application is scored at its best competitive advantage. It will also assist with the timely release of the Project Agreement should your project be funded. This form is for your use and not a required submission. Various templates and forms are in this manual, on the Small Government webpage, and on the OPWC Application webpage.

- [X ] Compliant certified authorizing legislation by applicant's governing body (OPWC Application webpage)
- [X ] Cooperative agreement if multi-jurisdictional (OPWC Application webpage)
- [X ] Compliant Chief Financial Officer's Certification and Loan Letter (OPWC Application webpage)
- [X ] Funding commitment letters and or documentation for all non-OPWC matching funds
- [X ] Signed/stamped registered professional engineer's detailed cost estimate including in-kind costs (OPWC Application webpage)
- [X ] Signed/stamped professional engineer's weighted useful life statement if not submitted with original application (cannot be modified)
- [X ] Small Government Engineer's Plan Status Certification form (in this manual and on SG webpage)
- [X ] Clear description of problem and scope of work with appropriate documentation
- [X ] Source documentation for proof of age with year clearly visible or compliant letter from eligible public official {letter template in this manual}
- [X ] Project site photos, if appropriate
- [X ] Map showing project location/site
- [N/A ] Farmland Preservation Review Letter if any impact to farmland (OPWC Application webpage)
- [X ] ADT report for Road, Bridge & Culvert Projects  
*OR*  
Number of households/EDUs (with calculation) for Water, Wastewater, Storm Water Collection, Solid Waste Projects who directly benefit

Roads, Bridges/Culverts, Storm Water, Solid Waste Projects Only:

- [X ] Auditor's Certificate of Estimated Resources with line item detail unless applicant in State of Fiscal Emergency; also if Storm Water or Solid Waste project, the fund(s) typically used are identified {examples in back of this manual}

Water and Wastewater Projects Only:

- [N/A ] "Current" water and wastewater rate ordinances/resolutions for all entities providing services unless applicant in State of Fiscal Emergency
- [N/A ] Small Government Water & Wastewater Ability & Effort Supplemental form (in this manual and on SG webpage)



**Small Government Self-Score**

*(Input Score in box for each criterion; will total automatically)*

**Applicant:** Village of Walbridge

	<b>SCORE</b>
<b>1 Ability &amp; Effort (Use A or B according to project type)</b>	
A. <i>Roads, Bridges/Culverts, Storm Water, Solid Waste Projects ONLY</i> 0 2 4 6 8 10	6
B. <i>Water &amp; Wastewater Projects ONLY</i> Cannot be self-scored; uses blind factor based on all project applications	0
<b>2 Health &amp; Safety (Use A or B according to project type)</b>	
A. <i>Road, Bridge, Culvert</i> 0 2 4 6 8 10	4
B. <i>Water, Wastewater, Storm Water, Solid Waste</i> 0 2 4 6 8 10	0
<b>3 Age &amp; Condition</b>	
I. <i>Age</i> 0 1 2 3 4 5	5
II. <i>Condition</i> 1 3 5	3
<b>4 Leveraging Ratio</b> 0 1 2 3 4 5 6 7 8 9 10	4
<b>5 Population Benefit</b> 0 1 2 3 4 5	1
<b>6 District Priority Ranking - Completed by Administrator</b>	0
<b>7 OPWC Funds Requested</b> 0 2 4 6 8 10	10
<b>8 Loan Request (Default 0 points if no loan requested)</b> 1 5 10	10
<b>9 Useful Life</b> 1 2 3 4 5	3
<b>10 Median Household Income</b> 2 4 6 8 10	10
<b>11 Readiness to Proceed</b>	
I. <i>Status of Plans</i> 0 2 5	0
II. <i>Status of Funding</i> 0 3 5	5
<b>TOTAL</b>	<b>61</b>