



State of Ohio  
**Public Works Commission**  
*Application for Financial Assistance*

**IMPORTANT:** Please consult "Instructions for Financial Assistance for Capital Infrastructure Projects" for guidance in completion of this form.

**Applicant**

Applicant: City Of Clyde, Ohio Subdivision Code: 143-16308  
 District Number: 5 County: Sandusky Date: 08/19/2021  
 Contact: Mark Swartz Phone: (419) 217-9168  
(The individual who will be available during business hours and who can best answer or coordinate the response to questions)  
 Email: msengineeringllc@yahoo.com FAX: (419) 547-3586

Project Name: 2022 Pavement Replacement Program Zip Code: 43410

**Project**

Subdivision Type <small>(Select one)</small>	Project Type <small>(Select single largest component by \$)</small>	Funding Request Summary <small>(Automatically populates from page 2)</small>
<input type="checkbox"/> 1. County	<input checked="" type="checkbox"/> 1. Road	Total Project Cost: <u>407,000.00</u>
<input checked="" type="checkbox"/> 2. City	<input type="checkbox"/> 2. Bridge/Culvert	1. Grant: <u>175,000.00</u>
<input type="checkbox"/> 3. Township	<input type="checkbox"/> 3. Water Supply	2. Loan: <u>0.00</u>
<input type="checkbox"/> 4. Village	<input type="checkbox"/> 4. Wastewater	3. Loan Assistance/ Credit Enhancement: <u>0.00</u>
<input type="checkbox"/> 5. Water (6119 Water District)	<input type="checkbox"/> 5. Solid Waste	Funding Requested: <u>175,000.00</u>
	<input type="checkbox"/> 6. Stormwater	

**District Recommendation** (To be completed by the District Committee)

Funding Type Requested <small>(Select one)</small>	SCIP Loan - Rate: _____ % Term: _____ Yrs	Amount: _____ .00
<input type="checkbox"/> State Capital Improvement Program	RLP Loan - Rate: _____ % Term: _____ Yrs	Amount: _____ .00
<input type="checkbox"/> Local Transportation Improvement Program	Grant:	Amount: _____ .00
<input type="checkbox"/> Revolving Loan Program	LTIP:	Amount: _____ .00
<input type="checkbox"/> Small Government Program	Loan Assistance / Credit Enhancement:	Amount: _____ .00
District SG Priority: _____		

**For OPWC Use Only**

STATUS _____	Grant Amount: _____ .00	Loan Type: <input type="checkbox"/> SCIP <input type="checkbox"/> RLP
Project Number: _____	Loan Amount: _____ .00	Date Construction End: _____
	Total Funding: _____ .00	Date Maturity: _____
Release Date: _____	Local Participation: _____ %	Rate: _____ %
OPWC Approval: _____	OPWC Participation: _____ %	Term: _____ Yrs

1.0 Project Financial Information (All Costs Rounded to Nearest Dollar)

1.1 Project Estimated Costs

Engineering Services

Preliminary Design:	<u>5,000</u>	.00	
Final Design:	<u>10,000</u>	.00	
Construction Administration:	<u>10,000</u>	.00	
Total Engineering Services:	a.) <u>25,000</u>	.00	<u>7</u> %
Right of Way:	b.) _____	.00	
Construction:	c.) <u>382,000</u>	.00	
Materials Purchased Directly:	d.) _____	.00	
Permits, Advertising, Legal:	e.) _____	.00	
Construction Contingencies:	f.) _____	.00	<u>0</u> %
Total Estimated Costs:	g.) <u>407,000</u>	.00	

1.2 Project Financial Resources

Local Resources

Local In-Kind or Force Account:	a.) _____	.00	
Local Revenues:	b.) <u>232,000</u>	.00	
Other Public Revenues:	c.) _____	.00	
ODOT / FHWA PID: _____	d.) _____	.00	
USDA Rural Development:	e.) _____	.00	
OEPA / OWDA:	f.) _____	.00	
CDBG:	g.) _____	.00	
<input type="checkbox"/> County Entitlement or Community Dev. "Formula"			
<input type="checkbox"/> Department of Development			
Other: _____	h.) _____	.00	
Subtotal Local Resources:	i.) <u>232,000</u>	.00	<u>57</u> %

OPWC Funds (Check all requested and enter Amount)

Grant: <u>100</u> % of OPWC Funds	j.) <u>175,000</u>	.00	
Loan: <u>0</u> % of OPWC Funds	k.) _____	.00	
Loan Assistance / Credit Enhancement:	l.) <u>0</u>	.00	
Subtotal OPWC Funds:	m.) <u>175,000</u>	.00	<u>43</u> %
Total Financial Resources:	n.) <u>407,000</u>	.00	<u>100</u> %

### 1.3 Availability of Local Funds

Attach a statement signed by the Chief Financial Officer listed in section 5.2 certifying all local resources required for the project will be available on or before the earliest date listed in the Project Schedule section. The OPWC Agreement will not be released until the local resources are certified. Failure to meet local share may result in termination of the project. Applicant needs to provide written confirmation for funds coming from other funding sources.

### 2.0 Repair / Replacement or New / Expansion

2.1 Total Portion of Project Repair / Replacement:	<u>407,000</u> .00	<u>100</u> %	A Farmland Preservation letter is required for any impact to farmland.
2.2 Total Portion of Project New / Expansion:	<u>0</u> .00	<u>0</u> %	
2.3 Total Project:	<u>407,000</u> .00	<u>100</u> %	

### 3.0 Project Schedule

3.1 Engineering / Design / Right of Way	Begin Date: <u>10/01/2021</u>	End Date: <u>01/28/2022</u>
3.2 Bid Advertisement and Award	Begin Date: <u>02/21/2022</u>	End Date: <u>07/04/2022</u>
3.3 Construction	Begin Date: <u>07/11/2022</u>	End Date: <u>10/14/2022</u>

Construction cannot begin prior to release of executed Project Agreement and issuance of Notice to Proceed. Failure to meet project schedule may result in termination of agreement for approved projects. Modification of dates must be requested in writing by project official of record and approved by the Commission once the Project Agreement has been executed.

### 4.0 Project Information

If the project is multi-jurisdictional, information must be consolidated in this section.

#### 4.1 Useful Life / Cost Estimate / Age of Infrastructure

Project Useful Life: 18 Years      Age: 2003 (Year built or year of last major improvement)

*Attach Registered Professional Engineer's statement, with seal or stamp and signature confirming the project's useful life indicated above and detailed cost estimate.*

#### 4.2 User Information

Road or Bridge:      Current ADT 7,016      Year 2021      Projected ADT \_\_\_\_\_ Year \_\_\_\_\_

Water / Wastewater: Based on monthly usage of 4,500 gallons per household; attach current ordinances.

Residential Water Rate      Current \$ \_\_\_\_\_      Proposed \$ \_\_\_\_\_

Number of households served: \_\_\_\_\_

Residential Wastewater Rate      Current \$ \_\_\_\_\_      Proposed \$ \_\_\_\_\_

Number of households served: \_\_\_\_\_

Stormwater: Number of households served: \_\_\_\_\_

## 4.3 Project Description

- A: SPECIFIC LOCATION (Supply a written location description that includes the project termini; a map does not replace this requirement.) 500 character limit.

Arch Street - Main St To Church S  
Bertha Avenue - Main St To Helen St  
Brown Street - Yost St To Parker Avenue  
Elm Street - Main St To Church St  
Fairhome Avenue - Main S To Helen S  
Lemmon Street - Main St To Helen St  
Mason Street - Midvale Avenue To S.R. 101  
Mechanic Street - Fair St To Cherry St  
Mulberry Street - Woodland Avenue To Maple St  
Sherman Street - Elm St To Arch St  
South Street - Mechanic St To Mulberry St      White St. - Mulberry St To Main St  
Yost St - Duane St To Brown St

- B: PROJECT COMPONENTS (Describe the specific work to be completed; the engineer's estimate does not replace this requirement) 1,000 character limit.

This project consists of reconstructing the existing asphalt pavement on thirteen Major Access Streets, in the City of Clyde, Ohio, being approximately 2.90 miles in total length. All streets will be pavement planed one and one half inches, and paved, using a one and one half inch surface course of asphalt pavement. Approximately 38,000 square yards of pavement planing and over 3,200 tons of asphalt will be used. After all streets have been completed, approximately 1,050 feet of cross walks and 282 feet of stop bars will be applied.

- C: PHYSICAL DIMENSIONS (Describe the physical dimensions of the existing facility and the proposed facility. Include length, width, quantity and sizes, mgd capacity, etc in detail.) 500 character limit.

This project will reconstruct twelve Major Access Streets, in the City of Clyde, amounting to approximately 2.90 miles in total length, on streets ranging from 16 feet to 30 feet in width. This project includes approximately 38,000 square yards of pavement planing, 3,200 tons of asphalt, 1,050 feet of cross walks and 282 feet of stop bars.

## 5.0 Project Officials

Changes in Project Officials must be submitted in writing from an officer of record.

### 5.1 Chief Executive Officer (Person authorized in legislation to sign project agreements)

Name: Paul Fiser  
Title: City Manager  
Address: 222 North Main Street  
  
City: Clyde State: Oh Zip: 43410  
Phone: (419) 547-6898  
FAX: (419) 547-3586  
E-Mail: pfiser@clydeohio.org

### 5.2 Chief Financial Officer (Can not also serve as CEO)

Name: Craig Davis  
Title: Finance Director  
Address: 222 North Main Street  
  
City: Clyde State: Oh Zip: 43410  
Phone: (419) 547-0575  
FAX: (419) 547-3586  
E-Mail: cdavis@clydeohio.org

### 5.3 Project Manager

Name: Mark Swartz P.E., P.S.  
Title: Project Engineer (MS Engineering LLC)  
Address: 2749 South County Road 260  
  
City: Clyde State: Oh Zip: 43410  
Phone: (419) 217-9168  
FAX: (419) 547-3586  
E-Mail: msengineeringllc@yahoo.com

## 6.0 Attachments / Completeness review

Confirm in the boxes below that each item listed is attached (Check each box)

- A certified copy of the legislation by the governing body of the applicant authorizing a designated official to sign and submit this application and execute contracts. This Individual should sign under 7.0, Applicant Certification, below.
- A certification signed by the applicant's chief financial officer stating the amount of all local share funds required for the project will be available on or before the dates listed in the Project Schedule section. If the application involves a request for loan (RLP or SCIP), a certification signed by the CFO which identifies a specific revenue source for repaying the loan also must be attached. Both certifications can be accomplished in the same letter.
- A registered professional engineer's detailed cost estimate and useful life statement, as required in 164-1-13, 164-1-14, and 164-1-16 of the Ohio Administrative Code. Estimates shall contain an engineer's seal or stamp and signature.
- A cooperative agreement (if the project involves more than one subdivision or district) which identifies the fiscal and administrative responsibilities of each participant.
- Farmland Preservation Review - The Governor's Executive Order 98-IV, "Ohio Farmland Protection Policy" requires the Commission to establish guidelines on how it will take protection of productive agricultural and grazing land into account in its funding decision making process. Please include a Farm Land Preservation statement for projects that have an impact on farmland.
- Capital Improvements Report. CIR Required by O.R.C. Chapter 164.06 on standard form.
- Supporting Documentation: Materials such as additional project description, photographs, economic impact (temporary and/or full time jobs likely to be created as a result of the project), accident reports, impact on school zones, and other information to assist your district committee in ranking your project. Be sure to include supplements which may be required by your local District Public Works Integrating Committee.

## 7.0 Applicant Certification

The undersigned certifies: (1) he/she is legally authorized to request and accept financial assistance from the Ohio Public Works Commission as identified in the attached legislation; (2) to the best of his/her knowledge and belief, all representations that are part of this application are true and correct; (3) all official documents and commitments of the applicant that are part of this application have been duly authorized by the governing body of the applicant; and, (4) should the requested financial assistance be provided, that in the execution of this project, the applicant will comply with all assurances required by Ohio Law, including those involving Buy Ohio and prevailing wages.

**Applicant certifies that physical construction on the project as defined in the application has NOT begun, and will not begin until a Project Agreement for this project has been executed with the Ohio Public Works Commission. Action to the contrary will result in termination of the agreement and withdrawal of Ohio Public Works Commission funding from the project.**

Paul Fiser, Clyde City Manager

Certifying Representative (Printed form, Type or Print Name and Title)

Paul Fiser 9-9-2021

Original Signature / Date Signed



RESOLUTION NO. 2021-38

A RESOLUTION AUTHORIZING THE CITY MANAGER TO PREPARE AND SUBMIT AN APPLICATION TO PARTICIPATE IN THE OHIO PUBLIC WORKS COMMISSION STATE CAPITAL IMPROVEMENT AND/OR LOCAL TRANSPORTATION IMPROVEMENT PROGRAM(S) AND TO EXECUTE CONTRACTS AS REQUIRED.

WHEREAS, the State Capital Improvement Program and the Local Transportation Improvement Program both provide financial assistance to political subdivisions for capital improvements to public infrastructure, and

WHEREAS, the infrastructure improvements herein described are capital improvements known as the Year 2022 –

1. CLYDE PAVING PROGRAM
2. WOODLAND AVENUE/MAPLE STREET SANITARY SEWER

WHEREAS, the infrastructure improvements herein described are considered to be a priority need for the community and are qualified projects under the OPWC programs.

NOW THEREFORE, BE IT RESOLVED by the Council of the City of Clyde, Ohio:

**SECTION 1.** The City Manager is hereby authorized to apply to the OPWC for funds as described above.

**SECTION 2.** The City Manager is further authorized to enter into any agreements as may be necessary and appropriate for obtaining this financial assistance, provided that any agreements requiring financial participation by the City shall first require additional approval legislation by this Council.

**SECTION 3.** That this Resolution shall go into effect on and after the earliest period allowed by law.

PASSED: 8-3-2021

  
G. Scott Black, Mayor

ATTEST: Janet R. Dickman  
Clerk of Council

APPROVED AS TO FORM:

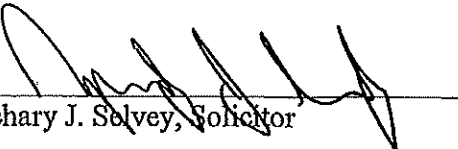
  
Zachary J. Solvey, Solicitor

**FISCAL OFFICER CERTIFICATION  
OF  
LOCAL FUNDS**

I, Craig Davis, the duly appointed and acting Finance Director, of the City of Clyde, Ohio, do hereby certify the City of Clyde, Ohio has funds, in the amount of \$ **232,000.00** in the City's **PERMANENT IMPROVEMENT FUND** and that this amount will be used to pay the local share for the **2022 Pavement Replacement Program** when it is required.

WITNESS MY HAND this 31 day of August, 2021,  
at Clyde, Ohio.

  
\_\_\_\_\_  
Fiscal Officer      Craig Davis  
Finance Director  
City of Clyde, Ohio



**ENGINEER'S ESTIMATE**  
 For The  
**2022 PAVEMENT REPLACEMENT PROGRAM**  
 August 2021

ITEM	QUAN.	UNIT	UNIT PRICE	TOTAL PRICE	DESCRIPTION
103.05	Lump	Sum	2,435.00	2,435.00	Premium For Contract Performance Bond
254	37,995	S.Y.	2.00	75,990.00	Pavement Planing, As Per Plan
254	200	S.Y.	10.00	2,000.00	Patching Planed Surface
407	2,760	Gal.	2.00	5,520.00	Tack Coat (0.07 Gal/ S.Y.)
411	51	Ton	65.00	3,315.00	Stab. Crushed Aggregate, For Driveways
441	3,255	Ton	82.00	266,910.00	Asph. Conc. Surface Course, Type 1 (448), PG 64-22, As Per Plan
614	1.96	Mile	650.00	1,274.00	Work Zone Centerline, Class 2
614	Lump	Sum	15,000.00	15,000.00	Maintaining Traffic
644	1	Each	1,000.00	1,000.00	School Symbol Marking, 72 Inch
644	1,050	L.F.	6.00	6,300.00	Crosswalk Line
644	282	L.F.	8.00	<u>2,256.00</u>	Stop Line
				Total =	\$382,000.00

**ENGINEER'S CONSTRUCTION ESTIMATE: \$ 382,000.00**

The estimated useful life of the **2022 PAVEMENT REPLACEMENT PROGRAM** is 18 years.

PREPARED BY:



*Mark E. Swartz* 8-31-21

Mark E. Swartz P.E.  
 MS Engineering LLC  
 Reg. Engineer No. 53919  
 2749 South C.R. 260  
 Clyde, Ohio 43410

**PROJECT DESCRIPTION**  
**For The**  
**2022 PAVEMENT REPLACEMENT PROGRAM**

This project consists of pavement planing and resurfacing thirteen Major Access streets, in Clyde, Ohio, being approximately 2.90 miles in total length. Approximately 38,000 square yards of one and one half inches of pavement planing and 3,200 tons of one and one half inches of asphalt paving will be used on this project. After all streets have been resurfaced with a surface course of asphalt concrete, approximately 1200 feet of cross walks and 400 feet of stop bars will be applied, where indicated.



# Directional 24 Hour Volume Report: 200 ARCH

Info Line 1 :  
 Info Line 2 :  
 GPS Lat/Lon :

Last Connected Device Type : Apollo  
 Serial Number :  
 # Lanes : 1

## Directional 24 Hour Volume Data For: August 3, 2021 (Tue)

Time	1	TOTAL
- AM -		
12 - 1		
1 - 2		
2 - 3		
3 - 4		
4 - 5		
5 - 6		
6 - 7		
7 - 8		
8 - 9		
9 - 10		
10 - 11		
11 - 12		
- PM -		
12 - 1		
1 - 2		
2 - 3	8	8
3 - 4	19	19
4 - 5	20	20
5 - 6	14	14
6 - 7	18	18
7 - 8	7	7
8 - 9	5	5
9 - 10	10	10
10 - 11	1	1
11 - 12	4	4

**TOTALS :** 106 106  
 % Total : 100.0%

----- AM (12am-10am) Peak Volumes -----

15 Minute :  
 One Hour :  
 P.H.F. :  
 PH Begins :

----- Mid (10am-2pm) Peak Volumes -----

15 Minute :  
 One Hour :  
 P.H.F. :  
 PH Begins :

----- PM (2pm-12am) Peak Volumes -----

15 Minute :	8				8
One Hour :	21				21
P.H.F. :	0.75				0.75
PH Begins :	2:45pm				2:45pm

**Directional 24 Hour Volume Data For: August 4, 2021 (Wed)**

Time	1	TOTAL
- AM -		
12 - 1	0	0
1 - 2	0	0
2 - 3	1	1
3 - 4	0	0
4 - 5	2	2
5 - 6	3	3
6 - 7	11	11
7 - 8	4	4
8 - 9	12	12
9 - 10	14	14
10 - 11	15	15
11 - 12	5	5
- PM -		
12 - 1	12	12
1 - 2	14	14
2 - 3	10	<del>10</del>
3 - 4	9	<del>9</del>
4 - 5	13	<del>13</del>
5 - 6	11	<del>11</del>
6 - 7	15	<del>15</del>
7 - 8	7	<del>7</del>
8 - 9	10	<del>10</del>
9 - 10	11	<del>11</del>
10 - 11	3	<del>3</del>
11 - 12	3	<del>3</del>

TOTALS : 185  
 % Total : 100.0% 185

AM (12am-10am) Peak Volumes

15 Minute : 6 6  
 One Hour : 15 15  
 P.H.F. : 0.75 0.75  
 PH Begins : 8:45am 8:45am

Mid (10am-2pm) Peak Volumes

15 Minute : 7 7  
 One Hour : 15 15  
 P.H.F. : 0.54 0.54  
 PH Begins : 10:00am 10:00am

PM (2pm-12am) Peak Volumes

15 Minute : 7 7  
 One Hour : 18 18  
 P.H.F. : 0.64 0.64  
 PH Begins : 5:30pm 5:30pm

TOTAL 24 HRZ = 199

# Directional 24 Hour Volume Report: 158 BERTHA

Info Line 1 :  
 Info Line 2 :  
 GPS Lat/Lon :

Last Connected Device Type : Apollo  
 Serial Number :  
 # Lanes : 1

## Directional 24 Hour Volume Data For: August 13, 2021 (Fri)

Time	1	TOTAL
<b>- AM -</b>		
12 - 1		
1 - 2		
2 - 3		
3 - 4		
4 - 5		
5 - 6		
6 - 7		
7 - 8		
8 - 9	6	6
9 - 10	13	13
10 - 11	9	9
11 - 12	9	9
<b>- PM -</b>		
12 - 1	23	23
1 - 2	20	20
2 - 3	24	24
3 - 4	29	29
4 - 5	29	29
5 - 6	20	20
6 - 7	26	26
7 - 8	46	46
8 - 9	18	18
9 - 10	7	7
10 - 11	8	8
11 - 12	6	6

**TOTALS :** 293 293  
 % Total : 100.0%

### AM (12am-10am) Peak Volumes

15 Minute :	6		6
One Hour :	16		16
P.H.F. :	0.67		0.67
PH Begins :	8:45am		8:45am

### Mid (10am-2pm) Peak Volumes

15 Minute :	12		12
One Hour :	23		23
P.H.F. :	0.64		0.64
PH Begins :	11:45am		11:45am

### PM (2pm-12am) Peak Volumes

15 Minute :	21		21
One Hour :	48		48
P.H.F. :	0.57		0.57
PH Begins :	7:15pm		7:15pm



**Directional 24 Hour Volume Data For: August 14, 2021 (Sat)**

Time	1	TOTAL
<b>- AM -</b>		
12 - 1	0	0
1 - 2	0	0
2 - 3	0	0
3 - 4	0	0
4 - 5	9	9
5 - 6	2	2
6 - 7	8	8
7 - 8	5	5
8 - 9	16	16
9 - 10		
10 - 11		
11 - 12		
<b>- PM -</b>		
12 - 1		
1 - 2		
2 - 3		
3 - 4		
4 - 5		
5 - 6		
6 - 7		
7 - 8		
8 - 9		
9 - 10		
10 - 11		
11 - 12		

**TOTALS :** 40 **40**  
 % Total : 100.0%

AM (12am-10am) Peak Volumes

15 Minute :	8	8
One Hour :	21	21
P.H.F. :	0.66	0.66
PH Begins :	7:30am	7:30am

Mid (10am-2pm) Peak Volumes

15 Minute :  
 One Hour :  
 P.H.F. :  
 PH Begins :

PM (2pm-12am) Peak Volumes

15 Minute :  
 One Hour :  
 P.H.F. :  
 PH Begins :

TOTAL 24 HR = 317



# Directional 24 Hour Volume Report: 610 BROWN

Info Line 1 :  
 Info Line 2 :  
 GPS Lat/Lon :

Last Connected Device Type : Apollo  
 Serial Number :  
 # Lanes : 1

## Directional 24 Hour Volume Data For: August 20, 2021 (Fri)

Time	1	TOTAL
<b>- AM -</b>		
12 - 1		
1 - 2		
2 - 3		
3 - 4		
4 - 5		
5 - 6		
6 - 7		
7 - 8		
8 - 9		
9 - 10		
10 - 11		
11 - 12		
<b>- PM -</b>		
12 - 1		
1 - 2	4	4
2 - 3	9	9
3 - 4	4	4
4 - 5	4	4
5 - 6	12	12
6 - 7	8	8
7 - 8	5	5
8 - 9	11	11
9 - 10	1	1
10 - 11	4	4
11 - 12	1	1

**TOTALS :** 63 63  
 % Total : 100.0%

### AM (12am-10am) Peak Volumes

15 Minute :  
 One Hour :  
 P.H.F. :  
 PH Begins :

### Mid (10am-2pm) Peak Volumes

15 Minute :	2	2
One Hour :	4	4
P.H.F. :	0.50	0.50
PH Begins :	1:00pm	1:00pm

### PM (2pm-12am) Peak Volumes

15 Minute :	6	6
One Hour :	14	14
P.H.F. :	0.58	0.58
PH Begins :	5:15pm	5:15pm

**Directional 24 Hour Volume Data For: August 21, 2021 (Sat)**

Time	1	TOTAL
<b>- AM -</b>		
12 - 1	1	1
1 - 2	2	2
2 - 3	0	0
3 - 4	0	0
4 - 5	1	1
5 - 6	0	0
6 - 7	0	0
7 - 8	3	3
8 - 9	4	4
9 - 10	0	0
10 - 11	5	5
11 - 12	7	7
<b>- PM -</b>		
12 - 1	6	6
1 - 2	<del>10</del>	<del>10</del>
2 - 3	<del>11</del>	<del>11</del>
3 - 4	<del>6</del>	<del>6</del>
4 - 5	<del>4</del>	<del>4</del>
5 - 6	<del>11</del>	<del>11</del>
6 - 7	<del>6</del>	<del>6</del>
7 - 8	<del>5</del>	<del>5</del>
8 - 9	<del>5</del>	<del>5</del>
9 - 10	<del>3</del>	<del>3</del>
10 - 11	<del>2</del>	<del>2</del>
11 - 12	<del>0</del>	<del>0</del>

**TOTALS :** 92 **92**  
 % Total : 100.0%

AM (12am-10am) Peak Volumes

15 Minute :	3	3
One Hour :	4	4
P.H.F. :	0.33	0.33
PH Begins :	7:45am	7:45am

Mid (10am-2pm) Peak Volumes

15 Minute :	8	8
One Hour :	13	13
P.H.F. :	0.41	0.41
PH Begins :	12:45pm	12:45pm

PM (2pm-12am) Peak Volumes

15 Minute :	5	5
One Hour :	11	11
P.H.F. :	0.55	0.55
PH Begins :	1:45pm	1:45pm

24 HR TOTAL = 86



**Directional 24 Hour Volume Data For: August 10, 2021 (Tue)**

Time	1	TOTAL
<b>- AM -</b>		
12 - 1	12	12
1 - 2	17	17
2 - 3	17	17
3 - 4	12	12
4 - 5	28	28
5 - 6	32	32
6 - 7	180	180
7 - 8	128	128
8 - 9	0	0
9 - 10		
10 - 11		
11 - 12		
<b>- PM -</b>		
12 - 1		
1 - 2		
2 - 3		
3 - 4		
4 - 5		
5 - 6		
6 - 7		
7 - 8		
8 - 9		
9 - 10		
10 - 11		
11 - 12		

**TOTALS :** 426 **426**  
 % Total : 100.0%

AM (12am-10am) Peak Volumes

15 Minute : 75 75  
 One Hour : 226 226  
 P.H.F. : 0.75 0.75  
 PH Begins : 6:30am 6:30am

Mid (10am-2pm) Peak Volumes

15 Minute :  
 One Hour :  
 P.H.F. :  
 PH Begins :

PM (2pm-12am) Peak Volumes

15 Minute :  
 One Hour :  
 P.H.F. :  
 PH Begins :

**TOTAL 24 Hrs = 1774**

# Directional 24 Hour Volume Report: 111 FAIRHOME

Info Line 1 :  
 Info Line 2 :  
 GPS Lat/Lon :

Last Connected Device Type : Apollo  
 Serial Number :  
 # Lanes : 1

## Directional 24 Hour Volume Data For: August 11, 2021 (Wed)

Time	1	TOTAL
<b>- AM -</b>		
12 - 1		
1 - 2		
2 - 3		
3 - 4		
4 - 5		
5 - 6		
6 - 7		
7 - 8		
8 - 9		
9 - 10		
10 - 11	0	0
11 - 12	23	23
<b>- PM -</b>		
12 - 1	66	66
1 - 2	47	47
2 - 3	60	60
3 - 4	56	56
4 - 5	49	49
5 - 6	39	39
6 - 7	45	45
7 - 8	35	35
8 - 9	40	40
9 - 10	22	22
10 - 11	24	24
11 - 12	19	19

**TOTALS :** 525 **525**  
 % Total : 100.0%

### AM (12am-10am) Peak Volumes

15 Minute :  
 One Hour :  
 P.H.F. :  
 PH Begins :

### Mid (10am-2pm) Peak Volumes

15 Minute :	27	27
One Hour :	71	71
P.H.F. :	0.66	0.66
PH Begins :	12:30pm	12:30pm

### PM (2pm-12am) Peak Volumes

15 Minute :	33	33
One Hour :	65	65
P.H.F. :	0.68	0.68
PH Begins :	3:15pm	3:15pm

**Directional 24 Hour Volume Data For: August 12, 2021 (Thu)**

Time	1	TOTAL
<b>- AM -</b>		
12 - 1	9	9
1 - 2	3	3
2 - 3	0	0
3 - 4	0	0
4 - 5	8	8
5 - 6	27	27
6 - 7	28	28
7 - 8	26	26
8 - 9	23	23
9 - 10	41	41
10 - 11	33	33
11 - 12	<del>45</del>	<del>45</del>
<b>- PM -</b>		
12 - 1	<del>33</del>	<del>33</del>
1 - 2	<del>40</del>	<del>40</del>
2 - 3		
3 - 4		
4 - 5		
5 - 6		
6 - 7		
7 - 8		
8 - 9		
9 - 10		
10 - 11		
11 - 12		

**TOTALS :** 316 **316**  
 % Total : 100.0%

AM (12am-10am) Peak Volumes

15 Minute :	18	18
One Hour :	41	41
P.H.F. :	0.57	0.57
PH Begins :	9:00am	9:00am

Mid (10am-2pm) Peak Volumes

15 Minute :	22	22
One Hour :	49	49
P.H.F. :	0.56	0.56
PH Begins :	11:45am	11:45am

PM (2pm-12am) Peak Volumes

15 Minute :  
 One Hour :  
 P.H.F. :  
 PH Begins :

TOTAL 24 HR = 723



# Directional 24 Hour Volume Report: LEMMON AT HT

Info Line 1 :  
 Info Line 2 :  
 GPS Lat/Lon :

Last Connected Device Type : Apollo  
 Serial Number :  
 # Lanes : 1

## Directional 24 Hour Volume Data For: August 14, 2021 (Sat)

Time	1	TOTAL
<b>- AM -</b>		
12 - 1		
1 - 2		
2 - 3		
3 - 4		
4 - 5		
5 - 6		
6 - 7		
7 - 8		
8 - 9	3	3
9 - 10	14	14
10 - 11	36	36
11 - 12	35	35
<b>- PM -</b>		
12 - 1	26	26
1 - 2	24	24
2 - 3	33	33
3 - 4	23	23
4 - 5	25	25
5 - 6	24	24
6 - 7	17	17
7 - 8	10	10
8 - 9	20	20
9 - 10	5	5
10 - 11	3	3
11 - 12	2	2

**TOTALS :** 300 **300**  
 % Total : 100.0%

### AM (12am-10am) Peak Volumes

15 Minute :	5	5
One Hour :	14	14
P.H.F. :	0.70	0.70
PH Begins :	9:00am	9:00am

### Mid (10am-2pm) Peak Volumes

15 Minute :	15	15
One Hour :	40	40
P.H.F. :	0.67	0.67
PH Begins :	11:15am	11:15am

### PM (2pm-12am) Peak Volumes

15 Minute :	13	13
One Hour :	39	39
P.H.F. :	0.75	0.75
PH Begins :	2:30pm	2:30pm



**Directional 24 Hour Volume Data For: August 15, 2021 (Sun)**

Time	1	TOTAL
<b>- AM -</b>		
12 - 1	7	7
1 - 2	1	1
2 - 3	0	0
3 - 4	0	0
4 - 5	1	1
5 - 6	1	1
6 - 7	2	2
7 - 8	3	3
8 - 9	5	5
9 - 10	36	36
10 - 11	19	19
11 - 12	97	97
<b>- PM -</b>		
12 - 1	28	28
1 - 2	11	11
2 - 3	18	18
3 - 4	18	18
4 - 5	11	11
5 - 6	33	33
6 - 7	16	16
7 - 8	36	36
8 - 9	52	52
9 - 10	14	14
10 - 11	2	2
11 - 12	4	4

**TOTALS :** 415 **415**  
 % Total : 100.0%

AM (12am-10am) Peak Volumes

15 Minute :	11	11
One Hour :	36	36
P.H.F. :	0.82	0.82
PH Begins :	9:00am	9:00am

Mid (10am-2pm) Peak Volumes

15 Minute :	53	53
One Hour :	106	106
P.H.F. :	0.50	0.50
PH Begins :	11:15am	11:15am

PM (2pm-12am) Peak Volumes

15 Minute :	22	22
One Hour :	55	55
P.H.F. :	0.63	0.63
PH Begins :	7:30pm	7:30pm

TOTAL 24 Hrs = 315

# Directional 24 Hour Volume Report: 329 MASON

Info Line 1 :  
 Info Line 2 :  
 GPS Lat/Lon :

Last Connected Device Type : Apollo  
 Serial Number :  
 # Lanes : 1

## Directional 24 Hour Volume Data For: August 2, 2021 (Mon)

Time	1	TOTAL
<b>- AM -</b>		
12 - 1		
1 - 2		
2 - 3		
3 - 4		
4 - 5		
5 - 6		
6 - 7		
7 - 8		
8 - 9		
9 - 10	77	77
10 - 11	56	56
11 - 12	86	86
<b>- PM -</b>		
12 - 1	57	57
1 - 2	103	103
2 - 3	139	139
3 - 4	126	126
4 - 5	115	115
5 - 6	110	110
6 - 7	72	72
7 - 8	58	58
8 - 9	61	61
9 - 10	55	55
10 - 11	57	57
11 - 12	27	27

**TOTALS :** 1199 1199  
 % Total : 100.0%

### AM (12am-10am) Peak Volumes

15 Minute :	24	24
One Hour :	77	77
P.H.F. :	0.80	0.80
PH Begins :	9:00am	9:00am

### Mid (10am-2pm) Peak Volumes

15 Minute :	33	33
One Hour :	103	103
P.H.F. :	0.78	0.78
PH Begins :	1:00pm	1:00pm

### PM (2pm-12am) Peak Volumes

15 Minute :	45	45
One Hour :	153	153
P.H.F. :	0.85	0.85
PH Begins :	2:30pm	2:30pm

**Directional 24 Hour Volume Data For: August 3, 2021 (Tue)**

Time	1	TOTAL
<b>- AM -</b>		
12 - 1	10	10
1 - 2	2	2
2 - 3	4	4
3 - 4	4	4
4 - 5	13	13
5 - 6	44	44
6 - 7	120	120
7 - 8	99	99
8 - 9	77	77
9 - 10	76	<del>76</del>
10 - 11	82	<del>82</del>
11 - 12	79	<del>79</del>
<b>- PM -</b>		
12 - 1	74	<del>74</del>
1 - 2	28	<del>28</del>
2 - 3		
3 - 4		
4 - 5		
5 - 6		
6 - 7		
7 - 8		
8 - 9		
9 - 10		
10 - 11		
11 - 12		

**TOTALS :** 712 **712**  
 % Total : 100.0%

AM (12am-10am) Peak Volumes

15 Minute :	38	38
One Hour :	120	120
P.H.F. :	0.79	0.79
PH Begins :	6:00am	6:00am

Mid (10am-2pm) Peak Volumes

15 Minute :	27	27
One Hour :	92	92
P.H.F. :	0.88	0.88
PH Begins :	11:30am	11:30am

PM (2pm-12am) Peak Volumes

15 Minute :  
 One Hour :  
 P.H.F. :  
 PH Begins :

TOTAL 24 HR = 1572

# Directional 24 Hour Volume Report: 141 MECHANIC

Info Line 1 :  
 Info Line 2 :  
 GPS Lat/Lon :

Last Connected Device Type : Apollo  
 Serial Number :  
 # Lanes : 1

## Directional 24 Hour Volume Data For: August 19, 2021 (Thu)

Time	1	TOTAL
- AM -		
12 - 1		
1 - 2		
2 - 3		
3 - 4		
4 - 5		
5 - 6		
6 - 7		
7 - 8		
8 - 9		
9 - 10		
10 - 11		
11 - 12		
- PM -		
12 - 1	3	3
1 - 2	7	7
2 - 3	13	13
3 - 4	12	12
4 - 5	9	9
5 - 6	16	16
6 - 7	8	8
7 - 8	8	8
8 - 9	11	11
9 - 10	3	3
10 - 11	0	0
11 - 12	1	1

TOTALS : 91 91  
 % Total : 100.0%

### AM (12am-10am) Peak Volumes

15 Minute :  
 One Hour :  
 P.H.F. :  
 PH Begins :

### Mid (10am-2pm) Peak Volumes

15 Minute : 2 2  
 One Hour : 7 7  
 P.H.F. : 0.88 0.88  
 PH Begins : 1:00pm 1:00pm

### PM (2pm-12am) Peak Volumes

15 Minute : 7 7  
 One Hour : 18 18  
 P.H.F. : 0.90 0.90  
 PH Begins : 4:45pm 4:45pm

**Directional 24 Hour Volume Data For: August 20, 2021 (Fri)**

Time	1	TOTAL
<b>- AM -</b>		
12 - 1	1	1
1 - 2	0	0
2 - 3	0	0
3 - 4	0	0
4 - 5	0	0
5 - 6	0	0
6 - 7	6	6
7 - 8	4	4
8 - 9	8	8
9 - 10	11	11
10 - 11	13	13
11 - 12	16	16
<b>- PM -</b>		
12 - 1	<del>11</del>	<del>11</del>
1 - 2		
2 - 3		
3 - 4		
4 - 5		
5 - 6		
6 - 7		
7 - 8		
8 - 9		
9 - 10		
10 - 11		
11 - 12		

**TOTALS :** 70 **70**  
 % Total : 100.0%

AM (12am-10am) Peak Volumes

15 Minute :	6	6
One Hour :	11	11
P.H.F. :	0.46	0.46
PH Begins :	9:00am	9:00am

Mid (10am-2pm) Peak Volumes

15 Minute :	9	9
One Hour :	18	18
P.H.F. :	0.90	0.90
PH Begins :	10:30am	10:30am

PM (2pm-12am) Peak Volumes

15 Minute :  
 One Hour :  
 P.H.F. :  
 PH Begins :

TOTAL 24 Hrs = 150

# Directional 24 Hour Volume Report: 530 MULBERRY

Info Line 1 :  
 Info Line 2 :  
 GPS Lat/Lon :

Last Connected Device Type : Apollo  
 Serial Number :  
 # Lanes : 1

## Directional 24 Hour Volume Data For: August 23, 2021 (Mon)

Time	1	TOTAL
<b>- AM -</b>		
12 - 1		
1 - 2		
2 - 3		
3 - 4		
4 - 5		
5 - 6		
6 - 7		
7 - 8		
8 - 9		
9 - 10		
10 - 11		
11 - 12		
<b>- PM -</b>		
12 - 1	54	54
1 - 2	53	53
2 - 3	90	90
3 - 4	88	88
4 - 5	85	85
5 - 6	105	105
6 - 7	89	89
7 - 8	72	72
8 - 9	54	54
9 - 10	59	59
10 - 11	38	38
11 - 12	29	29

**TOTALS :** 816 **816**  
 % Total : 100.0%

### AM (12am-10am) Peak Volumes

15 Minute :  
 One Hour :  
 P.H.F. :  
 PH Begins :

### Mid (10am-2pm) Peak Volumes

15 Minute : 20 20  
 One Hour : 54 54  
 P.H.F. : 0.68 0.68  
 PH Begins : 12:00pm 12:00pm

### PM (2pm-12am) Peak Volumes

15 Minute : 35 35  
 One Hour : 105 105  
 P.H.F. : 0.88 0.88  
 PH Begins : 2:15pm 2:15pm

**Directional 24 Hour Volume Data For: August 24, 2021 (Tue)**

Time	1	TOTAL
<b>- AM -</b>		
12 - 1	12	12
1 - 2	3	3
2 - 3	1	1
3 - 4	2	2
4 - 5	9	9
5 - 6	26	26
6 - 7	63	63
7 - 8	53	53
8 - 9	50	50
9 - 10	49	49
10 - 11	72	72
11 - 12	85	85
<b>- PM -</b>		
12 - 1	<del>55</del>	<del>55</del>
1 - 2	0	0
2 - 3	0	0
3 - 4	0	0
4 - 5	0	0
5 - 6	0	0
6 - 7	0	0
7 - 8	0	0
8 - 9	0	0
9 - 10	0	0
10 - 11	0	0
11 - 12	0	0

**TOTALS :** 480 **480**  
 % Total : 100.0%

AM (12am-10am) Peak Volumes

15 Minute :	24	24
One Hour :	68	68
P.H.F. :	0.89	0.89
PH Begins :	6:15am	6:15am

Mid (10am-2pm) Peak Volumes

15 Minute :	27	27
One Hour :	88	88
P.H.F. :	0.88	0.88
PH Begins :	10:30am	10:30am

PM (2pm-12am) Peak Volumes

15 Minute :	0	0
One Hour :	0	0
P.H.F. :		
PH Begins :		

**TOTAL 24 H1Z = 1,241**



# Directional 24 Hour Volume Report: SHERMAN

Info Line 1 :  
 Info Line 2 :  
 GPS Lat/Lon :

Last Connected Device Type : Apollo  
 Serial Number :  
 # Lanes : 1

## Directional 24 Hour Volume Data For: August 10, 2021 (Tue)

Time	1	TOTAL
<b>- AM -</b>		
12 - 1		
1 - 2		
2 - 3		
3 - 4		
4 - 5		
5 - 6		
6 - 7		
7 - 8		
8 - 9		
9 - 10	2	2
10 - 11	4	4
11 - 12	17	17
<b>- PM -</b>		
12 - 1	7	7
1 - 2	25	25
2 - 3	8	8
3 - 4	3	3
4 - 5	2	2
5 - 6	1	1
6 - 7	4	4
7 - 8	1	1
8 - 9	2	2
9 - 10	0	0
10 - 11	0	0
11 - 12	1	1

**TOTALS :** 77 77  
 % Total : 100.0%

### AM (12am-10am) Peak Volumes

15 Minute :	2	2
One Hour :	2	2
P.H.F. :	0.25	0.25
PH Begins :	8:45am	8:45am

### Mid (10am-2pm) Peak Volumes

15 Minute :	13	13
One Hour :	25	25
P.H.F. :	0.48	0.48
PH Begins :	1:00pm	1:00pm

### PM (2pm-12am) Peak Volumes

15 Minute :	3	3
One Hour :	8	8
P.H.F. :	0.67	0.67
PH Begins :	1:45pm	1:45pm

**Directional 24 Hour Volume Data For: August 11, 2021 (Wed)**

Time	1	TOTAL
<b>- AM -</b>		
12 - 1	0	0
1 - 2	0	0
2 - 3	1	1
3 - 4	0	0
4 - 5	1	1
5 - 6	0	0
6 - 7	0	0
7 - 8	1	1
8 - 9	3	3
9 - 10	<del>1</del>	<del>1</del>
10 - 11		
11 - 12		
<b>- PM -</b>		
12 - 1		
1 - 2		
2 - 3		
3 - 4		
4 - 5		
5 - 6		
6 - 7		
7 - 8		
8 - 9		
9 - 10		
10 - 11		
11 - 12		

**TOTALS :** 7 **7**  
 % Total : 100.0%

AM (12am-10am) Peak Volumes

15 Minute :	1	1
One Hour :	3	3
P.H.F. :	0.75	0.75
PH Begins :	7:30am	7:30am

Mid (10am-2pm) Peak Volumes

15 Minute :  
 One Hour :  
 P.H.F. :  
 PH Begins :

PM (2pm-12am) Peak Volumes

15 Minute :  
 One Hour :  
 P.H.F. :  
 PH Begins :

TOTAL 24 H12 = 83

# Directional 24 Hour Volume Report: SOUTH 2021

Info Line 1 :  
 Info Line 2 :  
 GPS Lat/Lon :

Last Connected Device Type : Apollo  
 Serial Number :  
 # Lanes : 1

## Directional 24 Hour Volume Data For: August 18, 2021 (Wed)

Time	1	TOTAL
<b>- AM -</b>		
12 - 1		
1 - 2		
2 - 3		
3 - 4		
4 - 5		
5 - 6		
6 - 7		
7 - 8		
8 - 9		
9 - 10	1	1
10 - 11	7	7
11 - 12	8	8
<b>- PM -</b>		
12 - 1	7	7
1 - 2	6	6
2 - 3	9	9
3 - 4	9	9
4 - 5	12	12
5 - 6	9	9
6 - 7	11	11
7 - 8	9	9
8 - 9	6	6
9 - 10	1	1
10 - 11	1	1
11 - 12	1	1

**TOTALS :** 97 97  
 % Total : 100.0%

### AM (12am-10am) Peak Volumes

15 Minute :	1		1
One Hour :	1		1
P.H.F. :	0.25		0.25
PH Begins :	8:45am		8:45am

### Mid (10am-2pm) Peak Volumes

15 Minute :	4		4
One Hour :	10		10
P.H.F. :	0.63		0.63
PH Begins :	11:15am		11:15am

### PM (2pm-12am) Peak Volumes

15 Minute :	5		5
One Hour :	13		13
P.H.F. :	0.81		0.81
PH Begins :	3:45pm		3:45pm

**Directional 24 Hour Volume Data For: August 19, 2021 (Thu)**

Time	1	TOTAL
<b>- AM -</b>		
12 - 1	2	2
1 - 2	0	0
2 - 3	0	0
3 - 4	0	0
4 - 5	0	0
5 - 6	0	0
6 - 7	2	2
7 - 8	4	4
8 - 9	1	1
9 - 10		
10 - 11		
11 - 12		
<b>- PM -</b>		
12 - 1		
1 - 2		
2 - 3		
3 - 4		
4 - 5		
5 - 6		
6 - 7		
7 - 8		
8 - 9		
9 - 10		
10 - 11		
11 - 12		

**TOTALS :** 9 **9**  
 % Total : 100.0%

AM (12am-10am) Peak Volumes

15 Minute :	3	3
One Hour :	5	5
P.H.F. :	0.42	0.42
PH Begins :	6:30am	6:30am

Mid (10am-2pm) Peak Volumes

15 Minute :  
 One Hour :  
 P.H.F. :  
 PH Begins :

PM (2pm-12am) Peak Volumes

15 Minute :  
 One Hour :  
 P.H.F. :  
 PH Begins :

TOTAL 24 HRZ = 106

# Directional 24 Hour Volume Report: 223 WHITE

Info Line 1 :  
 Info Line 2 :  
 GPS Lat/Lon :

Last Connected Device Type : Apollo  
 Serial Number :  
 # Lanes : 1

## Directional 24 Hour Volume Data For: August 17, 2021 (Tue)

Time	1	TOTAL
<b>- AM -</b>		
12 - 1		
1 - 2		
2 - 3		
3 - 4		
4 - 5		
5 - 6		
6 - 7		
7 - 8		
8 - 9		
9 - 10	20	20
10 - 11	20	20
11 - 12	38	38
<b>- PM -</b>		
12 - 1	34	34
1 - 2	26	26
2 - 3	31	31
3 - 4	46	46
4 - 5	31	31
5 - 6	34	34
6 - 7	17	17
7 - 8	20	20
8 - 9	16	16
9 - 10	7	7
10 - 11	12	12
11 - 12	5	5

**TOTALS :** 357 357  
 % Total : 100.0%

### AM (12am-10am) Peak Volumes

15 Minute :	7		7
One Hour :	20		20
P.H.F. :	0.71		0.71
PH Begins :	9:00am		9:00am

### Mid (10am-2pm) Peak Volumes

15 Minute :	12		12
One Hour :	39		39
P.H.F. :	0.89		0.89
PH Begins :	11:30am		11:30am

### PM (2pm-12am) Peak Volumes

15 Minute :	17		17
One Hour :	46		46
P.H.F. :	0.68		0.68
PH Begins :	3:00pm		3:00pm

**Directional 24 Hour Volume Data For: August 18, 2021 (Wed)**

Time	1	TOTAL
<b>- AM -</b>		
12 - 1	5	5
1 - 2	2	2
2 - 3	3	3
3 - 4	1	1
4 - 5	3	3
5 - 6	2	2
6 - 7	21	21
7 - 8	36	36
8 - 9	20	20
9 - 10	2	2
10 - 11		
11 - 12		
<b>- PM -</b>		
12 - 1		
1 - 2		
2 - 3		
3 - 4		
4 - 5		
5 - 6		
6 - 7		
7 - 8		
8 - 9		
9 - 10		
10 - 11		
11 - 12		

**TOTALS :** 95 **95**  
 % Total : 100.0%

AM (12am-10am) Peak Volumes

15 Minute :	12	12
One Hour :	36	36
P.H.F. :	0.75	0.75
PH Begins :	6:45am	6:45am

Mid (10am-2pm) Peak Volumes

15 Minute :  
 One Hour :  
 P.H.F. :  
 PH Begins :

PM (2pm-12am) Peak Volumes

15 Minute :  
 One Hour :  
 P.H.F. :  
 PH Begins :

TOTAL 24 Hrs = 450

# CITY OF CLYDE 2022 PAVEMENT REPLACEMENT PROGRAM

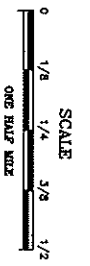
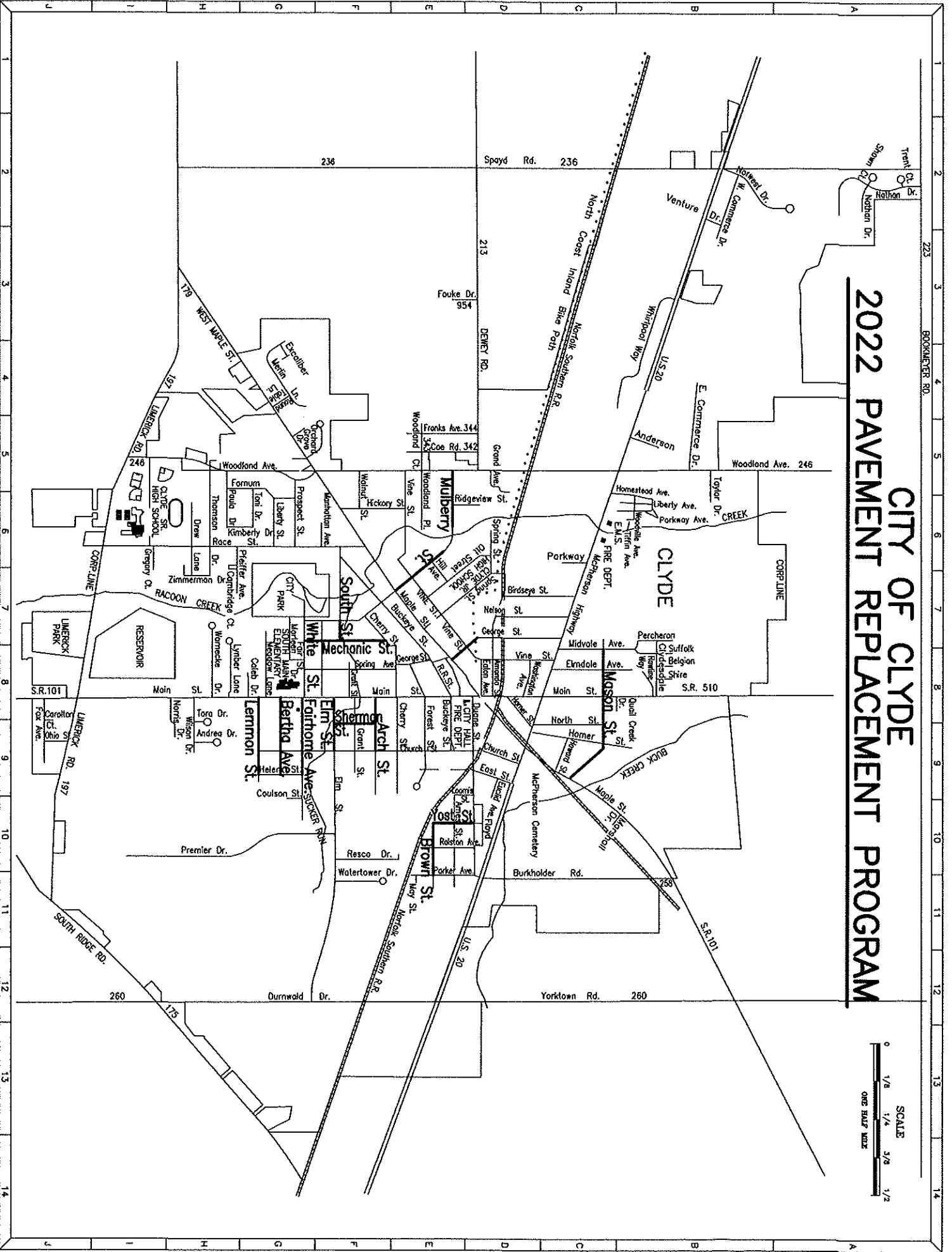



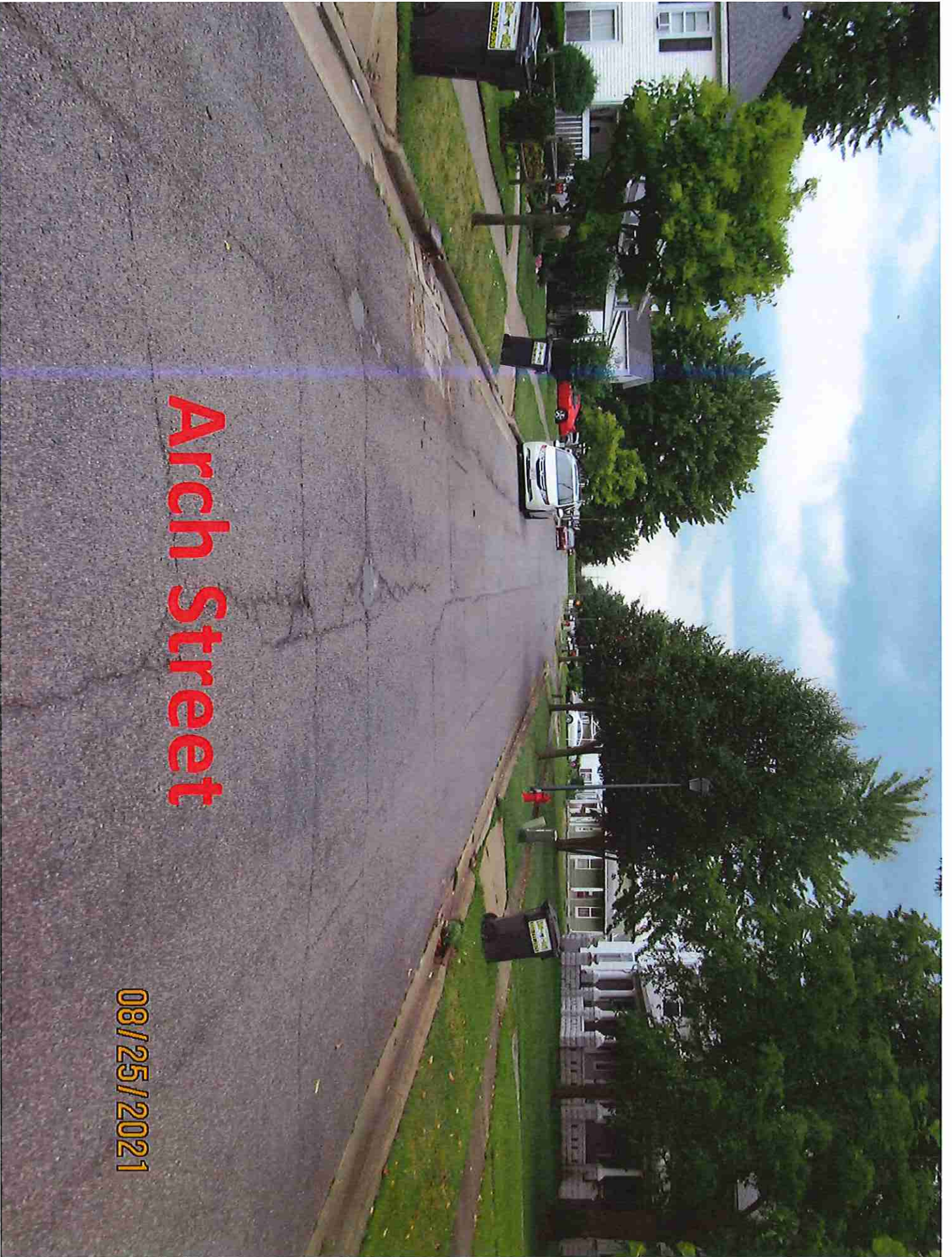

Arch Street

08/25/2021



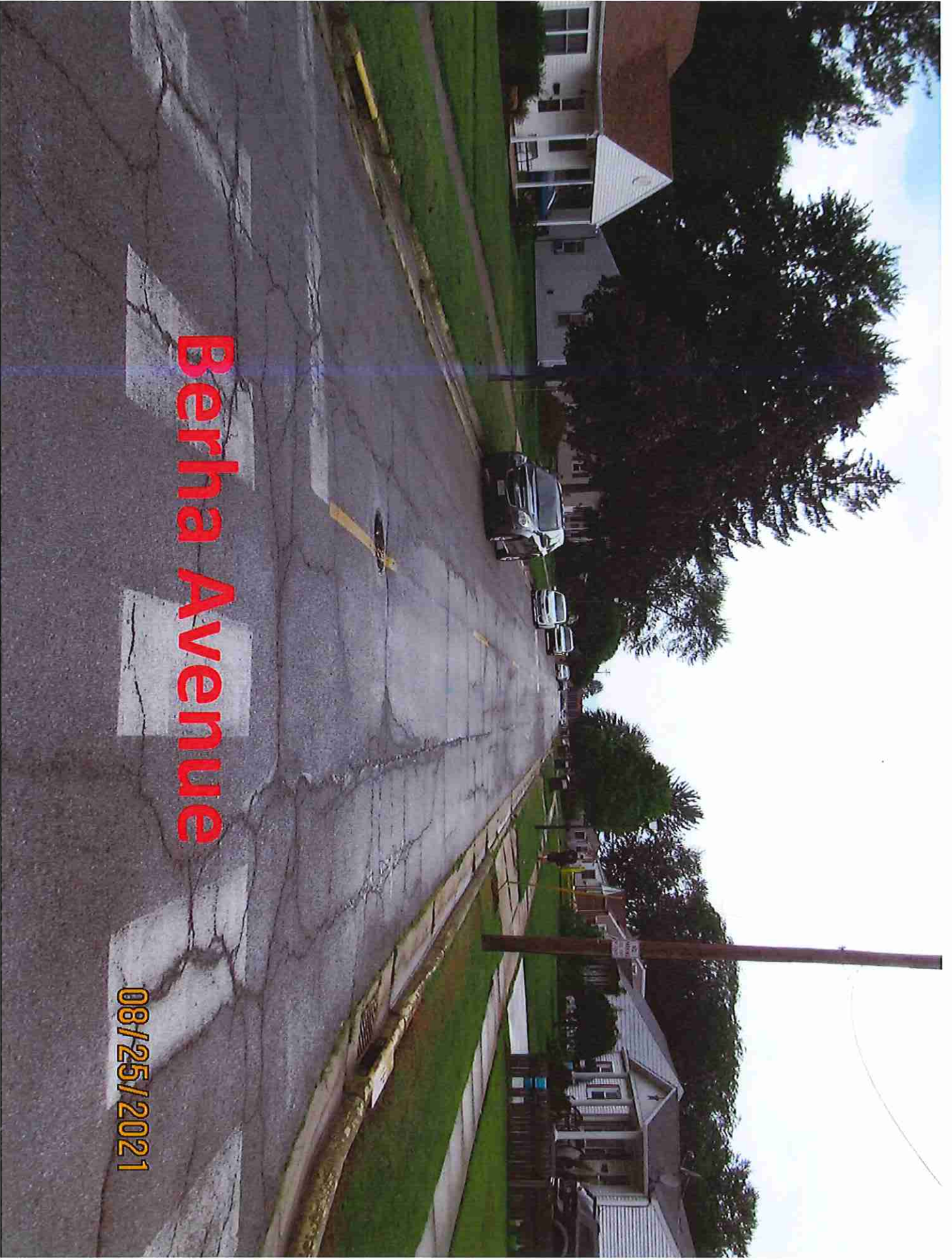

# Bertha Avenue

08/25/2021





**Brown Street**

**08/25/2021**



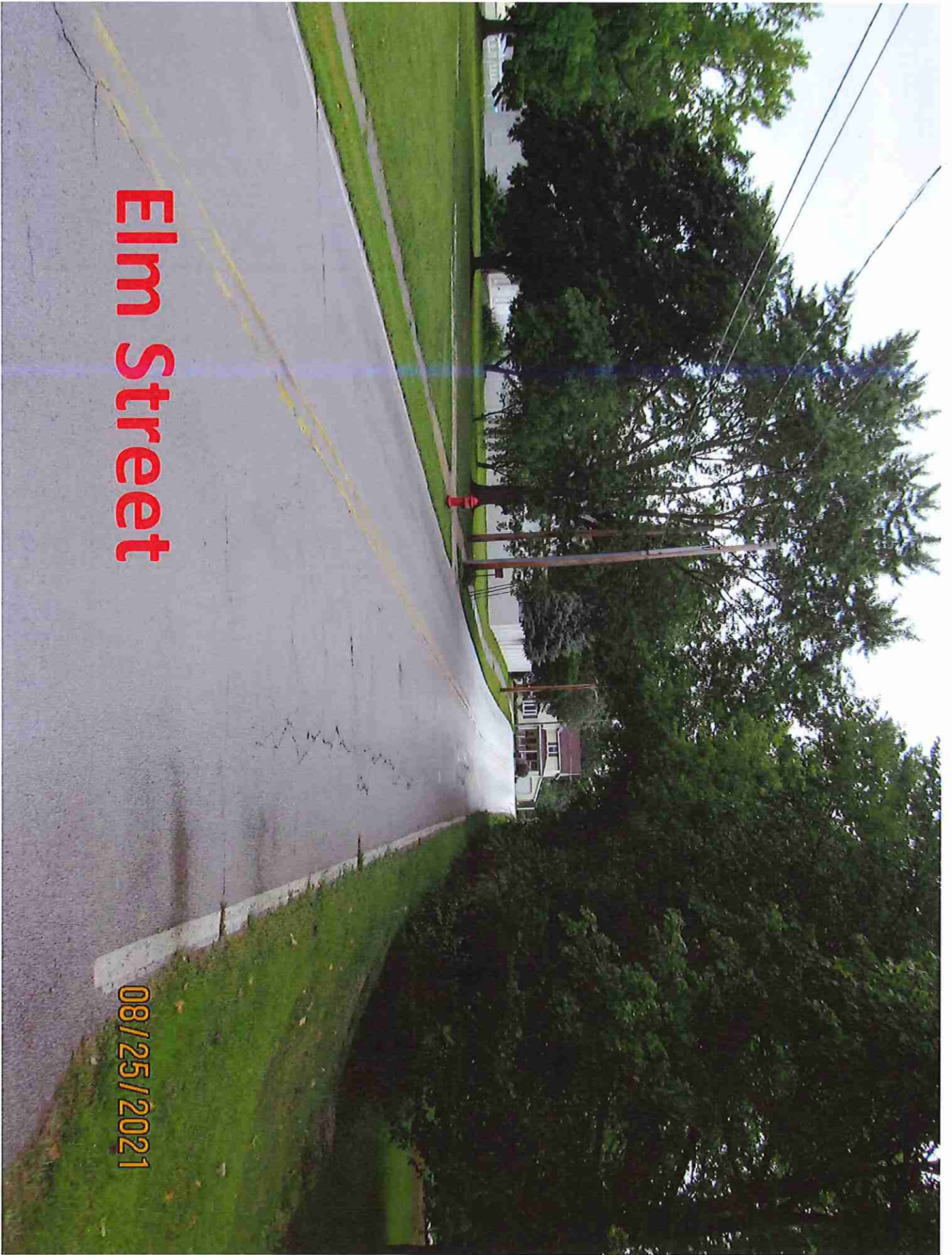

**Elm Street**

08/25/2021



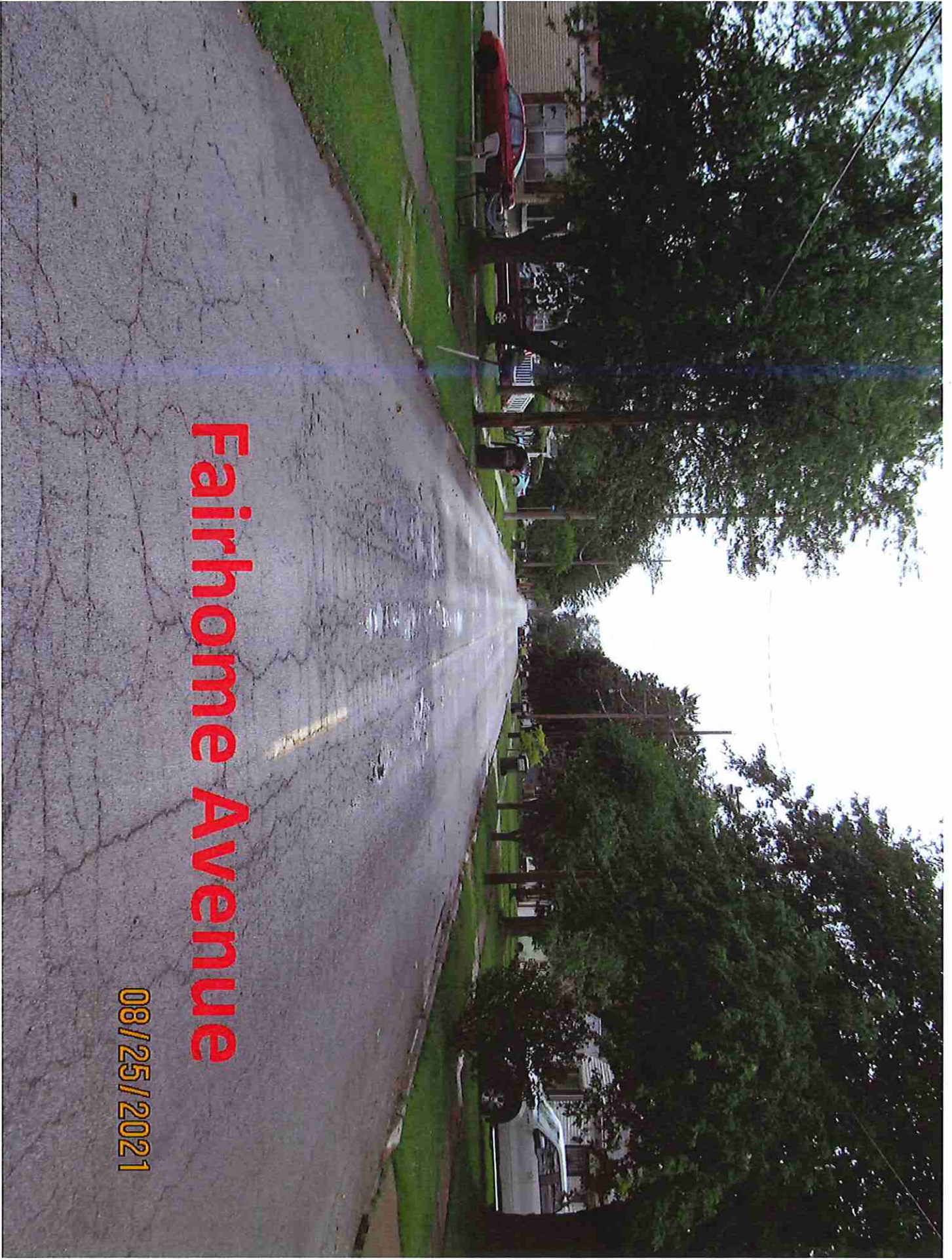

# Fairhome Avenue

08/25/2021



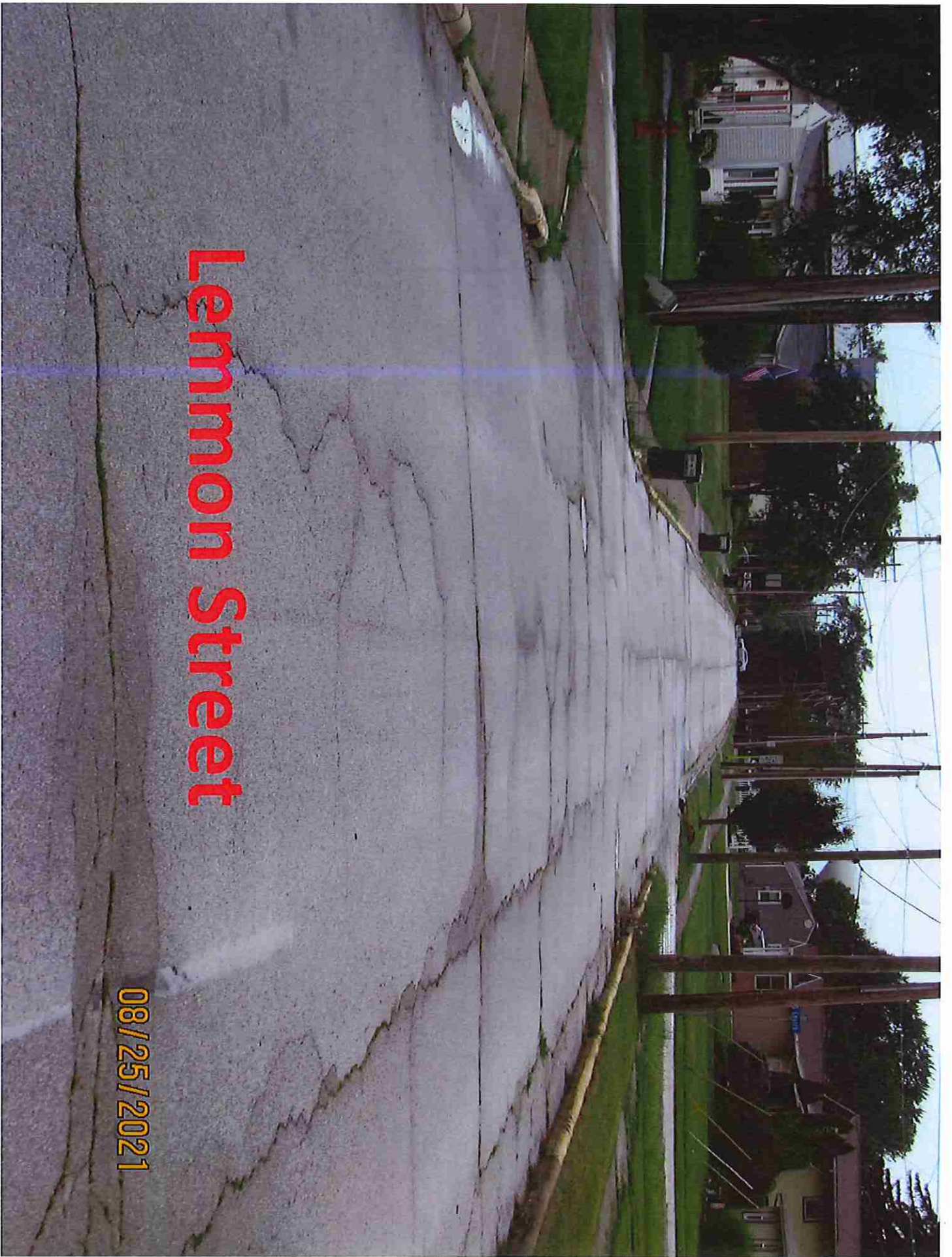

# Lemmon Street

08/25/2021



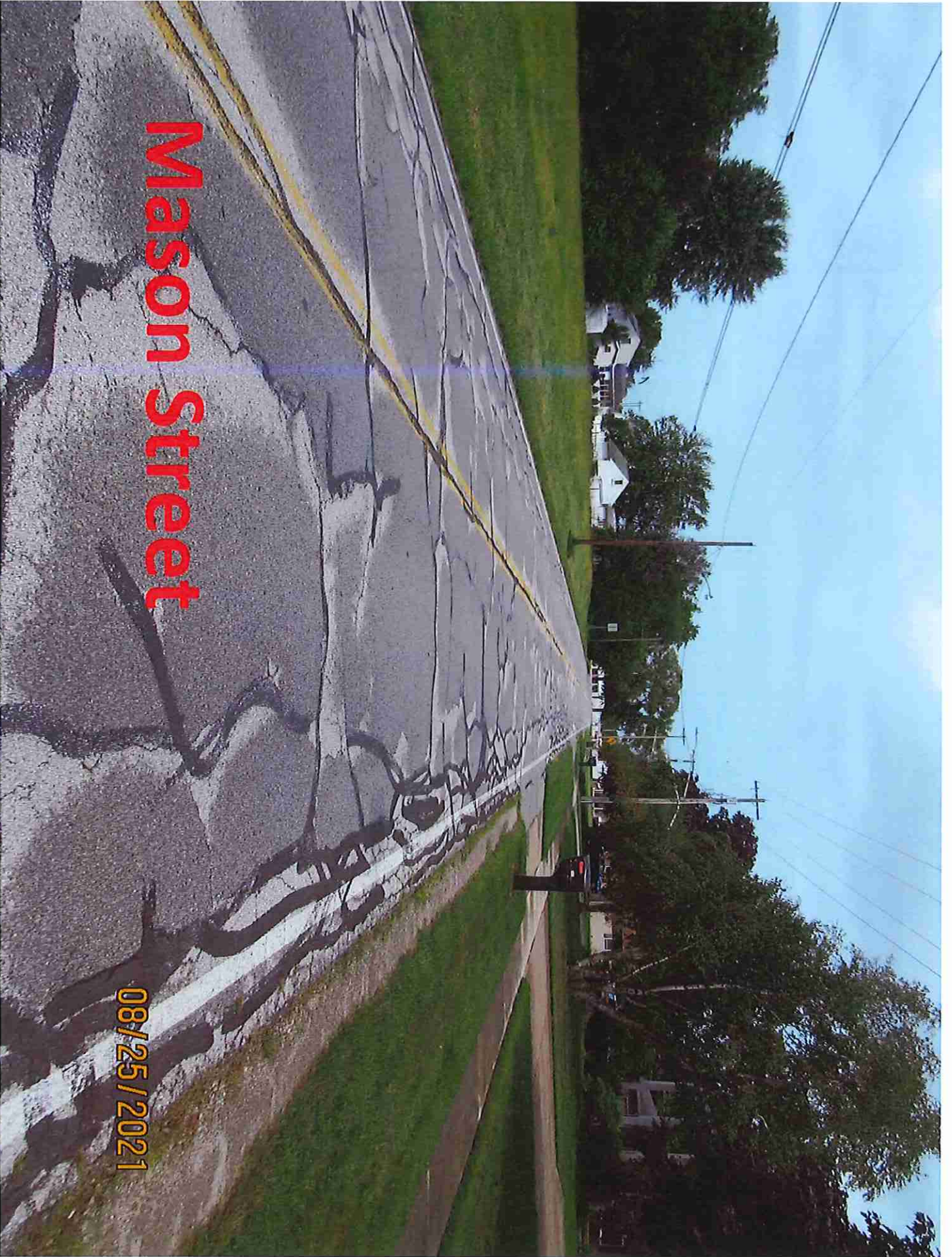

**Mason Street**

**08/25/2021**



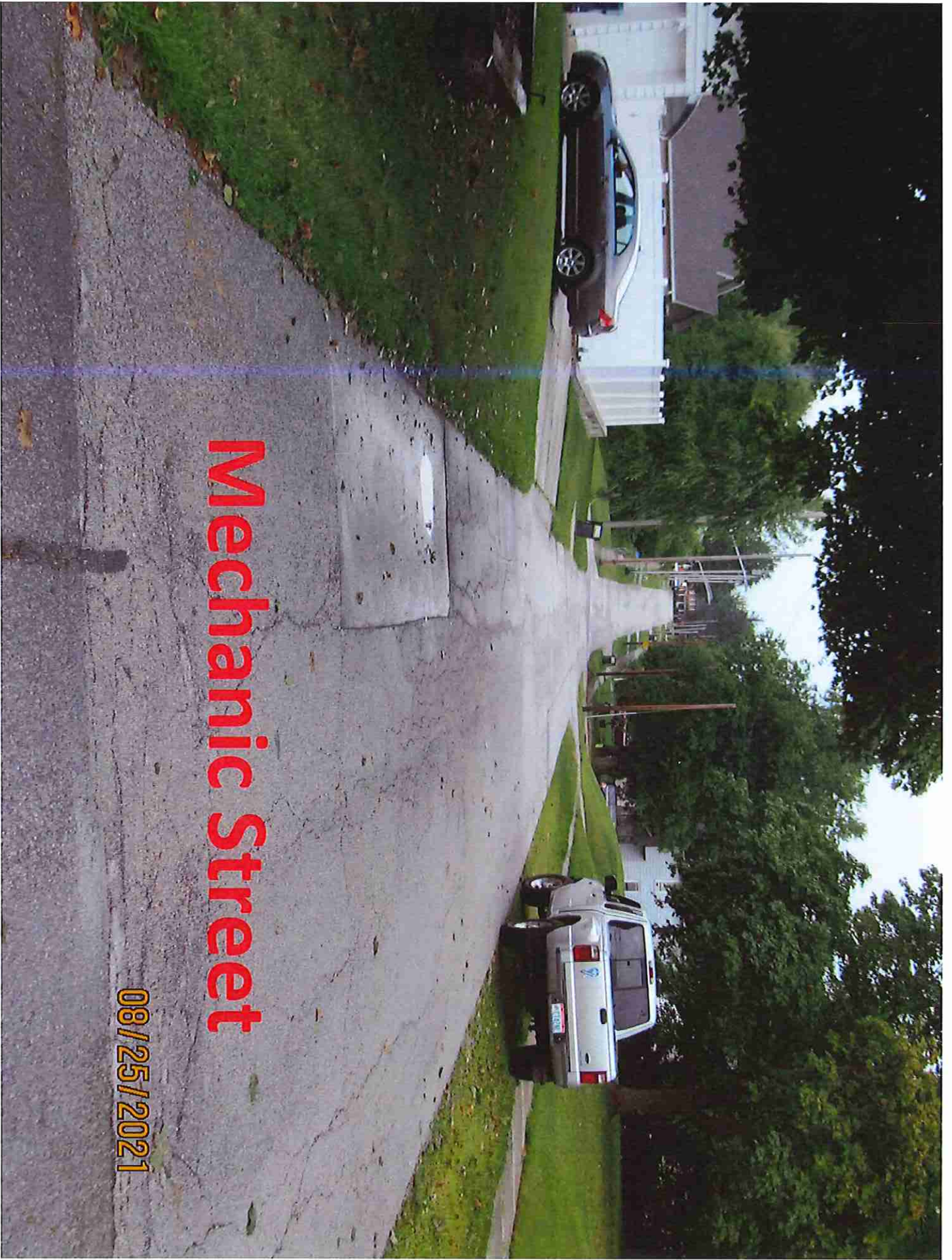

# Mechanic Street

08/25/2021



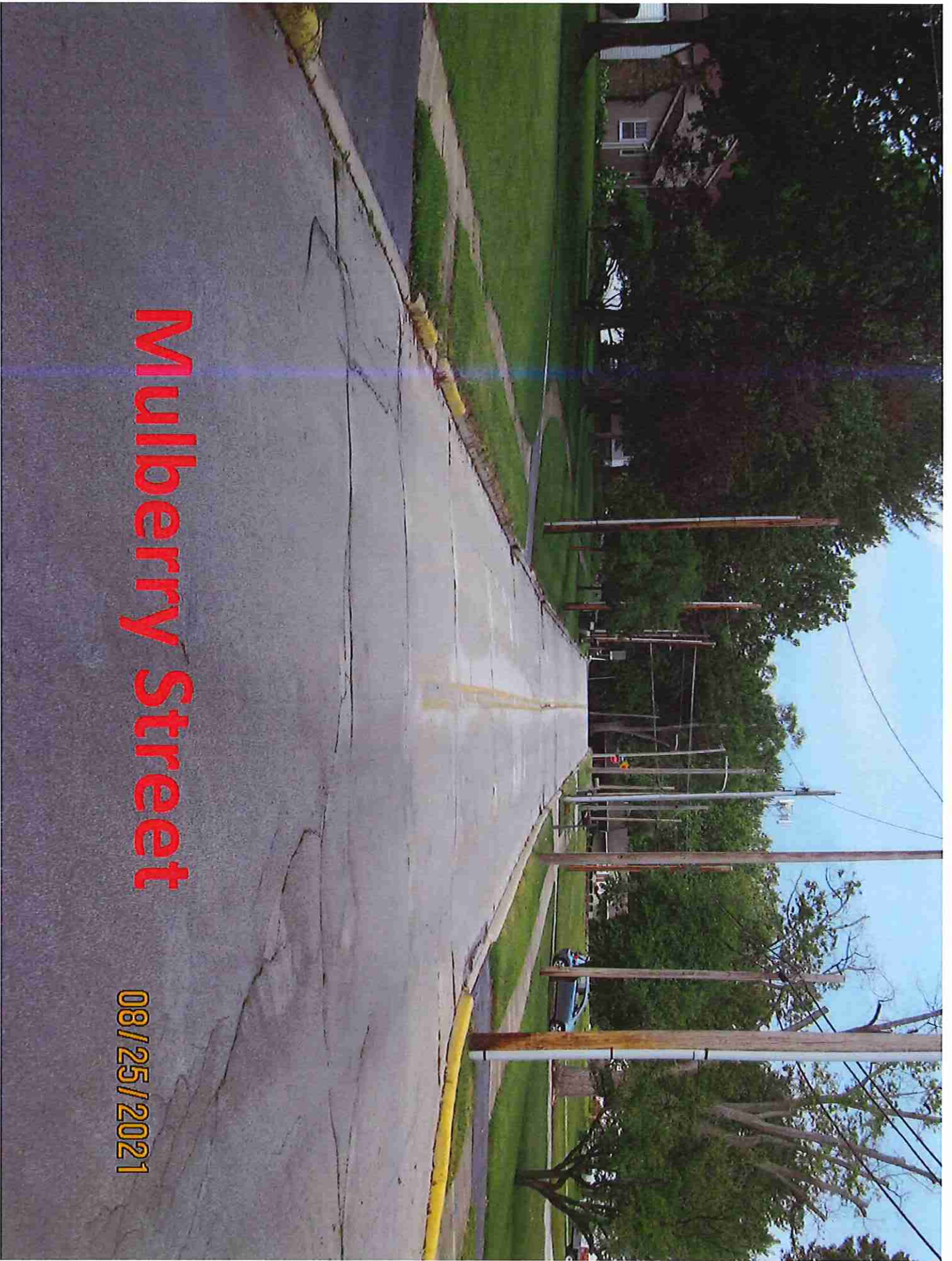

# Mulberry Street

08/25/2021



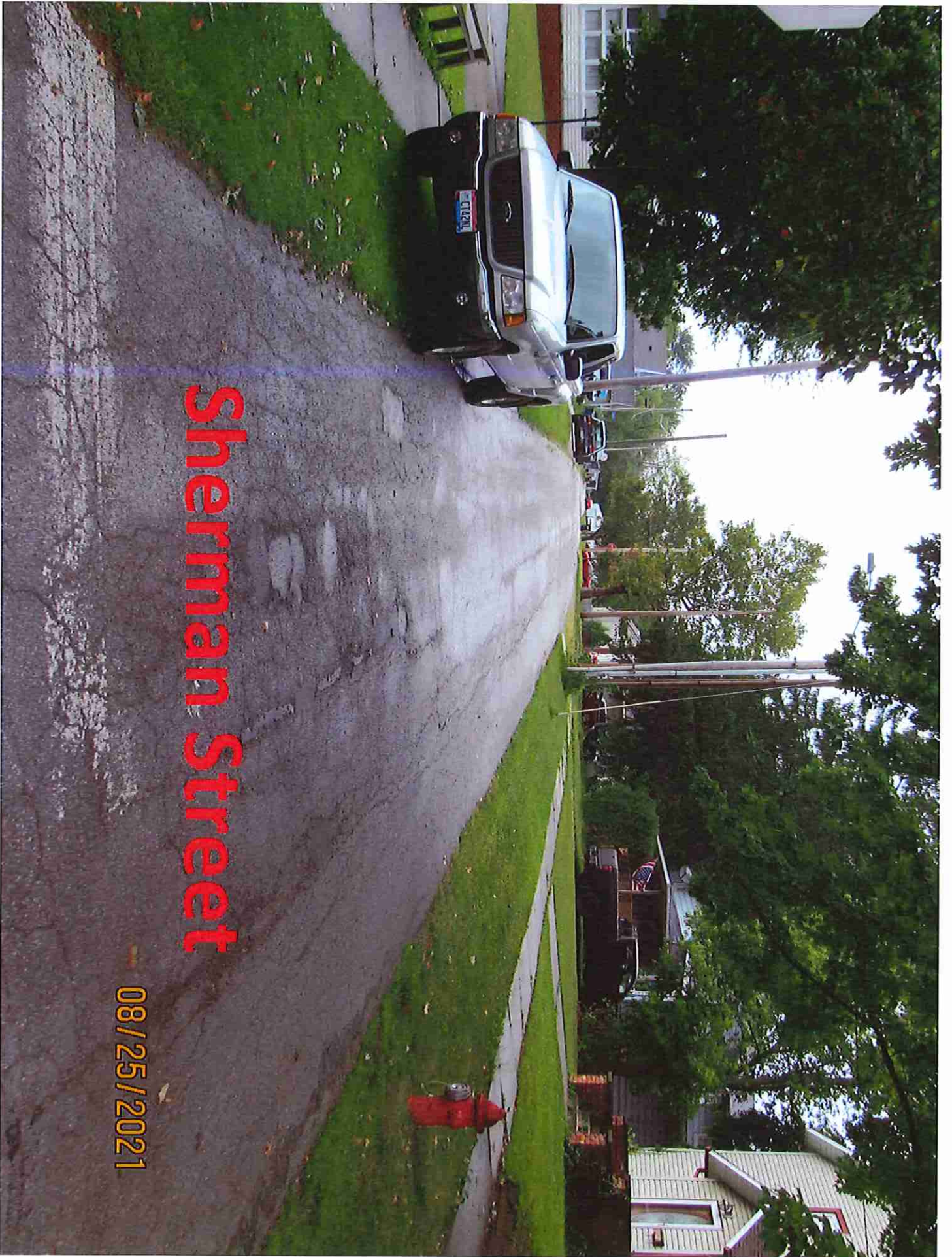

# Sherman Street

08/25/2021



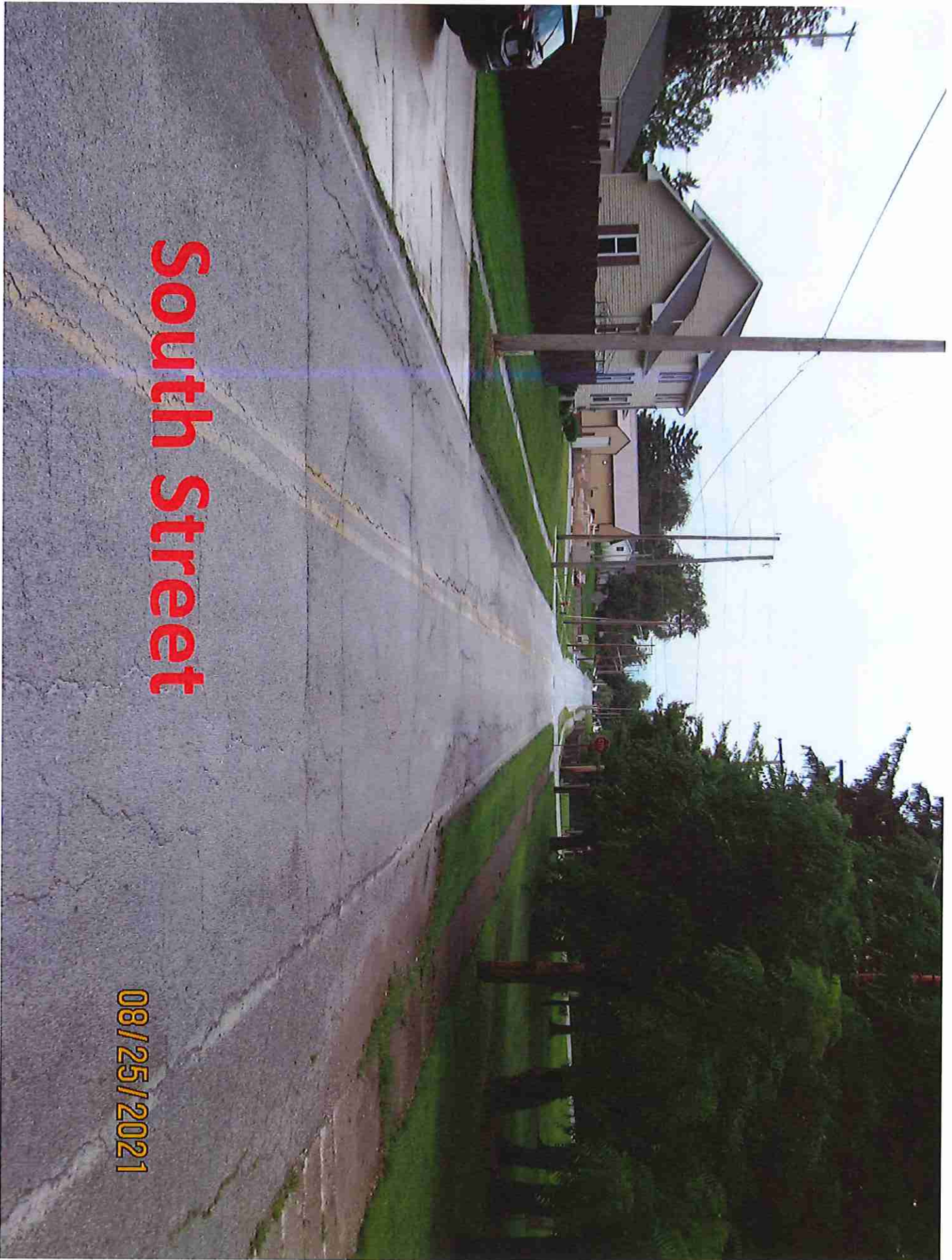

# South Street

08/25/2021





**White Street**

**08/25/2021**



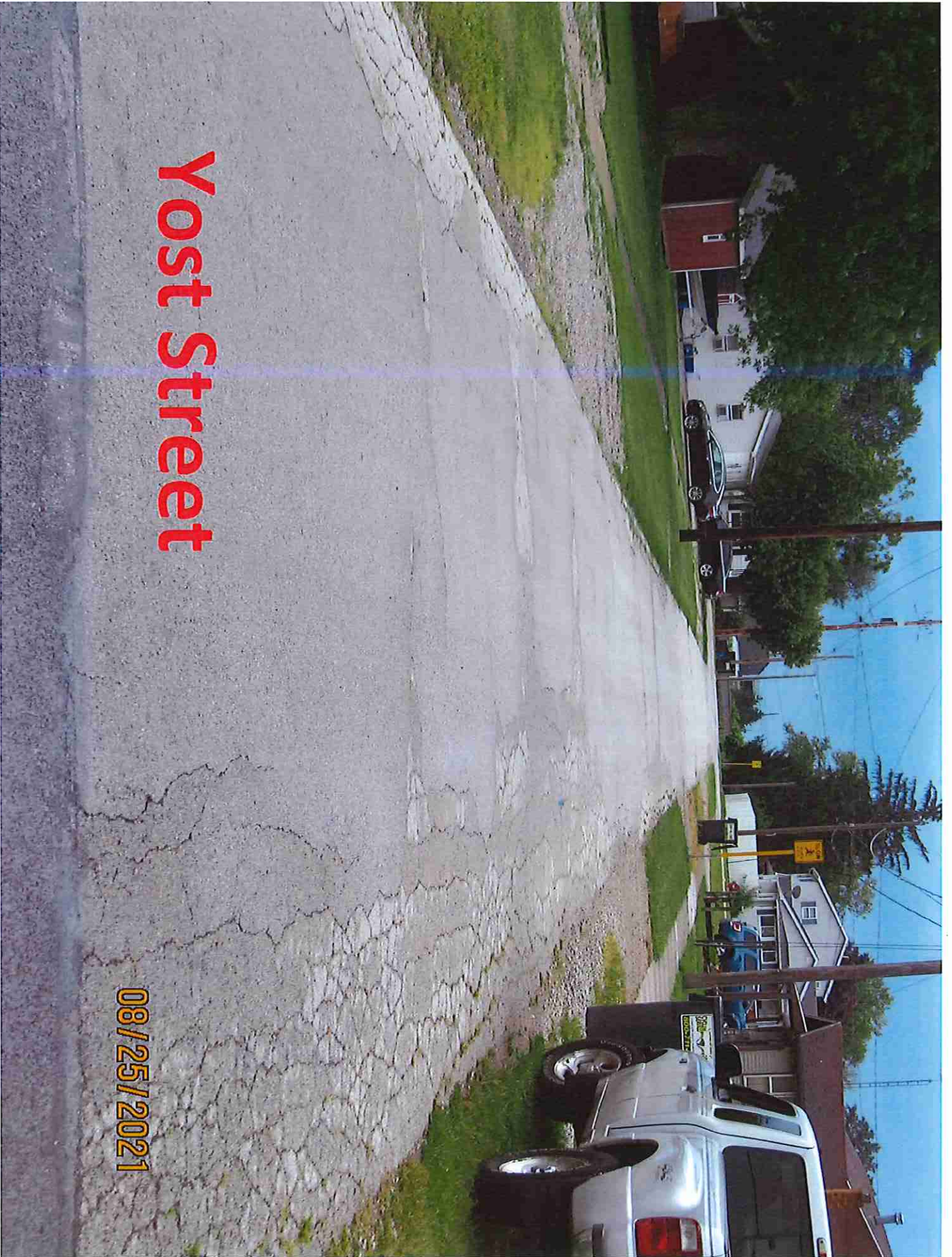

# Yost Street

08/25/2021

**DISTRICT 5  
CAPITAL IMPROVEMENT PROJECTS  
QUESTIONNAIRE  
ROUND 36**

Name of Applicant: City of Clyde, Ohio  
 Project Title: 2022 Pavement Replacement Program

The following questions are to be answered for each application submitted for State Issue II SCIP, LTIP and Loan Projects. Please provide specific information using the best documentation available to you. Justification of your responses to these questions will be required if your project is selected for funding, so please provide correct and accurate responses. **Villages and Townships under 5,000 in population should also complete the Small Government Criteria.**

1. What percentage of the project in repair A=100%, replacement B= \_\_%, expansion C= \_\_%, and new D= \_\_%? (Use dollar amounts of project to figure percentages and make sure the total equals one hundred(100) percent) A+B= \_\_% C+D= \_\_% **ORC Reference(s):164.06(B)(1); 164.14(E)(10)**

Repair/Replacement = Repair or Replacement of public facilities owned by the government (any subdivision of the state).

New/Expansion = Replacement of privately owned wells, septic systems, private water or wastewater systems, etc.

- 2a. Existing Physical Condition of Infrastructure **ORC Reference(s):164.06(B)(2);164.14(E)(9);164.14(E)(2); 164.14(E)(8)**

Points	Category	Description	Examples
10	Failing	Infrastructure has reached a point where it requires replacement, reconstruction or reconfiguration to fulfill its purpose	-Intersection Reconfiguration due to accident problem- Structural paving of 3.5" or greater of additional pavement - Pavement Widening to meet ODOT L&D Standards - Complete Pavement Reconstruction - Water or Sewer Line Replacement - Water or Sewer Plant Replacement - Widening graded shoulder width to ODOT L&D Standard -Complete Bridge or Culvert replacement- Replacement of a major component of a water and/or sewer treatment plant which would result in a failure in meeting WQ Standards
8	Poor	The condition is substandard and requires repair or restoration in order to return to the intended level of service and comply with current design standards. Infrastructure contains deficiency and is functioning at a diminished capacity.	-Multiple course of paving - Structural Culvert Lining - Bridge Deck Replacement - Replacement of a component such as a control mechanism, pumps, hydrants, valves, filters,

			etc of a water or sewer plant - Single course of paving with 25% base repair-Widening graded shoulder width to less than ODOT L&D Standard
6	Fading  X	The condition requires reconditioning to continue to function as originally intended.	-Single course of paving -Sewer Lining Projects -Water tower painting -Repair of a tank to maintain structural integrity in existing water and sewer systems-Widening aggregate berm on existing graded shoulder width
4	Fair	The condition is average, not good or poor. The infrastructure is still functioning as originally intended. Minor deficiencies exist requiring repair to continue to function as originally intended and/or to meet current design standards	
2	Good	The condition is safe and suitable to purpose. Infrastructure is functioning as originally intended, but requires minor repairs and/or upgrades to meet current design standards	
0	Excellent	The condition is new or requires no repair. Or, no supporting documentation has been submitted	

2b. Age of Infrastructure ORC Reference(s):164.06(B)(2)

Life	20	30	50
Project Type	Road	Wastewater and Water Treatment	Bridge/Culvert, Sanitary Sewer, Water Supply, Storm Water, Solid Waste
Points			
0	0-4 Years	0-6 Years	0-10 Years
1	5-8 Years	7-12 Years	11-20 Years
2	9-12 Years	13-18 Years	21-30 Years
3	13-16 Years	19-24 Years	31-40 Years
X 4	17-20 Years	25-30 Years	41-50 Years
5	20+ Years	30+ Years	50+ Years

3. Health and Safety Rating: ORC Reference(s):164.06(B)(4),164.14(E)(1); 164.14(E)(10)

If the proposed project is not approved what category would best represent the impact on the general health and/or public safety?



## ROADS

- Extremely Critical: Resurfacing, Restoration, Rehabilitation and Reconstruction (4R) of a Major Access Road.\*
- X** Critical: Resurfacing, Restoration and Rehabilitation (3R) of a Major Access Road.\*
- Major: Resurfacing, Restoration, Rehabilitation and Reconstruction (4R) of a Minor Access Road.\*
- Moderate: Resurfacing, Restoration and Rehabilitation (3R) of a Minor Access Road.\*
- Minimal: Preventative Maintenance of a Major Access Road.
- No Impact: Preventative Maintenance of a Minor Access Road.

Projects that have a variety of work will be scored in the LOWEST category of work contained in the Construction Estimate.

### *Road/Street Classifications:*

- X** *Major Access Road:* Roads or streets that have a dual function of providing access to adjacent properties and providing through or connecting service between other roads.
- Minor Access Road:* Roads or streets that primarily provide access to adjacent properties without through continuity, such as cul-de-sacs or loop roads or streets.
- Preventative Maintenance:* Non Structural Pavement work such as chip sealing, cape sealing, micro-surfacing, crack sealing, etc.

\*(3R) Resurfacing, Restoration and Rehabilitation - Improvements to existing roadways, which have as their main purpose, the restoration of the physical features (pavement, curb, guardrail, etc.) without altering the original design elements. (Surface and Intermediate layer Mill and Fills, overlays with less than or equal to 3.5" of additional pavement, etc....)

\*(4R) Resurfacing, Restoration, Rehabilitation and Reconstruction - Much like 3R, except that 4R allows for the complete reconstruction of the roadway and alteration of certain design elements (i.e., lane widths, shoulder width, SSD, overlays with greater than 3.5" of additional pavement. etc.).

## BRIDGES SUFFICIENCY RATING

- Extremely Critical: 0-25, or a General Appraisal rating of 3 or less.
- Critical: 27-50, or a General Appraisal rating of 4.
- Major: 51-65 or a General Appraisal rating of 5 or 6.
- Moderate: 66-80 or a General Appraisal rating of 7.
- Minimal: 81-100 or a General Appraisal rating of more than 7.
- No Impact: Bridge on a new roadway.

## **WASTEWATER TREATMENT PLANTS**

- Extremely Critical:** Improvements required by the Environmental Protection Agency (EPA) in the form of a consent decree, finding and orders or court order, and Health Department Construction Ban.
- Critical:** Improvements required by the Environmental Protection Agency (EPA) in the form of NPDES permit requirements or Notice of Violations.
- Major:** Replace deficient appurtenances. Update existing processes due to EPA recommendations.
- Moderate:** Increase capacity to meet current needs or update processes to improve effluent quality.
- Minimal:** New/Expansion project to meet a specific development proposal.
- No Impact:** New/Expansion to meet future or projected needs.

## **WATER TREATMENT PLANT**

- Extremely Critical:** EPA orders in the form of a consent decree, findings and orders or court order.
- Critical:** Improvements to meet Environmental Protection Agency (EPA) Safe Drinking Water Regulations and/or Notice of Violations.
- Major:** Replace deficient appurtenances. Update existing processes due to EPA recommendations.
- Moderate:** Increase capacity to meet current needs or update processes to improve water quality.
- Minimal:** New/Expansion project to meet a specific development proposal.
- No Impact:** New/Expansion to meet future or projected needs.

## **COMBINED SEWER SEPARATIONS** (May be construction of either new storm or sanitary sewer as long as the result is two separate sewer systems.)

- Extremely Critical:** EPA orders in the form of a consent decree, findings and orders or court order. Health Department Construction Ban.
- Critical:** Separate, due to chronic backup or flooding in basements.
- Major:** Separate, due to documented water quality impairment, or due to EPA recommendations.
- Moderate:** Separate, due to specific development proposal within or upstream of the combined system area.
- Minimal:** Separate, to conform to current design standards.
- No Impact:** No positive health effect.

## **STORM SEWERS**

- Extremely Critical:** Improvements ordered by the Environmental Protection Agency (EPA) in the form of a consent decree, findings and orders or court order.

Critical:	Chronic flooding (structure damage) or improvements required by the Environmental Protection Agency (EPA) in the form of NPDES permit requirements or Notice of Violations.
Major:	Inadequate capacity (land damage).
Moderate:	Inadequate capacity with no associated damage.
Minimal:	New/Expansion to meet current needs.
No Impact:	New/Expansion to meet future or project needs.

### **CULVERTS**

Extremely Critical:	Structurally deficient or functionally obsolete. Deterioration has already caused a critical safety hazard to the public.
Critical:	Inadequate capacity with land damage and the existing or high probability of property damage.
Major:	Inadequate capacity (land damage).
Moderate:	Inadequate capacity with no associated damage.
Minimal:	New/Expansion to meet current needs.
No Impact:	New/Expansion to meet future or projected needs.

### **SANITARY SEWERS**

Extremely Critical:	EPA orders in the form of a consent decree, findings and orders or court order. Health Department Construction Ban.
Critical:	Replace, due to chronic pipe failure, chronic backup or flooding in basements, sewer system overflows, and/or improvements required by the Environmental Protection Agency (EPA) in the form of NPDES permit requirements or Notice of Violations.
Major:	Replace, due to inadequate capacity or infiltration, or due to EPA recommendations.
Moderate:	Rehabilitate to increase capacity to meet current needs or to reduce inflow and infiltration.
Minimal:	New/Expansion project to meet a specific development proposal.
No Impact:	New/Expansion to meet future or projected needs.

### **SANITARY LIFT STATIONS AND FORCE MAINS**

Extremely Critical:	Structurally deficient. Deterioration has already caused a safety/health hazard to the public, or; EPA orders in the form of a consent decree, findings and orders or court order.
Critical:	Inadequate capacity with actual or a high probability of property damage; or improvements required by the Environmental Protection Agency (EPA) in the



form of NPDES permit requirements.

- Major: EPA recommendations, or; reduces a probable health and/or safety problem.
- Moderate: Rehabilitate to increase capacity to meet current needs.
- Minimal: New/Expansion to meet a specific development proposal.
- No Impact: New/Expansion to meet future or projected needs.

### **WATER PUMP STATIONS**

- Extremely Critical: Structurally deficient. Deterioration has already caused a safety hazard to the public, or, EPA orders in the form of a consent decree, findings and orders or court order.
- Critical: Inadequate capacity with the inability to maintain pressure required for fire flows.
- Major: Replace due to inadequate capacity or EPA recommendations.
- Moderate: Rehabilitate to increase capacity to meet current needs.
- Minimal: New/Expansion to meet a specific development proposal.
- No Impact: New/Expansion to meet future or projected needs.

### **WATER LINES/WATER TOWERS**

- Extremely Critical: Replace to solve low potable water pressure or excessive incidents of main breaks in project area.
- Critical: Replacement/Rehabilitation due to structural deficiency such as excessive corrosion and/or safety upgrades, etc.
- Major: Replace undersized water mains as part of an overall upgrade process. Replace water meters that have exceeded their useful life.
- Moderate: Increase capacity to meet current needs. Spot repairs/recoating to restore moderate corrosion of water components.
- Minimal: New/Expansion project to meet a specific development proposal.
- No Impact: New/Expansion to meet future or projected needs.

### **OTHER**

- Extremely Critical: There is a present health and/or safety threat.
- Critical: The project will provide immediate health and/or safety benefit.
- Major: The project will reduce a probable health and/or safety problem.

- Moderate:           The project will delay a health and/or safety problem.
- Minimal:            A possible future health and/or safety problem mitigation.
- No Impact:         No health and/or safety effect.

*NOTE: Combined projects that can be rated in more than one subset may be rated in the other category at the discretion of the District 5 Executive Committee. In general, the majority of the cost or scope of the project shall determine the category under which the project will be scored.*

(Submittals without supporting documentation will receive 0 Points for this question.)

Extremely Critical \_\_\_\_, Critical X, Major \_\_\_\_, Moderate \_\_\_\_, Minimal \_\_\_\_, No Impact \_\_\_\_. Explain your answer.

(Additional narrative, charts and/or pictures should be attached to questionnaire)

4. Identify the amount of local funds that will be used on the project as a percentage of the total project cost. ORC Reference 164.06(B)(6); ORC 164.06(B)(7); ORC 164.06(B)(3); ORC 164.14(E)(4)

A.) Amount of Local Funds = \$ 232,000.00

B.) Total Project Cost = \$ 407,000.00

RATIO OF LOCAL FUNDS DIVIDED by TOTAL PROJECT COSTS (A ÷ B) = 57 %

Note: Local funds should be considered funds derived from the applicant budget or loans funds to be paid back through local budget, assessments, rates or tax revenues collected by the applicant.

5. Identify the amount of other funding sources to be used on the project, excluding SCIP or LTIP Funds, as a percentage of the total project cost. ORC Reference(s): 164.06(B)(7); 164.14(E)(4)

Grants \_\_\_\_% Gifts \_\_\_\_%, Contributions \_\_\_\_%

Other \_\_\_\_% (explain) \_\_\_\_\_, Total \_\_\_\_%

Note: Grant funds and other revenues not contributed or collected through taxes by the applicant should be considered other funds. The Scope of Work for each Funding Source must be the same.

6. Total Amount of SCIP and Loan Funding Requested- An Applicant can request a grant per the categories below for points as indicated on the Priority Rating Sheet. If the Applicant is including a loan request equal to, but not exceeding 50% of the OPWC funding amounts listed below, there will be no point penalty. If loan funds requested are more than 50%, points as listed in the Priority Rating Sheet will apply. ORC Reference(s): 164.14(E)(10); 164.06(B)(5)

- \_\_\_\_\_ \$500,001 or More
- \_\_\_\_\_ \$400,001-\$500,000
- \_\_\_\_\_ \$325,001-\$400,000
- \_\_\_\_\_ \$275,001-\$325,000

X              \$175,001-\$275,000  
                  \$175,000 or Less

There are times when the District spends all of the grant money and has loan money remaining. When this happens, the district makes a loan offer in the amount of the requested grant to the communities that were not funded. The offers are made in the order of scoring. We need to know if you are not successful in obtaining grant dollars for your project if you would be interested in loan money:

YES        NO   X  

(This will only be considered if you are not funded with grant money and there is remaining loan money.) **Please note: if you answer “no” you will not be contacted, only if you answer “yes” will an offer be made in the event that there is loan money remaining.**

7. If the proposed project is funded, will its completion directly result in the creation of permanent full-time equivalent (FTE) jobs (FTE jobs shall be defined as 36 hours/week) ? Yes \_\_\_ No   X  . If yes, how many jobs within eighteen months? \_\_\_ Will the completed project retain jobs that would otherwise be permanently lost? Yes \_\_\_ No   X  . If yes, how many jobs \_\_\_ will be created/retrained within 18 months following the completion of the improvements?

**ORC Reference(s): 164.14(E)(3);164.14(E)(10)**

(Supporting documentation in the form of letter from affected industrial or commercial enterprises that specify full time equivalent jobs that will be retained or created directly by the installation or improvement of Public infrastructure. Additional items such as; 1) newspaper articles or other media news accounts, 2) public meeting minutes, and/or 3) a letter from the County Economic Development Director or State of Ohio Economic Development Professional that alludes to the requirement for the infrastructure improvement to support the business. Submittals without supporting documentation will receive 0 points for this question.)

8. What is the total number of existing users that will directly benefit from the proposed project if completed? 7,016 ADT (Use households served, traffic counts, etc. and explain the basis by which you arrived at your number.) **ORC Reference 164.14(E)(7); 164.06(B)(10)**

**2021 Traffic Counts**

9. Economic Distress Criteria **ORC Reference 164.06(B)(8)**

What is the Local Median Household Income as a percentage of the District Median Household Income?   89.89   %. Please utilize the Economic Distress Scoring Criteria based on ACS 2013-2017 Data provided in Exhibit A.

10. Readiness to Proceed Criteria **ORC Reference 164.06(B)(9); ORC 164.14(E)(5)**

Please categorize the status of planning and design elements for the project.

           Plans have not begun yet (0 Points)

\_\_\_\_\_ Preliminary Engineering Complete (1 Point)  
  X   Final Design Complete (2 Points)

11. Base Score Total for Questions 1-10=     89      
12. County Subcommittee Priority Points= \_\_\_\_\_  
(25-20-15 Points for each of the SCIP and LTIP Project Categories)

---

13. DISCRETIONARY POINTS (BY DISTRICT COMMITTEE ONLY)

13a. A **District Discretionary Point** may be awarded to projects that demonstrate significant Area-wide, County, or Community Impact. (Include documentation to support the claim of significance)  
(Maximum of 1 Point at the discretion of the District Executive Committee) \_\_\_\_\_

**ORC Reference 164.14(E)(7)**

13b. A **District Discretionary Point** may be awarded to projects that demonstrate that the entity has maximized local financial resources including assessments. Provide a Fund Status Report and/or the water and sanitary waste utility rate structures are at least 2.5% of area median household income for combined systems and 1.5% of the area median household income for water and sanitary only systems. Please provide rate ordinances for water and sanitary sewer to be considered for discretionary points. (Maximum of 1 Point at the discretion of the District 5 Executive Committee) \_\_\_\_\_ **ORC Reference 164.06(B)(3)**

14. **Grand Total of Points** \_\_\_\_\_

15. Is subdivision's population less than 5,000 Yes      No \_\_\_\_ If yes, continue. You may want to design your project per Small Government Project Evaluation Criteria, released for the current OPWC Round to assist in evaluating your project for potential Small Government Funding. The Small Government Criteria is available on the OPWC website at

<https://www.pwc.ohio.gov/Portals/0/Data/SmallGovernment%20Round%2036%20Methodology.pdf?ver=2019-08-07-071749-143>

---

16. **OHIO PUBLIC WORKS COMMISSION SMALL GOVERNMENT PROGRAM GUIDELINES**

All projects that are sponsored by a subdivision with a population of 5,000 or less, and not earning enough points for District Funding from SCIP or LTIP Funds, are then rated using the Small Government Program Rating Criteria for the corresponding funding round. In order to be rated the entity must submit the Small Government Supplement and their required budgets with their application. **Only infrastructure that is village- or township- owned is eligible for assistance.** The following policies have been adopted by the Small Government Commission:

- District Integrating Committees may submit up to seven (7) applications for consideration by the



Commission. All 7 must be ranked, however, only the top five (5) will be scored. The remaining two (2) will be held as contingency projects should an application be withdrawn.

- Grants are limited to \$500,000. Any assistance above that amount must be in the form of a loan.
- Grants for new or expanded infrastructure cannot exceed 50% of the project estimate.
- The Commission may deny funding for water and sewer systems that are deemed to be more cost-effective if regionalized.
- If a water or sewer project is determined to be affordable, the project will be offered a loan rather than a grant. Pay special attention to the **Water & Wastewater Affordability Supplemental and the Small Government Water & Wastewater Affordability Calculation Worksheet**. Both are available on the Small Government Program Tab at <https://www.pwc.ohio.gov/Programs/Infrastructure-Programs/Small-Government>
- Should there be more projects that meet the “annual score” than there is funding, the tie breaker is those projects which scored highest under Health & Safety, with the second tie breaker being Condition. If multiple projects have equivalent Health & Safety and Condition scores they are arranged according to the amount of assistance from low to high. Once the funded projects are announced, “contingency projects” may be funded from project under-runs by continuing down the approved project list.
- Supplemental assistance is not provided to projects previously funded by the Commission.
- Applicants have 30 days from receipt of application by OPWC without exception to provide additional documentation to make the application more competitive under the Small Government criteria. Applications will be scored after the 30-day period has expired. The applicants for each District's two (2) contingency projects will have the same 30-day period to submit supplemental information but these applications will not be scored unless necessary to do so. **It is each applicant's responsibility for determining the need for supplemental material. The applicant will not be asked for or notified of missing information unless the Commission has changed the project type and it affects the documentation required. Important information may include, but is not limited to: age of infrastructure, traffic counts or utility users, median income information, user rates ordinances, and the Auditor's Certificate of Estimated Revenues or documentation from the Auditor of State that subdivision is in a state of fiscal emergency.**

If you desire to have your Round 36 project considered for Small Government Funding please download the Small Government Evaluation Criteria applicable to Round 36 by accessing the OPWC Website at

<https://www.pwc.ohio.gov/Portals/0/Data/SmallGovernment%20Round%2036%20Methodology.pdf?ver=2019-08-07-071749-143>. **Please follow the Small Government Evaluation Criteria and include supporting documentation to receive points. Specifically, include the Auditor's Certification of funds for your entity and documentation supporting the age of the infrastructure.**

---

Please complete the Small Government Evaluation Criteria and attach all required supporting documentation and attach it to the District 5 Questionnaire for Round 36.

Date: 9-9-2021  
Signature: PAUL FISER  
Title: City Manager  
Address: 222 North Main Street, Clyde, Ohio 43410  
Phone: 419-547-6898  
FAX: N/A  
Email: pfiser@clydeohio.org



District 5 Capital Improvement Project Priority Rating Sheet, Round 35										Revised 06/29/2021 PROJECT NUMBER:										
COUNTY: SANDUSKY																				
PROJECT: 2022 Pavement Replacement Program																				
EST. COST: \$407,000.00																				
No.	X	WEIGHT FACTOR	CRITERIA TO BE CONSIDERED	IF PRIORITY FACTORS						A x B	PRIORITY FACTORS						No.			
				0	2	4	6	8	10		0	2	4	6	8	10				
1	1		REPAIR OR REPLACE vs. NEW OR EXPANSION							X	10		0%+	25%+	40%+	60%+	80%+	100%+	1	
2A	1		EXISTING PHYSICAL CONDITION Please refer to Criteria #2 of the Round 35 Scoring Methodology. Must submit substantiating documentation. (100% New or Expansion = 0 Points)							X	6		0	2	4	6	8	10	2A	
2B	1		AGE							X	4		Type	0	1	2	3	4	5	2B
													Road	0-4 Yrs	5-8 Yrs	9-12 Yrs	13-18 Yrs	17-20 Yrs	20+ Yrs	
													Wastewater	0-6 Yrs	7-12 Yrs	13-18 Yrs	19-24 Yrs	25-30 Yrs	30+ Yrs	
													Storm/Drain	0-10 Yrs	11-20 Yrs	21-30 Yrs	31-40 Yrs	41-50 Yrs	50+ Yrs	
													Sanitary Sewer, Water Supply, Storm Water, Solid Waste	0-10 Yrs	11-20 Yrs	21-30 Yrs	31-40 Yrs	41-50 Yrs	50+ Yrs	
3	2		PUBLIC HEALTH AND/OR SAFETY CONCERNS Submittals without supporting documentation will receive 0 points for this question.							X	16		0	2	4	6	8	10	3	
4	2		LOCAL MATCHING FUNDS Percentage of Local Share (Local funds are funds derived from the applicant budget or a loan to be paid back through the applicant budget, assessments, rates or tax revenues) *							X	20		0	2	4	6	8	10	4	
5	1		OTHER FUNDING (Excluding Issue B Funds) (Grants and other revenues not authorized or collected through taxes by the applicant, including Gifts, Contributions, etc. - must submit copy of award or status letter)							X	0		0	10%	20%	30%	40%	50%	5	
6			GRANT AND LOAN FUNDS REQUESTED. Please refer to Criteria #8 of the Round 35 Methodology for clarification.							X	20								6	
	2		Grant or Loan Only										-9	-8	0	8	9	10	6	
													\$500,001 or more	\$400,001 to \$500,000	\$325,001 to \$400,000	\$275,001 to \$325,000	\$175,001 to \$275,000	\$175,000 or less		
	2		Grant/Loan Combination										\$750,000 or more	\$600,001 to \$750,000	\$487,501 to \$600,000	\$412,501 to \$487,500	\$262,501 to \$412,500	\$262,500 or less	6	
When scoring a project that is only grant or loan, please use the chart labeled "Grant or Loan Only". When scoring a grant/loan combination, score the project for the grant in the first chart, then use the second chart labeled "Grant/Loan Combination" to score the total (grant and loan combined). Use the lower of the two as the score.																				
7	1		JOB CREATION/RETENTION Indicate full-time equivalent jobs. Include supporting documentation in the form of a comment letter from business or third party entity.							X	0		0	2	4	6			7	
													0-6 Jobs	7-14 Jobs	15-24 Jobs	25+ Jobs				
8	1		BENEFIT TO EXISTING USERS (Households or traffic counts) Equivalent to existing unit direct connections. Traffic Counts within three years with certified documentation, etc.							X	10		0	2	4	6	8	10	8	
													0-99 Users	100 - 349 Users	350 - 499 Users	500 - 749 Users	750 - 1000 Users	1000+ Users		
9	1		ECONOMIC DISTRESS Local MHI as a percentage of the District Median MHI							X	1		0	1	2				9	
													100%+	80%-100%	Less Than 80%					
10	1		READINESS TO PROCEED							X	2		0	1	2				10	
													Plans Not Begun	Preliminary Engineering Complete	Final Design Complete					
11			SUBTOTAL RANKING POINTS (MAX = 115)								89		Other Info: Does this project have a significant impact on productive farmland? YES NO X Attach Impact statement if yes. Is the Applicant ready to proceed to bids after State Approval within 6 months? YES NO X							
12			COUNTY SUBCOMMITTEE PRIORITY POINTS (15-20-15)										X							
13A			DISCRETIONARY POINTS (BY DISTRICT ONLY) (MAX=1)										District Discretionary Point may be awarded to projects that demonstrate significant Area-wide, County, or Community Impact. Include documentation to support the claim of significance.							
13B			DISCRETIONARY POINTS (BY DISTRICT ONLY) (MAX=1)										District Discretionary Point may be awarded to projects that demonstrate that the entity has maximized financial resources including assessments and utility rate structure.							
14			GRAND TOTAL RANKING POINTS																	

\* Applicants must certify local and other share contributions. Specify, all funding sources to be utilized as local share at the time of application submittal.