



State of Ohio
Public Works Commission
Application for Financial Assistance

RECEIVED
 JUN 18 2018 8:27

IMPORTANT: Please consult "Instructions for Financial Assistance for Capital Infrastructure Projects" for guidance in completion of this form.

Applicant

Applicant: Paulding County Subdivision Code: 125-00125

District Number: 5 County: Paulding County Date: 09/07/2018

Contact: Chad M. Crosby Phone: (419) 399-2433
(The individual who will be available during business hours and who can best answer or coordinate the response to questions)

Email: chadc@pauldingcountyoh.com FAX: (419) 399-3363

Project

Project Name: 2018 Paulding County Bridge Improvements Zip Code: 45879

Subdivision Type	Project Type	Funding Request Summary	
<small>(Select one)</small>	<small>(Select single largest component by \$)</small>	<small>(Automatically populates from page 2)</small>	
<input checked="" type="checkbox"/> 1. County	<input type="checkbox"/> 1. Road	Total Project Cost:	<u>212,080 .00</u>
<input type="checkbox"/> 2. City	<input checked="" type="checkbox"/> 2. Bridge/Culvert	1. Grant:	<u>106,040 .00</u>
<input type="checkbox"/> 3. Township	<input type="checkbox"/> 3. Water Supply	2. Loan:	<u>0 .00</u>
<input type="checkbox"/> 4. Village	<input type="checkbox"/> 4. Wastewater	3. Loan Assistance/ Credit Enhancement:	<u>0 .00</u>
<input type="checkbox"/> 5. Water (6119 Water District)	<input type="checkbox"/> 5. Solid Waste	Funding Requested:	<u>106,040 .00</u>
	<input type="checkbox"/> 6. Stormwater		

District Recommendation (To be completed by the District Committee)

Funding Type Requested	SCIP Loan - Rate: _____ % Term: _____ Yrs	Amount: _____ .00
<small>(Select one)</small>		
<input type="checkbox"/> State Capital Improvement Program	RLP Loan - Rate: _____ % Term: _____ Yrs	Amount: _____ .00
<input type="checkbox"/> Local Transportation Improvement Program	Grant:	Amount: _____ .00
<input type="checkbox"/> Revolving Loan Program	LTIP:	Amount: _____ .00
<input type="checkbox"/> Small Government Program	Loan Assistance / Credit Enhancement:	Amount: _____ .00
District SG Priority: _____		

For OPWC Use Only

STATUS	Grant Amount: _____ .00	Loan Type: <input type="checkbox"/> SCIP <input type="checkbox"/> RLP
Project Number: _____	Loan Amount: _____ .00	Date Construction End: _____
_____	Total Funding: _____ .00	Date Maturity: _____
Release Date: _____	Local Participation: _____ %	Rate: _____ %
OPWC Approval: _____	OPWC Participation: _____ %	Term: _____ Yrs

1.0 Project Financial Information (All Costs Rounded to Nearest Dollar)

1.1 Project Estimated Costs

Engineering Services

Preliminary Design:	_____	.00	
Final Design:	_____	.00	
Construction Administration:	_____	.00	
Total Engineering Services:	a.) _____	<u>0</u> .00	<u>0</u> %
Right of Way:	b.) _____	.00	
Construction:	c.) _____	<u>212,080</u> .00	
Materials Purchased Directly:	d.) _____	.00	
Permits, Advertising, Legal:	e.) _____	.00	
Construction Contingencies:	f.) _____	.00	<u>0</u> %
Total Estimated Costs:	g.) _____	<u>212,080</u> .00	

1.2 Project Financial Resources

Local Resources

Local In-Kind or Force Account:	a.) _____	.00	
Local Revenues:	b.) _____	<u>106,040</u> .00	
Other Public Revenues:	c.) _____	.00	
ODOT / FHWA PID: _____	d.) _____	.00	
USDA Rural Development:	e.) _____	.00	
OEPA / OWDA:	f.) _____	.00	
CDBG:	g.) _____	.00	
<input type="checkbox"/> County Entitlement or Community Dev. "Formula"			
<input type="checkbox"/> Department of Development			
Other: _____	h.) _____	.00	
Subtotal Local Resources:	i.) _____	<u>106,040</u> .00	<u>50</u> %

OPWC Funds (Check all requested and enter Amount)

Grant: <u>100</u> % of OPWC Funds	j.) _____	<u>106,040</u> .00	
Loan: <u>0</u> % of OPWC Funds	k.) _____	.00	
Loan Assistance / Credit Enhancement:	l.) _____	<u>0</u> .00	
Subtotal OPWC Funds:	m.) _____	<u>106,040</u> .00	<u>50</u> %
Total Financial Resources:	n.) _____	<u>212,080</u> .00	<u>100</u> %

1.3 Availability of Local Funds

Attach a statement signed by the Chief Financial Officer listed in section 5.2 certifying all local resources required for the project will be available on or before the earliest date listed in the Project Schedule section. The OPWC Agreement will not be released until the local resources are certified. Failure to meet local share may result in termination of the project. Applicant needs to provide written confirmation for funds coming from other funding sources.

2.0 Repair / Replacement or New / Expansion

2.1 Total Portion of Project Repair / Replacement:	212,080 .00	100 %
2.2 Total Portion of Project New / Expansion:	0 .00	0 %
2.3 Total Project:	212,080 .00	100 %

A Farmland Preservation letter is required for any impact to farmland

3.0 Project Schedule

3.1 Engineering / Design / Right of Way	Begin Date: <u>06/01/2018</u>	End Date: <u>08/10/2018</u>
3.2 Bid Advertisement and Award	Begin Date: <u>06/01/2019</u>	End Date: <u>07/01/2019</u>
3.3 Construction	Begin Date: <u>07/01/2019</u>	End Date: <u>12/31/2019</u>

Construction cannot begin prior to release of executed Project Agreement and issuance of Notice to Proceed. Failure to meet project schedule may result in termination of agreement for approved projects. Modification of dates must be requested in writing by project official of record and approved by the Commission once the Project Agreement has been executed.

4.0 Project Information

If the project is multi-jurisdictional, information must be consolidated in this section.

4.1 Useful Life / Cost Estimate / Age of Infrastructure

Project Useful Life: 50 Years Age: 1958 (Year built or year of last major improvement)

Attach Registered Professional Engineer's statement, with seal or stamp and signature confirming the project's useful life indicated above and detailed cost estimate.

4.2 User Information

Road or Bridge: Current ADT 357 Year 2018 Projected ADT 380 Year 2038

Water / Wastewater: Based on monthly usage of 4,500 gallons per household; attach current ordinances.

Residential Water Rate Current \$ _____ Proposed \$ _____

Number of households served: _____

Residential Wastewater Rate Current \$ _____ Proposed \$ _____

Number of households served: _____

Stormwater: Number of households served: _____

4.3 Project Description

- A: SPECIFIC LOCATION (Supply a written location description that includes the project termini; a map does not replace this requirement.) 500 character limit.

CR-179 - 5.54 Bridge 2982' north of SR-637

- B: PROJECT COMPONENTS (Describe the specific work to be completed; the engineer's estimate does not replace this requirement) 1,000 character limit.

Work will consist of removing old bridge structure and replacing it with a concrete box culvert. All existing lateral drains will be replaced with proper sized structures. The ditch channel will have rock added to protect the integrity of the channel. Wing-walls will be placed on each end of the box to insure erosion does not take place and guardrail will be placed on each side to help with public safety. New pavement will be laid with an intermediate course followed by a surface course to aid in transition from existing road to new pavement. Traffic will be maintained at all times in accordance to the Engineers specifications.

- C: PHYSICAL DIMENSIONS (Describe the physical dimensions of the existing facility and the proposed facility. Include length, width, quantity and sizes, mgd capacity, etc in detail.) 500 character limit.

CR-179 - 5.54B concrete slab bridge will be replaced with a 14'x8' concrete box culvert

5.0 Project Officials

Changes in Project Officials must be submitted in writing from an officer of record.

5.1 Chief Executive Officer

(Person authorized in legislation to sign project agreements)

Name: Tony Zartman

Title: Paulding County Commissioner Chairman

Address: 115 N. Williams St B-1

City: Paulding State: OH Zip: 45879

Phone: (419) 399-8215

FAX: _____

E-Mail: pccommissioners@pauldingcountyoh.com

5.2 Chief Financial Officer

(Can not also serve as CEO)

Name: Claudia Fickell

Title: Paulding County Auditor

Address: 115 N. Williams St Suite 101

City: Paulding State: OH Zip: 45879

Phone: (419) 399-8205

FAX: _____

E-Mail: paucoaud@pauldingcountyoh.com

5.3 Project Manager

Name: Chad M. Crosby

Title: Project Manager

Address: 801 West Wayne St

City: Paulding State: OH Zip: 45879

Phone: (419) 399-2433

FAX: (419) 399-3363

E-Mail: chadc@pauldingcountyoh.com

6.0 Attachments / Completeness review

Confirm in the boxes below that each item listed is attached (Check each box)

- A certified copy of the legislation by the governing body of the applicant authorizing a designated official to sign and submit this application and execute contracts. This individual should sign under 7.0, Applicant Certification, below.
- A certification signed by the applicant's chief financial officer stating the amount of all local share funds required for the project will be available on or before the dates listed in the Project Schedule section. If the application involves a request for loan (RLP or SCIP), a certification signed by the CFO which identifies a specific revenue source for repaying the loan also must be attached. Both certifications can be accomplished in the same letter.
- A registered professional engineer's detailed cost estimate and useful life statement, as required in 164-1-13, 164-1-14, and 164-1-16 of the Ohio Administrative Code. Estimates shall contain an engineer's seal or stamp and signature.
- A cooperative agreement (if the project involves more than one subdivision or district) which identifies the fiscal and administrative responsibilities of each participant.
- Farmland Preservation Review - The Governor's Executive Order 98-IV, "Ohio Farmland Protection Policy" requires the Commission to establish guidelines on how it will take protection of productive agricultural and grazing land into account in its funding decision making process. Please include a Farm Land Preservation statement for projects that have an impact on farmland.
- Capital Improvements Report. CIR Required by O.R.C. Chapter 164.06 on standard form.
- Supporting Documentation: Materials such as additional project description, photographs, economic impact (temporary and/or full time jobs likely to be created as a result of the project), accident reports, impact on school zones, and other information to assist your district committee in ranking your project. Be sure to include supplements which may be required by your local District Public Works Integrating Committee.

7.0 Applicant Certification

The undersigned certifies: (1) he/she is legally authorized to request and accept financial assistance from the Ohio Public Works Commission as identified in the attached legislation; (2) to the best of his/her knowledge and belief, all representations that are part of this application are true and correct; (3) all official documents and commitments of the applicant that are part of this application have been duly authorized by the governing body of the applicant; and, (4) should the requested financial assistance be provided, that in the execution of this project, the applicant will comply with all assurances required by Ohio Law, including those involving Buy Ohio and prevailing wages.

Applicant certifies that physical construction on the project as defined in the application has NOT begun, and will not begin until a Project Agreement for this project has been executed with the Ohio Public Works Commission. Action to the contrary will result in termination of the agreement and withdrawal of Ohio Public Works Commission funding from the project.

Tony Zartman Paulding County Commissioner

Certifying Representative (Printed form, Type or Print Name and Title)

Original Signature / Date Signed

9/26/2018

2018 PAULDING COUNTY BRIDGE IMPROVEMENTS

PAULDING COUNTY

Travis R. McGarvey, P.E., P.S.
Paulding County Engineer

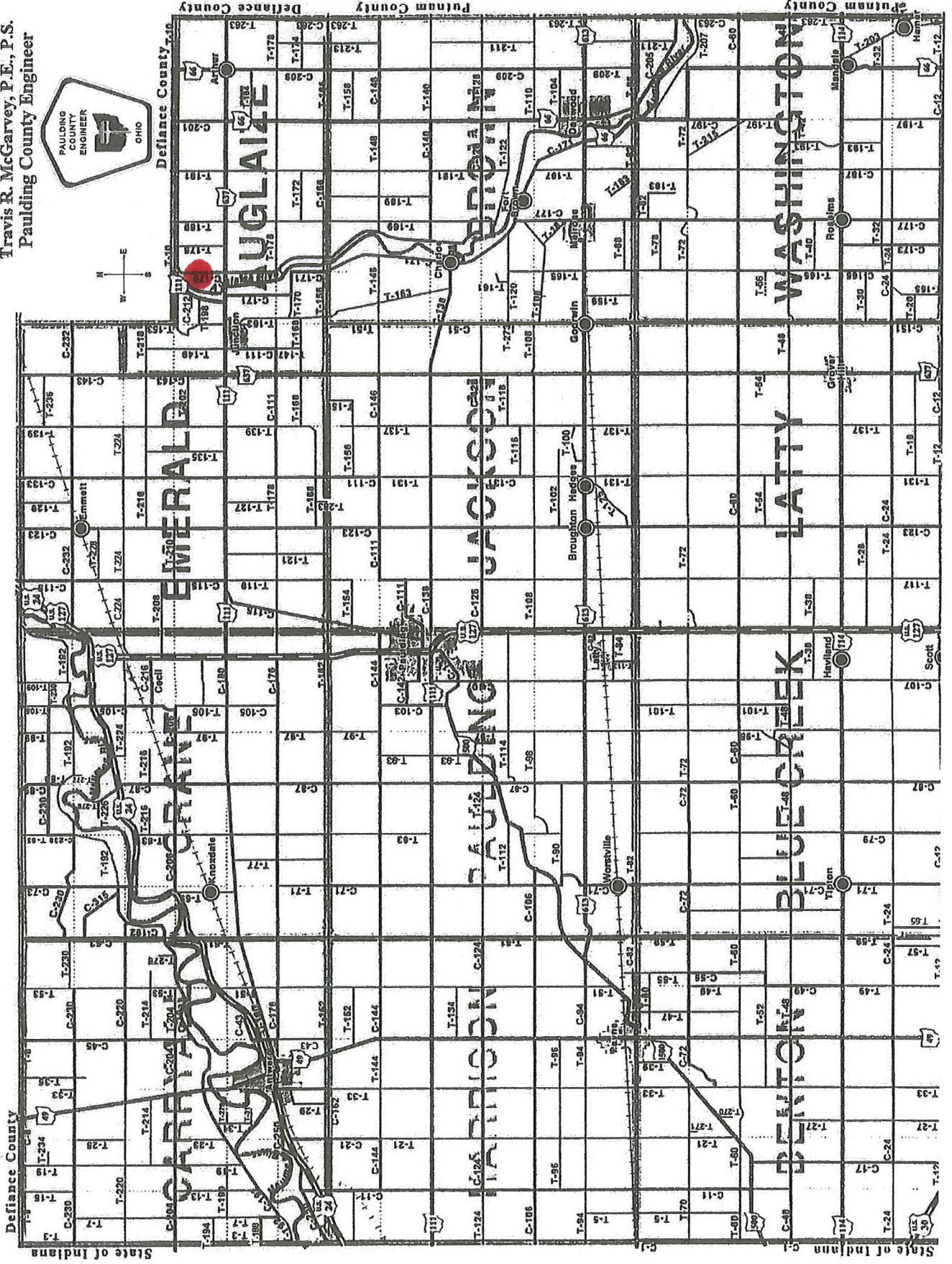

TRAFFIC COUNT 24 HRS

2018 Paulding County Bridge Improvements

CR179-5.54B = 357

07-02-18/07-03-18 (between SR-637 to TR-10)

SIGNED:

A handwritten signature in blue ink, appearing to read "Chad M. Cook", written over a horizontal line.

DATE: 7-3-18

Paulding County Bridge 5.54B Replacement



IN THE MATTER OF AUTHORIZING THE PRESIDENT/CHAIRMAN OF THE BOARD OF COUNTY COMMISSIONERS TO SIGN APPLICATIONS AND TO EXECUTE CONTRACTS AND/OR AGREEMENTS WITH THE OHIO PUBLIC WORKS COMMISSION (OPWC) FOR PROGRAM YEAR 33 SCIP AND LTIP FUNDS

Office of the Board of County Commissioners
Paulding County, Ohio
September 26, 2018

This 26th day of September, 2018, the Board of County Commissioners met in regular session with the following members present:

Tony Zartman, Roy Klopfenstein, Mark Holtsberry, and Cindy Peters, Clerk

Mr. Mark Holtsberry moved to adopt the following resolution:

BE IT RESOLVED, that the Board of County Commissioners does hereby authorize the President/Chairman of the Board of County Commissioners to sign applications and to execute contracts and/or agreements with Ohio Public Works Commission (OPWC) for Program Year 33 SCIP and LTIP funds to be used for County projects.

The motion was seconded by Mr. Roy Klopfenstein. Upon the call of the roll, the following vote resulted:

<u>Mark Holtsberry</u>	<u>yes</u>
<u>Roy Klopfenstein</u>	<u>yes</u>
<u>Tony Zartman</u>	<u>yes</u>
PAULDING COUNTY COMMISSIONERS	

ATTEST: Cindy Peters, Clerk
Adopted: September 26, 2018

cc: Engineer

IN THE MATTER OF AUTHORIZATION TO APPLY TO THE OHIO PUBLIC WORKS COMMISSION (OPWC) FOR PROGRAM YEAR 33 SCIP AND LTIP FUNDS TO BE USED FOR COUNTY PROJECTS

Office of the Board of County Commissioners
Paulding County, Ohio
August 20, 2018

This 20th day of August, 2018, the Board of County Commissioners met in regular session with the following members present:

Tony Zartman, Roy Klopfenstein, Mark Holtsberry, and Cindy Peters, Clerk

Mr. Roy Klopfenstein moved to adopt the following resolution:

BE IT RESOLVED, that the Board of County Commissioners does hereby authorize Paulding County Engineer, Travis McGarvey to apply to the Ohio Public Works Commission (OPWC) for Program Year 33 SCIP and LTIP funds to be used for County projects.

The motion was seconded by Mr. Mark Holtsberry. Upon the call of the roll, the following vote resulted:

<u>Mark Holtsberry</u>	<u>yes</u>
<u>Roy Klopfenstein</u>	<u>yes</u>
<u>Tony Zartman</u>	<u>yes</u>

PAULDING COUNTY COMMISSIONERS

ATTEST: Cindy Peters, Clerk
Adopted: August 20, 2018

cc: Engineer

“Status of Funds”

I, Auditor of Paulding County, hereby certify that the Paulding County Engineer has the amount of \$ 106,040.00 in the Gas Tax account/fund and that this amount will be used to pay the local share for the project “2018 Paulding County Bridge Improvements” when it is required.

Claudia Fickel, Auditor

Claudia Fickel, Paulding County Auditor

Ohio Public Works Commission
SUMMARY FORM

Paulding County 125-00125 Paulding 8/7/2018
 Subdivision Code County Date

Infrastructure Component	Replacement Cost	Repair Cost	Total Units	Units/Physical Condition					
				Excellent	Good	Fair	Poor	Critical	Unknown
Roads	148,443,929	22,468,218	Center Line Miles 334.61	120.00	50.00	129.61	35.00		
Bridges	89,214,746	2,358,507	Number of Bridges 186	75	65	30	16		
Culverts	11,297,089	2,485,047	Number of Culverts 968	100	550	288	30		
Water Supply Systems			Number of Facilities 0						
Water Distribution			Linear Feet (Thousands) 0.00						
Wastewater Systems			Number of Facilities 0						
Wastewater Collection	9,192,653	459,632	Linear Feet (Thousands) 60.00	60.00					
Stormwater Collection			Linear Feet (Thousands) 0.00						
Solid Waste Disposal			Capacity (Tons per Day) 0						
Totals	258,148,422	27,771,404							

Subdivision Socio-Economic Characteristics

	Current	Census Information		
		Population Total	% LMI	% Unemployment
Population	19,254	19,614	0.00%	
Total Households	8,755	7,571	13.50%	
% Unemployment	7%	MHI	% Poverty	6.40%

Preparer's Name, Phone Number, email : Chad M. Crosby 419-399-2433 chadc@pauldingcountyoh.com

Ohio Public Works Commission
Five Year Capital Improvement Plan/Maintenance of Effort

Paulding County

125-00125

08/07/2018

Subdivision

Code

Date

Project Name/Description	Funding Codes(s)	Status (A) Active (P) Pending (C) Complete	Total Cost	Two Year Effort		Five-Year Plan				
				Yr 2014 <i>Funded</i>	Yr 2015	Yr 2016	Yr 2017	Yr 2018 <i>Planned</i>	Yr 2019	Yr 2020
2014 Paving	OPWC/Gas	C	1,000,000							
2015 Bridge & Culvert Improvements	Gas	A	200,000	200,000						
Chip Seal Various Roads	Gas	P	200,000	200,000						
Wedging Various Roads	Gas	A	100,000	100,000						
Overlay Various Roads	Gas	A	750,000	750,000						
2016 Bridge & Culvert Improvements	Gas	P		200,000	200,000					
Chip Seal Various Roads	Gas	P		200,000	200,000					
Wedging Various Roads	Gas	P		100,000	100,000					
Overlay Various Roads	Gas	P		750,000	750,000					
CR123-1.34 Bridge Replacement	LBR	P		400,000	400,000					
2017 Bridge & Culvert Improvements	Gas	P			200,000	200,000				
Chip Seal Various Roads	Gas	P			200,000	200,000				
Wedging Various Roads	Gas	P			100,000	100,000				
Overlay Various Roads	Gas	P			750,000	750,000				
2018 B ridge & Culvert Improvements	Gas	P				200,000	200,000			
Chip Seal Various Roads	Gas	P				200,000	200,000			
Wedging Various Roads	Gas	P				100,000	100,000			
Overlay Various Roads	Gas	P				750,000	750,000			

Revised: April 17, 2018

**DISTRICT 5
CAPITAL IMPROVEMENT PROJECTS
QUESTIONNAIRE
ROUND 33**

Name of Applicant: Paulding County
Project Title: 2018 Paulding County Bridge Improvements

The following questions are to be answered for each application submitted for State Issue II SCIP, LTIP and Loan Projects. Please provide specific information using the best documentation available to you. Justification of your responses to these questions will be required if your project is selected for funding, so please provide correct and accurate responses. **Communities and Townships under 5,000 in population should also complete the Small Government Criteria.**

1. What percentage of the project in repair A= 0%, replacement B=100%, expansion C= 0%, and new D= 0%? (Use dollar amounts of project to figure percentages and make sure the total equals one hundred(100) percent) A+B= 100% C+D= 0%

Repair/Replacement = Repair or Replacement of public facilities owned by the government (any subdivision of the state).

New/Expansion = Replacement of privately owned wells, septic systems, private water or wastewater systems, etc.

2. Give the physical condition rating:

Closed or Not Operating: The condition is unusable, dangerous and unsafe. The primary components have failed. The infrastructure is not functioning at all.

Critical: The condition is causing or contributing to a serious non-compliance situation and is threatening the intended design level of service. The infrastructure is functioning at seriously diminished capacity. Imminent failure is anticipated within 18 months. Repair and/or replacement is required to eliminate the critical condition and meet current design standards. **(For Road Projects structural repair items would represent a minimum of 25% of the total Project Cost).**

Poor:

The condition is substandard and requires repair/replacement in order to return to the intended level of service and comply with current design standards. Infrastructure contains a major deficiency and is functioning at a diminished capacity.

Fair:

The condition is average, not good or poor. The infrastructure is still functioning as originally intended. Minor deficiencies exist requiring repair to continue to function as originally intended and/or to meet current design standards.

Good: The condition is safe and suitable to purpose. Infrastructure is functioning as originally intended, but requires minor repairs and/or upgrades to meet current design standards.

Excellent: The condition is new, or requires no repair. Or, no supporting documentation has been submitted.

* **In order to receive points provide supporting documentation (e.g. photos, a narrative, maintenance history, or third party findings) to justifying the rating.**

3. If the proposed project is not approved what category would best represent the impact on the general health and/or public safety?

ROADS

Extremely Critical: Resurfacing, Restoration, Rehabilitation and Reconstruction (4R) of a Major Access Road.*

Critical: Resurfacing, Restoration and Rehabilitation (3R) of a Major Access Road.*

Major: Resurfacing, Restoration, Rehabilitation and Reconstruction (4R) of a Minor Access Road.*

Moderate: Resurfacing, Restoration and Rehabilitation (3R) of a Minor Access Road.*

Minimal: Preventative Maintenance of a Major Access Road.

No Impact: Preventative Maintenance of a Minor Access Road.

Projects that have a variety of work will be scored in the LOWEST category of work contained in the Construction Estimate.

Road/Street Classifications:

Major Access Road: Roads or streets that have a dual function of providing access to adjacent properties and providing through or connecting service between other roads.

Minor Access Road: Roads or streets that primarily provide access to adjacent properties without through continuity, such as cul-de-sacs or loop roads or streets.

Preventative Maintenance: Non Structural Pavement work such as chip sealing, cape sealing, microsurfacing, crack sealing, etc.

*(3R) Resurfacing, Restoration and Rehabilitation - Improvements to existing roadways, which have as their main purpose, the restoration of the physical features (pavement, curb, guardrail, etc.) without altering the original design elements.

*(4R) Resurfacing, Restoration, Rehabilitation and Reconstruction - Much like 3R, except that 4R allows for the complete reconstruction of the roadway and alteration of certain design elements (i.e., lane widths, shoulder

width, SSD, etc.).

BRIDGES SUFFICIENCY RATING

- Extremely Critical: 0-25, or a General Appraisal rating of 3 or less.
- Critical: 27-50, or a General Appraisal rating of 4.
- Major: 51-65 or a General Appraisal rating of 5 or 6.
- Moderate: 66-80 or a General Appraisal rating of 7.
- Minimal: 81-100 or a General Appraisal rating of more than 7.
- No Impact: Bridge on a new roadway.

WASTEWATER TREATMENT PLANTS

- Extremely Critical: Environmental Protection Agency (EPA) orders in the form of a consent decree, findings and orders or court order. Health Department Construction Ban.
- Critical: Improvements ordered by the Environmental Protection Agency (EPA) in the form of NPDES Orders.
- Major: Replace deficient appurtenances. Update existing processes due to EPA recommendations.
- Moderate: Increase capacity to meet current needs or update processes to improve effluent quality.
- Minimal: New/Expansion project to meet a specific development proposal.
- No Impact: New/Expansion to meet future or projected needs.

WATER TREATMENT PLANT

- Extremely Critical: EPA orders in the form of a consent decree, findings and orders or court order.
- Critical: Improvements to meet Environmental Protection Agency (EPA) Safe Drinking Water Regulations and/or NPDES Orders.
- Major: Replace deficient appurtenances. Update existing processes due to EPA recommendations.
- Moderate: Increase capacity to meet current needs or update processes to improve water quality.
- Minimal: New/Expansion project to meet a specific development proposal.
- No Impact: New/Expansion to meet future or projected needs.

COMBINED SEWER SEPARATIONS (May be construction of either new storm or sanitary sewer as long as the result is two separate sewer systems.)

- Extremely Critical: EPA orders in the form of a consent decree, findings and orders or court order. Health Department Construction Ban.
- Critical: Separate, due to chronic backup or flooding in basements.
- Major: Separate, due to documented water quality impairment, or due to EPA recommendations.
- Moderate: Separate, due to specific development proposal within or upstream of the combined system area.
- Minimal: Separate, to conform to current design standards.
- No Impact: No positive health effect.

STORM SEWERS

- Extremely Critical: EPA orders in the form of a consent decree, findings and orders or court order.
- Critical: Chronic flooding (structure damage).
- Major: Inadequate capacity (land damage).
- Moderate: Inadequate capacity with no associated damage.
- Minimal: New/Expansion to meet current needs.
- No Impact: New/Expansion to meet future or project needs.

CULVERTS

- Extremely Critical: Structurally deficient or functionally obsolete. Deterioration has already caused a safety Critical: hazard to the public.
- Critical: Inadequate capacity with land damage and the existing or high probability of property damage.
- Major: Inadequate capacity (land damage).
- Moderate: Inadequate capacity with no associated damage.
- Minimal: New/Expansion to meet current needs.
- No Impact: New/Expansion to meet future or projected needs.

SANITARY SEWERS

- Extremely Critical: EPA orders in the form of a consent decree, findings and orders or court order. Health Department Construction Ban.
- Critical: Replace, due to chronic pipe failure, chronic backup or flooding in basements. Improvements ordered by the Environmental Protection Agency (EPA) in the form of NPDES Orders.
- Major: Replace, due to inadequate capacity or infiltration, or due to EPA recommendations.
- Moderate: Rehabilitate to increase capacity to meet current needs or to reduce inflow and infiltration.
- Minimal: New/Expansion project to meet a specific development proposal.
- No Impact: New/Expansion to meet future or projected needs.

SANITARY LIFT STATIONS AND FORCE MAINS

- Extremely Critical: Structurally deficient. Deterioration has already caused a safety/health hazard to the public, or, EPA orders in the form of a consent decree, findings and orders or court order.
- Critical: Inadequate capacity with actual or a high probability of property damage. Improvements ordered by the Environmental Protection Agency (EPA) in the form of NPDES Orders.
- Major: EPA recommendations, or, reduces a probable health and/or safety problem.
- Moderate: Rehabilitate to increase capacity to meet current needs.
- Minimal: New/Expansion to meet a specific development proposal.
- No Impact: New/Expansion to meet future or projected needs.

WATER PUMP STATIONS

- Extremely Critical: Structurally deficient. Deterioration has already caused a safety hazard to the public, or, EPA orders in the form of a consent decree, findings and orders or court order.
- Critical: Inadequate capacity with the inability to maintain pressure required for fire flows.
- Major: Replace due to inadequate capacity or EPA recommendations.
- Moderate: Rehabilitate to increase capacity to meet current needs.

Minimal: New/Expansion to meet a specific development proposal.

No Impact: New/Expansion to meet future or projected needs.

WATER LINES/WATER TOWERS

Extremely Critical: Solve low water pressure or excessive incidents of main breaks in project area.

Critical: Replace, due to deficiency such as excessive corrosion, etc.

Major: Replace undersized water lines as upgrading process.

Moderate: Increase capacity to meet current needs.

Minimal: New/Expansion project to meet a specific development proposal.

No Impact: New/Expansion to meet future or projected needs.

OTHER

Extremely Critical: There is a present health and/or safety threat.

Critical: The project will provide immediate health and/or safety benefit.

Major: The project will reduce a probable health and/or safety problem.

Moderate: The project will delay a health and/or safety problem.

Minimal: A possible future health and/or safety problem mitigation.

No Impact: No health and/or safety effect.

NOTE: Combined projects that can be rated in more than one subset may be rated in the other category at the discretion of the District 5 Executive Committee. In general, the majority of the cost or scope of the project shall determine the category under which the project will be scored.

(Submittals without supporting documentation will receive 0 Points for this question.)

Extremely Critical ____, Critical X, Major ____, Moderate ____, Minimal ____, No Impact ____. Explain your answer.

Bridge has a general appraisal rating of 4

(Additional narrative, charts and/or pictures should be attached to questionnaire)

4. Identify the amount of local funds that will be used on the project as a percentage of the total project cost.

A.) Amount of Local Funds = \$ 106,040
B.) Total Project Cost = \$ 212,080

RATIO OF LOCAL FUNDS DIVIDED by TOTAL PROJECT COSTS (A÷B)= 50 %

Note: Local funds should be considered funds derived from the applicant budget or loans funds to be paid back through local budget, assessments, rates or tax revenues collected by the applicant.

5. Identify the amount of other funding sources to be used on the project, excluding State Issue II or LTIP Funds, as a percentage of the total project cost.

Grants ___% Gifts ___%, Contributions ___%

Other ___% (explain) _____ , Total 0 %

Note: Grant funds and other revenues not contributed or collected through taxes by the applicant should be considered other funds. The Scope of Work for each Funding Source must be the same.

6. Total Amount of SCIP and Loan Funding Requested- An Applicant can request a grant per the categories below for points as indicated on the Priority Rating Sheet. If the Applicant is including a loan request equal to, but not exceeding 50% of the OPWC funding amounts listed below, there will be no point penalty. If loan funds requested are more than 50%, points as listed in the Priority Rating Sheet will apply.

- _____ \$500,001 or More
- _____ \$400,001-\$500,000
- _____ \$325,001-\$400,000
- _____ \$275,001-\$325,000
- _____ \$175,001-\$275,000
- X _____ \$175,000 or Less

There are times when the District spends all of the grant money and has loan money remaining. When this happens, the district makes a loan offer in the amount of the requested grant to the communities that were not funded. The offers are made in the order of scoring. We need to know if you are not successful in obtaining grant dollars for your project if you would be interested in loan money:

YES _____ NO X

(This will only be considered if you are not funded with grant money and there is remaining loan money.) **Please note: if you answer “no” you will not be contacted, only if you answer “yes” will an offer be made in the event that there is loan money remaining.**

7. If the proposed project is funded, will its completion directly result in the creation of permanent full-time equivalent (FTE) jobs (FTE jobs shall be defined as 35 hours/week) ? Yes ___ No X. If yes, how many jobs within eighteen months? ___ Will the completed project retain jobs that would otherwise be

permanently lost? Yes ___ No X. If yes, how many jobs _____ will be created/retrained within 18 months following the completion of the improvements?

(Supporting documentation in the form of letter from affected industrial or commercial enterprises that specify full time equivalent jobs that will be retained or created directly by the installation or improvement of Public infrastructure. Additional items such as; 1) newspaper articles or other media news accounts, 2) public meeting minutes, and/or 3) a letter from the County Economic Development Director or State of Ohio Economic Development Professional that alludes to the requirement for the infrastructure improvement to support the business. Submittals without supporting documentation will receive 0 points for this question.)

8. What is the total number of existing users that will directly benefit from the proposed project if completed? 357 (Use households served, traffic counts, etc. and explain the basis by which you arrived at your number.) Traffic Count

9. Is subdivision's population less than 5,000 Yes ___ No X
If yes, continue. You may want to design your project per Small Government Project Evaluation Criteria, released for the current OPWC Round to assist in evaluating your project for potential Small Government Funding. The Small Government Criteria is available on the OPWC website at <http://www.pwc.state.oh.us/Meth.SG.PDF> If No, skip to Question 11.

10. **OHIO PUBLIC WORKS COMMISSION SMALL GOVERNMENT PROGRAM GUIDELINES**

All projects that are sponsored by a subdivision with a population of 5,000 or less, and not earning enough points for District Funding from SCIP or LTIP Funds, are then rated using the Small Government Program Rating Criteria for the corresponding funding round. In order to be rated the entity must submit the Small Government Supplement and their required budgets with their application. **Only infrastructure that is village- or township- owned is eligible for assistance.** The following policies have been adopted by the Small Government Commission:

- District Integrating Committees may submit up to seven (7) applications for consideration by the Commission. All 7 must be ranked, however, only the top five (5) will be scored. The remaining two (2) will be held as contingency projects should an application be withdrawn.
- Grants are limited to \$500,000. Any assistance above that amount must be in the form of a loan.
 - Grants for new or expanded infrastructure cannot exceed 50% of the project estimate.
- The Commission may deny funding for water and sewer systems that are deemed to be more

Municipal Income Tax _____

County Sales Tax _____

Others _____

(DO NOT INCLUDE SCHOOL TAXES)

SPECIFIC PROJECT AREA INFORMATION.

Median household income _____

Monthly utility rate: Water _____

Sewer _____

Other _____

List any special user fees or assessment (be specific)

POLITICAL SUBDIVISION= _____

COUNTY= _____

DISCRETIONARY POINTS (BY DISTRICT COMMITTEE ONLY)= _____

(25-20-15)

Date: 9-3-2018

Signature: J. McGarvey

Title: County Engineer

Address: 801 West Wayne St., Paulding OH 45679

Phone: 419-399-2433

FAX: 419-399-~~2433~~ 3363

Email: tmegarvey@windstream.net

District 5

Capital Improvement Project

Priority Rating Sheet, Round 33

Revised 04/17/18

PROJECT NUMBER

COUNTY: PAV		PROJECT NUMBER															
PROJECT: BRIDGE																	
EST. COST: 212,080																	
No.	"A" WEIGHT FACTOR	CRITERIA TO BE CONSIDERED	"B" PRIORITY FACTORS					"A" x "B"	Priority Factors						No.		
									0	2	4	6	8	10			
1	1	(Repair or Replace) vs. (New or Expansion)	0	2	4	6	8	10	10	0% + Repair or Reolacement	20% + Repair or Reolacement	40% + Repair or Reolacement	60%+ Repair or Replacement	80%+ Repair or Replacement	100%+ Repair or Replacement	1	
2	1.5	Existing Physical Condition: Must submit substantiating documentation and CIR (100% New or Expansion = 0 Points)	0	2	4	6	8	10	9	Excellent	Good	Fair	Poor	Critical	Closed or Not Operating	2	
3	2	Public Health and/or Public Safety Concerns Submittals without supporting documentation will receive 0 points for this question.	0	2	4	6	8	10	16	No Impact	Minimal	Moderate	Major	Critical	Extremely Critical	3	
4	2	Percentage of Local Share (Local funds are funds derived from the applicant budget or a loan to be paid back through the applicant budget, assessments, rates or tax revenues) *	0	2	4	6	8	10	20	0%+	10%+	20%+	30%+	40%+	50%+	4	
5	1	OTHER FUNDING SOURCES (Excluding Issue II Funds) (Grants and other revenues not contributed or collected through taxes by the applicant; including Gifts, Contributions, etc. - must submit copy of award or status letter.)	0	2	4	6	8	10	0	0%+	10%+	20%+	30%+	40%+	50%+	5	
No.	"A" WEIGHT FACTOR	CRITERIA TO BE CONSIDERED	"B" PRIORITY FACTORS					"A" x "B"	Priority Factors						No.		
								-9	-8	0	8	9	10				
								Grant or Loan Only									
6	2	OPWC Grant and Loan Funding Requested; Please refer to Item 6 on Questionnaire for Clarification.	-9	-8	0	8	9	10	20	\$500,001 or more	\$400,001 to \$500,000	\$325,001 to \$400,000	\$275,001 to \$325,000	\$175,001 to \$275,000	\$175,000 or less	6	
	2		-9	-8	0	8	9	10		Grant/Loan Combination							
								\$750,000 or more	\$600,001 to \$750,000	\$487,501 to \$600,000	\$412,501 to \$487,500	\$262,501 to \$412,500	\$262,500 or less	6			
When scoring a project that is only grant or only loan. Please use the chart labeled "Grant or Loan Only". When scoring a grant/loan combination, score the project for the grant in the first chart, then use the second chart labeled "Grant/Loan Combination" to score the total (grant and loan combined). Use the lower of the two as the score.																	
No.	"A" WEIGHT FACTOR	CRITERIA TO BE CONSIDERED	"B" PRIORITY FACTORS					"A" x "B"	Priority Factors						No.		
									0	2	4	6	8	10			
7	1	Will the Proposed Project Create Permanent jobs or retain jobs that would otherwise be permanently lost (Written Documentation Required)	0	2	4	6	8	10	0	0+ jobs	7+ jobs	15+ jobs	25+ jobs	50+ jobs	100+ jobs	8	
8	1	Benefits to Existing Users such as households, (Equivalent dwelling units), traffic Counts, etc.	0	2	4	6	8	10	4	0+	100+	350+	500+	750+	1000+	9	
9		SUBTOTAL RANKING POINTS (MAX. = 115)						79	Other Info: Does this project have a significant impact on productive farmland? YES NO Attach impact statement if yes. Is the Applicant ready to proceed to bids after State Approval within 6 months? YES NO								
10		COUNTY PRIORITY POINTS (25-2015)						20	LTP								
11		DISCRETIONARY POINTS (BY DISTRICT ONLY) (MAX = 12)															
12		GRAND TOTAL RANKING POINTS						99									

* Applicants must certify local share contribution. Specify, all funding sources to be utilized as local share at the time of application submittal.