

**Ohio Public Works Commission
District 5 Round 34**

**Cedar TR #1041, Martin-Williston TR #7,
Walbridge East TR #68, & Russell TR #128
Roads Resurfacing**

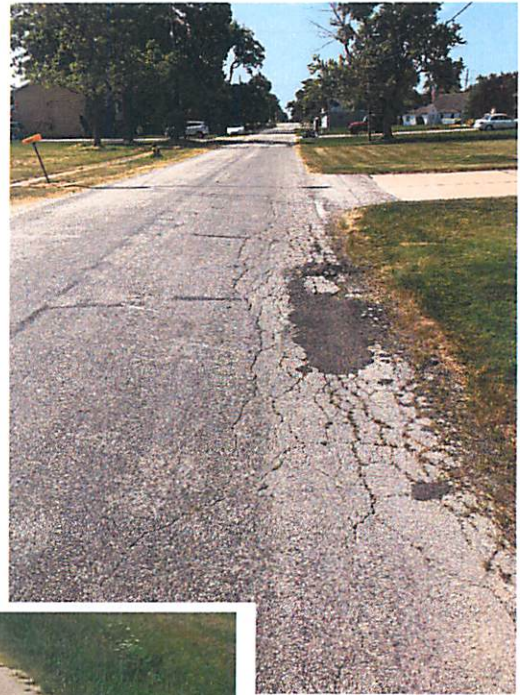

**Benton Township
Ottawa County, Ohio**

**Cedar TR #1041, Martin-Williston TR #7,
Walbridge East TR #68 &
Russell Road TR #128 Roads Resurfacing
Table of Contents**

OPWC Application

Resolution and Cooperative Agreement

Financial Certifications

Engineer's Estimate

Traffic Counts

Road Cards

Condition Ratings

Supporting Items:

Project Narratives

Maps

Photos

Road Detail Sheets

Letters of Support

Questionnaire

Priority Rating Sheet



State of Ohio
Public Works Commission
Application for Financial Assistance

IMPORTANT: Please consult "Instructions for Financial Assistance for Capital Infrastructure Projects" for guidance in completion of this form.

Applicant

Applicant: Benton Township Subdivision Code: 123-05620

District Number: 5 County: Ottawa Date: 09/06/2019

Contact: Ronald P. Lajti, Jr., P.E., P.S. Phone: (419) 734-6777
(The individual who will be available during business hours and who can best answer or coordinate the response to questions)

Email: rlajti@co.ottawa.oh.us FAX: (419) 734-6768

Project

Project Name: Cedar TR1041 Martin-Williston TR7 Walbridge East TR68 Russell Rd TR128 Roads Resurfacing Zip Code: 43432

Subdivision Type

(Select one)

- ☐ 1. County
☐ 2. City
☒ 3. Township
☐ 4. Village
☐ 5. Water (6119 Water District)

Project Type

(Select single largest component by \$)

- ☒ 1. Road
☐ 2. Bridge/Culvert
☐ 3. Water Supply
☐ 4. Wastewater
☐ 5. Solid Waste
☐ 6. Stormwater

Funding Request Summary

(Automatically populates from page 2)

Total Project Cost: 477,408.00
1. Grant: 238,704.00
2. Loan: 40,000.00
3. Loan Assistance/
Credit Enhancement: 0.00
Funding Requested: 278,704.00

District Recommendation (To be completed by the District Committee)

Funding Type Requested

(Select one)

- ☐ State Capital Improvement Program
☐ Local Transportation Improvement Program
☐ Revolving Loan Program
☐ Small Government Program

SCIP Loan - Rate: _____ % Term: _____ Yrs Amount: _____ .00

RLP Loan - Rate: _____ % Term: _____ Yrs Amount: _____ .00

Grant: Amount: _____ .00

LTIP: Amount: _____ .00

District SG Priority: _____ Loan Assistance / Credit Enhancement: Amount: _____ .00

For OPWC Use Only

STATUS

Project Number: _____ Grant Amount: _____ .00 Loan Type: ☐ SCIP ☐ RLP
_____ Loan Amount: _____ .00 Date Construction End: _____
_____ Total Funding: _____ .00 Date Maturity: _____
Release Date: _____ Local Participation: _____ % Rate: _____ %
OPWC Approval: _____ OPWC Participation: _____ % Term: _____ Yrs

1.0 Project Financial Information (All Costs Rounded to Nearest Dollar)

1.1 Project Estimated Costs

Engineering Services

Preliminary Design:	_____	.00	
Final Design:	<u>1,000</u>	.00	
Construction Administration:	<u>9,000</u>	.00	
Total Engineering Services:	a.) <u>10,000</u>	.00	<u>2</u> %
Right of Way:	b.) _____	.00	
Construction:	c.) <u>424,007</u>	.00	
Materials Purchased Directly:	d.) _____	.00	
Permits, Advertising, Legal:	e.) <u>1,000</u>	.00	
Construction Contingencies:	f.) <u>42,401</u>	.00	<u>10</u> %
Total Estimated Costs:	g.) <u>477,408</u>	.00	

1.2 Project Financial Resources

Local Resources

Local In-Kind or Force Account:	a.) _____	.00	
Local Revenues:	b.) <u>198,704</u>	.00	
Other Public Revenues:	c.) _____	.00	
ODOT / FHWA PID: _____	d.) _____	.00	
USDA Rural Development:	e.) _____	.00	
OEPA / OWDA:	f.) _____	.00	
CDBG:	g.) _____	.00	
<input type="checkbox"/> County Entitlement or Community Dev. "Formula"			
<input type="checkbox"/> Department of Development			
Other: _____	h.) _____	.00	
Subtotal Local Resources:	i.) <u>198,704</u>	.00	<u>42</u> %

OPWC Funds (Check all requested and enter Amount)

Grant: <u>86</u> % of OPWC Funds	j.) <u>238,704</u>	.00	
Loan: <u>14</u> % of OPWC Funds	k.) <u>40,000</u>	.00	
Loan Assistance / Credit Enhancement:	l.) <u>0</u>	.00	
Subtotal OPWC Funds:	m.) <u>278,704</u>	.00	<u>58</u> %
Total Financial Resources:	n.) <u>477,408</u>	.00	<u>100</u> %

1.3 Availability of Local Funds

Attach a statement signed by the Chief Financial Officer listed in section 5.2 certifying all local resources required for the project will be available on or before the earliest date listed in the Project Schedule section. The OPWC Agreement will not be released until the local resources are certified. Failure to meet local share may result in termination of the project. Applicant needs to provide written confirmation for funds coming from other funding sources.

2.0 Repair / Replacement or New / Expansion

2.1 Total Portion of Project Repair / Replacement:	<u>477,408 .00</u>	<u>100</u> %
2.2 Total Portion of Project New / Expansion:	<u>0 .00</u>	<u>0</u> %
2.3 Total Project:	<u>477,408 .00</u>	<u>100</u> %

A Farmland
Preservation letter is
required for any
impact to farmland

3.0 Project Schedule

3.1 Engineering / Design / Right of Way	Begin Date: <u>01/01/2020</u>	End Date: <u>06/30/2020</u>
3.2 Bid Advertisement and Award	Begin Date: <u>07/01/2020</u>	End Date: <u>08/15/2020</u>
3.3 Construction	Begin Date: <u>08/16/2020</u>	End Date: <u>06/30/2021</u>

Construction cannot begin prior to release of executed Project Agreement and issuance of Notice to Proceed.

Failure to meet project schedule may result in termination of agreement for approved projects.
Modification of dates must be requested in writing by project official of record and approved by the Commission once the Project Agreement has been executed.

4.0 Project Information

If the project is multi-jurisdictional, information must be consolidated in this section.

4.1 Useful Life / Cost Estimate / Age of Infrastructure

Project Useful Life: 12 Years Age: 1997 (Year built or year of last major improvement)

Attach Registered Professional Engineer's statement, with seal or stamp and signature confirming the project's useful life indicated above and detailed cost estimate.

4.2 User Information

Road or Bridge: Current ADT 1,172 Year 2019 Projected ADT 1,430 Year 2039

Water / Wastewater: Based on monthly usage of 4,500 gallons per household; attach current ordinances.

Residential Water Rate Current \$ _____ Proposed \$ _____

Number of households served: _____

Residential Wastewater Rate Current \$ _____ Proposed \$ _____

Number of households served: _____

Stormwater: Number of households served: _____

4.3 Project Description

- A: SPECIFIC LOCATION (Supply a written location description that includes the project termini; a map does not replace this requirement.) 500 character limit.

Ottawa County - Allen Township

Martin-Williston Road TR #7 - Trowbridge Road to SR 579

Cedar Street TR #1041 - Curtice East & West to the township line

Ottawa County - Benton Township

Walbridge East Road TR #68 - Stange Road to SR 590

Ottawa County - Carroll Township

Russell Road TR #127 - Duff-Washa to SR 2

- B: PROJECT COMPONENTS (Describe the specific work to be completed; the engineer's estimate does not replace this requirement) 1,000 character limit.

Martin-Williston Road

1. Apply an asphalt concrete scratch/leveling course to profile and smooth the roadway surface.
2. Overlay entire road with cold mix leveling course.
3. Apply compacted aggregate berm stone.

Cedar Street

Apply 1.75" asphalt concrete surface course

Walbridge East Road

1. Apply an asphalt concrete scratch/leveling course to profile and smooth the roadway surface.
2. Overlay entire road with cold mix leveling course.
3. Apply compacted aggregate berm stone.

Russell Road

1. Perform spot pavement repairs as necessary to fix isolated pavement failures
2. Apply 0.75" asphalt concrete scratch/leveling course to profile and smooth the roadway surface.
3. Overlay with 1.25" asphalt concrete surface course.
4. Apply compacted aggregate berm stone.

- C: PHYSICAL DIMENSIONS (Describe the physical dimensions of the existing facility and the proposed facility. Include length, width, quantity and sizes, mgd capacity, etc in detail.) 500 character limit.

Martin-Williston Road TR #7 - 2.01 miles long, 18.5 feet wide

Cedar Street TR #1041 - 0.14 miles long, 19.0 feet wide

Walbridge East Road TR #68 - 1 mile long, 18.0 feet wide

Russell Road TR #128 - 0.52 miles long, 18 feet wide

5.0 Project Officials

Changes in Project Officials must be submitted in writing from an officer of record.

5.1 Chief Executive Officer

(Person authorized in legislation to sign project agreements)

Name: James Buhro
Title: Benton Township Trustee
Address: 1670 Walker Street
P. O. Box 7
City: Graytown State: OH Zip: 43452
Phone: (419) 862-3774
FAX: (419) 862-1738
E-Mail: jrbuhro54@gmail.com

5.2 Chief Financial Officer

(Can not also serve as CEO)

Name: Gayle Millinger
Title: Benton Township Fiscal Officer
Address: 1670 Walker Street
P. O. Box 7
City: Graytown State: OH Zip: 43452
Phone: (419) 862-3774
FAX: (419) 862-1738
E-Mail: _____

5.3 Project Manager

Name: Ronald P. Lajti Jr. P.E., P.S.
Title: Ottawa County Engineer
Address: 8247 W State Route #163

City: Oak Harbor State: OH Zip: 43449
Phone: (419) 734-6777
FAX: (419) 734-6768
E-Mail: rlajti@co.ottawa.oh.us

6.0 Attachments / Completeness review

Confirm in the boxes below that each item listed is attached (Check each box)

- ☒ A certified copy of the legislation by the governing body of the applicant authorizing a designated official to sign and submit this application and execute contracts. This individual should sign under 7.0, Applicant Certification, below.
- ☒ A certification signed by the applicant's chief financial officer stating the amount of all local share funds required for the project will be available on or before the dates listed in the Project Schedule section. If the application involves a request for loan (RLP or SCIP), a certification signed by the CFO which identifies a specific revenue source for repaying the loan also must be attached. Both certifications can be accomplished in the same letter.
- ☒ A registered professional engineer's detailed cost estimate and useful life statement, as required in 164-1-13, 164-1-14, and 164-1-16 of the Ohio Administrative Code. Estimates shall contain an engineer's seal or stamp and signature.
- ☒ A cooperative agreement (if the project involves more than one subdivision or district) which identifies the fiscal and administrative responsibilities of each participant.
- ☐ Farmland Preservation Review - The Governor's Executive Order 98-IV, "Ohio Farmland Protection Policy" requires the Commission to establish guidelines on how it will take protection of productive agricultural and grazing land into account in its funding decision making process. Please include a Farm Land Preservation statement for projects that have an impact on farmland.
- ☐ Capital Improvements Report. CIR Required by O.R.C. Chapter 164.06 on standard form.
- ☒ Supporting Documentation: Materials such as additional project description, photographs, economic impact (temporary and/or full time jobs likely to be created as a result of the project), accident reports, impact on school zones, and other information to assist your district committee in ranking your project. Be sure to include supplements which may be required by your local District Public Works Integrating Committee.

7.0 Applicant Certification

The undersigned certifies: (1) he/she is legally authorized to request and accept financial assistance from the Ohio Public Works Commission as identified in the attached legislation; (2) to the best of his/her knowledge and belief, all representations that are part of this application are true and correct; (3) all official documents and commitments of the applicant that are part of this application have been duly authorized by the governing body of the applicant; and, (4) should the requested financial assistance be provided, that in the execution of this project, the applicant will comply with all assurances required by Ohio Law, including those involving Buy Ohio and prevailing wages.

Applicant certifies that physical construction on the project as defined in the application has NOT begun, and will not begin until a Project Agreement for this project has been executed with the Ohio Public Works Commission. Action to the contrary will result in termination of the agreement and withdrawal of Ohio Public Works Commission funding from the project.

James Buhro, Benton Township Trustee

Certifying Representative (Printed form, Type or Print Name and Title)

James Buhro 8/28/19
Original Signature / Date Signed

The Board of Trustees of Benton Township, Allen Township, and Carroll Township, Ottawa County, Ohio, met in special session at the Ottawa County Engineer's Office, 8247 W State Route #163, Oak Harbor, Ohio on August 28, 2019 with the following in attendance:

Benton Township: James Buhro, William Belkofer, David Millinger, Gayle Millinger
Allen Township: Ernest Cottrell, Jr., Scott Everhardt, Sonia Eischen
Carroll Township: Jordan Moore, Sandra Shearon

Jordan Moore, Carroll Township made the motion, second by **Scott Everhardt, Allen Township** to adopt the following resolution:

Resolution Number: **SM-2019-02**
Cedar TR #1041, Martin-Williston TR #7, Walbridge East TR #68
& Russell TR #128 Roads Resurfacing
Issue I Round 34 Ohio Public Works Grant/Loan Application
Cooperation Agreement
Date **August 28, 2019**

Whereas, the State Capital Improvement Program and the Local Transportation Improvement Program both provide financial assistance to political subdivisions for capital improvements to public infrastructure, and

Whereas, Benton Township, Allen Township and Carroll Township are planning to make capital improvements to various roads in their respective townships, and

Whereas, the infrastructure improvements are considered to be a priority need for the communities and are qualified under the OPWC program, and

Whereas Benton, Allen and Carroll Townships will execute a cooperation agreement for a joint road resurfacing project under Ohio Public Works Commission Issue 1, Round 34, in the amount of \$477,408

Be it resolved, Benton Township, Allen Township, and Carroll Township, all of Ottawa County, Ohio, agree to enter into a cooperation agreement to submit an application to the Ohio Public Works Commission for the Cedar TR #1041, Martin-Williston TR #7, Walbridge East TR #68 & Russell TR #128 Roads Resurfacing Project, and

Resolved, further agree to the following:

1. Benton, Allen and Carroll Townships agree to provide a percentage of the total project costs based upon the Engineer's Estimates for their individual road projects. The preliminary ratio of cost sharing is:

Benton Township: \$133,305 or 28%
Allen Township: \$267,607 or 56%
Carroll Township: \$ 76,496 or 16%
2. All participants agree that the proportions listed above are preliminary and subject to change based upon the final construction costs of each road in the application. It is further agreed that any loan funding received through this application will be split among the townships according to the percentage of final construction costs for this project.
3. Benton, Allen and Carroll Townships will each be responsible for cost overages for only their roads.
4. Benton Township, Allen Township and Carroll Township agree to pay their portion of the costs as invoiced by the County Engineer.
5. Allen Township and Carroll Township agree to submit their loan payments, if any, to Benton Township a minimum of 30 days prior to the Ohio Public Works loan repayment due date.

5. Allen Township and Carroll Township agree to submit their loan payments, if any, to Benton Township a minimum of 30 days prior to the Ohio Public Works loan repayment due date.
6. Benton Township agrees to submit loan payments to the Ohio Public Works Commission on behalf of all parties by the due date.
7. Benton Township, Allen Township and Carroll Townships authorize the following:
 - Section 1: Benton Township to serve as lead applicant
 - Section 2: James Buhro, Benton Township Trustee, is hereby authorized and directed to apply to the OPWC for funds for the above described project.
 - Section 3: James Buhro, Benton Township Trustee, is further authorized to enter into any agreements as may be necessary and appropriate for obtaining this financial assistance.

The resolution was duly adopted this 28th day of August, 2019.

Benton Township:

James Buhro

William Belkofer

David Millinger

Allen Township:

Ernest Cottrell, Jr.

Scott Everhardt

Craig Blausey

Carroll Township:

Jordan Moore

James Meek

Sandra Shearon

I, Gayle Millinger, Fiscal Officer of Benton Township, Ottawa County, Ohio, hereby do certify that the above Joint Board entered into this agreement this 28th day of August 2019 in a special meeting as stated.

Gayle Millinger
Benton Township Fiscal Officer

**Benton Township Board of Trustees
Ottawa, County, Ohio
1670 N Walker St. PO Box 7
Graytown, Ohio 43432**

Trustees

James Buhro 419-707-2849
David Millinger 419-340-2584
Bill Belkofer 419-340-3082

Fiscal Officer

Gayle Millinger 419-707-1070

I, Gayle Millinger, Fiscal Officer of Benton Township, hereby certify that Benton Township will have the amount of \$55,452 in the Gas Tax Fund and that this amount will be used to pay the local share for the Cedar TR #1041, Martin-Williston TR #7, Walbridge East TR #68 and Russell TR #128 Roads Resurfacing Project when it is required.

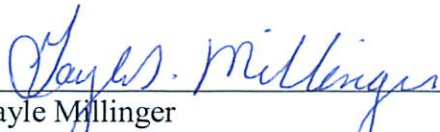

Gayle Millinger
Benton Township Fiscal Officer

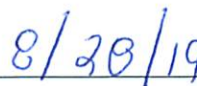

Date

Allen Township Trustees
P.O. Box 440, Williston, Ohio 43468-0440
Phone/Fax (419) 836-4204

Scott Everhardt
22459 Bittersweet Lane
Curtice, OH 43412 419 836-9614

Ernest Cottrell
22095 Honeysuckle Lane
Curtice, OH 43412 419 340-7013

Craig Blausey
4907 N. Martin-Williston Road
Martin, OH 43445 419 855-9056

Sonia Eischen, Fiscal Officer
4683 N. Martin-Williston Road
Martin, OH 43445 419 855-9886

August 28, 2019

To Whom It May Concern:

I, Sonia Eischen, Fiscal Officer of Allen Township, hereby certify that Allen Township will have the amount of \$111,404 in the gas tax and/or road and bridge funds and that this amount will be used to pay the local share for the Cedar TR #1041, Martin-Williston TR #7, Walbridge East TR #68 and Russell TR #128 Roads Resurfacing Project when it is required.



Sonia Eischen
Allen Township Fiscal Officer



Date

Carroll Township Trustees

OTTAWA COUNTY

11080 W. Toussaint E. Road ♦ Oak Harbor, Ohio 43449
419-898-9621

I, Tina Gyde, Fiscal Officer of Carroll Township, hereby certify that Carroll Township will have the amount of \$31,848 in the Gas Tax Fund and that this amount will be used to pay the local share for the Cedar TR #1041, Martin-Williston TR #7, Walbridge East TR #68 and Russell TR #128 Roads Resurfacing Project when it is required.



Tina Gyde
Carroll Township Fiscal Officer



Date

James Meek
Trustee
419-707-0445

Sandra Shearon
Trustee
419-898-0936

Jordan Moore
Trustee
419-346-0029

Tina Gyde
Fiscal Officer
419-265-0848

**Benton Township Board of Trustees
Ottawa, County, Ohio
1670 N Walker St. PO Box 7
Graytown, Ohio 43432**

Trustees

James Buhro 419-707-2849
David Millinger 419-340-2584
Bill Belkofer 419-340-3082

Fiscal Officer

Gayle Millinger 419-707-1070

I, Gayle Millinger, Fiscal Officer of Benton Township, hereby certify that Benton Township will collect the amount of \$40,000 in the Gas Tax Fund and that this amount will be used to repay the Ohio Public Works Commission SCIP or RLP loan requested for the Cedar TR #1041, Martin-Williston TR #7, Walbridge East TR #68 and Russell TR #128 Roads Resurfacing Project over a term of ten years.

Benton Township will collect loan payments from Allen Township and Carroll Township, co- applicants for this application, thirty days prior to the Ohio Public Works due date. Benton Township will submit payments to the Ohio Public Works Commission on the behalf of all three townships.

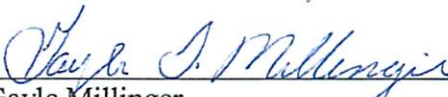

Gayle Millinger
Benton Township Fiscal Officer

9/3/2019

Date

Allen Township Trustees
P.O. Box 440, Williston, Ohio 43468-0440
Phone/Fax (419) 836-4204

Scott Everhardt
22459 Bittersweet Lane
Curtice, OH 43412 419 836-9614

Ernest Cottrell
22095 Honeysuckle Lane
Curtice, OH 43412 419 340-7013

Craig Blausey
4907 N. Martin-Williston Road
Martin, OH 43445 419 855-9056

Sonia Eischen, Fiscal Officer
4683 N. Martin-Williston Road
Martin, OH 43445 419 855-9886

August 28, 2019

To Whom It May Concern:

I, Sonia Eischen, Fiscal Officer of Allen Township, hereby certify that Allen Township will collect the amount of \$22,400 in the gas tax and/or road and bridge funds and that this amount will be used to repay the Ohio Public Works Commission SCIP or RLP loan requested for the Cedar TR #1041, Martin-Williston TR #7, Walbridge East TR #68 and Russell TR #128 Roads Resurfacing Project over a term of ten years.

Allen Township will submit loan payments to Benton Township, the lead applicant for this application, thirty days prior to the Ohio Public Works due date. Benton Township will submit payments to the Ohio Public Works Commission on our behalf.



Sonia Eischen
Allen Township Fiscal Officer

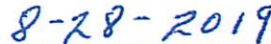

Date

Carroll Township Trustees

OTTAWA COUNTY

11080 W. Toussaint E. Road ♦ Oak Harbor, Ohio 43449
419-898-9621

I, Tina Gyde, Fiscal Officer of Carroll Township, hereby certify that Carroll Township will collect the amount of \$6,400 in the Gas Tax Fund and that this amount will be used to repay the Ohio Public Works Commission SCIP or RLP loan requested for the Cedar TR #1041, Martin-Williston TR #7, Walbridge East TR #68 and Russell TR #128 Roads Resurfacing Project over a term of ten years.

Carroll Township will submit loan payments to Benton Township, the lead applicant for this application, thirty days prior to the Ohio Public Works due date. Benton Township will submit payments to the Ohio Public Works Commission on our behalf.



Tina Gyde
Carroll Township Fiscal Officer



Date

James Meek
Trustee
419-707-0445

Sandra Shearon
Trustee
419-898-0936

Jordan Moore
Trustee
419-346-0029

Tina Gyde
Fiscal Officer
419-265-0848

**Cedar TR #1041, Martin-Williston TR #7, Walbridge East TR #68 &
Russell TR #128 Roads Resurfacing**

Item	Qty	Units	Description	Unit Price	Total
Cedar Street TR #1041 (Allen Twp)					
407	127	GALS	TACK COAT (SURFACE)	\$ 2.25	\$ 286.00
441	179	TON	1.75" ASPHALT CONCRETE SURFACE COURSE, TYPE 1, PG64	\$ 85.00	\$ 15,215.00
614	LUMP	SUM	MAINTENANCE OF TRAFFIC	\$ 1,500.00	\$ 1,500.00
103.05	LUMP	SUM	CONTRACT BOND	\$ 256.00	\$ 256.00
			Subtotal - Cedar Street		\$ 17,257.00
Martin-Williston Road TR #7 (Allen Twp)					
405	1759	TONS	#67 STONE	\$ 54.00	\$ 94,986.00
405	129	TONS	CHOKE COAT, #9 STONE	\$ 58.00	\$ 7,482.00
405	21804	GALS	CM-150, BITUMINOUS MATERIAL	\$ 3.40	\$ 74,134.00
411	392	TONS	BERM STONE	\$ 26.00	\$ 10,192.00
441	267	TONS	0.75" ASPHALT CONCRETE INTERMEDIATE (SCRATCH), TYPE 1	\$ 92.00	\$ 24,564.00
614	LUMP	SUM	MAINTENANCE OF TRAFFIC	\$ 6,000.00	\$ 6,000.00
103.05	LUMP	SUM	CONTRACT BOND	\$ 3,261.00	\$ 3,261.00
			Subtotal - Martin-Williston Road		\$ 220,619.00
Walbridge East Road TR #68 (Benton Twp)					
405	836	TONS	#67 STONE	\$ 54.00	\$ 45,144.00
405	67	TONS	CHOKE COAT, #9 STONE	\$ 58.00	\$ 3,886.00
405	10363	GALS	CM-150, BITUMINOUS MATERIAL	\$ 3.40	\$ 35,235.00
441	239	TON	ASPHALT CONCRETE INTERMEDIATE (SCRATCH), TYPE 1	\$ 92.00	\$ 21,988.00
411	244	TONS	BERM STONE	\$ 26.00	\$ 6,344.00
614	LUMP	SUM	MAINTENANCE OF TRAFFIC	\$ 4,000.00	\$ 4,000.00
103.05	LUMP	SUM	CONTRACT BOND	\$ 1,749.00	\$ 1,749.00
			Subtotal - Walbridge East Road		\$ 118,346.00
Russell Road TR #128 (Carroll Twp)					
253	38	CY	PAVEMENT REPAIR	\$ 240.00	\$ 9,120.00
407	763	GALS	TACK COAT	\$ 2.10	\$ 1,603.00
441	227	TON	0.75" ASPHALT CONCRETE INTERMEDIATE, TYPE 1	\$ 78.00	\$ 17,706.00
441	395	TON	1.25" ASPHALT CONCRETE SURFACE COURSE, TYPE 1, PG64-22	\$ 78.00	\$ 30,810.00
411	101	TON	BERM STONE	\$ 26.00	\$ 2,626.00
642	0.52	MILE	CENTERLINE, TYPE 1	\$ 900.00	\$ 468.00
642	18.00	LF	STOPBAR	\$ 25.00	\$ 450.00
614	LUMP	SUM	MAINTENANCE OF TRAFFIC	\$ 4,000.00	\$ 4,000.00
103.05	LUMP	SUM	CONTRACT BOND	\$ 1,002.00	\$ 1,002.00
			Subtotal - Russell Road		\$ 67,785.00

**Cedar TR #1041, Martin-Williston TR #7, Walbridge East TR #68 &
Russell TR #128 Roads Resurfacing**

			SUBTOTAL		\$ 424,007.00
			ENGINEERING		\$ 10,000.00
			PERMITS, LEGAL, ADVERTISING		\$ 1,000.00
			CONTINGENCIES	10%	\$ 42,401.00

Total

\$ 477,408.00

This Estimate was Prepared by :

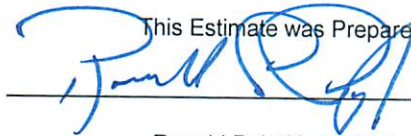

Ronald P. Lajti, Jr., P.E., P.S.
Ottawa County Engineer
Project Life will be 12 years



***Cedar TR #1041, Martin-Williston TR #7, Walbridge East TR #68, &
Russell Road TR #128 Roads Resurfacing***

Traffic Counts - Actual and Estimated
Ottawa County - Issue I 2019

Road Name	Road Number	Begin	End	Year	ADT actual	ADT 2038 - 39 est.
Cedar	TR #1041	Curtice East/West	Township Line	2019	286	349
Martin-Williston	TR #7	Trowbridge	SR 579	2019	352	430
Walbridge East	TR #68	Stange	SR 590	2018	118	144
Russell	TR #128	Duff-Washa	SR 2	2019	416	508
			Total		1172	1430

Estimates are based on actual 2018 and 2019 traffic counts.

MetroCount Traffic Executive Vehicle Counts (Virtual Day)

VirtVehicleCount-98 -- English (ENU)

Datasets:

Site: **ALL-T1041-0.20**
Direction: 7 - North bound A>B, South bound B>A. **Lane:** 0
Survey Duration: 10:00 Wednesday, July 03, 2019 => 11:19 Friday, July 12, 2019
Zone:
File: ALL-T1041-0.20.EC0 (Plus)
Identifier: DH578K2B MC56-L5 [MC55] (c)Microcom 19Oct04
Algorithm: Factory default (v3.21 - 15275)
Data type: Axle sensors - Paired (Class/Speed/Count)

Profile:

Filter time: 10:00 Wednesday, July 03, 2019 => 11:19 Friday, July 12, 2019
Included classes: 1, 2, 3, 4, 5, 6, 7, 8, 9, 10, 11, 12, 13
Speed range: 10 - 160 km/h.
Direction: North, East, South, West (bound)
Separation: All - (Headway)
Name: Default Profile
Scheme: Vehicle classification (Scheme F)
Units: Metric (meter, kilometer, m/s, km/h, kg, tonne)
In profile: Vehicles = 2597 / 2623 (99.01%)

VirtVehicleCount-98 Page 2

* **Virtual Day - Total=286, 15 minute drops**

0000	0100	0200	0300	0400	0500	0600	0700	0800	0900	1000	1100	1200	1300	1400	1500	1600	1700	1800	1900	2000	2100	2200	2300
3	1	1	0	1	4	7	10	9	12	16	22	20	21	18	22	25	22	21	16	14	11	6	3
1	0	0	0	0	0	2	3	2	3	3	6	5	5	4	4	6	6	5	5	5	4	2	1
1	0	0	0	0	0	2	1	3	2	4	6	5	5	5	6	6	5	4	3	3	3	2	1
0	0	0	0	0	3	1	3	3	4	5	5	5	5	4	5	7	5	5	5	3	2	1	1
1	0	0	0	0	1	2	3	2	3	4	5	5	6	4	6	6	6	7	4	3	2	2	1

AM Peak 1100 - 1200 (22), AM PHF=0.89 PM Peak 1600 - 1700 (25), PM PHF=0.90

Numbers have been rounded to the nearest integer.

MetroCount Traffic Executive Vehicle Counts (Virtual Day)

VirtVehicleCount-97 -- English (ENU)

Datasets:

Site: **ALL-T0007-2.80**
Direction: 5 - South bound A>B, North bound B>A. Lane: 0
Survey Duration: 11:00 Wednesday, July 03, 2019 => 11:35 Friday, July 12, 2019
Zone:
File: ALL-T0007-2.80.EC0 (Plus)
Identifier: DH81S60X MC56-L5 [MC55] (c)Microcom 19Oct04
Algorithm: Factory default (v3.21 - 15275)
Data type: Axle sensors - Paired (Class/Speed/Count)

Profile:

Filter time: 11:00 Wednesday, July 03, 2019 => 11:35 Friday, July 12, 2019
Included classes: 1, 2, 3, 4, 5, 6, 7, 8, 9, 10, 11, 12, 13
Speed range: 10 - 160 km/h.
Direction: North, East, South, West (bound)
Separation: All - (Headway)
Name: Default Profile
Scheme: Vehicle classification (Scheme F)
Units: Metric (meter, kilometer, m/s, km/h, kg, tonne)
In profile: Vehicles = 3182 / 3186 (99.87%)

VirtVehicleCount-97 Page 2

* Virtual Day - Total=352, 15 minute drops

0000	0100	0200	0300	0400	0500	0600	0700	0800	0900	1000	1100	1200	1300	1400	1500	1600	1700	1800	1900	2000	2100	2200	2300
3	2	1	1	2	4	9	15	14	18	21	20	22	23	29	30	30	25	19	20	18	15	7	5
1	1	0	0	0	1	2	3	3	4	5	6	6	6	6	8	8	8	5	5	5	4	2	1
1	0	1	0	0	0	2	4	2	5	6	4	5	6	6	7	7	6	4	4	4	3	2	1
0	0	1	0	1	2	3	3	5	5	4	5	7	5	8	8	6	6	5	5	4	3	1	1
1	0	0	0	1	1	3	4	4	5	4	6	5	5	9	7	9	5	5	6	5	4	2	1

AM Peak 1145 - 1245 (23), AM PHF=0.88 PM Peak 1430 - 1530 (33), PM PHF=0.91

Numbers have been rounded to the nearest integer.

MetroCount Traffic Executive Vehicle Counts (Virtual Day)

VirtVehicleCount-100 -- English (ENU)

Datasets:

Site: **BEN-TR68-5.35**
Direction: 8 - East bound A>B, West bound B>A. Lane: 0
Survey Duration: 11:00 Friday, July 13, 2018 => 11:52 Monday, July 23, 2018
Zone:
File: BEN-TR68-5.35.EC0 (Plus)
Identifier: DH68A3TH MC56-L5 [MC55] (c)Microcom 19Oct04
Algorithm: Factory default (v3.21 - 15275)
Data type: Axle sensors - Paired (Class/Speed/Count)

Profile:

Filter time: 11:00 Friday, July 13, 2018 => 11:52 Monday, July 23, 2018
Included classes: 1, 2, 3, 4, 5, 6, 7, 8, 9, 10, 11, 12, 13
Speed range: 10 - 160 km/h.
Direction: North, East, South, West (bound)
Separation: All - (Headway)
Name: Default Profile
Scheme: Vehicle classification (Scheme F)
Units: Metric (meter, kilometer, m/s, km/h, kg, tonne)
In profile: Vehicles = 1182 / 1183 (99.92%)

VirtVehicleCount-100 Page 2

* **Virtual Day - Total=118, 15 minute drops**

0000	0100	0200	0300	0400	0500	0600	0700	0800	0900	1000	1100	1200	1300	1400	1500	1600	1700	1800	1900	2000	2100	2200	2300
1	0	0	0	1	1	3	5	5	6	6	7	10	8	7	9	8	11	11	7	6	4	3	1
0	0	0	0	0	0	1	1	1	1	1	2	2	2	2	2	3	3	3	2	2	1	1	0
0	0	0	0	0	0	1	1	1	2	1	2	3	2	2	2	1	3	2	2	1	1	1	1
0	0	0	0	0	1	1	2	2	1	2	1	2	2	2	2	2	3	3	2	2	1	1	0
0	0	0	0	0	0	1	1	1	1	2	2	3	2	1	2	3	2	2	2	1	1	1	0

AM Peak 1145 - 1245 (9), AM PHF=0.71 PM Peak 1645 - 1745 (11), PM PHF=0.92

Numbers have been rounded to the nearest integer.

MetroCount Traffic Executive Vehicle Counts (Virtual Day)

VirtVehicleCount-99 -- English (ENU)

Datasets:

Site: **CAR-C0128-0.20**
Direction: 5 - South bound A>B, North bound B>A. **Lane:** 0
Survey Duration: 11:00 Wednesday, July 03, 2019 => 10:47 Friday, July 12, 2019
Zone:
File: CAR-C0128-0.20.EC0 (Plus)
Identifier: DH68A3TH MC56-L5 [MC55] (c)Microcom 19Oct04
Algorithm: Factory default (v3.21 - 15275)
Data type: Axle sensors - Paired (Class/Speed/Count)

Profile:

Filter time: 11:00 Wednesday, July 03, 2019 => 10:47 Friday, July 12, 2019
Included classes: 1, 2, 3, 4, 5, 6, 7, 8, 9, 10, 11, 12, 13
Speed range: 10 - 160 km/h.
Direction: North, East, South, West (bound)
Separation: All - (Headway)
Name: Default Profile
Scheme: Vehicle classification (Scheme F)
Units: Metric (meter, kilometer, m/s, km/h, kg, tonne)
In profile: Vehicles = 3732 / 3732 (100.00%)

VirtVehicleCount-99 Page 2

* Virtual Day - Total=416, 15 minute drops

0000	0100	0200	0300	0400	0500	0600	0700	0800	0900	1000	1100	1200	1300	1400	1500	1600	1700	1800	1900	2000	2100	2200	2300
2	1	1	2	3	10	12	11	17	20	26	32	36	33	30	33	28	28	23	22	16	15	10	5
1	0	0	0	0	3	4	3	4	3	6	8	9	9	9	9	8	7	6	6	5	4	2	1
0	0	0	1	1	3	2	3	4	6	6	9	7	7	6	9	5	7	5	5	4	4	3	2
0	0	0	0	1	1	3	2	4	4	5	8	10	8	7	7	8	6	6	6	4	4	3	1
0	0	0	1	1	2	3	3	6	6	9	7	10	8	8	8	8	8	6	5	4	3	2	1

AM Peak 1145 - 1245 (33), AM PHF=0.80 PM Peak 1230 - 1330 (37), PM PHF=0.89

Numbers have been rounded to the nearest integer.

COUNTY AND TOWNSHIP ROAD SYSTEM
CONSTRUCTION PROJECT AND LOG RECORD

ROAD NO. T-1041
ROAD NAME Curtice Cedar
SECTION 0.00-0.12
NET LENGTH 0.12/ $\square\square\square T=0.14$
R/W WIDTH 60'
DATE ESTAB.

LOCATION _____

DDOT mileage as of April 2008

DDOT mileage as of April 2008

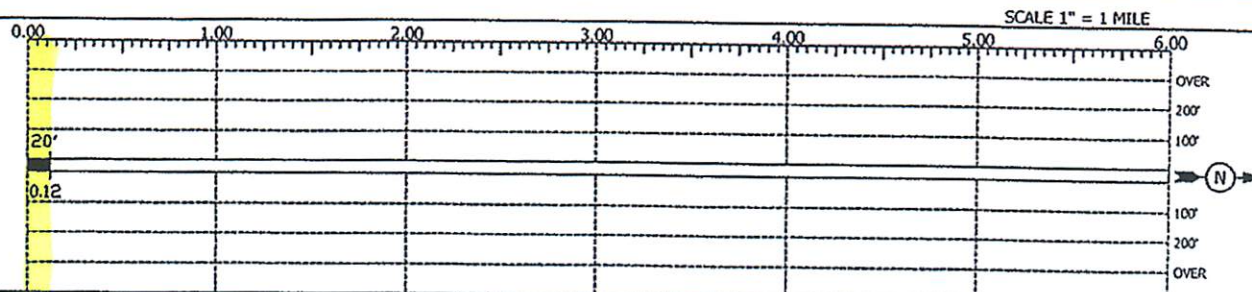
[illegible]

PRIMITIVE
UNIMPROVED
GRADED AND DRAINED
SOIL-SURFACED



GRAVEL OR STONE
BIT. SURFACE-TREATED
MIXED BITUMINOUS
BITUMINOUS PENETRATION



BIT. CONC. OR SHEET ASPHALT
CONCRETE
BRICK
BLOCK



REMARKS

SPECIAL FEATURES	
4 mile in Clay Twp.	
2 mile in Harris Twp.	
1/2 mile due to split with	
Clay Twp. & Sandusky Co.	
1 mile due to split with	
Harris Twp. & Sandusky Co.	

CARD 2 OF 2

LOCATION Begin at Sandusky Co. line and
S.R.105 in Harris Twp. thence north crossing S.R.163,
S.R.120, and Bus. Rt.20
in Clay Twp. thence north crossing S.R.579 and ending
at the Lucas Co. line in Allen Twp.

ODOT mileage as of February 2014

OTTAWA COUNTY COUNTY ENGINEERING DEPARTMENT COUNTY AND TOWNSHIP ROAD SYSTEM CONSTRUCTION PROJECT AND LOG RECORD

ODOT=0.90 HARRIS
ODOT=3.52 CLAY
ODOT=4.24 ALLEN

ROAD NO. T-7
ROAD NAME Martin-Williston
SECTION
NET LENGTH
R/W WIDTH 60'
DATE ESTAB.

SCALE 1" = 1 MILE

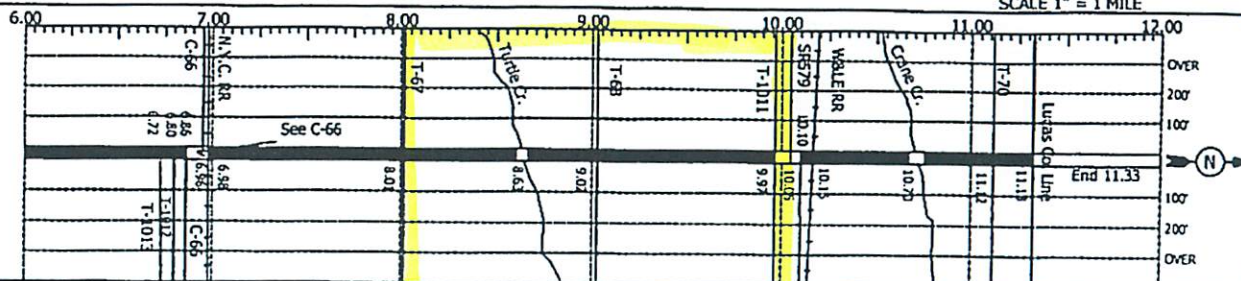

YEAR BUILT	DESCRIPTION OF WORK	COST
1944	Surface: 1" S.T. RT-8 @0.33gal 25lbs #6	
1946	Surface: S.T. See over	
1953	Surface: seal	\$946.32
1953	Surface: seal	\$908.54
1956	100lb drag MC-4	\$7,899
1982	Single seal by Twp. crews	\$29,230.00
1998	150lb drag CM150 2' berm each side	
2013	150lb drag w/#67 stone 0.93gal CM-150, w/choke coat 12lbs. #9	\$79,635.47

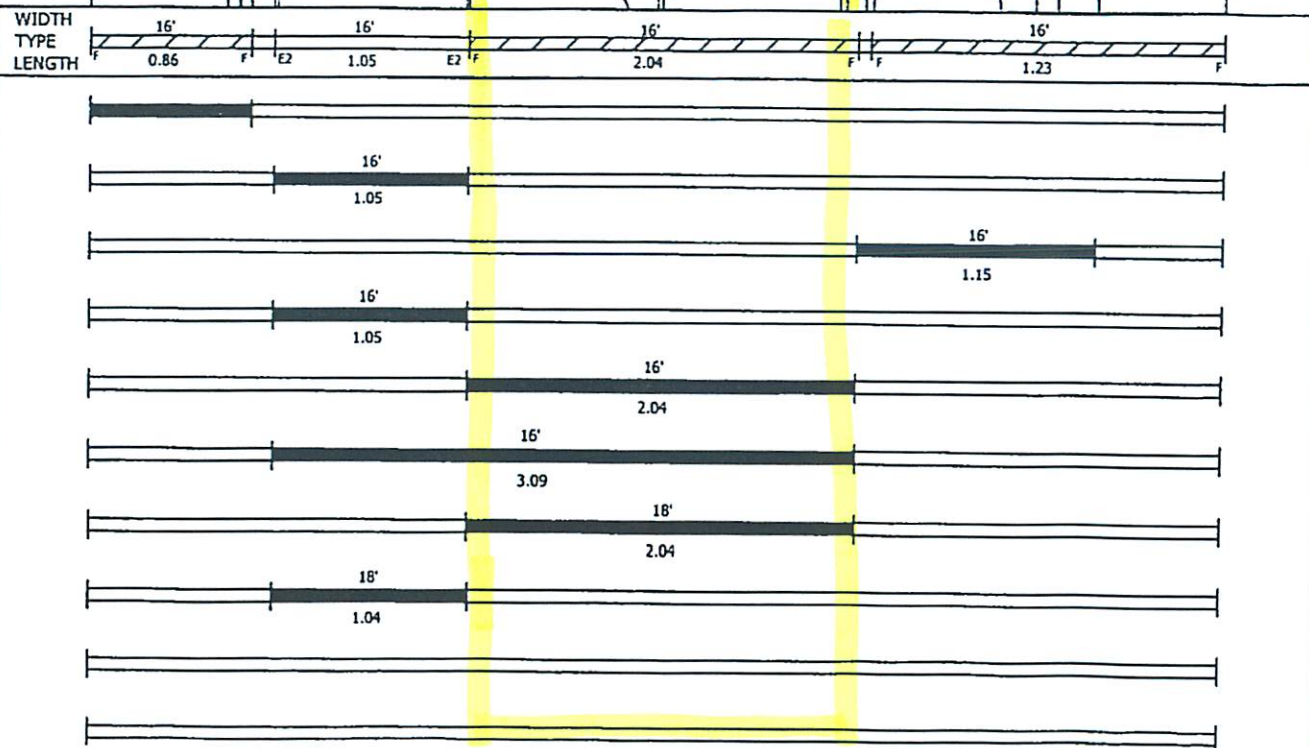

SYMBOLS FOR ROAD TYPES

PRIMITIVE
UNIMPROVED
GRADED AND DRAINED
SOIL-SURFACED



GRAVEL OR STONE
BIT. SURFACE-TREATED
MIXED BITUMINOUS
BITUMINOUS PENETRATION



BIT. CONC. OR SHEET ASPHALT
CONCRETE
BRICK
BLOCK



REMARKS

SPECIAL FEATURES

OTTAWA COUNTY

COUNTY ENGINEERING DEPARTMENT

COUNTY AND TOWNSHIP ROAD SYSTEM
CONSTRUCTION PROJECT AND LOG RECORD

ROAD NO. T-68
 ROAD NAME Walbridge East
 SECTION 0.0-7.17
 NET LENGTH 7.17 / ODOT Benton=4.03
ODOT Allen=3.06
 R/W WIDTH _____
 DATE ESTAB. _____

CARD 2 OF 2

SCALE 1" = 1 MILE

LOCATION

ODOT mileage as of April 2008

YEAR BUILT	DESCRIPTION OF WORK	COST
1948	Surface 1"	\$4,410.45
1950	Surface 1" MC-1 MC-4 RS-2	\$889.51
1970	Single seal by Twp. forces	
1992	Seal by Twp.	
1995	150lb drag CM150 by contract #67 w/12lbs #9	\$7,770.80
1996	seal 0.50gal RS-2 30lbs 8's	\$2,225.00

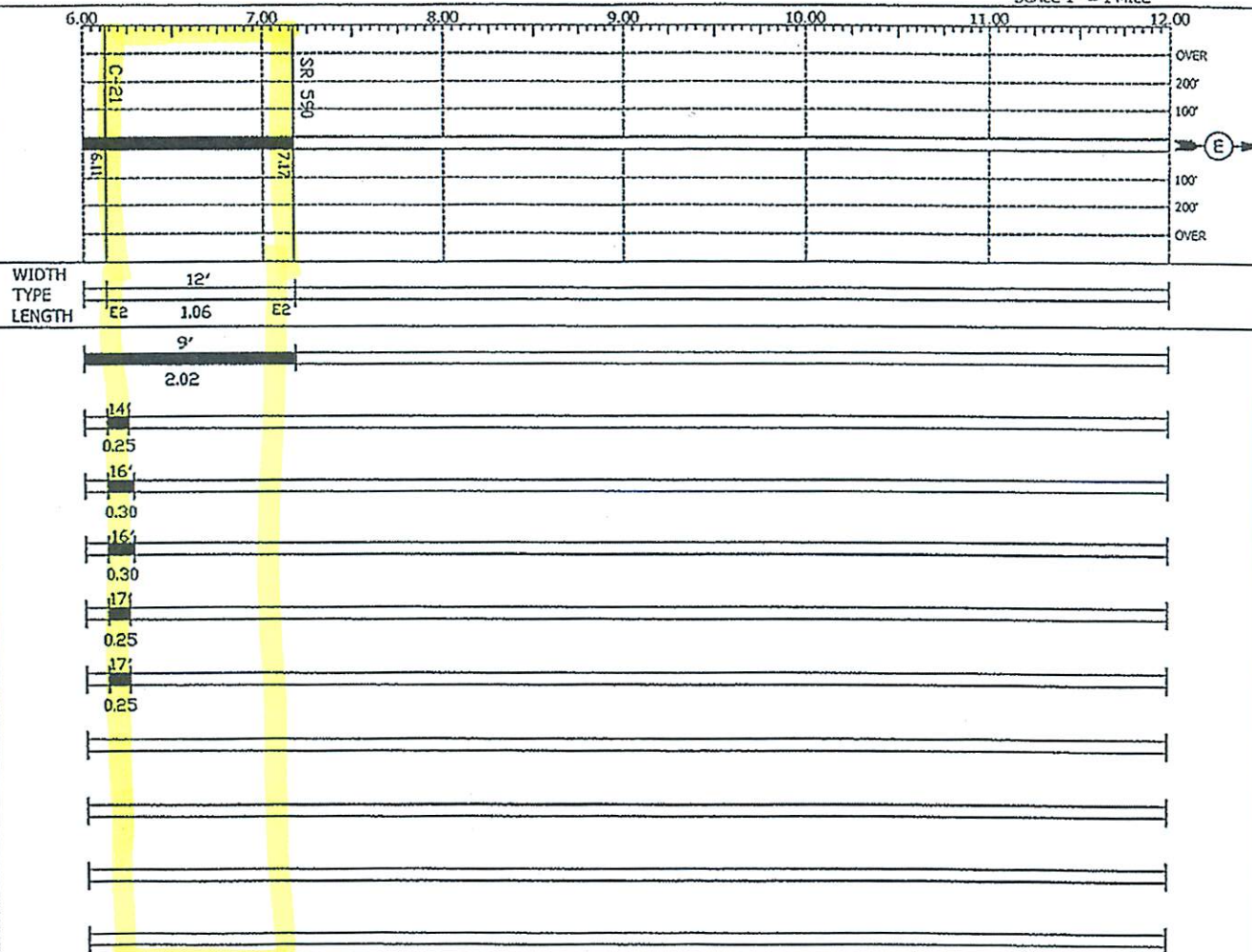

SYMBOLS FOR ROAD TYPES

PRIMITIVE
 UNIMPROVED
 GRADED AND DRAINED
 SOIL-SURFACED



GRAVEL OR STONE
 BIT. SURFACE-TREATED
 MIXED BITUMINOUS
 BITUMINOUS PENETRATION



BIT. CONC. OR SHEET ASPHALT
 CONCRETE
 BRICK
 BLOCK



REMARKS

SPECIAL FEATURES _____

OTTAWA COUNTY

COUNTY ENGINEERING DEPARTMENT

COUNTY AND TOWNSHIP ROAD SYSTEM CONSTRUCTION PROJECT AND LOG RECORD

ROAD NO. T-128
 ROAD NAME Russell
 SECTION 0.00-0.53
 NET LENGTH 0.53
 R/W WIDTH 40'
 DATE ESTAB. _____

CARD 1 OF 1

LOCATION Begin at C-24 in Carroll Twp.
thence north ending at S.R.#2

ODOT mileage confirmed April 2008

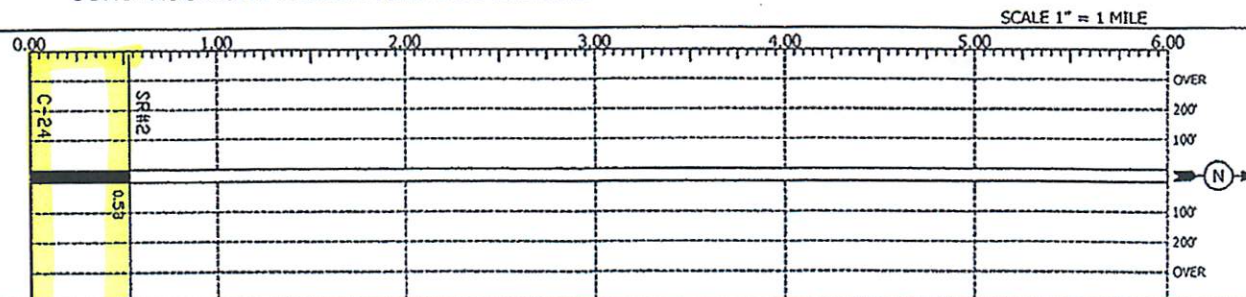

YEAR BUILT	DESCRIPTION OF WORK	COST	WIDTH TYPE LENGTH	
			E2 0.53 E2	
			16'	
1966	1 1/2' drag MC-800 @1.10 #67 @135lbs	\$2,996.64	16'	
			0.53	
1970	single seal 0.40gal MC-3000 30lbs #9	\$870.51	16'	
			0.53	
1983	single seal 0.50gal RS-2 25lbs #8	\$3,476.62	16'	
			0.53	
1994	2 3/4' hot mix +24' berms	\$18,686.13	16'	
			0.53	

SYMBOLS FOR ROAD TYPES		REMARKS _____ _____ _____ _____
PRIMITIVE UNIMPROVED GRADED AND DRAINED SOIL-SURFACED	GRAVEL OR STONE BIT. SURFACE-TREATED MIXED BITUMINOUS BITUMINOUS PENETRATION	

Pavement Condition Rating (PCR) Scale

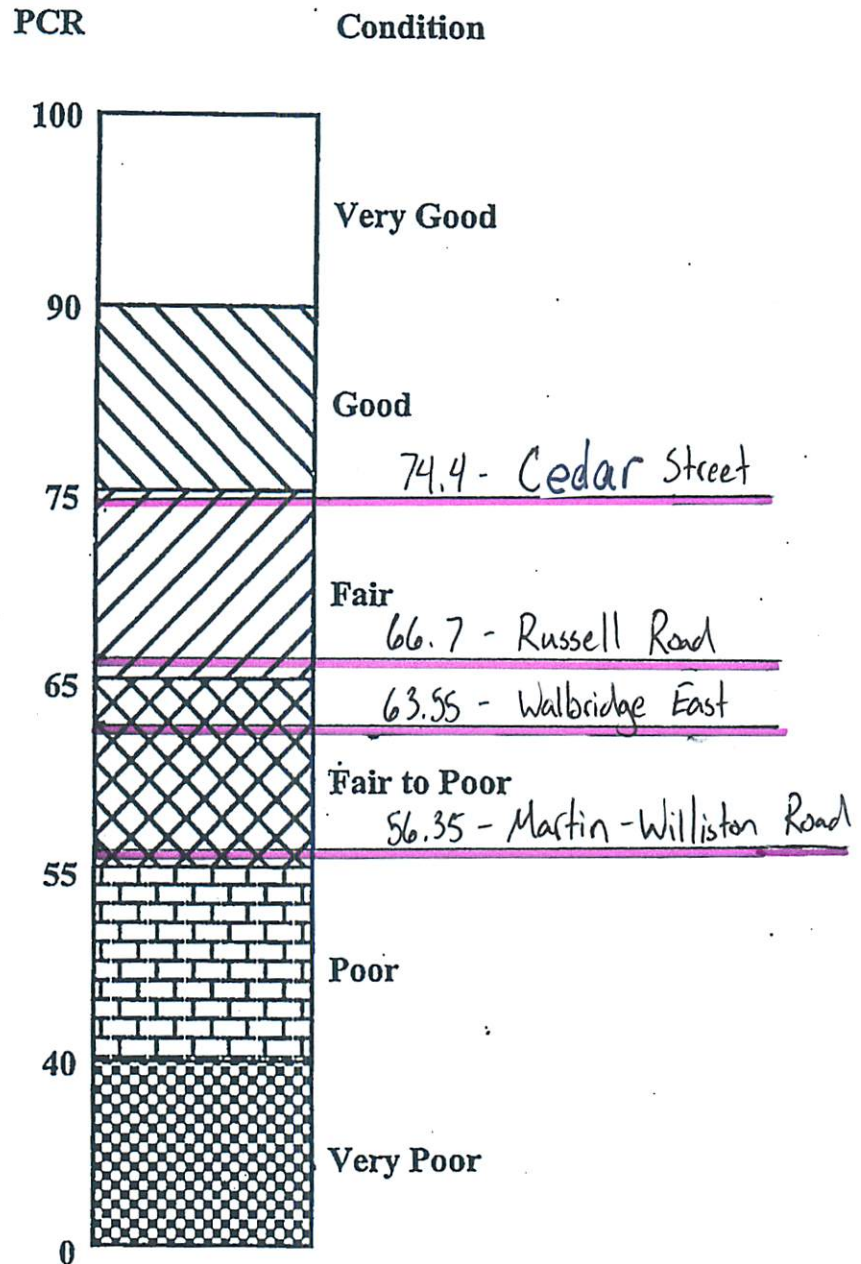

ROAD NAME: CEDAR STREET
 LOG MILE: WILDACRE RD
 TO: COUNTY LINE

FLEXIBLE PAVEMENT CONDITION RATING FORM

DATE: 8/19/2019
 RATED BY: CRM

DISTRESS	DISTRESS WEIGHT	SEVERITY WT.*				EXTENT WT.*				DEDUCT POINTS***
			L	M	H		O	F	E	
RAVELING	10	-	0.3	0.6	1	-	0.5	0.8	1	
BLEEDING	5	-	0.8	0.8	1	-	0.6	0.9	1	
PATCHING	5	H	0.3	0.6	1	E	0.6	0.8	1	5.0
POTHOLE/DEBONDING	10	M	0.4	0.7	1	F	0.5	0.8	1	5.6
CRACK SEALING DEFICIENCY	5	-	1	1	1	-	0.5	0.8	1	
RUTTING	10	M	0.3	0.7	1	E	0.6	0.8	1	7.0
SETTLEMENT	10	H	0.5	0.7	1	F	0.5	0.8	1	8.0
CORRUGATIONS	5	-	0.4	0.8	1	-	0.5	0.8	1	
WHEEL TRACK CRACKING	15	-	0.4	0.7	1	-	0.5	0.7	1	
BLOCK AND TRANSVERSE CRACKING	10	-	0.4	0.7	1	-	0.5	0.7	1	
LONGITUDINAL JOINT CRACKING	5	-	0.4	0.7	1	-	0.5	0.7	1	
EDGE CRACKING	5	-	0.4	0.7	1	-	0.5	0.7	1	
RANDOM CRACKING	5	-	0.4	0.7	1	-	0.5	0.7	1	
TOTAL DEDUCT =										25.6
SUM OF STRUCTURAL DEDUCT (BOLD) =										12.6
100 - TOTAL DEDUCT = PCR =										74.4

*L = LOW
 M = MEDIUM
 H = HIGH

**O = OCCASIONAL
 F = FREQUENT
 E = EXTENSIVE

***DEDUCT POINTS = DISTRESS WEIGHT x SEVERITY WT. x EXTENT WT.

NOTES: OVERALL THIS ROAD IS IN POOR CONDITION. THE ENTIRE ROAD HAS BEEN CHIP SEAL PATCHED IN ORDER TO EXTEND LIFE UNTIL A RESURFACING PROJECT. ROAD HAS RUTTING AND SETTLEMENT. PRIOR TO THE CHIP SEAL THERE WERE EXTENSIVE POTHOLE AND CRACKING. THE SURFACE WAS RAVELING/CRUMBLING AS WELL. THE CHIP SEAL IS A TEMPORARY PATCH AND A MORE PERMANENT FIX IS NEEDED AS SOON AS POSSIBLE.

ROAD NAME: RUSSELL RD
 LOG MILE: DUFF-WASHA ROAD
 TO: SR-2

FLEXIBLE PAVEMENT CONDITION RATING FORM

DATE: 8/19/2019
 RATED BY: CRM

DISTRESS	DISTRESS WEIGHT	SEVERITY WT.*				EXTENT WT.*				DEDUCT POINTS***
			L	M	H		O	F	E	
RAVELING	10	M	0.3	0.6	1	E	0.5	0.8	1	6.0
BLEEDING	5	-	0.8	0.8	1	-	0.6	0.9	1	
PATCHING	5	-	0.3	0.6	1	-	0.6	0.8	1	
POTHOLE/DEBONDING	10	-	0.4	0.7	1	-	0.5	0.8	1	
CRACK SEALING DEFICIENCY	5	H	1	1	1	E	0.5	0.8	1	5.0
RUTTING	10	-	0.3	0.7	1	-	0.6	0.8	1	
SETTLEMENT	10	M	0.5	0.7	1	F	0.5	0.8	1	5.6
CORRUGATIONS	5	-	0.4	0.8	1	-	0.5	0.8	1	
WHEEL TRACK CRACKING	15	L	0.4	0.7	1	F	0.5	0.7	1	4.2
BLOCK AND TRANSVERSE CRACKING	10	M	0.4	0.7	1	E	0.5	0.7	1	7.0
LONGITUDINAL JOINT CRACKING	5	L	0.4	0.7	1	O	0.5	0.7	1	1.0
EDGE CRACKING	5	M	0.4	0.7	1	E	0.5	0.7	1	3.5
RANDOM CRACKING	5	L	0.4	0.7	1	O	0.5	0.7	1	1

*L = LOW
 M = MEDIUM
 H = HIGH

**O = OCCASIONAL
 F = FREQUENT
 E = EXTENSIVE

TOTAL DEDUCT =	33.3
SUM OF STRUCTURAL DEDUCT (BOLD) =	12.2
100 - TOTAL DEDUCT = PCR =	66.7

***DEDUCT POINTS = DISTRESS WEIGHT x SEVERITY WT. x EXTENT WT.

NOTES: THE EDGES ARE CRACKING EXTENSIVELY, CRACK SEALING IS CURRENTLY HOLDING SOME ISOLATED SPOTS TOGETHER. TRANSVERSE CRACKS ARE PREVALENT AND CONSISTENT DOWN THE ENTIRE ROAD. RAVELING IS BEGINNING TO GET MUCH WORSE AND THE EXISTING CRACKS WILL WANT TO POT HOLE IN THE NEXT FEW YEARS IF NOT RESURFACED.

ROAD NAME: WALBRIDGE EAST RD
 LOG MILE: SR-590
 TO: STANGE RD

FLEXIBLE PAVEMENT CONDITION RATING FORM

DATE: 8/19/2019
 RATED BY: CRM

DISTRESS	DISTRESS WEIGHT	SEVERITY WT.*				EXTENT WT.*				DEDUCT POINTS***
			L	M	H		O	F	E	
RAVELING	10	M	0.3	0.6	1	E	0.5	0.8	1	6.0
BLEEDING	5	H	0.8	0.8	1	E	0.6	0.9	1	5.0
PATCHING	5	L	0.3	0.6	1	E	0.6	0.8	1	1.5
POTHOLES/DEBONDING	10	L	0.4	0.7	1	O	0.5	0.8	1	2.0
CRACK SEALING DEFICIENCY	5	L	1	1	1	O	0.5	0.8	1	2.5
RUTTING	10	M	0.3	0.7	1	F	0.6	0.8	1	5.6
SETTLEMENT	10	M	0.5	0.7	1	E	0.5	0.8	1	7.0
CORRUGATIONS	5	-	0.4	0.8	1	-	0.5	0.8	1	
WHEEL TRACK CRACKING	15	L	0.4	0.7	1	O	0.5	0.7	1	3.0
BLOCK AND TRANSVERSE CRACKING	10	-	0.4	0.7	1	-	0.5	0.7	1	
LONGITUDINAL JOINT CRACKING	5	-	0.4	0.7	1	-	0.5	0.7	1	
EDGE CRACKING	5	M	0.4	0.7	1	F	0.5	0.7	1	2.5
RANDOM CRACKING	5	L	0.4	0.7	1	F	0.5	0.7	1	1

*L = LOW
 M = MEDIUM
 H = HIGH

**O = OCCASIONAL
 F = FREQUENT
 E = EXTENSIVE

TOTAL DEDUCT =	36.45
SUM OF STRUCTURAL DEDUCT (BOLD) =	12
100 - TOTAL DEDUCT = PCR =	63.55

***DEDUCT POINTS = DISTRESS WEIGHT x SEVERITY WT. x EXTENT WT.

NOTES: THE OUTSIDE FEW FEET OF THE LANES ARE THE WORST PART OF THIS ROAD, THEY ARE SETTLING AND CRACKING. THE TOWNSHIP HAS TAR AND CHIPPED THESE AREAS WHICH HAS HELD THE ROAD TOGETHER, BUT TYPICAL MAINTENANCE CAN NOT DO ANYTHING FOR THE SETTLING THAT IS OCCURRING. THE ROAD IS BLEEDING AS WELL. IN A FEW AREAS WHERE THE ROAD HAS SETTLED, WATER IS NOW POOLING DURING RAINS, ACCELERATING THE DETERIORATION.

ROAD NAME: MARTIN-WILLISTON RD
 LOG MILE: TROWBRIDGE ROAD
 TO: SR-579

FLEXIBLE PAVEMENT CONDITION RATING FORM

DATE: 8/19/2019
 RATED BY: CRM

DISTRESS	DISTRESS WEIGHT	SEVERITY WT.*				EXTENT WT.*				DEDUCT POINTS***
			L	M	H		O	F	E	
RAVELING	10	L	0.3	0.6	1	F	0.5	0.8	1	2.4
BLEEDING	5	L	0.8	0.8	1	F	0.6	0.9	1	3.6
PATCHING	5	H	0.3	0.6	1	E	0.6	0.8	1	5.0
POTHOLES/DEBONDING	10	H	0.4	0.7	1	E	0.5	0.8	1	10.0
CRACK SEALING DEFICIENCY	5	L	1	1	1	O	0.5	0.8	1	2.5
RUTTING	10	M	0.3	0.7	1	F	0.6	0.8	1	5.6
SETTLEMENT	10	M	0.5	0.7	1	F	0.5	0.8	1	5.6
CORRUGATIONS	5	-	0.4	0.8	1	-	0.5	0.8	1	
WHEEL TRACK CRACKING	15	-	0.4	0.7	1	-	0.5	0.7	1	
BLOCK AND TRANSVERSE CRACKING	10	L	0.4	0.7	1	O	0.5	0.7	1	2.0
LONGITUDINAL JOINT CRACKING	5	L	0.4	0.7	1	O	0.5	0.7	1	1.0
EDGE CRACKING	5	H	0.4	0.7	1	F	0.5	0.7	1	3.5
RANDOM CRACKING	5	M	0.4	0.7	1	F	0.5	0.7	1	2
TOTAL DEDUCT =										43.65
SUM OF STRUCTURAL DEDUCT (BOLD) =										20.05
100 - TOTAL DEDUCT = PCR =										56.35

*L = LOW
 M = MEDIUM
 H = HIGH

**O = OCCASIONAL
 F = FREQUENT
 E = EXTENSIVE

***DEDUCT POINTS = DISTRESS WEIGHT x SEVERITY WT. x EXTENT WT.

NOTES: THE ROADWAY HAS A LARGE NUMBER OF POTHOLES, MOST ARE PATCHED. SOME ARE BEYOND PATCH REPAIR. THERE ARE MANY AREAS WHERE THE EDGE OF THE ROAD IS CRUMBLING AND UNRAVELING. THE TOWNSHIP MAY HAS TRIED TO FIX SOME OF THE EDGE PROBLEMS WITH TAR AND CHIP PATCHES BUT THEY HAVE CONTINUED TO FAIL. THIS ROAD IS IN NEED OF A LEVELING COURSE, ROUTINE MAINTAINCE CANNOT KEEP UP.

**Allen Township Trustees
Ottawa County
P.O. Box 440
Williston, Ohio 43468-0440
(419) 836-4204**

**Ernest E. Cottrell
22095 West Honeysuckle
Curtice, Ohio 43412 (419) 340-7013**

**Scott R. Everhardt
22459 Bittersweet Lane
Curtice, Ohio 43412 (419) 836-9614**

**Craig Blausey
4907 N. Martin Williston Road
Martin, Ohio 43445 (419) 855-9056**

**Sonia Eischen
4683 North Martin Williston Road
Martin, Ohio 43445 (419) 855-9886**

August 23, 2019

Ohio Public Works Commission
District 5 Committee
Issue 1 Round 34
Re; "Resolution # SM-2019-02"

Dear Committee Members,

The Allen Township Trustees are pleased to submit an OPWC Issue I, Round 34 SCIP Grant/Loan application for financial assistance to resurface approximately 2.15 miles of road work resurfacing within the township. Allen Township is submitting the narrative for the CM-150 resurfacing of Martin Williston Road TR#7. The road area to be resurfaced begins north at SR579 and will end at the Lucas County line. The balance of this grant/loan application narrative will include miles in both Carol and Salem Townships.

Martin Williston Road (TR#7 2.01 miles) is in extremely poor condition with spider cracking throughout (see pictures). The road has several potholes that are continuously cleaned and filled. The road is also experiencing major edge peel erosion on the east edge. The road has a poor base and is failing in several locations. The township will provide the berm after the overlay is completed. The township will chip seal the road one year after the repaving is completed. A CM-150 overlay will add a seven to ten-year solution for road use without incurring additional costs of repair. Genoa School's, OCTA buses and agriculture trucks and equipment travel this road daily to serve students, elderly residents and the agricultural industry in Allen Township.

Cedar Street (TR# 1041) .14 miles

Cedar Street is in extremely poor condition with major edge peeling on both the east and west sides of the road. There are several potholes and disintegration throughout the entire length of the road. The rework and repaving of this road should add a seven to ten-year solution for road use without incurring additional yearly cost for repairs. This road transitions to a township road as a straight extension off Wildacre Road. Wildacre Road is a highly traveled county road and receives a minimum of fifty loaded dump trucks a day passing through from Stoneco Quarry. Since Cedar Street is a straight extension of Wildacre Road it does receive considerable amount of traffic as both residents and non-residents use it to travel in and out of the township and county.

The township received letters of support from The Ottawa County Sheriff, The Allen-Clay Joint Fire District and The Genoa Schools. I have included the original letters within the application for your consideration. The township is applying for a SCIP grant/loan and the township will appropriate the additional matching monies from the township's 2020 budget for this project.

If you have any questions, please contact me at 419-836-9614 or by email at scott.apr@outlook.com.

Best Regards,



Scott R. Everhardt
Allen Township Trustee,
Ottawa County, Ohio

***Benton Township Trustees
1670 N Walker St PO Box 7
Graytown, Ohio 43432
419-862-3774***

*James Buhro, Trustee President
David Millinger, Trustee
William Belkofer, Trustee*

Gayle Millinger, Fiscal Officer

August 28, 2019

Ohio Public Works Commission
District 5 Committee, Issue 1 Round 34
Re: Walbridge Road East between Stange and St. Rt. 590

The Board of Benton Township Trustees is asking for your consideration with financial assistance to resurface the pavement on 1.00 mile of Walbridge E Road.

Included in this package are photographs which show the breaking down and pulling-out of the existing pavement, water holes, and repaired cross-over bumps, and tar bleeding through. Over the years Benton Township has patched over many of the asphalt problems in an attempt to extend the life of the pavement on this road. However, the roadway is in need of more than just patches. We have school buses and many children that live on this road and we are very concerned about unsafe travel conditions.

For Walbridge Road E Road we are proposing a hot mix scratch course with overlay of cold mix leveling course be applied in order to level the road surface and fill in low spots. This will alleviate ponding on the road which cause dangerous driving conditions. In addition winter prompts the formation of ice; the result of freezing and thawing cycle causes the pavements to crack and break. The surface of the roads also have tar bleeding which results in very slippery, unsafe conditions when the roadway is wet due to rain, heat or snow, There is little or no stone protruding to help with traction.

Benton Township has received letters of support from Benton-Carroll-Salem Schools, The Ottawa County Sheriff, The Ottawa County Commissioners, Allen-Clay Joint Fire/EMS District and Benton Township residents. I have included them in the application for your consideration.

Limited finances and anticipated reductions in township finances have encouraged us to file this application. Please help us in returning these roads to safe condition for traveling for the public.

If you have any questions, please contact me at 419-707-2789.

Sincerely,



James R Buhro
Benton Township Trustee, President
Ottawa County, Ohio

Carroll Township Trustees

OTTAWA COUNTY

11080 W. Toussaint E. Road ♦ Oak Harbor, Ohio 43449
419-898-9621

August 28, 2019

Ohio Public Works Commission

Issue I Round 34

Resolution #SM-2019-02

Dear Committee Members,

The Carroll Township Trustees are pleased to submit an OPWC Issue I, Round 33 Grant application for financial assistance to complete capital improvements to .53 miles of road within the township. Carroll Township is submitting the narrative for the resurfacing of Russell Road TR#128. The project begins at the intersection with SR #2 at the north, and ends with road at Dufwasha Road. The balance of this grant application will include miles in both Benton and Allen Townships.

Russell Road (T-128/0.53 mile) is a section of road that is rapidly deteriorating due to age and traffic. The entire section of road is extensively thermal cracked. The north end of Russell Road is exposed to increased wear-and-tear due to additional semi traffic coming in and out of a new Dollar General store. With the heavier truck traffic, we are seeing wheel track cracking and rutting in the pavement. We plan to widen the north intersection to deal with the semis making wide turns in and out of the Dollar General and tearing up our road berm. The township has done an excellent job maintaining a 25-year-old road surface with a very thorough crack seal program.

The Township received letters of support from the Ottawa County Sheriff, as well as the Carroll Township Fire and Police Departments. I have included the letters within the application for your consideration. The Township is applying for a grant/loan combination, and the Township will appropriate required monies from 2020 budget for this project.

If you have any questions, please contact me at (419)346-0029 or by email at jbmoore@genoabank.com.

Regards,

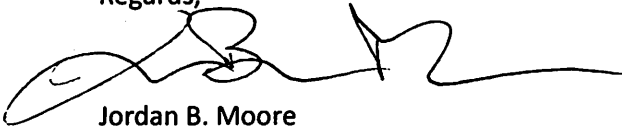

Jordan B. Moore

James Meek
Trustee
419-707-0445

Sandra Shearon
Trustee
419-898-0936

Jordan Moore
Trustee
419-346-0029

Tina Gyde
Fiscal Officer
419-265-0848

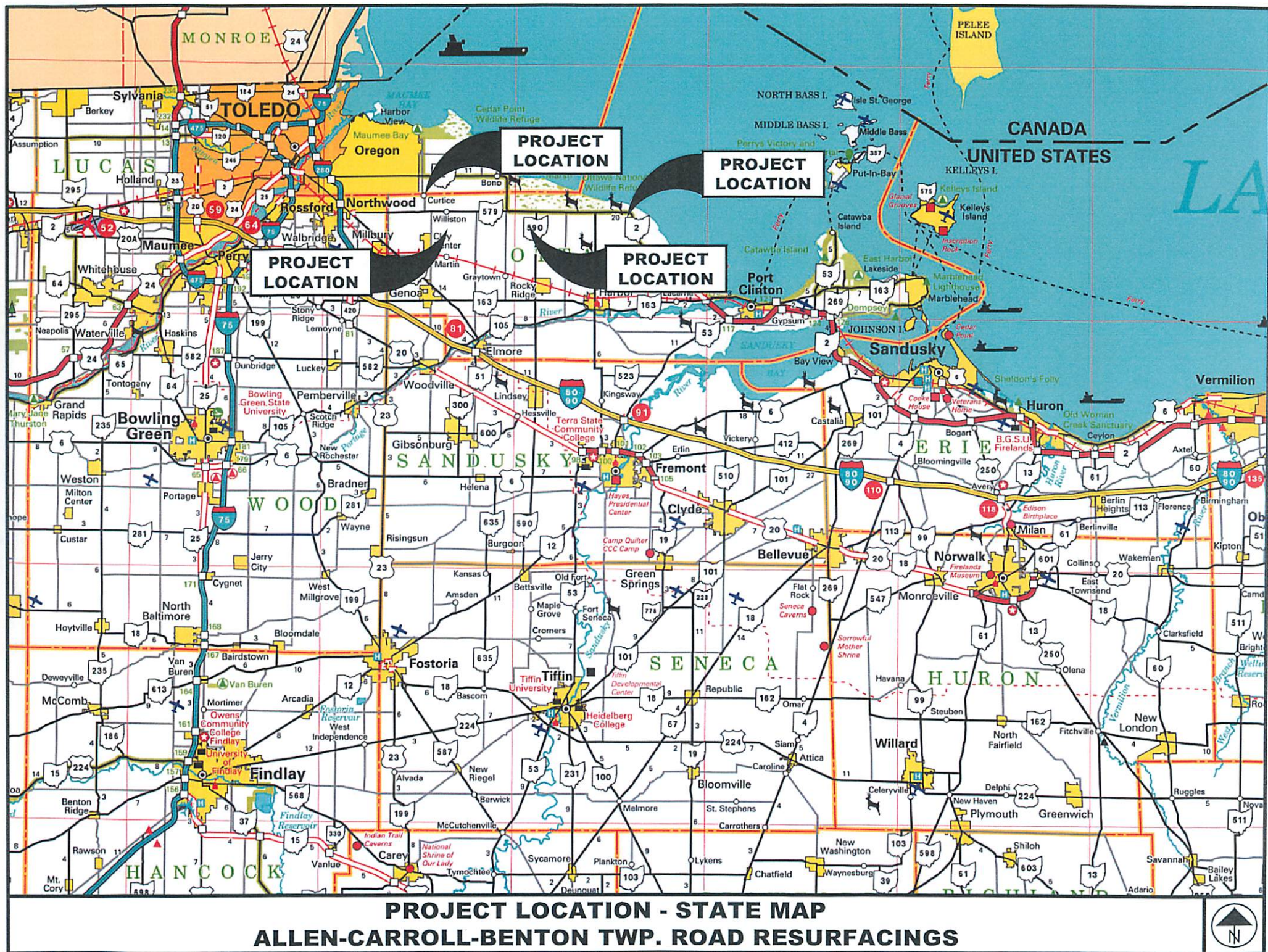

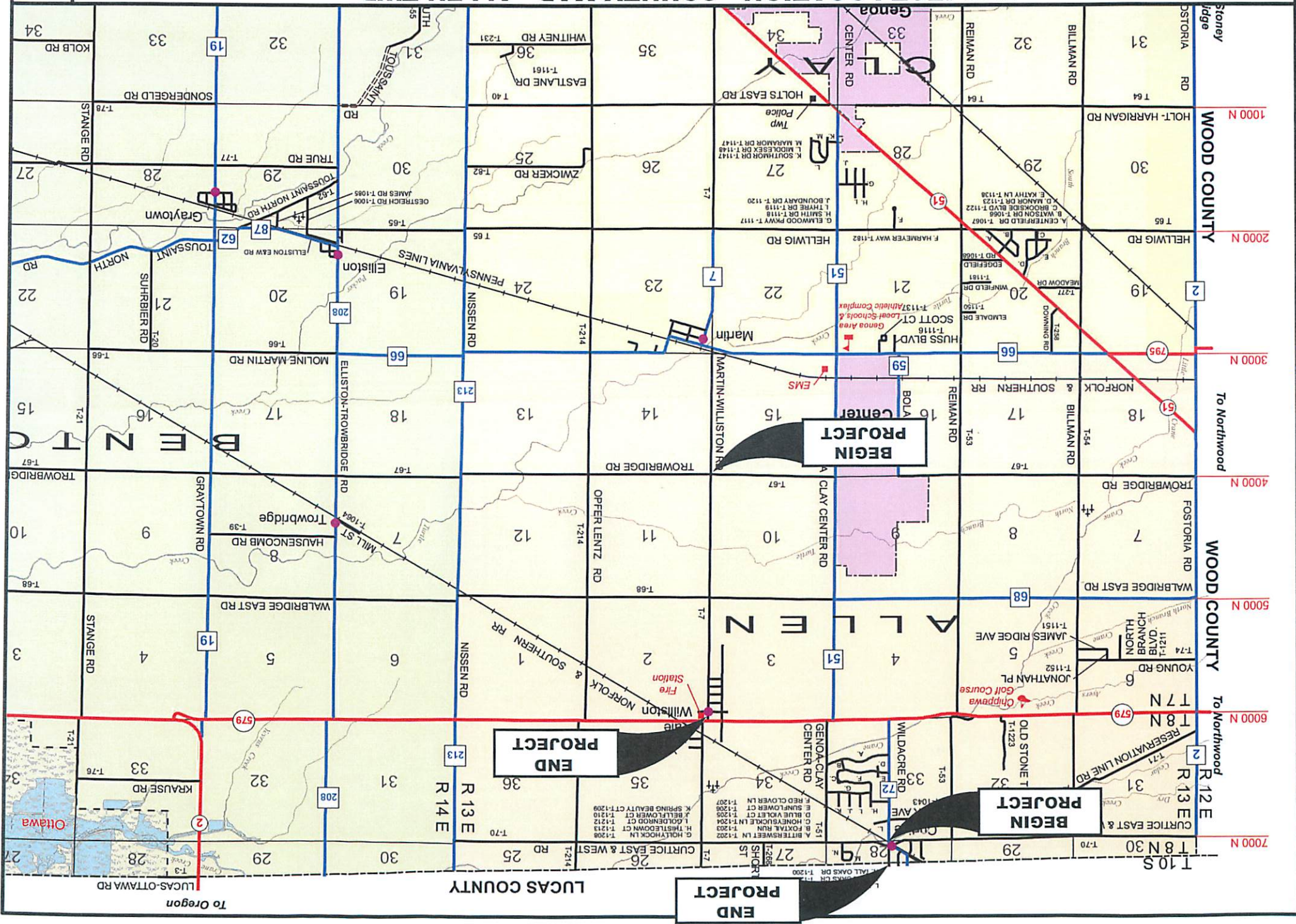

Cedar Street TR #1041



Photo 1 – Edge Failures, Patching, Raveling and Cracking
Prior to Chip Seal Patching



Photo 2 – Existing Temporary Chip Seal Patching of
Roadway Surface

Cedar Street TR #1041

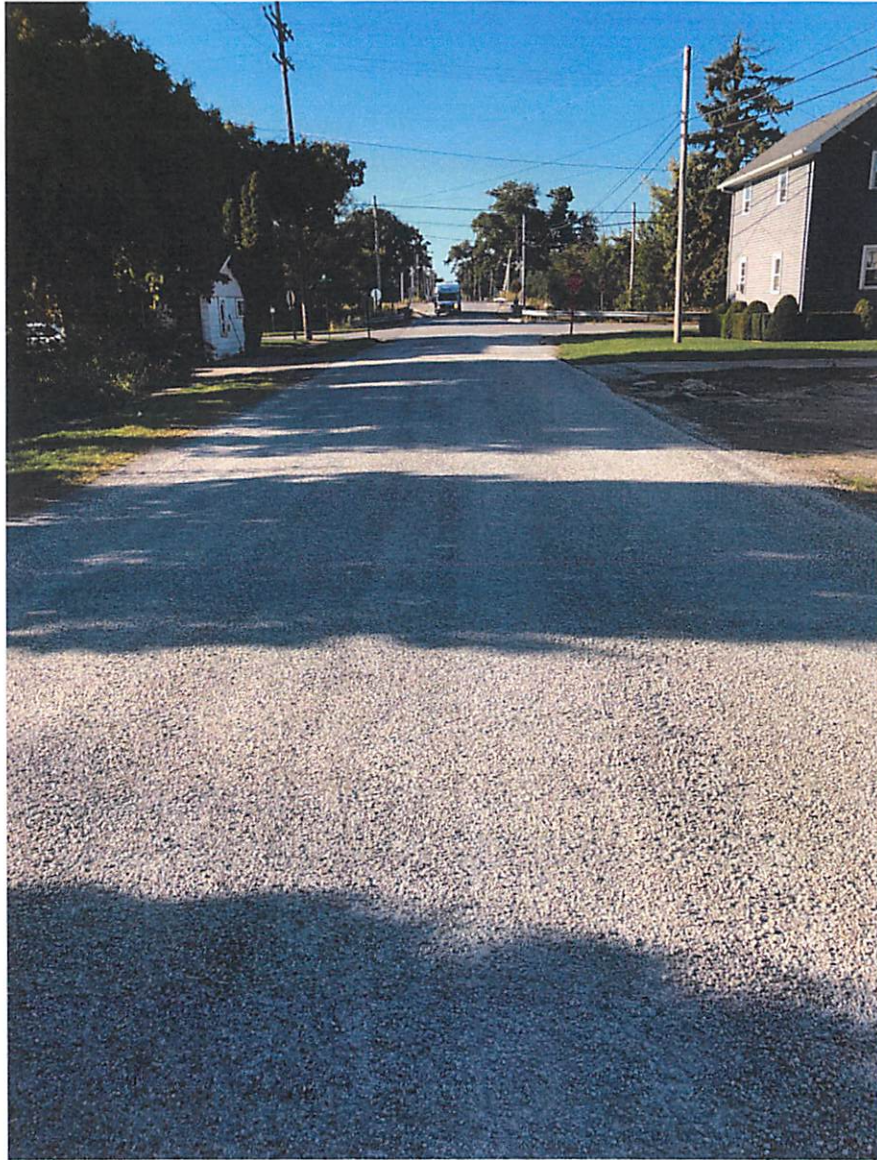
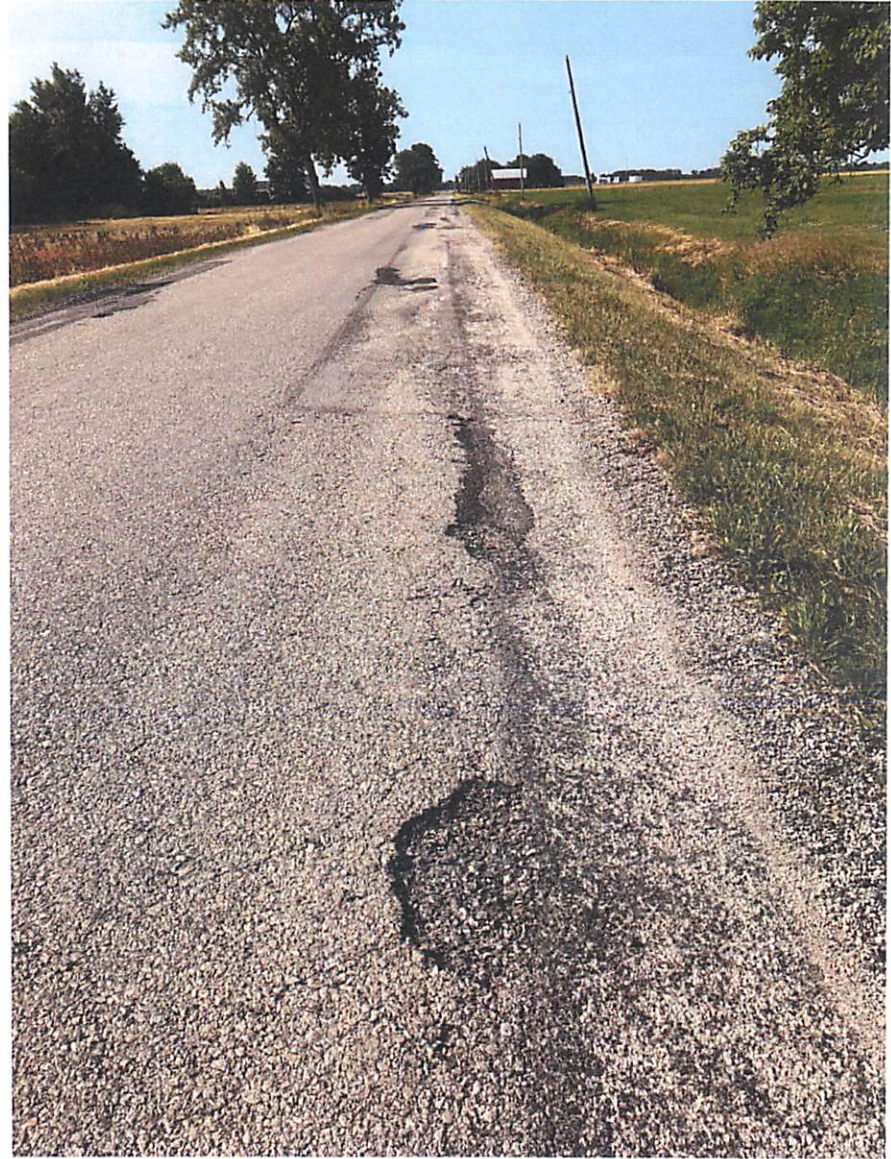

Photo 3 – Existing Temporary Chip Seal Patching of Roadway Surface

Martin-Williston Road TR #7



Photos 1 & 2 – Edge Failures, Potholes, Patching and Bleeding

Martin-Williston Road TR #7



Photos 3 & 4 – Severe Edge Failure and Rutting

Martin-Williston Road TR #7



Photo 5 – Widespread Chip Seal Patching (Also Failing)



Photos 6 & 7 – Widespread Patching, Potholes and Bleeding

Walbridge East Road TR #68



Photo 1 – Edge Failures with Bleeding



Photo 2 – Failed Edge Repairs

Walbridge East Road TR #68



Photos 3 & 4 – Rutting and Ponding at Pavement Edge



Photos 5, 6, 7, 8 – Widespread Bleeding and Map Cracking

Walbridge East Road TR #68



Photos 9, 10, 11, 12– Repairs Required at Crossover Pipes



Photo 13 & 14 – Misc. Edge Repairs and Failures

Russell Road TR #128

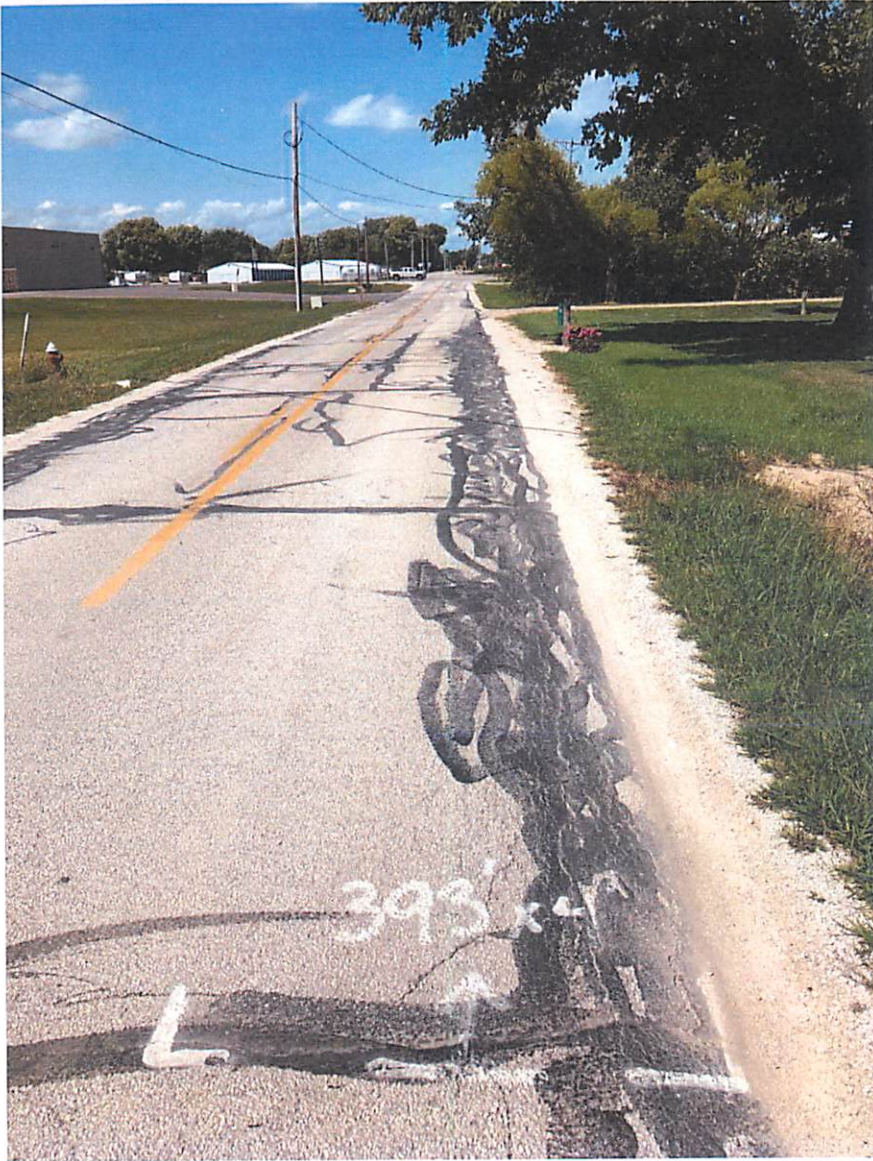

Photos 1 & 2 – Edge Failures, Revealing and Widespread Cracking

Russell Road TR #128



Photos 3 & 4 – Edge Failures, Revealing and Widespread Cracking

Russell Road TR #128



Photo 5 – Widespread Transverse, Edge & Random Cracking

ROAD RESURFACING 2020 - COST ESTIMATE

ALLEN TOWNSHIP - MARTIN-WILLISTON ROAD (TR#7)

ESTIMATOR: CRM

DATE: 7/2/2019

	LENGTH			AREA	BITUMINOUS MATERIAL				AGGREGATE, MATERIAL OR PROCESS									
ROAD NAME	MILES	LENGTH (FT)	WIDTH (FT)	SQ YDS	KINDS	APPLIED RATE	TOTAL GALLONS	UNIT COST	APPLIED COST	STONE SIZE	LBS PER SQ YD	THICKNESS (IN)	TOTAL CU YDS	TOTAL TONS	UNIT COST	APPLIED COST	TOTAL COST	REMARKS
MARTIN WILLISTON ROAD FROM TROWBRIDGE ROAD NORTH TO SR 579	2.01	10590	19.5	22945	CM-150	0.93	21338.9	\$ 3.40	\$ 72,552.09	#67	150			1721	\$ 54.00	\$ 92,934.00	\$ 165,486.09	DRAG COAT
	2.01	10590	19.5	22945						#9	11			126.0	\$ 58.00	\$ 7,308.00	\$ 7,308.00	CHOKE COAT
				500	CM-150	0.93	465.0	\$ 3.40	\$ 1,581.00	#67	150			38	\$ 54.00	\$ 2,052.00	\$ 3,633.00	DRAG COAT (INTERSECTION AND DRIVES)
				500						#9	11			3.0	\$ 58.00	\$ 174.00	\$ 174.00	CHOKE COAT (INTERSECTION AND DRIVES)
	1.21	6400	9.0	6400								0.75		267.00	\$ 92.00	\$ 24,564.00	\$ 24,564.00	441 ASPHALT CONCRETE INTERMEDIATE COURSE, TYPE 1, (448)
	4.01	21180	1.5	3530						411	2.00			392.0	\$ 26.00	\$ 10,192.00	\$ 10,192.00	COMPACTED AGGREGATE (411 BERM)
																	\$ 6,000.00	MAINTENANCE OF TRAFFIC
																	\$ 3,261.00	BOND PREMIUM
																	\$ 220,619.00	ROAD TOTAL

NOTICE TO BIDDERS:

DRIVEWAY APRONS AND MAILBOX APPROACHES SHALL BE MILLED AND PAVED UP TO 6 FEET FROM THE EDGE OF PAVEMENT. ESTIMATE INCLUDES MILLING OF ABUTTING JOINTS AT ALL ASPHALT & CONCRETE DRIVES, THIS WILL NOT BE A SEPERATELY PAID ITEM. THERE ARE A TOTAL OF ±50 DRIVES, QUANTITIES ON ESTIMATE WERE COMPUTED AS FOLLOWS:

TOTAL LENGTH	WIDTH	SY
1500	3	500

ESTIMATE ALSO TO INCLUDE THE MILLING OF ABUTTING JOINTS AT ALL INVOLVED INTERSECTIONS. JOINTS SHALL BE THE FULL WIDTH OF PAVEMENT, 10 FEET IN LENGTH IN INTERSECTIONS, AND AT A DEPTH EQUAL TO THE DEPTH OF PROPOSED ASPHALT OVERLAYMENT.

QUANTITIES FOR DRIVES WILL BE LUMPED TOGETHER WITH ROADWAY QUANTITIES IN PROPOSAL. THEY ARE SHOWN SEPARATE IN THIS ESTIMATE SHEET FOR QUANTITY CLARITY.

DRAG COAT LISTED ABOVE SHALL BE MIXED IN A PUGMILL AT THE CONTRACTOR'S SITE. INSPECTOR SHALL BE NOTIFIED OF DATE, TIME, AND LOCATION, 48 HOUR IN ADVANCE OF MIXING. MATERIAL IS TO BE PLACED WITH A CONVENTIONAL PAVER WITH A 3/16" PER FOOT CROSS SLOPE.

448 SURFACE TYPE 1, SCRATCH COURSE LISTED ABOVE WILL BE LAYED IN VARIOUS LOCATIONS TO CORRECT SEVERE CROSS-SECTIONAL SLOPE ISSUES. THE ESTIMATED AMOUNT ABOVE IS FOR ESTIMATING PURPOSES ONLY AND THE ENTIRE QUANTITY IS NOT GAURANTEED. EXACT LOCATIONS WILL BE MARKED OUT ONSITE BY THE ENGINEER AT THE TIME OF CONSTRUCTION. ESTIMATE INCLUDES 3600 LF OF LANE WIDTH SCRATCH COURSE WITH AN AVERAGE THICKNESS OF .75". IN THE NORTH BOUND LANE AND 2800' IN THE SOUTHBOUND LANE.

PAVEMENT IS ON AN AVERAGE OF 18.5' IN WIDTH. 19.5' WAS USED FOR MATERIAL PADDING DUE TO INCONSISTENCIES IN THE CROSS-SECTIONAL SLOPE OF THE EXISTING PAVEMENT. FINISH PAVEMENT WIDTH WILL VARY SLIGHTLY.

TRAFFIC SHALL BE MAINTAINED.

SEE OTTAWA COUNTY SUPPLEMENTAL SPECIFICATIONS FOR COLD MIX AND HOT MIX.

ROAD RESURFACING 2020 - COST ESTIMATE

ALLEN TOWNSHIP - CEDAR STREET (TR#1041)

ESTIMATOR: CRM

DATE: 7/2/19

	LENGTH			AREA	BITUMINOUS MATERIAL				AGGREGATE, MATERIAL OR PROCESS									
ROAD NAME	MILES	LENGTH (FT)	WIDTH (FT)	SQ YDS	KINDS	APPLIED RATE	TOTAL GALLONS	UNIT COST	APPLIED COST	STONE SIZE	LBS PER SQ YD	THICKNESS (IN)	TOTAL CU YDS	TOTAL TONS	UNIT COST	APPLIED COST	TOTAL COST	REMARKS
CEDAR STREET FROM CURTICE EAST AND WEST TO TWP. LINE	0.14	750	19.0	1583.3	Tack	0.080	127	\$ 2.25	\$ 285.75								\$ 285.75	TACK COAT
	0.14	750	19.0	1583 249	PG64-22 PG64-22					448 448	1.75 1.75			154.00 25.00	\$ 85.00 \$ 85.00	\$ 13,090.00 \$ 2,125.00	\$ 13,090.00 \$ 2,125.00	1.75" 448 SURFACE TYPE 1 (SURFACE) 1.75" 448 SURFACE TYPE 1 (DRIVES)
																\$ 1,500.00	\$ 1,500.00	MAINTENANCE OF TRAFFIC
																\$ 256.00	\$ 256.00	CONTRACT BOND
																	\$ 17,257.00	ROAD TOTAL

NOTICE TO BIDDERS:

ESTIMATE TO INCLUDE MILLING OF ABUTTING JOINTS AT ALL INVOLVED INTERSECTIONS. JOINTS SHALL BE THE FULL WIDTH OF PAVEMENT, 12 FEET IN LENGTH, AND AT A DEPTH EQUAL TO THE DEPTH OF PROPOSED ASPHALT OVERLAYMENT.

DRIVEWAY APRONS AND MAILBOX APPROACHES SHALL BE MILLED AND PAVED UP TO 4 FEET FROM THE EDGE OF PAVEMENT. ESTIMATE INCLUDES MILLING OF ABUTTING JOINTS AT ALL ASPHALT & CONCRETE DRIVES, THIS WILL NOT BE A SEPARATELY PAID ITEM. THERE ARE APPROX. 14 DRIVES.

TOTAL LENGTH WIDTH SY
560 4 248.9

QUANTITIES FOR DRIVES WILL BE LUMPED TOGETHER WITH ROADWAY QUANTITIES IN PROPOSAL. THEY ARE SHOWN SEPARATE IN THIS ESTIMATE SHEET FOR QUANTITY CLARITY.

ROAD WIDTH VARIES. 19' IS AVERAGE WIDTH.

QUANTITIES ON PROPOSAL ARE SLIGHTLY HIGHER THAN ON COST ESTIMATE DUE TO ROUNDING

LOCAL TRAFFIC SHALL BE MAINTAINED DURING CONSTRUCTION.

SEE OTTAWA COUNTY SUPPLEMENTAL SPECIFICATIONS FOR ASPHALT CONCRETE PAVEMENT

ROAD RESURFACING 2020 - COST ESTIMATE

BENTON TOWNSHIP - WALBRIDGE EAST ROAD (TR#68)

ESTIMATOR: CRM

DATE: 7/29/2019

	LENGTH			AREA	BITUMINOUS MATERIAL				AGGREGATE, MATERIAL OR PROCESS									
ROAD NAME	MILES	LENGTH (FT)	WIDTH (FT)	SQ YDS	KINDS	APPLIED RATE	TOTAL GALLONS	UNIT COST	APPLIED COST	STONE SIZE	LBS PER SQ YD	THICKNESS (IN)	TOTAL CU YDS	TOTAL TONS	UNIT COST	APPLIED COST	TOTAL COST	REMARKS
WALBRIDGE EAST ROAD FROM STANGE TO SR 590	1.00	5265	18.5	10823	CM-150	0.93	10065.0	\$ 3.40	\$ 34,221.00	#67	150			812	\$ 54.00	\$ 43,848.00	\$ 78,069.00	DRAG COAT
	1.00	5265	18.5	10823						#9	12			65.0	\$ 58.00	\$ 3,770.00	\$ 3,770.00	CHOKE COAT
				320	CM-150	0.93	298.0	\$ 3.40	\$ 1,013.20	#67	150			24	\$ 54.00	\$ 1,296.00	\$ 2,309.20	DRAG COAT (INTERSECTION AND DRIVES)
				320						#9	12			2.0	\$ 58.00	\$ 116.00	\$ 116.00	CHOKE COAT (INTERSECTION AND DRIVES)
	0.81	4300	9.0	4300								1.00		239.00	\$ 92.00	\$ 21,988.00	\$ 21,988.00	441 ASPHALT CONCRETE INTERMEDIATE COURSE, TYPE 1, (448)
	1.99	10530	1.5	1755						411		2.5		244.0	\$ 26.00	\$ 6,344.00	\$ 6,344.00	COMPACTED AGGREGATE (411 BERM)
																	\$ 4,000.00	MAINTENANCE OF TRAFFIC
																	\$ 1,749.00	BOND PREMIUM
																\$ 118,346.00	ROAD TOTAL	

NOTICE TO BIDDERS:

DRIVEWAY APRONS AND MAILBOX APPROACHES SHALL BE MILLED AND PAVED UP TO 6 FEET FROM THE EDGE OF PAVEMENT. ESTIMATE INCLUDES MILLING OF ABUTTING JOINTS AT ALL ASPHALT (4 TOTAL) & CONCRETE DRIVES, THIS WILL NOT BE A SEPERATELY PAID ITEM. THERE ARE A TOTAL OF ±18 DRIVES, QUANTITIES ON ESTIMATE WERE COMPUTED AS FOLLOWS:

TOTAL LENGTH	WIDTH	SY
720	4	320

ESTIMATE ALSO TO INCLUDE THE MILLING OF ABUTTING JOINTS AT ALL INVOLVED INTERSECTIONS. JOINTS SHALL BE THE FULL WIDTH OF PAVEMENT, 10 FEET IN LENGTH IN INTERSECTIONS, AND AT A DEPTH EQUAL TO THE DEPTH OF PROPOSED ASPHALT OVERLAYMENT.

QUANTITIES FOR DRIVES WILL BE LUMPED TOGETHER WITH ROADWAY QUANTITIES IN PROPOSAL. THEY ARE SHOWN SEPARATE IN THIS ESTIMATE SHEET FOR QUANTITY CLARITY.

DRAG COAT LISTED ABOVE SHALL BE MIXED IN A PUGMILL AT THE CONTRACTOR'S SITE. INSPECTOR SHALL BE NOTIFIED OF DATE, TIME, AND LOCATION, 48 HOUR IN ADVANCE OF MIXING. MATERIAL IS TO BE PLACED WITH A CONVENTIONAL PAVER WITH A 3/16" PER FOOT CROSS SLOPE.

448 SURFACE TYPE 1, SCRATCH COURSE LISTED ABOVE WILL BE LAYED IN VARIOUS LOCATIONS TO CORRECT SEVERE CROSS-SECTIONAL SLOPE ISSUES. THE ESTIMATED AMOUNT ABOVE IS FOR ESTIMATING PURPOSES ONLY AND THE ENTIRE QUANTITY IS NOT GAURANTEED. EXACT LOCATIONS WILL BE MARKED OUT ONSITE BY THE ENGINEER AT THE TIME OF CONSTRUCTION. ESTIMATE INCLUDES 4300 LF OF HALF WIDTH SCRATCH COURSE WITH AN AVERAGE THICKNESS OF 1" (ZERO AT CENTERLINE, VARYING AT EDGE OF PAVEMENT).

PAVEMENT IS ON AN AVERAGE OF 18.0' IN WIDTH. 18.5' WAS USED FOR MATERIAL PADDING DUE TO INCONSISTENCIES IN THE CROSS-SECTIONAL SLOPE OF THE EXISTING PAVEMENT. FINISH PAVEMENT WIDTH SHALL BE 18.5'.

LOCAL TRAFFIC SHALL BE MAINTAINED.

SEE OTTAWA COUNTY SUPPLEMENTAL SPECIFICATIONS FOR COLD MIX AND HOT MIX.

ROAD SHALL BE COLD MIX PAVED FULL WIDTH.

ROAD RESURFACING 2020 - COST ESTIMATE

CARROLL TOWNSHIP - RUSSELL RD. (TR#128)

ESTIMATOR: CRM

DATE: 7/13/19

	LENGTH			AREA	BITUMINOUS MATERIAL				AGGREGATE, MATERIAL OR PROCESS										
ROAD NAME	MILES	LENGTH (FT)	WIDTH (FT)	SQ YDS	KINDS	APPLIED RATE	TOTAL GALLONS	UNIT COST	APPLIED COST	STONE SIZE	LBS PER SQ YD	THICKNESS (IN)	TOTAL CU YDS	TOTAL TONS	UNIT COST	APPLIED COST	TOTAL COST	REMARKS	
RUSSELL ROAD FROM DUFF-WASHA ROAD TO SR2		393.0	4.0	174.7								6	30.0		\$ 240.00	\$ 7,200.00	\$ 7,200.00	253 - PAVEMENT REPAIR	
		114.0	4.0	50.7								6	8.0		\$ 240.00	\$ 1,920.00	\$ 1,920.00	253 - PAVEMENT REPAIR	
	0.52	2723	18.0	5446	Tack	0.080	436	\$ 2.10	\$ 915.60								\$ 915.60	TACK COAT FOR INTERMEDIATE	
	0.52	2723	18.0	5446	Tack	0.060	327	\$ 2.10	\$ 686.70								\$ 686.70	TACK COAT	
				202	PG64-22					448	1.50		17.00	\$ 78.00	\$ 1,326.00	\$ 1,326.00	\$ 1,326.00	1.5" 448 SURFACE TYPE 1 (DRIVES)	
	0.52	2723	18.0	5446	PG64-22					448	1.25		378.00	\$ 78.00	\$ 29,484.00	\$ 29,484.00	\$ 29,484.00	1.25" 448 SURFACE TYPE 1 (SURFACE)	
	0.52	2723	18.0	5446	PG64-22					448	0.75		227.00	\$ 78.00	\$ 17,706.00	\$ 17,706.00	\$ 17,706.00	0.75" 448 INTERMEDIATE TYPE 1 (SCRATCH)	
	1.03	5446	1.5	907.67						411	2		101.0	\$ 26.00	\$ 2,626.00	\$ 2,626.00	\$ 2,626.00	BERM STONE	
	0.52														\$ 900.00	\$ 468.00	\$ 468.00	CENTER LINE, 4"	
		18													\$ 25.00	\$ 450.00	\$ 450.00	STOP BAR	
																\$ 4,000.00	\$ 4,000.00	\$ 4,000.00	MAINTENANCE OF TRAFFIC
																	\$ 1,002.00	\$ 1,002.00	CONTRACT BOND
																\$ 67,785.00	\$ 67,785.00	ROAD TOTAL	

NOTICE TO BIDDERS:

ESTIMATE TO INCLUDE MILLING OF ABUTTING JOINTS AT ALL INVOLVED INTERSECTIONS. JOINTS SHALL BE THE FULL WIDTH OF PAVEMENT, 12 FEET IN LENGTH, AND AT A DEPTH EQUAL TO THE DEPTH OF PROPOSED ASPHALT OVERLAYMENT.

DRIVEWAY APRONS AND MAILBOX APPROACHES SHALL BE MILLED AND PAVED UP TO 4 FEET FROM THE EDGE OF PAVEMENT. ESTIMATE INCLUDES MILLING OF ABUTTING JOINTS AT ALL ASPHALT & CONCRETE DRIVES, THIS WILL NOT BE A SEPERATLY PAID ITEM. THERE ARE APPROXIMATELY 13 DRIVES.

TOTAL LENGTH WIDTH SY
455 4 202.2

QUANTITIES FOR DRIVES WILL BE LUMPED TOGETHER WITH ROADWAY QUANTITIES IN PROPOSAL. THEY ARE SHOWN SEPARATE IN THIS ESTIMATE SHEET FOR QUANTITY CLARITY.

ROAD WIDTH VARIES SLIGHTLY, 18.0' IS THE AVERAGE WIDTH.

QUANTITIES ON PROPOSAL ARE SLIGHTLY HIGHER THAN ON COST ESTIMATE DUE TO ROUNDING

TRAFFIC SHALL BE MAINTAINED DURING CONSTRUCTION.

TOWNSHIP TO RETAIN ALL OR A PORTION OF GRINDINGS PRODUCED DURING MILLING OPERATIONS. CONTRACTOR TO PROVIDE TRANSPORTATION TO A DESTINATION IN THE TOWNSHIP THAT WILL BE DETERMINED ONCE OPERATIONS ARE UNDERWAY. CONTRACTOR WILL BE RESPONSIBLE FOR ANY GRINDINGS THE TOWNSHIP DOES NOT CLAIM.

SEE SUPPLEMENTAL SPECIFICATIONS FOR ASPHALT CONCRETE PAVEMENT

THE EXACT QUANTITY AND LOCATION OF BASE REPAIR NEEDED WILL BE DETERMINED ON SITE PRIOR TO CONSTRUCTION.

Benton-Carroll-Salem

School District

www.bcssd.com



Board of Education Office

11685 W. State Route 163

Oak Harbor, OH 43449

Phone: (419) 898-6210

August 26, 2019

To Whom It May Concern:

I am writing to support the grant application of Benton Township (Ottawa County) for the Ohio Public Works Grant, which would cover the following areas of our school district:

*Suhrbier Road, Graytown 1 mile

*Walbridge Road East, 1 mile between Stange Road and State Route 590.

This would improve the safety of these areas for all, and especially our **school bus traffic**, which heavily utilizes this area. Our school district community would be well served by these grant funds.

Thank you for your consideration.

Sincerely,

Guy L. Parmigian
Superintendent

HOME OF THE OAK HARBOR ROCKETS

Guy L. Parmigian, Ph.D.
Superintendent

Cajon H. Keeton
Treasurer



Genoa Area Local Schools

2810 N. Genoa-Clay Center Road
Genoa, Ohio 43430

Superintendent, Michael Ferguson
Treasurer, J. William Nye
Director of Business Services,
Lisa Cruickshank
Director of Curriculum/Instruction,
Karen Robey

Telephone: 419.855.7741
Fax: 419.855.4030
www.genoaschools.com

August 22, 2019

Allen Township Trustees

As discussed, this letter supports your efforts to apply and receive additional grants/funding to improve our township roads. Specifically, the Trustees seek funding for:

Repaving of – Martin Williston Rd (2 Miles)

As Superintendent of the Genoa Area Local Schools, I can confirm the need to repair, resurface and improve the roads within the community and school district. Our bus drivers, students and staff drive these roads daily and the need to resurface, widen and repair the roads is imperative to all our student's safety. We appreciate your efforts for the safety and well-being of all children who ride or drive the township roads on a daily basis. Thank you.

Regards,

Michael G. Ferguson, Superintendent
Genoa Area Local Schools

Empowering our Students to be Future Ready

Genoa Area High School
2980 N. Genoa-Clay Center Rd.
Genoa, Ohio 43430
Principal, Benjamin Ohlemacher
419.855.7741

Genoa Area Middle School
2950 N. Genoa-Clay Center Rd.
Genoa, Ohio 43430
Principal, Dir. of Transportation, Kevin Katafias
Dir. of Student Services,
Lauren Scheanwald
Director of Technology, Tom Baker
419.855.7741

Genoa Area Elementary School
2820 N. Genoa-Clay Center Rd.
Genoa, Ohio 43430
Principal, Yolanda Mies
Assistant Principal, Cody McPherson
419.855.7741



Ottawa County Sheriff's Office

Stephen J. Levorchick
Sheriff

Brad M. York
Chief Deputy

ADDRESS/PHONE/FAX

315 Madison Street, Room 110
Port Clinton, Ohio 43452
Phone (419) 734-4404
FAX (419) 732-8311
www.ottawacountysheriff.org

SHERIFF

Stephen J. Levorchick
Phone (419) 734-6877

CHIEF DEPUTY

Brad M. York
Phone (419) 734-6826

CAPTAIN OF
OPERATIONS

Zach Bowling
Phone (419) 734-6827

JAIL ADMINISTRATOR

Captain Kent Davis
Full Service Facility
Phone (419) 734-6828

MSJ Facility

Phone (419) 734-6995

COMMUNICATIONS

Sergeant James Lucas
Corporal John Knecht
Phone (419) 734-4404

DIRECTOR OF
ADMINISTRATION

Deputy Heather K. Moss
Phone (419) 734-6823

DIRECTOR OF FINANCE

Deputy Callie D. McConahay
Phone (419) 734-6829

CIVIL

Deputy Rhonda Reiter
Deputy Kendra Berlin
Phone (419) 734-6824

Benton Township Trustees
Carroll Township Trustees
Allen Township Trustees

August 23, 2019

Dear Trustees,

I am submitting this letter as support of your efforts to make Benton, Carroll, and Allen Townships very safe communities and a great place to raise a family.

It is my understanding that you are currently attempting to receive funding from outside grant sources to assist in your highway paving projects throughout Benton, Carroll, and Allen Townships. Without those grant opportunities, all three townships would be unable to commit to making the roadways within your township as safe as you would with the funding.

Your three townships together are key farming communities within Ottawa County. As township trustees, it is obvious that you are doing everything that you can to keep the residents of your respective townships safe, at home, at work, on their farms, and in their cars.

As Sheriff of Ottawa County, I am honored to write this letter of support in your efforts to maintain the high quality of safety within Benton, Carroll, and Harris Townships. Through the established partnerships that you have in place in your townships, the residents should take great pride in their community and also have a peace of mind that their township trustees are attempting to keep their community safe.

Sincerely,

Stephen J. Levorchick,
Sheriff of Ottawa County



CARROLL TOWNSHIP POLICE DEPARTMENT
3536 N. State Route 19 – Oak Harbor, OH – 43449
Robert Paulsen, Chief

419-898-4906, Dispatch
419-898-0841, Fax

August 21, 2019

Carroll Township Trustees
11080 W. Toussaint East Rd.
Oak Harbor, Ohio 43449

Dear Trustees,

I am writing this letter to support your efforts to make Carroll Township as safe as possible for our residents. Carroll Township is a great community to raise a family.

I recently heard that you were attempting to receive funding from a grant to assist in paving of our township roads. In my travels one of the first items I notice is the conditions of roads, streets, or alleys. Good updated roadways are a sign of priority that a local government puts the safety of their residents. Updated roads usually disperse water off of them quickly, making any evasive driving more functional.

Carroll Township has a large influx of tourism, due to the many areas. First and foremost would be access to Lake Erie. This leads to our population expanding in the summer to over three times what we have in the winter. Clean updated roads lead to not only protecting our permanent residents but also those choosing Carroll Township for their summer fun.

As Chief of Police for Carroll Township, I am honored to write this letter in support of your efforts to maintain the high quality of safety within our township. Part of this safety is the condition of our roadways. Carroll Township residents should take great pride in their community and your efforts to their continued safety.

Sincerely,

A handwritten signature in black ink, appearing to read "R. W. Paulsen", with a long horizontal flourish extending to the right.

Robert W Paulsen
Chief of Police

Carroll Township Emergency Medical & Fire Service Inc.

11080 W. Toussaint East Road

Oak Harbor, Ohio 43449

KATHY BOWYER
E.M.S. Chief

Telephone: 419-898-9621
Fax: 419-898-0366

JOHN BROUGH
Fire Chief

LETTER OF SUPPORT CARROLL TOWNSHIP TRUSTEES AUGUST 22, 2019

This letter is in response to the Carroll Township, Ottawa County, Trustees' request for funding through OPWC grant to resurface the following road in Carroll Township:

Russell Rd.

The Carroll Township Emergency Medical & Fire Service provides EMS and fire service to all of Carroll Township. As such we often use this road and know that it requires attention to make it safer for our citizens as well as provide safe and rapid emergency vehicle access to any emergencies that occur to the residents that live on named road.

We ask that you give high consideration to this request and ultimately fund it.

THANK YOU!



John Brough
Fire Chief



ALLEN-CLAY JOINT FIRE DISTRICT

Headquarters

3155 N. Genoa-Clay Center Rd.
Genoa, OH 43430
District Chief Michael T. Musolf

Phone: 419-855-4733
Fax: 419-855-1074

LETTER OF SUPPORT ALLEN TOWNSHIP TRUSTEES AUGUST 23, 2019

This letter is in response to the Allen Township, Ottawa County, Trustees' request for funding through the OPWC grant to resurface the following road in Allen Township:

Martin-Williston Road between Trowbridge Road and State Route 579 (2 miles)

The Allen-Clay Joint Fire District provides fire and EMS service to all of Allen Township. As such we often use these roads and know that they require attention to make them safer for our citizens as well as provide safe and rapid emergency vehicle access to any emergencies that occur to the residents that live on the named roads.

We ask that you give high consideration to this request and ultimately fund it.

Thank you!

Michael T. Musolf
District Fire Chief
Allen-Clay Joint Fire District



ALLEN-CLAY JOINT FIRE DISTRICT

Headquarters

3155 N. Genoa-Clay Center Rd.
Genoa, OH 43430
District Chief Michael T. Musolf

Phone: 419-855-4733

Fax: 419-855-1074

LETTER OF SUPPORT BENTON TOWNSHIP TRUSTEES AUGUST 27, 2019

This letter is in response to the Benton Township, Ottawa County, Trustees' request for funding through the OPWC grant to resurface the following roads in Benton Township:

Walbridge Road between Stange Road and State Route 590 (1 mile)
Suhrbier Road between Martin-Moline Road and W. Toussaint North Road (1 mile)

The Allen-Clay Joint Fire District provides fire and EMS service to a portion of Benton Township. As such we often use these roads and know that they require attention to make them safer for our citizens as well as provide safe and rapid emergency vehicle access to any emergencies that occur to the residents that live on the named roads.

We ask that you give high consideration to this request and ultimately fund it.

Thank you!

Michael T. Musolf
District Fire Chief
Allen-Clay Joint Fire District

**DISTRICT 5
CAPITAL IMPROVEMENT PROJECTS
QUESTIONNAIRE
ROUND 34**

Name of Applicant: Benton Township
Project Title: Cedar TR #1041 Martin-Williston TR #7 Walbridge East TR #68 & Russell TR #128

The following questions are to be answered for each application submitted for State Issue II SCIP, LTIP and Loan Projects. Please provide specific information using the best documentation available to you. Justification of your responses to these questions will be required if your project is selected for funding, so please provide correct and accurate responses. **Communities and Townships under 5,000 in population should also complete the Small Government Criteria.**

1. What percentage of the project in repair A= 100 %, replacement B= __%, expansion C= __%, and new D= ____%? (Use dollar amounts of project to figure percentages and make sure the total equals one hundred(100) percent) A+B= 100 % C+D= __%

Repair/Replacement = Repair or Replacement of public facilities owned by the government (any subdivision of the state).

New/Expansion = Replacement of privately owned wells, septic systems, private water or wastewater systems, etc.

2. Give the physical condition rating:

Closed or Not Operating: The condition is unusable, dangerous and unsafe. The primary components have failed. The infrastructure is not functioning at all.

Critical: The condition is causing or contributing to a serious non-compliance situation and is threatening the intended design level of service. The infrastructure is functioning at seriously diminished capacity. Imminent failure is anticipated within 18 months. Repair and/or replacement is required to eliminate the critical condition and meet current design standards. **(For Road Projects structural repair items would represent a minimum of 25% of the total Project Cost).**

Poor: The condition is substandard and requires repair/replacement in order to return to the intended level of service and comply with current design standards. Infrastructure contains a major deficiency and is functioning at a diminished capacity.

Fair: The condition is average, not good or poor. The infrastructure is still functioning as originally intended. Minor deficiencies exist requiring repair to continue to function as originally intended and/or to meet current design standards.

Good: The condition is safe and suitable to purpose. Infrastructure is functioning as originally intended, but requires minor repairs and/or upgrades to meet current design standards.

Excellent: The condition is new, or requires no repair. Or, no supporting documentation has been submitted.

* **In order to receive points provide supporting documentation (e.g. photos, a narrative, maintenance history, or third party findings) to justifying the rating.**

3. If the proposed project is not approved what category would best represent the impact on the general health and/or public safety?

ROADS

Extremely Critical: Resurfacing, Restoration, Rehabilitation and Reconstruction (4R) of a Major Access Road.*

Critical: Resurfacing, Restoration and Rehabilitation (3R) of a Major Access Road.*

Major: Resurfacing, Restoration, Rehabilitation and Reconstruction (4R) of a Minor Access Road.*

Moderate: Resurfacing, Restoration and Rehabilitation (3R) of a Minor Access Road.*

Minimal: Preventative Maintenance of a Major Access Road.

No Impact: Preventative Maintenance of a Minor Access Road.

Projects that have a variety of work will be scored in the LOWEST category of work contained in the Construction Estimate.

Road/Street Classifications:

Major Access Road:

Roads or streets that have a dual function of providing access to adjacent properties and providing through or connecting service between other roads.

Minor Access Road:

Roads or streets that primarily provide access to adjacent properties without through continuity, such as cul-de-sacs or loop roads or streets.

Preventative Maintenance:

Non Structural Pavement work such as chip sealing, cape sealing, micro-surfacing, crack sealing, etc.

*(3R) Resurfacing, Restoration and Rehabilitation - Improvements to existing roadways, which have as their main purpose, the restoration of the physical features (pavement, curb, guardrail, etc.) without altering the original design elements. **(Surface and Intermediate layer Mill and Fills, overlays with less than or equal to 3" of additional pavement, ect...)**

*(4R) Resurfacing, Restoration, Rehabilitation and Reconstruction - Much like 3R, except that 4R allows for the complete reconstruction of the roadway and alteration of certain design elements (i.e., lane widths, shoulder width, SSD, **overlays with greater than 3" of additional pavement**, etc.).

*(4R) Resurfacing, Restoration, Rehabilitation and Reconstruction - Much like 3R, except that 4R allows for the complete reconstruction of the roadway and alteration of certain design elements (i.e., lane widths, shoulder width, SSD, etc.).

BRIDGES SUFFICIENCY RATING

Extremely Critical:	0-25, or a General Appraisal rating of 3 or less.
Critical:	27-50, or a General Appraisal rating of 4.
Major:	51-65 or a General Appraisal rating of 5 or 6.
Moderate:	66-80 or a General Appraisal rating of 7.
Minimal:	81-100 or a General Appraisal rating of more than 7.
No Impact:	Bridge on a new roadway.

WASTEWATER TREATMENT PLANTS

Extremely Critical:	Environmental Protection Agency (EPA) orders in the form of a consent decree, findings and orders or court order. Health Department Construction Ban.
Critical:	Improvements ordered by the Environmental Protection Agency (EPA) in the form of NPDES Orders.
Major:	Replace deficient appurtenances. Update existing processes due to EPA recommendations.
Moderate:	Increase capacity to meet current needs or update processes to improve effluent quality.
Minimal:	New/Expansion project to meet a specific development proposal.
No Impact:	New/Expansion to meet future or projected needs.

WATER TREATMENT PLANT

Extremely Critical:	EPA orders in the form of a consent decree, findings and orders or court order.
Critical:	Improvements to meet Environmental Protection Agency (EPA) Safe Drinking Water Regulations and/or NPDES Orders.
Major:	Replace deficient appurtenances. Update existing processes due to EPA recommendations.
Moderate:	Increase capacity to meet current needs or update processes to improve water quality.
Minimal:	New/Expansion project to meet a specific development proposal.
No Impact:	New/Expansion to meet future or projected needs.

COMBINED SEWER SEPARATIONS (May be construction of either new storm or sanitary sewer as long as the result is two separate sewer systems.)

Extremely Critical:	EPA orders in the form of a consent decree, findings and orders or court order. Health Department Construction Ban.
Critical:	Separate, due to chronic backup or flooding in basements.
Major:	Separate, due to documented water quality impairment, or due to EPA recommendations.
Moderate:	Separate, due to specific development proposal within or upstream of the combined system area.
Minimal:	Separate, to conform to current design standards.
No Impact:	No positive health effect.

STORM SEWERS

Extremely Critical:	EPA orders in the form of a consent decree, findings and orders or court order.
Critical:	Chronic flooding (structure damage).
Major:	Inadequate capacity (land damage).
Moderate:	Inadequate capacity with no associated damage.
Minimal:	New/Expansion to meet current needs.
No Impact:	New/Expansion to meet future or project needs.

CULVERTS

Extremely Critical:	Structurally deficient or functionally obsolete. Deterioration has already caused a safety Critical: hazard to the public.
Critical:	Inadequate capacity with land damage and the existing or high probability of property damage.
Major:	Inadequate capacity (land damage).
Moderate:	Inadequate capacity with no associated damage.
Minimal:	New/Expansion to meet current needs.
No Impact:	New/Expansion to meet future or projected needs.

SANITARY SEWERS

- Extremely Critical: EPA orders in the form of a consent decree, findings and orders or court order. Health Department Construction Ban.
- Critical: Replace, due to chronic pipe failure, chronic backup or flooding in basements. Improvements ordered by the Environmental Protection Agency (EPA) in the form of NPDES Orders.
- Major: Replace, due to inadequate capacity or infiltration, or due to EPA recommendations.
- Moderate: Rehabilitate to increase capacity to meet current needs or to reduce inflow and infiltration.
- Minimal: New/Expansion project to meet a specific development proposal.
- No Impact: New/Expansion to meet future or projected needs.

SANITARY LIFT STATIONS AND FORCE MAINS

- Extremely Critical: Structurally deficient. Deterioration has already caused a safety/health hazard to the public, or, EPA orders in the form of a consent decree, findings and orders or court order.
- Critical: Inadequate capacity with actual or a high probability of property damage. Improvements ordered by the Environmental Protection Agency (EPA) in the form of NPDES Orders.
- Major: EPA recommendations, or, reduces a probable health and/or safety problem.
- Moderate: Rehabilitate to increase capacity to meet current needs.
- Minimal: New/Expansion to meet a specific development proposal.
- No Impact: New/Expansion to meet future or projected needs.

WATER PUMP STATIONS

- Extremely Critical: Structurally deficient. Deterioration has already caused a safety hazard to the public, or, EPA orders in the form of a consent decree, findings and orders or court order.
- Critical: Inadequate capacity with the inability to maintain pressure required for fire flows.
- Major: Replace due to inadequate capacity or EPA recommendations.
- Moderate: Rehabilitate to increase capacity to meet current needs.

Minimal: New/Expansion to meet a specific development proposal.

No Impact: New/Expansion to meet future or projected needs.

WATER LINES/WATER TOWERS

Extremely Critical: Solve low water pressure or excessive incidents of main breaks in project area.

Critical: Replace, due to deficiency such as excessive corrosion, etc.

Major: Replace undersized water lines as upgrading process.

Moderate: Increase capacity to meet current needs.

Minimal: New/Expansion project to meet a specific development proposal.

No Impact: New/Expansion to meet future or projected needs.

OTHER

Extremely Critical: There is a present health and/or safety threat.

Critical: The project will provide immediate health and/or safety benefit.

Major: The project will reduce a probable health and/or safety problem.

Moderate: The project will delay a health and/or safety problem.

Minimal: A possible future health and/or safety problem mitigation.

No Impact: No health and/or safety effect.

NOTE: Combined projects that can be rated in more than one subset may be rated in the other category at the discretion of the District 5 Executive Committee. In general, the majority of the cost or scope of the project shall determine the category under which the project will be scored.

(Submittals without supporting documentation will receive 0 Points for this question.)

Extremely Critical ____, Critical X, Major ____, Moderate ____, Minimal ____, No Impact ____. Explain your answer. Resurfacing of major access roads

(Additional narrative, charts and/or pictures should be attached to questionnaire)

4. Identify the amount of local funds that will be used on the project as a percentage of the total project cost.

A.) Amount of Local Funds = \$ 238,704

B.) Total Project Cost = \$ 477,408

RATIO OF LOCAL FUNDS DIVIDED by TOTAL PROJECT COSTS (A/B)= 50 %

Note: Local funds should be considered funds derived from the applicant budget or loans funds to be paid back through local budget, assessments, rates or tax revenues collected by the applicant.

5. Identify the amount of other funding sources to be used on the project, excluding State Issue II or LTIP Funds, as a percentage of the total project cost.

Grants % Gifts %, Contributions 0 %

Other % (explain) , Total 0 %

Note: Grant funds and other revenues not contributed or collected through taxes by the applicant should be considered other funds. The Scope of Work for each Funding Source must be the same.

6. Total Amount of SCIP and Loan Funding Requested- An Applicant can request a grant per the categories below for points as indicated on the Priority Rating Sheet. If the Applicant is including a loan request equal to, but not exceeding 50% of the OPWC funding amounts listed below, there will be no point penalty. If loan funds requested are more than 50%, points as listed in the Priority Rating Sheet will apply.

<u> </u>	\$500,001 or More
<u> X </u>	\$400,001-\$500,000
<u> </u>	\$325,001-\$400,000
<u> </u>	\$275,001-\$325,000
<u> </u>	\$175,001-\$275,000
<u> </u>	\$175,000 or Less

There are times when the District spends all of the grant money and has loan money remaining. When this happens, the district makes a loan offer in the amount of the requested grant to the communities that were not funded. The offers are made in the order of scoring. We need to know if you are not successful in obtaining grant dollars for your project if you would be interested in loan money:

YES X NO

(This will only be considered if you are not funded with grant money and there is remaining loan money.) **Please note: if you answer “no” you will not be contacted, only if you answer “yes” will an offer be made in the event that there is loan money remaining.**

7. If the proposed project is funded, will its completion directly result in the creation of permanent full-time equivalent (FTE) jobs (FTE jobs shall be defined as 35 hours/week) ? Yes No X . If yes, how many jobs within eighteen months? Will the completed project retain jobs that would otherwise be

permanently lost? Yes ___ No X. If yes, how many jobs _____ will be created/retrained within 18 months following the completion of the improvements?

(Supporting documentation in the form of letter from affected industrial or commercial enterprises that specify full time equivalent jobs that will be retained or created directly by the installation or improvement of Public infrastructure. Additional items such as; 1) newspaper articles or other media news accounts, 2) public meeting minutes, and/or 3) a letter from the County Economic Development Director or State of Ohio Economic Development Professional that alludes to the requirement for the infrastructure improvement to support the business. Submittals without supporting documentation will receive 0 points for this question.)

8. What is the total number of existing users that will directly benefit from the proposed project if completed? 1,172 Average Daily Traffic Count (Use households served, traffic counts, etc. and explain the basis by which you arrived at your number.)

9. Is subdivision's population less than 5,000 Yes ___ No X

If yes, continue. You may want to design your project per Small Government Project Evaluation Criteria, released for the current OPWC Round to assist in evaluating your project for potential Small Government Funding. The Small Government Criteria is available on the OPWC website at <http://www.pwc.state.oh.us/Meth.SG.PDF> If No, skip to Question 11.

10. **OHIO PUBLIC WORKS COMMISSION SMALL GOVERNMENT PROGRAM GUIDELINES**

All projects that are sponsored by a subdivision with a population of 5,000 or less, and not earning enough points for District Funding from SCIP or LTIP Funds, are then rated using the Small Government Program Rating Criteria for the corresponding funding round. In order to be rated the entity must submit the Small Government Supplement and their required budgets with their application.

Only infrastructure that is village- or township- owned is eligible for assistance. The following policies have been adopted by the Small Government Commission:

- District Integrating Committees may submit up to seven (7) applications for consideration by the Commission. All 7 must be ranked, however, only the top five (5) will be scored. The remaining two (2) will be held as contingency projects should an application be withdrawn.
- Grants are limited to \$500,000. Any assistance above that amount must be in the form of a loan.
- Grants for new or expanded infrastructure cannot exceed 50% of the project estimate.
- The Commission may deny funding for water and sewer systems that are deemed to be more

cost-effective if regionalized.

- If a water or sewer project is determined to be affordable, the project will be offered a loan rather than a grant. Pay special attention to the **Water & Wastewater Affordability Supplemental and the Small Government Water & Wastewater Affordability Calculation Worksheet**. Both are available on the Small Government Program Tab at <http://www.pwc.state.oh.us/SmallGovernment.html>

- Should there be more projects that meet the “annual score” than there is funding, the tie breaker is those projects which scored highest under Health & Safety, with the second tie breaker being Condition. If multiple projects have equivalent Health & Safety and Condition scores they are arranged according to the amount of assistance from low to high. Once the funded projects are announced, “contingency projects” may be funded from project under-runs by continuing down the approved project list.

- Supplemental assistance is not provided to projects previously funded by the Commission.

- Applicants have 30 days from receipt of application by OPWC without exception to provide additional documentation to make the application more competitive under the Small Government criteria. Applications will be scored after the 30-day period has expired. The applicants for each District's two (2) contingency projects will have the same 30-day period to submit supplemental information but these applications will not be scored unless necessary to do so. **It is each applicant's responsibility for determining the need for supplemental material. The applicant will not be asked for or notified of missing information unless the Commission has changed the project type and it affects the documentation required. Important information may include, but is not limited to: age of infrastructure, traffic counts or utility users, median income information, user rates ordinances, and the Auditor's Certificate of Estimated Revenues or documentation from the Auditor of State that subdivision is in a state of fiscal emergency.**

If you desire to have your Round 34 project considered for Small Government Funding please download the Small Government Evaluation Criteria applicable to Round 34 by accessing the OPWC Website at <http://www.pwc.state.oh.us/Meth.SG.PDF>. Please complete the Small Government Evaluation Criteria and attach all required supporting documentation and attach it to the District 5 Questionnaire for Round 32.

11. MANDATORY INFORMATION, DISTRICT 5, DISCRETIONARY RANKING POINTS

List all specific user fees: Amount or
ROAD & BRIDGE PROJECTS:(OHIO REVISED CODE) Percentage

Permissive license fee	4504.02 or 4504.06 _____
	4504.15 or 4504.17 _____
	4504.16 or 4504.171 _____
	4504.172 _____
	4504.18 _____

Special property taxes	5555.48 _____
	5555.49 _____

Municipal Income Tax _____

County Sales Tax _____

Others _____

(DO NOT INCLUDE SCHOOL TAXES)

SPECIFIC PROJECT AREA INFORMATION.

Median household income _____

Monthly utility rate: Water _____

Sewer _____

Other _____

List any special user fees or assessment (be specific)

POLITICAL SUBDIVISION= _____

COUNTY= _____

DISCRETIONARY POINTS (BY DISTRICT COMMITTEE ONLY)= _____

(25-20-15)

Date: 8/28/19

Signature: James Buhro

Title: James Buhro Benton Township Trustee

Address: P. O. Box 7 Graytown, Ohio 43432

Phone: (419) 862-3774

FAX: (419) 862-1738

Email: jrbuhro54@gmail.com

District 5
Capital Improvement Project
Priority Rating Sheet, Round 34

Revised 04/23/19
PROJECT NUMBER

COUNTY: Ottawa			Cedar TR #1041, Martin-Williston TR #7, Walbridge East TR #68 & Russell Road TR #128 Roads Resurfacing													
PROJECT: Cedar, Martin-Williston, Walbridge																
EST. COST: \$477,408.00																
No.	"A" WEIGHT FACTOR	CRITERIA TO BE CONSIDERED	"B" PRIORITY FACTORS						"A" x "B"	Priority Factors						No.
			0	2	4	6	8	10		0	2	4	6	8	10	
1	1	(Repair or Replace) vs. (New or Expansion)	0	2	4	6	8	10	10	0% + Repair or Replacement	20% + Repair or Replacement	40% + Repair or Replacement	60% + Repair or Replacement	80% + Repair or Replacement	100% + Repair or Replacement	1
2	1.5	Existing Physical Condition: Must submit substantiating documentation and CIR (100% New or Expansion = 0 Points)	0	2	4	6	8	10	9	Excellent	Good	Fair	Poor	Critical	Closed or Not Operating	2
3	2	Public Health and/or Public Safety Submittals without supporting documentation will receive 0 points for this question.	0	2	4	6	8	10	16	No Impact	Minimal	Moderate	Major	Critical	Extremely	3
4	2	Percentage of Local Share (Local funds are funds derived from the applicant budget or a loan to be paid back through the applicant budget, assessments, rates or tax revenues) *	0	2	4	6	8	10	20	0%+	10%+	20%+	30%+	40%+	50%+	4
5	1	OTHER FUNDING SOURCES (Excluding Issue II Funds) (Grants and other revenues not contributed or collected through taxes by the applicant; including Gifts, Contributions, etc. – must submit copy of award or status letter.)	0	2	4	6	8	10	0	0%+	10%+	20%+	30%+	40%+	50%+	5
No.	"A" WEIGHT FACTOR	CRITERIA TO BE CONSIDERED	"B" PRIORITY FACTORS						"A" x "B"	Priority Factors						No.
										-9	-8	0	8	9	10	
										Grant or Loan Only						
6	2	OPWC Grant and Loan Funding Requested. Please refer to Item 6 on Questionnaire for clarification.	-9	-8	0	8	9	10		\$500,001 or more	\$400,001 to \$500,000	\$325,001 to \$400,000	\$275,001 to \$325,000	\$175,001 to \$275,000	\$175,000 or less	6
										Grant/Loan Combination						
	2		-9	-8	0	8	9	10	18	\$750,000 or more	\$600,001 to \$750,000	\$487,501 to \$600,000	\$412,501 to \$487,500	\$262,501 to \$412,500	\$262,500 or less	6
When scoring a project that is only grant or only loan. Please use the chart labeled "Grant or Loan Only". When scoring a grant/loan combination, score the project for the grant in the first chart, then use the second chart labeled "Grant/Loan Combination" to score the total (grant and loan combined). Use the lower of the two as the score.																
No.	"A" WEIGHT FACTOR	CRITERIA TO BE CONSIDERED	"B" PRIORITY FACTORS						"A" x "B"	Priority Factors						No.
										0	2	4	6	8	10	
7	1	Will the Proposed Project Create Permanent jobs or retain jobs that would otherwise be permanently lost (Written Documentation Required)	0	2	4	6	8	10	0	0+ jobs	7+ jobs	15+ jobs	25+ jobs	50+ jobs	100+ jobs	7
8	1	Benefits to Existing Users (Equivalent dwelling units), Traffic Counts, etc.	0	2	4	6	8	10	10	0+	100+	350+	500+	750+	1000+	8
9		SUBTOTAL RANKING POINTS (MAX. = 115)							83	Other Info: Does this project have a significant impact on productive farmland? YES NO Attach impact statement if yes. Is the Applicant ready to proceed to bids after State Approval within 6 months? YES NO						
10		COUNTY PRIORITY POINTS (25-20-15)														
11		DISCRETIONARY POINTS (BY DISTRICT ONLY) (MAX.=12)														
12		GRAND TOTAL RANKING POINTS														

* Applicants must certify local share contribution. Specify, all funding sources to be utilized as local share at the time of application submittal.