



State of Ohio
Public Works Commission
Application for Financial Assistance

IMPORTANT: Please consult "Instructions for Financial Assistance for Capital Infrastructure Projects" for guidance in completion of this form.

Applicant

Applicant: City of Sandusky Subdivision Code: 043-70348
 District Number: 5 County: Erie Date: 07/17/2019
 Contact: Aaron Klein Phone: (419) 627-5829
(The individual who will be available during business hours and who can best answer or coordinate the response to questions)
 Email: aklein@ci.sandusky.oh.us FAX: (419) 627-5933

Project

Project Name: 2020 Resurfacing Program Zip Code: 44870

Subdivision Type <small>(Select one)</small>	Project Type <small>(Select single largest component by \$)</small>	Funding Request Summary <small>(Automatically populates from page 2)</small>
<input type="checkbox"/> 1. County	<input checked="" type="checkbox"/> 1. Road	Total Project Cost: <u>350,000 .00</u>
<input checked="" type="checkbox"/> 2. City	<input type="checkbox"/> 2. Bridge/Culvert	1. Grant: <u>175,000 .00</u>
<input type="checkbox"/> 3. Township	<input type="checkbox"/> 3. Water Supply	2. Loan: <u>0 .00</u>
<input type="checkbox"/> 4. Village	<input type="checkbox"/> 4. Wastewater	3. Loan Assistance/ Credit Enhancement: <u>0 .00</u>
<input type="checkbox"/> 5. Water (6119 Water District)	<input type="checkbox"/> 5. Solid Waste	Funding Requested: <u>175,000 .00</u>
	<input type="checkbox"/> 6. Stormwater	

District Recommendation (To be completed by the District Committee)

Funding Type Requested <small>(Select one)</small>	SCIP Loan - Rate: _____ % Term: _____ Yrs	Amount: _____ .00
<input type="checkbox"/> State Capital Improvement Program	RLP Loan - Rate: _____ % Term: _____ Yrs	Amount: _____ .00
<input type="checkbox"/> Local Transportation Improvement Program	Grant:	Amount: _____ .00
<input type="checkbox"/> Revolving Loan Program	LTIP:	Amount: _____ .00
<input type="checkbox"/> Small Government Program	Loan Assistance / Credit Enhancement:	Amount: _____ .00
District SG Priority: _____		

For OPWC Use Only

STATUS _____	Grant Amount: _____ .00	Loan Type: <input type="checkbox"/> SCIP <input type="checkbox"/> RLP
Project Number: _____	Loan Amount: _____ .00	Date Construction End: _____
	Total Funding: _____ .00	Date Maturity: _____
Release Date: _____	Local Participation: _____ %	Rate: _____ %
OPWC Approval: _____	OPWC Participation: _____ %	Term: _____ Yrs

1.0 Project Financial Information (All Costs Rounded to Nearest Dollar)

1.1 Project Estimated Costs

Engineering Services

Preliminary Design:	_____	0	.00	
Final Design:	_____	0	.00	
Construction Administration:	_____	6,000	.00	
Total Engineering Services:	a.) _____	6,000	.00	2 %
Right of Way:	b.) _____		.00	
Construction:	c.) _____	329,000	.00	
Materials Purchased Directly:	d.) _____		.00	
Permits, Advertising, Legal:	e.) _____		.00	
Construction Contingencies:	f.) _____	15,000	.00	5 %
Total Estimated Costs:	g.) _____	350,000	.00	

1.2 Project Financial Resources

Local Resources

Local In-Kind or Force Account:	a.) _____	20,000	.00	
Local Revenues:	b.) _____	155,000	.00	
Other Public Revenues:	c.) _____		.00	
ODOT / FHWA PID: _____	d.) _____		.00	
USDA Rural Development:	e.) _____		.00	
OEPA / OWDA:	f.) _____		.00	
CDBG:	g.) _____		.00	
<input type="checkbox"/> County Entitlement or Community Dev. "Formula"				
<input type="checkbox"/> Department of Development				
Other: _____	h.) _____		.00	
Subtotal Local Resources:	i.) _____	175,000	.00	50 %

OPWC Funds (Check all requested and enter Amount)

Grant: <u>100</u> % of OPWC Funds	j.) _____	175,000	.00	
Loan: <u>0</u> % of OPWC Funds	k.) _____		.00	
Loan Assistance / Credit Enhancement:	l.) _____	0	.00	
Subtotal OPWC Funds:	m.) _____	175,000	.00	50 %
Total Financial Resources:	n.) _____	350,000	.00	100 %

1.3 Availability of Local Funds

Attach a statement signed by the Chief Financial Officer listed in section 5.2 certifying all local resources required for the project will be available on or before the earliest date listed in the Project Schedule section. The OPWC Agreement will not be released until the local resources are certified. Failure to meet local share may result in termination of the project. Applicant needs to provide written confirmation for funds coming from other funding sources.

2.0 Repair / Replacement or New / Expansion

2.1 Total Portion of Project Repair / Replacement:	<u>350,000</u> .00	<u>100</u> %
2.2 Total Portion of Project New / Expansion:	<u>0</u> .00	<u>0</u> %
2.3 Total Project:	<u>350,000</u> .00	<u>100</u> %

A Farmland Preservation letter is required for any impact to farmland

3.0 Project Schedule

3.1 Engineering / Design / Right of Way	Begin Date: <u>12/01/2019</u>	End Date: <u>04/01/2020</u>
3.2 Bid Advertisement and Award	Begin Date: <u>05/01/2020</u>	End Date: <u>06/28/2020</u>
3.3 Construction	Begin Date: <u>07/01/2020</u>	End Date: <u>06/26/2021</u>

Construction cannot begin prior to release of executed Project Agreement and issuance of Notice to Proceed.

Failure to meet project schedule may result in termination of agreement for approved projects. Modification of dates must be requested in writing by project official of record and approved by the Commission once the Project Agreement has been executed.

4.0 Project Information

If the project is multi-jurisdictional, information must be consolidated in this section.

4.1 Useful Life / Cost Estimate / Age of Infrastructure

Project Useful Life: 10 Years Age: 1967 (Year built or year of last major improvement)

Attach Registered Professional Engineer's statement, with seal or stamp and signature confirming the project's useful life indicated above and detailed cost estimate.

4.2 User Information

Road or Bridge: Current ADT 1,619 Year 2019 Projected ADT 1,700 Year 2023

Water / Wastewater: Based on monthly usage of 4,500 gallons per household; attach current ordinances.

Residential Water Rate Current \$ _____ Proposed \$ _____

Number of households served: 0

Residential Wastewater Rate Current \$ _____ Proposed \$ _____

Number of households served: 0

Stormwater: Number of households served: 0

4.3 Project Description

- A: SPECIFIC LOCATION (Supply a written location description that includes the project termini; a map does not replace this requirement.) 500 character limit.

The 46 streets segments selected represent the worst asphalt streets in Sandusky. This is based on an updated pavement condition survey, originally performed by TransMap in 2016. Work since 2016 has been incorporated into and removed from this list. The PCI factor includes an automated annual degradation since the survey was performed. A majority of the damage to these pavements is surficial, therefore a thin overlay will serve these roadways well for both drainage, rideability and longevity.

- B: PROJECT COMPONENTS (Describe the specific work to be completed; the engineer's estimate does not replace this requirement) 1,000 character limit.

Milling 1.5" of asphalt pavement surface and overlaid with 1.5" of new asphalt.

- C: PHYSICAL DIMENSIONS (Describe the physical dimensions of the existing facility and the proposed facility. Include length, width, quantity and sizes, mgd capacity, etc in detail.) 500 character limit.

53074 SY of asphalt resurfacing.

5.0 Project Officials

Changes in Project Officials must be submitted in writing from an officer of record.

5.1 Chief Executive Officer (Person authorized in legislation to sign project agreements)

Name: Eric Wobser
Title: City Manager
Address: 240 Columbus Ave.

City: Sandusky State: OH Zip: 44870
Phone: (419) 627-5844
FAX: (419) 627-5825
E-Mail: ewobser@ci.sandusky.oh.us

5.2 Chief Financial Officer (Can not also serve as CEO)

Name: Hank Solowiej
Title: Finance Director
Address: 240 Columbus Ave.

City: Sandusky State: OH Zip: 44870
Phone: (419) 627-5776
FAX: (419) 627-5892
E-Mail: hsolowiej@ci.sandusky.oh.us

5.3 Project Manager

Name: Aaron Klein, P.E.
Title: Director of Public Works
Address: 240 Columbus Ave.

City: Sandusky State: OH Zip: 44870
Phone: (419) 627-5829
FAX: (419) 627-5933
E-Mail: aklein@ci.sandusky.oh.us

6.0 Attachments / Completeness review

Confirm in the boxes below that each item listed is attached (Check each box)

- A certified copy of the legislation by the governing body of the applicant authorizing a designated official to sign and submit this application and execute contracts. This individual should sign under 7.0, Applicant Certification, below.
- A certification signed by the applicant's chief financial officer stating the amount of all local share funds required for the project will be available on or before the dates listed in the Project Schedule section. If the application involves a request for loan (RLP or SCIP), a certification signed by the CFO which identifies a specific revenue source for repaying the loan also must be attached. Both certifications can be accomplished in the same letter.
- A registered professional engineer's detailed cost estimate and useful life statement, as required in 164-1-13, 164-1-14, and 164-1-16 of the Ohio Administrative Code. Estimates shall contain an engineer's seal or stamp and signature.
- A cooperative agreement (if the project involves more than one subdivision or district) which identifies the fiscal and administrative responsibilities of each participant.
- Farmland Preservation Review - The Governor's Executive Order 98-IV, "Ohio Farmland Protection Policy" requires the Commission to establish guidelines on how it will take protection of productive agricultural and grazing land into account in its funding decision making process. Please include a Farm Land Preservation statement for projects that have an impact on farmland.
- Capital Improvements Report. CIR Required by O.R.C. Chapter 164.06 on standard form. Per District 5 Questionnaire
- Supporting Documentation: Materials such as additional project description, photographs, economic impact (temporary and/or full time jobs likely to be created as a result of the project), accident reports, impact on school zones, and other information to assist your district committee in ranking your project. Be sure to include supplements which may be required by your local District Public Works Integrating Committee.

7.0 Applicant Certification

The undersigned certifies: (1) he/she is legally authorized to request and accept financial assistance from the Ohio Public Works Commission as identified in the attached legislation; (2) to the best of his/her knowledge and belief, all representations that are part of this application are true and correct; (3) all official documents and commitments of the applicant that are part of this application have been duly authorized by the governing body of the applicant; and, (4) should the requested financial assistance be provided, that in the execution of this project, the applicant will comply with all assurances required by Ohio Law, including those involving Buy Ohio and prevailing wages.

Applicant certifies that physical construction on the project as defined in the application has NOT begun, and will not begin until a Project Agreement for this project has been executed with the Ohio Public Works Commission. Action to the contrary will result in termination of the agreement and withdrawal of Ohio Public Works Commission funding from the project.

Eric Wobser, City Manager

Certifying Representative (Printed form, Type or Print Name and Title)

Original Signature / Date Signed

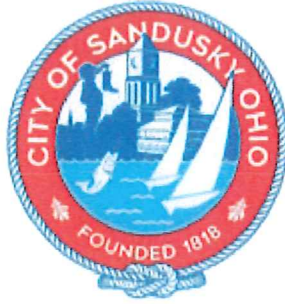

The City of Sandusky



OPWC Round 34 Submittal Citywide Resurfacing Project

Prepared By:
Joshua R. Snyder, P.E.
Asst. City Engineer

8/16/19

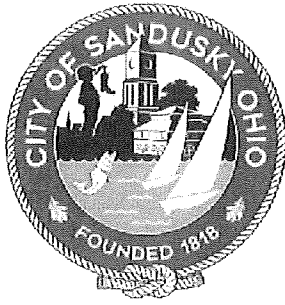

DEPARTMENT OF PUBLIC WORKS

240 Columbus Ave.
Sandusky, Ohio 44870
419.627.5829
www.ci.sandusky.oh.us

OPWC Round 34 Contents Included with Application

State of Ohio Public Works Commission, Application for Finance Assistance

District 5 Capital Improvements Projects, Questionnaire Round 34

Supplemental Project Narrative

Engineer's Estimate, Stamped and Signed by Assistant City Engineer, Joshua Snyder, P.E.

Project Area Map and Current Roadway Photos

Certification of Local Funds Available, Signed by Finance Director, Hank Solowiej, CPA

Resolution 032-19R, Certified by City Commission Clerk, Kelly Kresser, CMC

Traffic Counts

OPWC Round 34

Citywide Resurfacing Project

Supplemental Project Narrative

Project Information:

Roadway – This project addresses the very worst rated asphalt paved streets in the City. Because they are the worst, they are in various areas with varying ADT's. None of the streets selected are “Dead ends”, or end at the water.

Based on City records and the updated TransMap survey of 2016, the streets chosen are not slated for any future work or part of larger projects. This list reflects the remaining 45 worst street segments of asphalt pavement in the City. The project will address the streets rated 0 to 14 in the Pavement Condition Indices (PCI). Performing this project would raise the total average PCI of all asphalt streets from 46 to 53.8

Our project would primarily mill and pave the top 1.5” of these streets, 10% of the award amount is reserved for partial and full depth repairs.

The current ADT's on two (2) of the busier segments are 851 on Mills and 922 on N. Depot St., at an adjacent segment. Projected ADT's are 930 and 1010, respectively for 2024. There are 43 other segments affected in this project as well; that using the ITE daily trips per residential household factor (9.8 trips/day) equates to just under 9000 vehicles/day affected on the roadway segments selected.

The City of Elyria and City of Lorain regularly use OPWC funds to augment their street resurfacing programs. These citywide resurfacing projects typically score well in OPWC District 9.

HEALTH AND SAFETY: It is incumbent upon the City to maintain streets free of nuisance. Lack of repairs and reconstruction would cause further damage to conditions already hazardous to drivers and personal property.

OVERALL ECONOMIC HEALTH OF THE COMMUNITY: The City of Sandusky, like many larger cities struggles to find dollars dedicated to roadways. Within the General Fund, Parks and rec, Police and Fire to name a few other areas that also split up this money. The new gas tax will help “bridge” the funding gap, but as revealed in our pavement survey, it will take \$1.2M annually dedicated to roads to hold the PCI rating and only slightly raise it.

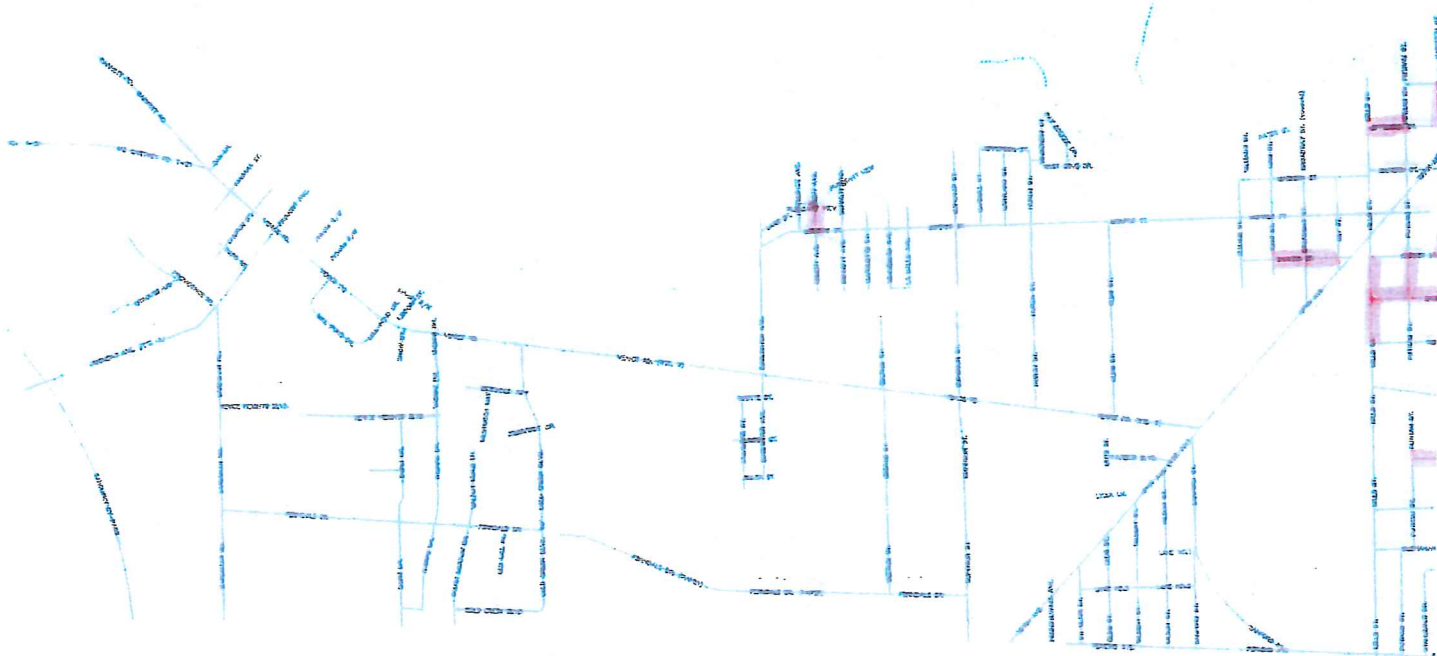

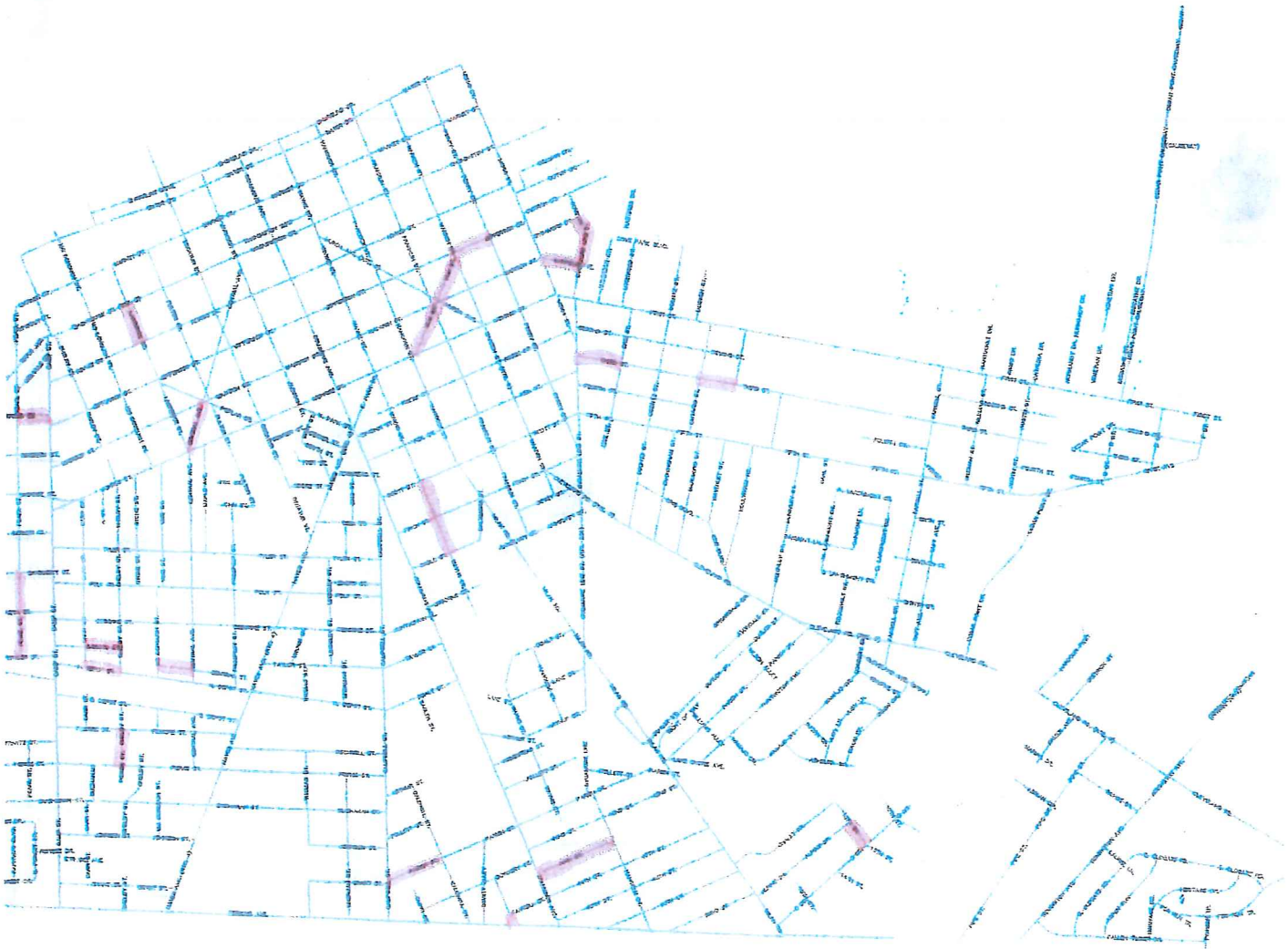

2020 PROPOSED

Name	From	To
THIRTEENTH ST	C ST	ALPINE DR
CENTRAL ST	MC DONOUGH ST	CENTRAL AVE
SHELBY ST	PIERCE ST	FILMORE ST
N DEPOT ST	HAYES AVE	THOMAS ST
HANCOCK ST	E ARTHUR ST	LANE ST
THIRD ST	ONTARIO ST	LANE ST
W JEFFERSON ST	MILLS ST	PUTNAM ST
CLINTON ST	BARKER ST	W MONROE ST
CLINTON ST	TAYLOR ST	SENECA ST
FILMORE ST	PUTNAM ST	HARRISON ST
PEARL ST	TAYLOR ST	SENECA ST
HARRISON ST	W JEFFERSON ST	W ADAMS ST
HARRISON ST	BARKER ST	W MONROE ST
N DEPOT ST	CARR ST	SHELBY ST
RANSOM ST	CARR ST	SHELBY ST
WAYNE ST	CABLE ST	FINCH ST
CENTRAL AVE	W MONROE ST	POPLAR ST
COVE ST	COVE PARK BLVD	SYCAMORE ST
PEARL ST	SENECA ST	SANDUSKY ST
SANDUSKY ST	PUTNAM ST	HARRISON ST
SYCAMORE LINE	GARFIELD AVE	COVE PARK BLVD
W PARISH ST	GRANT ST	CALDWELL ST
44 ST	COLUMBUS AVE	HANCOCK ST
CEMENT AVE	W MONROE ST	PLEASANTVIEW PL
CLINTON ST	SANDUSKY ST	BARKER ST
FILMORE ST	HARRISON ST	CLAY ST
BARKER ST	KING ST	BROADWAY ST
BARKER ST	BROADWAY ST	JAY ST
HARRISON ST	SENECA ST	SANDUSKY ST
MILLS ST	SANDUSKY ST	BARKER ST
PUTNAM ST	SANDUSKY ST	BARKER ST
SANDUSKY ST	MILLS ST	PUTNAM ST
SANDUSKY ST	HARRISON ST	CLINTON ST
ELM ST	E MONROE ST	FRANKLIN ST
SADLER ST	W PERKINS AVE	W FARWELL ST
THIRD ST	SYCAMORE LINE	ERIE ST
W JEFFERSON ST	PEARL ST	CAMP ST
GARFIELD AVE	MEIGS ST	SYCAMORE LINE
LAWRENCE ST	W ADAMS ST	W WASHINGTON ST
MC DONOUGH ST	N DEPOT ST	CENTRAL ST
MILLS ST	SENECA ST	SANDUSKY ST
PERRY ST	E ADAMS ST	E WASHINGTON ST
E JEFFERSON ST	WARREN ST	PERRY ST
ELM ST	HURON AVE	WARREN ST
WAYNE ST	FINCH ST	SCOTT ST
HORSESHOE AVE	W MONROE ST	PLEASANTVIEW PL

CHIEF FINANCIAL OFFICER'S CERTIFICATION OF LOCAL FUNDS LETTER

8-13-19

I, Hank Solowiej of the City of Sandusky, hereby certify that Sandusky has the amount of \$175,000 in the Capital Projects Fund and that this amount will be used to pay the local share for the 2020 Street Resurfacing Project when it is required.

Hank Solowiej

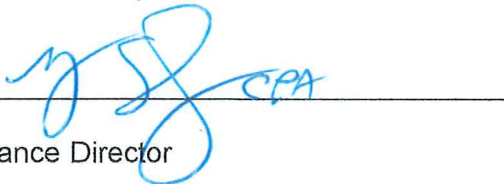

Finance Director

**DETAILED ENGINEER'S ESTIMATE /
USEFUL LIFE STATEMENT**

{NOTE: The Estimate should specify items with prices and quantities necessary for the project. Do not summarize construction into one item. A construction contingency up to 10% is permitted but inflationary adjustments are not. If the Useful Life Statement is provided on a separate page then both pages must have an engineer's seal or stamp and signature.}

2020 Resurfacing Program

ITEM	QUANTITY	UNIT	PRICE	AMOUNT
1.5"Resurfacing	53,074	SY	\$5.25	\$278,639
1.5"Milling	53,074	SY	\$0.95	\$50,361
Construction Contingency	1	LS	\$15,000	\$15,000
TOTAL				\$344,000

The estimated useful life of the 2020 Resurfacing Program is 10 years.

Engineer's Signature and Stamp or Seal



DISTRICT 5
CAPITAL IMPROVEMENT PROJECTS
QUESTIONNAIRE
ROUND 34

Name of Applicant: City of Sandusky
Project Title: 2020 Resurfacing Program

The following questions are to be answered for each application submitted for State Issue II SCIP, LTIP and Loan Projects. Please provide specific information using the best documentation available to you. Justification of your responses to these questions will be required if your project is selected for funding, so please provide correct and accurate responses. **Communities and Townships under 5,000 in population should also complete the Small Government Criteria.**

1. What percentage of the project in repair A= 50%, replacement B= 50%, expansion C= __%, and new D= __%? (Use dollar amounts of project to figure percentages and make sure the total equals one hundred(100) percent) A+B= __% C+D= __%

Repair/Replacement = Repair or Replacement of public facilities owned by the government (any subdivision of the state).

New/Expansion = Replacement of privately owned wells, septic systems, private water or wastewater systems, etc.

2. Give the physical condition rating:

Closed or Not Operating: The condition is unusable, dangerous and unsafe. The primary components have failed. The infrastructure is not functioning at all.

Critical:

The condition is causing or contributing to a serious non-compliance situation and is threatening the intended design level of service. The infrastructure is functioning at seriously diminished capacity. Imminent failure is anticipated within 18 months. Repair and/or replacement is required to eliminate the critical condition and meet current design standards. **(For Road Projects structural repair items would represent a minimum of 25% of the total Project Cost).**

Poor: The condition is substandard and requires repair/replacement in order to return to the intended level of service and comply with current design standards. Infrastructure contains a major deficiency and is functioning at a diminished capacity.

Fair: The condition is average, not good or poor. The infrastructure is still functioning as originally intended. Minor deficiencies exist requiring repair to continue to function as originally intended and/or to meet current design standards.

Good: The condition is safe and suitable to purpose. Infrastructure is functioning as

originally intended, but requires minor repairs and/or upgrades to meet current design standards.

Excellent: The condition is new, or requires no repair. Or, no supporting documentation has been submitted.

* **In order to receive points provide supporting documentation (e.g. photos, a narrative, maintenance history, or third party findings) to justifying the rating.**

3. If the proposed project is not approved what category would best represent the impact on the general health and/or public safety?

ROADS

Extremely Critical: Resurfacing, Restoration, Rehabilitation and Reconstruction (4R) of a Major Access Road.* **(No DEAD ENDS)**

Critical: Resurfacing, Restoration and Rehabilitation (3R) of a Major Access Road.*

Major: Resurfacing, Restoration, Rehabilitation and Reconstruction (4R) of a Minor Access Road.*

Moderate: Resurfacing, Restoration and Rehabilitation (3R) of a Minor Access Road.*

Minimal: Preventative Maintenance of a Major Access Road.

No Impact: Preventative Maintenance of a Minor Access Road.

Projects that have a variety of work will be scored in the LOWEST category of work contained in the Construction Estimate.

Road/Street Classifications:

Major Access Road: Roads or streets that have a dual function of providing access to adjacent properties and providing through or connecting service between other roads.

Minor Access Road: Roads or streets that primarily provide access to adjacent properties without through continuity, such as cul-de-sacs or loop roads or streets.

Preventative Maintenance: Non Structural Pavement work such as chip sealing, cape sealing, micro-surfacing, crack sealing, etc.

*(3R) Resurfacing, Restoration and Rehabilitation - Improvements to existing roadways, which have as their main purpose, the restoration of the physical features (pavement, curb, guardrail, etc.) without altering the original design elements. (Surface and Intermediate layer Mill and Fills, overlays with less than or equal to 3" of additional pavement, ect...)

*(4R) Resurfacing, Restoration, Rehabilitation and Reconstruction - Much like 3R, except that 4R allows for the complete reconstruction of the roadway and alteration of certain design elements (i.e., lane widths, shoulder width, SSD, overlays with greater than 3" of additional pavement, etc.).

BRIDGES SUFFICIENCY RATING

Extremely Critical: 0-25, or a General Appraisal rating of 3 or less.
Critical: 27-50, or a General Appraisal rating of 4.
Major: 51-65 or a General Appraisal rating of 5 or 6.
Moderate: 66-80 or a General Appraisal rating of 7.
Minimal: 81-100 or a General Appraisal rating of more than 7.
No Impact: Bridge on a new roadway.

WASTEWATER TREATMENT PLANTS

Extremely Critical: Environmental Protection Agency (EPA) orders in the form of a consent decree, findings and orders or court order. Health Department Construction Ban.
Critical: Improvements ordered by the Environmental Protection Agency (EPA) in the form of NPDES Orders.
Major: Replace deficient appurtenances. Update existing processes due to EPA recommendations.
Moderate: Increase capacity to meet current needs or update processes to improve effluent quality.
Minimal: New/Expansion project to meet a specific development proposal.
No Impact: New/Expansion to meet future or projected needs.

WATER TREATMENT PLANT

Extremely Critical: EPA orders in the form of a consent decree, findings and orders or court order.
Critical: Improvements to meet Environmental Protection Agency (EPA) Safe Drinking Water Regulations and/or NPDES Orders.
Major: Replace deficient appurtenances. Update existing processes due to EPA recommendations.
Moderate: Increase capacity to meet current needs or update processes to improve water quality.
Minimal: New/Expansion project to meet a specific development proposal.

No Impact: New/Expansion to meet future or projected needs.

COMBINED SEWER SEPARATIONS (May be construction of either new storm or sanitary sewer as long as the result is two separate sewer systems.)

Extremely Critical: EPA orders in the form of a consent decree, findings and orders or court order. Health Department Construction Ban.

Critical: Separate, due to chronic backup or flooding in basements.

Major: Separate, due to documented water quality impairment, or due to EPA recommendations.

Moderate: Separate, due to specific development proposal within or upstream of the combined system area.

Minimal: Separate, to conform to current design standards.

No Impact: No positive health effect.

STORM SEWERS

Extremely Critical: EPA orders in the form of a consent decree, findings and orders or court order.

Critical: Chronic flooding (structure damage).

Major: Inadequate capacity (land damage).

Moderate: Inadequate capacity with no associated damage.

Minimal: New/Expansion to meet current needs.

No Impact: New/Expansion to meet future or project needs.

CULVERTS

Extremely Critical: Structurally deficient or functionally obsolete. Deterioration has already caused a safety Critical: hazard to the public.

Critical: Inadequate capacity with land damage and the existing or high probability of property damage.

Major: Inadequate capacity (land damage).

Moderate: Inadequate capacity with no associated damage.

Minimal: New/Expansion to meet current needs.

No Impact: New/Expansion to meet future or projected needs.

SANITARY SEWERS

Extremely Critical: EPA orders in the form of a consent decree, findings and orders or court order. Health Department Construction Ban.

Critical: Replace, due to chronic pipe failure, chronic backup or flooding in basements. Improvements ordered by the Environmental Protection Agency (EPA) in the form of NPDES Orders.

Major: Replace, due to inadequate capacity or infiltration, or due to EPA recommendations.

Moderate: Rehabilitate to increase capacity to meet current needs or to reduce inflow and infiltration.

Minimal: New/Expansion project to meet a specific development proposal.

No Impact: New/Expansion to meet future or projected needs.

SANITARY LIFT STATIONS AND FORCE MAINS

Extremely Critical: Structurally deficient. Deterioration has already caused a safety/health hazard to the public, or, EPA orders in the form of a consent decree, findings and orders or court order.

Critical: Inadequate capacity with actual or a high probability of property damage. Improvements ordered by the Environmental Protection Agency (EPA) in the form of NPDES Orders.

Major: EPA recommendations, or, reduces a probable health and/or safety problem.

Moderate: Rehabilitate to increase capacity to meet current needs.

Minimal: New/Expansion to meet a specific development proposal.

No Impact: New/Expansion to meet future or projected needs.

WATER PUMP STATIONS

Extremely Critical: Structurally deficient. Deterioration has already caused a safety hazard to the public, or, EPA orders in the form of a consent decree, findings and orders or court order.

Critical: Inadequate capacity with the inability to maintain pressure required for fire flows.

Major: Replace due to inadequate capacity or EPA recommendations.

- Moderate: Rehabilitate to increase capacity to meet current needs.
- Minimal: New/Expansion to meet a specific development proposal.
- No Impact: New/Expansion to meet future or projected needs.

WATER LINES/WATER TOWERS

- Extremely Critical: Solve low water pressure or excessive incidents of main breaks in project area.
- Critical: Replace, due to deficiency such as excessive corrosion, etc.
- Major: Replace undersized water lines as upgrading process.
- Moderate: Increase capacity to meet current needs.
- Minimal: New/Expansion project to meet a specific development proposal.
- No Impact: New/Expansion to meet future or projected needs.

OTHER

- Extremely Critical: There is a present health and/or safety threat.
- Critical: The project will provide immediate health and/or safety benefit.
- Major: The project will reduce a probable health and/or safety problem.
- Moderate: The project will delay a health and/or safety problem.
- Minimal: A possible future health and/or safety problem mitigation.
- No Impact: No health and/or safety effect.

NOTE: Combined projects that can be rated in more than one subset may be rated in the other category at the discretion of the District 5 Executive Committee. In general, the majority of the cost or scope of the project shall determine the category under which the project will be scored.

(Submittals without supporting documentation will receive 0 Points for this question.)

Extremely Critical ____, Critical ____, Major ____, Moderate ____, Minimal ____, No Impact ____. Explain your answer.

(Additional narrative, charts and/or pictures should be attached to questionnaire)

4. Identify the amount of local funds that will be used on the project as a percentage of the total project cost.

A.) Amount of Local Funds = \$ 175K

B.) Total Project Cost = \$ 350K

RATIO OF LOCAL FUNDS DIVIDED by TOTAL PROJECT COSTS (A/B)= 50 %

Note: Local funds should be considered funds derived from the applicant budget or loans funds to be paid back through local budget, assessments, rates or tax revenues collected by the applicant.

5. N/A Identify the amount of other funding sources to be used on the project, excluding State Issue II or LTIP Funds, as a percentage of the total project cost.

Grants ___% Gifts ___%, Contributions ___%

Other ___% (explain) _____, Total ___%

Note: Grant funds and other revenues not contributed or collected through taxes by the applicant should be considered other funds. The Scope of Work for each Funding Source must be the same.

6. Total Amount of SCIP and Loan Funding Requested- An Applicant can request a grant per the categories below for points as indicated on the Priority Rating Sheet. If the Applicant is including a loan request equal to, but not exceeding 50% of the OPWC funding amounts listed below, there will be no point penalty. If loan funds requested are more than 50%, points as listed in the Priority Rating Sheet will apply.

- _____ \$500,001 or More
- _____ \$400,001-\$500,000
- _____ \$325,001-\$400,000
- _____ \$275,001-\$325,000
- _____ \$175,001-\$275,000
- X _____ \$175,000 or Less

There are times when the District spends all of the grant money and has loan money remaining. When this happens, the district makes a loan offer in the amount of the requested grant to the communities that were not funded. The offers are made in the order of scoring. We need to know if you are not successful in obtaining grant dollars for your project if you would be interested in loan money:

YES X NO _____

(This will only be considered if you are not funded with grant money and there is remaining loan money.) Please note: if you answer "no" you will not be contacted, only if you answer "yes" will an offer be made in the event that there is loan money remaining.

7. If the proposed project is funded, will its completion directly result in the creation of permanent full-time

N/A

equivalent (FTE) jobs (FTE jobs shall be defined as 35 hours/week) ? Yes ___ No ___. If yes, how many jobs within eighteen months? ___ Will the completed project retain jobs that would otherwise be permanently lost? Yes ___ No ___. If yes, how many jobs ___ will be created/retrained within 18 months following the completion of the improvements?

(Supporting documentation in the form of letter from affected industrial or commercial enterprises that specify full time equivalent jobs that will be retained or created directly by the installation or improvement of Public infrastructure. Additional items such as; 1) newspaper articles or other media news accounts, 2) public meeting minutes, and/or 3) a letter from the County Economic Development Director or State of Ohio Economic Development Professional that alludes to the requirement for the infrastructure improvement to support the business. Submittals without supporting documentation will receive 0 points for this question.)

8. What is the total number of existing users that will directly benefit from the proposed project if completed? 71000 (Use households served, traffic counts, etc. and explain the basis by which you arrived at your number.)

9. Is subdivision's population less than 5,000 Yes ___ No
 If yes, continue. You may want to design your project per Small Government Project Evaluation Criteria, released for the current OPWC Round to assist in evaluating your project for potential Small Government Funding. The Small Government Criteria is available on the OPWC website at <http://www.pwc.state.oh.us/Meth.SG.PDF> If No, skip to Question 11.

10. **OHIO PUBLIC WORKS COMMISSION SMALL GOVERNMENT PROGRAM GUIDELINES**

All projects that are sponsored by a subdivision with a population of 5,000 or less, and not earning enough points for District Funding from SCIP or LTIP Funds, are then rated using the Small Government Program Rating Criteria for the corresponding funding round. In order to be rated the entity must submit the Small Government Supplement and their required budgets with their application. **Only infrastructure that is village- or township- owned is eligible for assistance.** The following policies have been adopted by the Small Government Commission:

- District Integrating Committees may submit up to seven (7) applications for consideration by the Commission. All 7 must be ranked, however, only the top five (5) will be scored. The remaining two (2) will be held as contingency projects should an application be withdrawn.
- Grants are limited to \$500,000. Any assistance above that amount must be in the form of a loan.

- Grants for new or expanded infrastructure cannot exceed 50% of the project estimate.
- The Commission may deny funding for water and sewer systems that are deemed to be more cost-effective if regionalized.
- If a water or sewer project is determined to be affordable, the project will be offered a loan rather than a grant. Pay special attention to the **Water & Wastewater Affordability Supplemental** and the **Small Government Water & Wastewater Affordability Calculation Worksheet**. Both are available on the **Small Government Program Tab** at <http://www.pwc.state.oh.us/SmallGovernment.html>
- Should there be more projects that meet the “annual score” than there is funding, the tie breaker is those projects which scored highest under Health & Safety, with the second tie breaker being Condition. If multiple projects have equivalent Health & Safety and Condition scores they are arranged according to the amount of assistance from low to high. Once the funded projects are announced, “contingency projects” may be funded from project under-runs by continuing down the approved project list.
- Supplemental assistance is not provided to projects previously funded by the Commission.
- Applicants have 30 days from receipt of application by OPWC without exception to provide additional documentation to make the application more competitive under the Small Government criteria. Applications will be scored after the 30-day period has expired. The applicants for each District's two (2) contingency projects will have the same 30-day period to submit supplemental information but these applications will not be scored unless necessary to do so. It is each applicant's responsibility for determining the need for supplemental material. The applicant will not be asked for or notified of missing information unless the Commission has changed the project type and it affects the documentation required. Important information may include, but is not limited to: age of infrastructure, traffic counts or utility users, median income information, user rates ordinances, and the Auditor's Certificate of Estimated Revenues or documentation from the Auditor of State that subdivision is in a state of fiscal emergency.

If you desire to have your Round 33 project considered for Small Government Funding please download the Small Government Evaluation Criteria applicable to Round 33 by accessing the OPWC Website at <http://www.pwc.state.oh.us/Meth.SG.PDF>. Please complete the Small Government Evaluation Criteria and attach all required supporting documentation and attach it to the District 5 Questionnaire for Round 32.

11. MANDATORY INFORMATION, DISTRICT 5, DISCRETIONARY RANKING POINTS

List all specific user fees: Amount or
ROAD & BRIDGE PROJECTS: (OHIO REVISED CODE) Percentage

Permissive license fee	4504.02 or 4504.06 _____
	4504.15 or 4504.17 _____
	4504.16 or 4504.171 _____
	4504.172 _____
	4504.18 _____

District 5

Capital Improvement Project

Priority Rating Sheet, Round 34

Revised 04/23/19

COUNTY:		PROJECT NUMBER																												
PROJECT:																														
EST. COST:																														
No.	"A" WEIGHT FACTOR	CRITERIA TO BE CONSIDERED	"B" PRIORITY FACTORS										"A" x "B"	Priority Factors						No.										
			0	2	4	6	8	10	0	2	4	6		8	10															
1	1	(Repair or Replace) vs. (New or Expansion)	0	2	4	6	8	10	0	2	4	6	8	10	0%+ Repair or Replacement	20%+ Repair or Replacement	40%+ Repair or Replacement	60%+ Repair or Replacement	80%+ Repair or Replacement	100%+ Repair or Replacement	10	1								
2	1.5	Existing Physical Condition: Must submit substantiating documentation and CIR (100% New or Expansion is 0 Points)	0	2	4	6	8	10	0	2	4	6	8	10	Excellent	Good	Fair	Poor	Critical	Closed or Not Operating	12	2								
3	2	Public Health and/or Public Safety Concerns Submittals without supporting documentation will receive 0 points for this criterion	0	2	4	6	8	10	0	2	4	6	8	10	No Impact	Minimal	Moderate	Major	Critical	Extremely Critical	20	3								
4	2	Percentage of Local Share (Local funds are funds derived from the applicant budget or a loan to be paid back through the applicant budget, assessments, rates or revenues)	0	2	4	6	8	10	0	2	4	6	8	10	0%+	10%+	20%+	30%+	40%+	50%+	20	4								
5	1	OTHER FUNDING SOURCES (Excluding Issue # Funds) (Grants and other revenues not counted or collected through taxes by the applicant, including Gifts, Contributions, etc. - must submit copy of award or status letter.)	0	2	4	6	8	10	0	2	4	6	8	10	0%+	10%+	20%+	30%+	40%+	50%+	0	5								
No.	"A" WEIGHT FACTOR	CRITERIA TO BE CONSIDERED	"B" PRIORITY FACTORS										"A" x "B"	Priority Factors						No.										
			-9	-8	-7	-6	-5	-4	-3	-2	-1	0		1	2	3	4	5	6		7	8	9	10						
E	2	DPWC Grant and Loan Funding Requested, Please refer to Item 6 on Questionnaire for Clarification.	-9	-8	-7	-6	-5	-4	-3	-2	-1	0	1	2	3	4	5	6	7	8	9	10	Grant or Loan Only \$500,001 to \$1,000,000	\$400,001 to \$500,000	\$325,001 to \$400,000	\$275,001 to \$325,000	\$175,001 to \$275,000	\$175,000 or less	20	6
	2		-9	-8	-7	-6	-5	-4	-3	-2	-1	0	1	2	3	4	5	6	7	8	9	10	Grant/Loan Combination \$750,000 to \$1,000,000	\$600,001 to \$750,000	\$487,501 to \$600,000	\$412,501 to \$487,500	\$325,001 to \$412,500	\$250,000 or less		6
When scoring a project that is only grant or only loan, please use the chart labeled "Grant or Loan Only". When scoring a grant/loan combination, score the project for the grant in the first chart, then use the second chart labeled "Grant/Loan Combination" to score the total (grant and loan combined). Use the lower of the two as the score.																														
No.	"A" WEIGHT FACTOR	CRITERIA TO BE CONSIDERED	"B" PRIORITY FACTORS										"A" x "B"	Priority Factors						No.										
			0	2	4	6	8	10	0	2	4	6		8	10															
7	1	Will the Proposed Project Create Permanent jobs or retain jobs that would otherwise be permanently lost? (Written Documentation Required)	0	2	4	6	8	10	0	2	4	6	8	10	0+ jobs	7+ jobs	15+ jobs	25+ jobs	57+ jobs	100+ jobs	0	8								
8	1	Benefit to Existing Users such as households, (Equivalent dwelling units), traffic counts, etc.	0	2	4	6	8	10	0	2	4	6	8	10	0-	100-	350+	500-	750+	1000+	10	9								
9		SUBTOTAL RANKING POINTS (MAX = 115)											92	Other Info: Does this project have a significant impact on productive farmland? YES NO Attach Impact statement if yes. Is the Applicant ready to proceed to bids after State Approval within 8 months? YES NO																
10		COUNTY PRIORITY POINTS (25-20 IS)																												
11		DISCRETIONARY POINTS (BY DISTRICT QV, V1, MAX = 12)																												
12		GRAND TOTAL RANKING POINTS																												

* Applicants must certify local share contribution. Specify, all funding sources to be utilized as local share at the time of application submittal.

CERTIFICATION

I, Kelly L. Kresser, Clerk of the City Commission of the City of Sandusky, Ohio, do hereby certify that the attached is a true and correct copy of **Resolution 032-19R** adopted at a regular meeting of the Commission of the City of Sandusky, Erie County, Ohio, which was held on August 12, 2019.

Given under my hand and seal this 12th day of August, 2019:



Kelly L. Kresser, CMC
Clerk of the City Commission
City of Sandusky, Ohio

RESOLUTION NO. 032-19R

A RESOLUTION AUTHORIZING THE SUBMISSION OF AN APPLICATION BY THE CITY MANAGER FOR FINANCIAL ASSISTANCE AND TO ENTER INTO A PROJECT AGREEMENT WITH THE OHIO PUBLIC WORKS COMMISSION IN ORDER TO PARTICIPATE IN THE OHIO PUBLIC WORKS COMMISSION'S STATE CAPITAL IMPROVEMENT AND/OR LOCAL TRANSPORTATION IMPROVEMENT PROGRAMS AUTHORIZED BY CHAPTER 164 (AID TO LOCAL GOVERNMENT IMPROVEMENTS) OF THE OHIO REVISED CODE FOR THE 2020 CITYWIDE RESURFACING PROJECT; AND DECLARING THAT THIS RESOLUTION TAKE IMMEDIATE EFFECT IN ACCORDANCE WITH SECTION 14 OF THE CITY CHARTER.

WHEREAS, TransMap performed a citywide pavement survey in 2015, which was updated in June of 2019, and the updated survey indicated there is a great need for asphalt pavement repair throughout the City; and

WHEREAS, the proposed 2020 Citywide Resurfacing Project involves the milling and resurfacing of forty-six (46) of the worst asphalt street segments (block to block) in the City, along with making other repairs as needed, and this work will address many of the complaint areas and prevent further damage that would then require more intensive and expensive construction; and

WHEREAS, the estimated cost for the 2020 Citywide Resurfacing Project is \$350,000.00 and the City is requesting grant funds in the amount of \$175,000.00 (50% of the estimated project cost) and if awarded, the City's portion of the project will be paid with Issue 8 funds from the Capital Projects Fund; and

WHEREAS, a certified copy of the legislation approving the project is required by the governing body of the applicant; and

WHEREAS, this Resolution should be passed as an emergency measure under suspension of the rules in accordance with Section 14 of the City Charter in order for the grant application and Resolution to be submitted to the Ohio Public Works Committee by the deadline of September 7, 2019; and

WHEREAS, in that it is deemed necessary in order to provide for the immediate preservation of the public peace, property, health, and safety of the City of Sandusky, Ohio, and its citizens, and to provide for the efficient daily operation of the Municipal Departments, including the Department of Public Works, of the City of Sandusky, Ohio, the City Commission of the City of Sandusky, Ohio, finds that an emergency exists regarding the aforesaid, and that it is advisable that this **Resolution** be declared an emergency measure which will take immediate effect in accordance with Section 14 of the City Charter; and NOW, THEREFORE,

BE IT RESOLVED BY THE CITY COMMISSION OF THE CITY OF SANDUSKY, OHIO, THAT:

Section 1. This City Commission hereby approves the submission of an application for financial assistance with the Ohio Public Work's Commission's State Capital Improvement and/or Local Transportation Improvement Programs as provided in Chapter 164 of the Ohio Revised Code for the 2020 Citywide Resurfacing Project, authorizes and directs the City Manager to file the application

RLM

PAGE 2 - RESOLUTION NO. 032-19R

for assistance and authorizes and directs the City Manager and/or Finance Director to provide any necessary information and assurances and to execute appropriate project agreements if assistance is awarded by the Ohio Public Works Commission.

Section 2. If any section, phrase, sentence, or portion of this Resolution is for any reason held invalid or unconstitutional by any Court of competent jurisdiction, such portion shall be deemed a separate, distinct, and independent provision, and such holding shall not affect the validity of the remaining portions thereof.

Section 3. This City Commission finds and determines that all formal actions of this City Commission concerning and relating to the passage of this Resolution were taken in an open meeting of this City Commission and that all deliberations of this City Commission and of any of its committees that resulted in those formal actions were in meetings open to the public in compliance with the law.

Section 4. That for the reasons set forth in the preamble hereto, this Resolution is hereby declared to be an emergency measure which shall take immediate effect in accordance with Section 14 of the City Charter after its adoption and due authentication by the President and the Clerk of the City Commission of the City of Sandusky, Ohio.

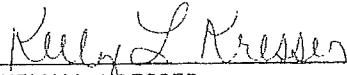

DENNIS E. MURRAY, JR.
PRESIDENT OF THE CITY COMMISSION

ATTEST: 

KELLY L. KRESSER
CLERK OF THE CITY COMMISSION

Passed: August 12, 2019



MILLS ST. - ODOT TIMS Map

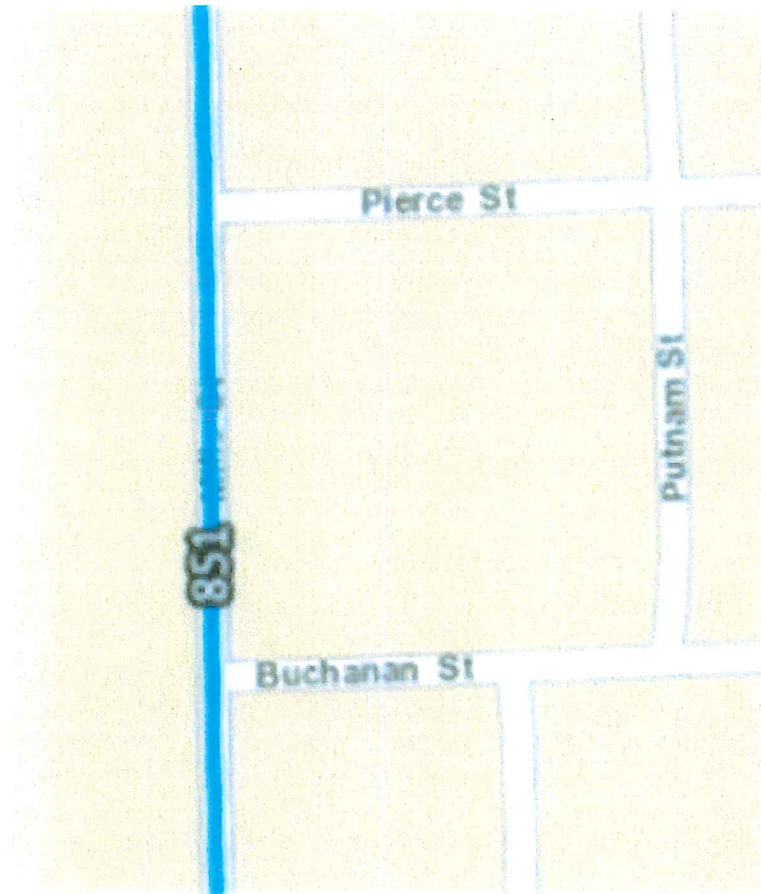

N. DEPOT ST. - ODOT TIMS Map

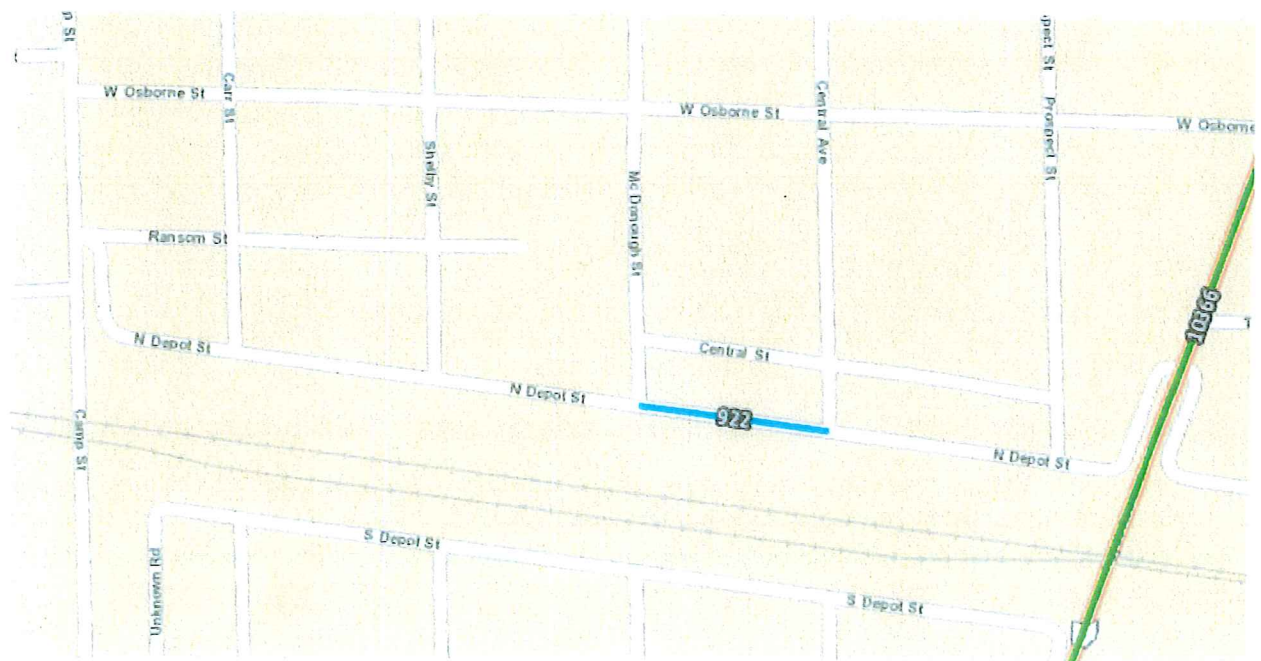

3462298	Erie	CITY OF SANDUSKY	Major Collector	U	MILLS ST	BUCHANAN ST	PIERCE ST			MILLS ST S OF SENECA ST, IN SANDUSKY	2-WAY	NB/SB			41.4368953	-82.7272761	1060	7/29/2014
19422	ERIE	-	Major Collector	U	MILLS ST						2-WAY	NB/SB	CENIR000501**C	0.535	41.4411157	-82.727426	861	1/1/2018
3472298	Erie	CITY OF SANDUSKY	Minor Arterial	U	MONROE ST	WARREN ST	PERRY ST				2-WAY	EB/WB			41.4525456	-82.7010441	734	8/14/2014
3482298	Erie	CITY OF SANDUSKY	Minor Arterial	U	MONROE ST	PEARL ST	CLINTON ST				2-WAY	EB/WB	CENIR000500**C	1.769	41.446691	-82.722171	729	1/1/2019
3492298	Erie	CITY OF SANDUSKY	-		MONROE ST	COLUMBUS AVE	WAYNE ST				2-WAY	EB/WB			41.449694	-82.709605	6263	8/8/2016
3502298	Erie	CITY OF SANDUSKY	-		MONROE ST	DECATUR ST	JACKSON ST				2-WAY	EB/WB			41.44916	-82.711192	8809	8/8/2016
206991	ERIE	SANDUSKY	Local	U	N DEPOT ST					12TH ST NEAR C ST, SANDUSKY	2-WAY		MPENIR000410**C	0.306	41.440644	-82.714845	933	1/1/2018









