

**Ohio Public Works Commission
District 5 Round 36**

**Little Portage E TR #112, Walbridge East TR #68,
Curtice E & W TR #70, & Bier TR #97
Roads Resurfacing**

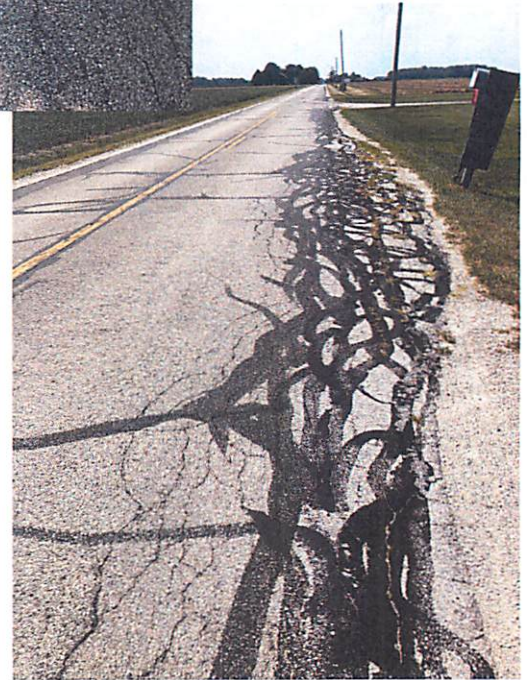
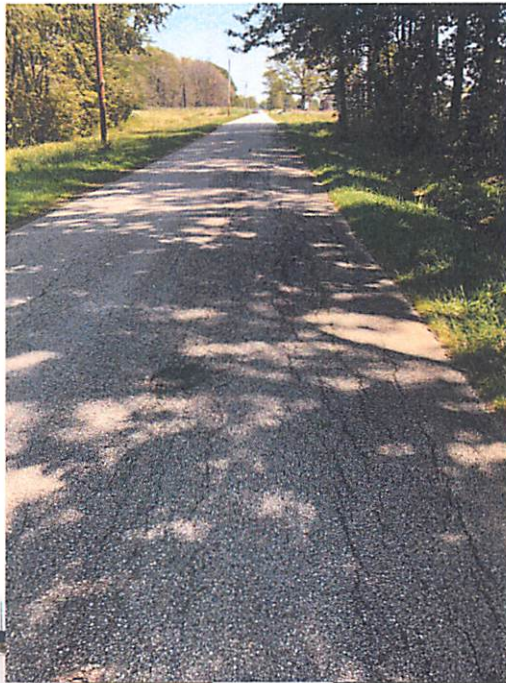

**Salem Township
Ottawa County, Ohio**

**Little Portage East TR #112, Walbridge East TR #68,
Curtice East & West TR #70 & Bier TR #97
Roads Resurfacing
Table of Contents**

OPWC Application

Resolution and Cooperative Agreement

Financial Certifications

Engineer's Estimate

Traffic Counts

Road Cards

Condition Ratings

Farmland Preservation Review Letter

Supporting Items:

Project Narratives

Maps

Photos

Road Detail Sheets

Letters of Support

Questionnaire

Small Government Items:

Rating Scales

Official Certificate(s) of Estimated Resources

Engineer's Plan Status Certification

Calculations for Rating Scales – Questions 1, 5 and 10

Priority Rating Sheet



State of Ohio
Public Works Commission
Application for Financial Assistance

IMPORTANT: Please consult "Instructions for Financial Assistance for Capital Infrastructure Projects" for guidance in completion of this form.

Applicant

Applicant: Salem Township Subdivision Code: 123-69946

District Number: 5 County: Ottawa Date: 07-02-2021

Contact: Ronald P Lajti, Jr., P.E., P.S., Ottawa County Engineer Phone: (419) 734-6777
(The individual who will be available during business hours and who can best answer or coordinate the response to questions)

Email: OttawaCoEng@co.ottawa.oh.us FAX: (419) 734-6768

Project

Project Name: Little Portage E, Walbridge E, Curtice E & W, & Bier Roads Resurfacing Zip Code: 43449

Subdivision Type	Project Type	Funding Request Summary
<small>(Select one)</small>	<small>(Select single largest component by \$)</small>	<small>(Automatically populates from page 2)</small>
<input type="checkbox"/> 1. County	<input checked="" type="checkbox"/> 1. Road	Total Project Cost: <u>517,390.00</u>
<input type="checkbox"/> 2. City	<input type="checkbox"/> 2. Bridge/Culvert	1. Grant: <u>258,500.00</u>
<input checked="" type="checkbox"/> 3. Township	<input type="checkbox"/> 3. Water Supply	2. Loan: <u>50,000.00</u>
<input type="checkbox"/> 4. Village	<input type="checkbox"/> 4. Wastewater	3. Loan Assistance/ Credit Enhancement: <u>0.00</u>
<input type="checkbox"/> 5. Water (6119 Water District)	<input type="checkbox"/> 5. Solid Waste	Funding Requested: <u>308,500.00</u>
	<input type="checkbox"/> 6. Stormwater	

District Recommendation (To be completed by the District Committee)

<u>Funding Type Requested</u> <small>(Select one)</small>	SCIP Loan - Rate: _____ % Term: _____ Yrs	Amount: _____ .00
<input type="checkbox"/> State Capital Improvement Program	RLP Loan - Rate: _____ % Term: _____ Yrs	Amount: _____ .00
<input type="checkbox"/> Local Transportation Improvement Program	Grant:	Amount: _____ .00
<input type="checkbox"/> Revolving Loan Program	LTIP:	Amount: _____ .00
<input type="checkbox"/> Small Government Program	Loan Assistance / Credit Enhancement:	Amount: _____ .00
District SG Priority: _____		

For OPWC Use Only

<u>STATUS</u>	Grant Amount: _____ .00	Loan Type: <input type="checkbox"/> SCIP <input type="checkbox"/> RLP
Project Number: _____	Loan Amount: _____ .00	Date Construction End: _____
_____	Total Funding: _____ .00	Date Maturity: _____
Release Date: _____	Local Participation: _____ %	Rate: _____ %
OPWC Approval: _____	OPWC Participation: _____ %	Term: _____ Yrs

1.0 Project Financial Information (All Costs Rounded to Nearest Dollar)

1.1 Project Estimated Costs

Engineering Services

Preliminary Design:	_____	.00	
Final Design:	_____	.00	
Construction Administration:	<u>15,000</u>	.00	
Total Engineering Services:	a.) <u>15,000</u>	.00	<u>3</u> %
Right of Way:	b.) _____	.00	
Construction:	c.) <u>454,900</u>	.00	
Materials Purchased Directly:	d.) _____	.00	
Permits, Advertising, Legal:	e.) <u>2,000</u>	.00	
Construction Contingencies:	f.) <u>45,490</u>	.00	<u>10</u> %
Total Estimated Costs:	g.) <u>517,390</u>	.00	

1.2 Project Financial Resources

Local Resources

Local In-Kind or Force Account:	a.) <u>208,890</u>	.00	
Local Revenues:	b.) _____	.00	
Other Public Revenues:	c.) _____	.00	
ODOT / FHWA PID: _____	d.) _____	.00	
USDA Rural Development:	e.) _____	.00	
OEPA / OWDA:	f.) _____	.00	
CDBG:	g.) _____	.00	
<input type="checkbox"/> County Entitlement or Community Dev. "Formula"			
<input type="checkbox"/> Department of Development			
Other: _____	h.) _____	.00	
Subtotal Local Resources:	i.) <u>208,890</u>	.00	<u>40</u> %

OPWC Funds (Check all requested and enter Amount)

Grant: <u>84</u> % of OPWC Funds	j.) <u>258,500</u>	.00	
Loan: <u>16</u> % of OPWC Funds	k.) <u>50,000</u>	.00	
Loan Assistance / Credit Enhancement:	l.) <u>0</u>	.00	
Subtotal OPWC Funds:	m.) <u>308,500</u>	.00	<u>60</u> %
Total Financial Resources:	n.) <u>517,390</u>	.00	<u>100</u> %

1.3 Availability of Local Funds

Attach a statement signed by the Chief Financial Officer listed in section 5.2 certifying all local resources required for the project will be available on or before the earliest date listed in the Project Schedule section. The OPWC Agreement will not be released until the local resources are certified. Failure to meet local share may result in termination of the project. Applicant needs to provide written confirmation for funds coming from other funding sources.

2.0 Repair / Replacement or New / Expansion

2.1 Total Portion of Project Repair / Replacement:	_____ 517,390 .00	_____ 100 %
2.2 Total Portion of Project New / Expansion:	_____ 0 .00	_____ 0 %
2.3 Total Project:	_____ 517,390 .00	_____ 100 %

A Farmland Preservation letter is required for any impact to farmland

3.0 Project Schedule

3.1 Engineering / Design / Right of Way	Begin Date: <u>01/03/2022</u>	End Date: <u>02/28/2023</u>
3.2 Bid Advertisement and Award	Begin Date: <u>03/01/2023</u>	End Date: <u>03/31/2023</u>
3.3 Construction	Begin Date: <u>04/01/2023</u>	End Date: <u>06/30/2023</u>

Construction cannot begin prior to release of executed Project Agreement and issuance of Notice to Proceed. Failure to meet project schedule may result in termination of agreement for approved projects. Modification of dates must be requested in writing by project official of record and approved by the Commission once the Project Agreement has been executed.

4.0 Project Information

If the project is multi-jurisdictional, information must be consolidated in this section.

4.1 Useful Life / Cost Estimate / Age of Infrastructure

Project Useful Life: 15 Years Age: 2000 (Year built or year of last major improvement)

Attach Registered Professional Engineer's statement, with seal or stamp and signature confirming the project's useful life indicated above and detailed cost estimate.

4.2 User Information

Road or Bridge: Current ADT 1,036 Year 2021 Projected ADT 1,264 Year 2041

Water / Wastewater: Based on monthly usage of 4,500 gallons per household; attach current ordinances.

Residential Water Rate Current \$ _____ Proposed \$ _____

Number of households served: _____

Residential Wastewater Rate Current \$ _____ Proposed \$ _____

Number of households served: _____

Stormwater: Number of households served: _____

4.3 Project Description

- A: SPECIFIC LOCATION** (Supply a written location description that includes the project termini; a map does not replace this requirement.) 500 character limit.

Ottawa County - Salem Township - Section 13
Little Portage East Road TR #112

Ottawa County - Allen Township - Sections 2, 11, 30 & 31
Walbridge East Road TR #68
Curtice East & West Road TR #70

Ottawa County - Carroll Township - Sections 26 & 27
Bier Road TR #97

- B: PROJECT COMPONENTS** (Describe the specific work to be completed; the engineer's estimate does not replace this requirement) 1,000 character limit.

Little Portage East Road

1. Apply 0.75" asphalt concrete scratch/leveling course to profile and smooth the roadway surface.
2. Overlay with 1.25" asphalt concrete surface course.
3. Apply berm stone.

Walbridge East Road

1. Apply an asphalt concrete scratch/leveling course to increase structural capacity as well as profile and smooth the roadway surface.
2. Overlay entire road with cold mix leveling course.
3. Apply berm stone.

Curtice East & West Road

1. Apply an asphalt concrete scratch/leveling course to increase structural capacity as well as profile and smooth the roadway surface.
2. Overlay entire road with cold mix leveling course.
3. Apply berm stone.

Bier Road

1. Perform spot pavement repairs as necessary to fix isolated pavement failures.
2. Apply 0.75" asphalt concrete scratch/leveling course to profile and smooth the roadway surface. Overlay with 1.25" asphalt concrete surface course.
3. Apply berm stone.

- C: PHYSICAL DIMENSIONS** (Describe the physical dimensions of the existing facility and the proposed facility. Include length, width, quantity and sizes, mgd capacity, etc in detail.) 500 character limit.

Little Portage East Road TR #112 - .103 miles long, 16 feet wide
Walbridge East Road TR #68 - 1.00 miles long, 18.5 feet wide
Curtice East & West Road TR #70 - .52 miles long, 20.5 feet wide
Bier Road TR #97 - 1.52 miles long, 17.5 feet wide

5.0 Project Officials

Changes in Project Officials must be submitted in writing from an officer of record.

5.1 Chief Executive Officer (Person authorized in legislation to sign project agreements)

Name: Richard Lenke
Title: Salem Township Trustee
Address: P.O. Box 417

City: Oak Harbor State: OH Zip: 43449
Phone: (419) 898-4579
FAX: (419) 898-4126
E-Mail: LenkeFarms@outlook.com

5.2 Chief Financial Officer (Can not also serve as CEO)

Name: Aaron Avery
Title: Salem Township Fiscal Officer
Address: 11650 W Portage River South Road
P. O. Box 417
City: Oak Harbor State: OH Zip: 43449
Phone: (419) 351-9006
FAX: (419) 898-4126
E-Mail: salemtwp@cros.net

5.3 Project Manager

Name: Ronald P Lajti JR, PE PS
Title: Ottawa County Engineer
Address: 8247 W State Route #163

City: Oak Harbor State: OH Zip: 43449
Phone: (419) 734-6777
FAX: (419) 734-6768
E-Mail: rlajti@co.ottawa.oh.us

6.0 Attachments / Completeness review

Confirm in the boxes below that each item listed is attached (Check each box)

- A certified copy of the legislation by the governing body of the applicant authorizing a designated official to sign and submit this application and execute contracts. This individual should sign under 7.0, Applicant Certification, below.
- A certification signed by the applicant's chief financial officer stating the amount of all local share funds required for the project will be available on or before the dates listed in the Project Schedule section. If the application involves a request for loan (RLP or SCIP), a certification signed by the CFO which identifies a specific revenue source for repaying the loan also must be attached. Both certifications can be accomplished in the same letter.
- A registered professional engineer's detailed cost estimate and useful life statement, as required in 164-1-13, 164-1-14, and 164-1-16 of the Ohio Administrative Code. Estimates shall contain an engineer's seal or stamp and signature.
- A cooperative agreement (if the project involves more than one subdivision or district) which identifies the fiscal and administrative responsibilities of each participant.
- Farmland Preservation Review - The Governor's Executive Order 98-IV, "Ohio Farmland Protection Policy" requires the Commission to establish guidelines on how it will take protection of productive agricultural and grazing land into account in its funding decision making process. Please include a Farm Land Preservation statement for projects that have an impact on farmland.
- Capital Improvements Report. CIR Required by O.R.C. Chapter 164.06 on standard form.
- Supporting Documentation: Materials such as additional project description, photographs, economic impact (temporary and/or full time jobs likely to be created as a result of the project), accident reports, impact on school zones, and other information to assist your district committee in ranking your project. Be sure to include supplements which may be required by your local District Public Works Integrating Committee.

7.0 Applicant Certification

The undersigned certifies: (1) he/she is legally authorized to request and accept financial assistance from the Ohio Public Works Commission as identified in the attached legislation; (2) to the best of his/her knowledge and belief, all representations that are part of this application are true and correct; (3) all official documents and commitments of the applicant that are part of this application have been duly authorized by the governing body of the applicant; and, (4) should the requested financial assistance be provided, that in the execution of this project, the applicant will comply with all assurances required by Ohio Law, including those involving Buy Ohio and prevailing wages.

Applicant certifies that physical construction on the project as defined in the application has NOT begun, and will not begin until a Project Agreement for this project has been executed with the Ohio Public Works Commission. Action to the contrary will result in termination of the agreement and withdrawal of Ohio Public Works Commission funding from the project.

Richard Lenke, Salem Township Trustee

Certifying Representative (Printed form, Type or Print Name and Title)



Original Signature / Date Signed

The Board of Trustees of Salem Township, Allen Township, and Carroll Township, Ottawa County, Ohio, met in special session at the Ottawa County Engineer's Office, 8247 W State Route #163, Oak Harbor, Ohio on August 18, 2021 with the following in attendance:

Salem Township: Richard Lenke, Todd Winke, Aaron Avery
Allen Township: Scott Everhardt, Craig Blausey
Carroll Township: Jordan Moore, James Meek

Jordan Moore, Carroll Township made the motion, second by **Scott Everhardt, Allen Township** to adopt the following resolution:

Resolution Number: **SAC-2021-01**
Little-Portage East TR #112, Walbridge East TR #68, Curtice East & West TR #70 and
Bier TR #97 Roads Resurfacing Project
Issue I Round 36 Ohio Public Works Grant/Loan Application
Cooperation Agreement
Date **August 18, 2021**

Whereas, the State Capital Improvement Program and the Local Transportation Improvement Program both provide financial assistance to political subdivisions for capital improvements to public infrastructure, and

Whereas, Salem Township, Allen Township, and Carroll Township are planning to make capital improvements to various roads in their respective townships, and

Whereas, the infrastructure improvements are considered to be a priority need for the communities and are qualified under the OPWC program, and

Whereas Salem, Allen, and Carroll Townships will execute a cooperation agreement for a joint road resurfacing project under Ohio Public Works Commission Issue 1, Round 36, in the amount of \$517,390.

Be it resolved, Salem Township, Allen Township, and Carroll Township, all of Ottawa County, Ohio, agree to enter into a cooperation agreement to submit an application to the Ohio Public Works Commission for the Little-Portage East TR #112, Walbridge East TR #68, Curtice East & West TR #70 and Bier TR #97 Roads Resurfacing Project, and

Resolved, further agree to the following:

1. Salem, Allen, and Carroll Townships agree to provide a percentage of the total project costs based upon the Engineer's Estimates for their individual road projects. The preliminary ratio of cost sharing is:

Salem Township: \$118,870 or 23%
Allen Township: \$205,400 or 40%
Carroll Township: \$193,120 or 37%
2. All participants agree that the proportions listed above are preliminary and subject to change based upon the final construction costs of each road in the application.
3. Salem, Allen, and Carroll Townships will each be responsible for cost overages for only their roads.
4. Salem, Allen, and Carroll Townships agree to pay their portion of the costs as invoiced by the County Engineer.
5. Salem, Allen, and Carroll Townships authorize the following:

Section 1: Salem Township to serve as lead applicant
Section 2: Richard Lenke, Salem Township Trustee, is hereby authorized and directed to apply to the OPWC for funds for the above described project.

Section 3: Richard Lenke, Salem Township Trustee, is further authorized to enter into any agreements as may be necessary and appropriate for obtaining this financial assistance.

The resolution was duly adopted this 18th day of August, 2021.

Salem Township:

Ronald Buehler, Township Trustee

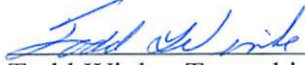

Todd Winke, Township Trustee



Richard Lenke, Township Trustee

Allen Township:

Ernest Cottrell, Jr, Township Trustee

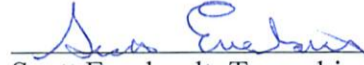

Scott Everhardt, Township Trustee



Craig Blausey, Township Trustee

Carroll Township:



Jordan Moore, Township Trustee

Sandra Shearon, Township Trustee



James Meek, Township Trustee

I, Aaron Avery, Fiscal Officer of Salem Township, Ottawa County, Ohio, hereby do certify that the above Joint Board entered into this agreement this 18th day of August 2021 in a special meeting as stated.



Aaron Avery

Salem Township Fiscal Officer

Salem Township

Ottawa County, Ohio

PO Box 417

Oak Harbor, OH 43449

BOARD OF TRUSTEES

Ronald Buehler

Richard Lenke

Todd Winke

Aaron Avery, Fiscal Officer

Matt Chasteen, Zoning Inspector

I, Aaron Avery, Fiscal Officer of Salem Township, hereby certify that Salem Township will collect the amount of \$50,000 in the Public Works Commission Project Fund and that this amount will be used to repay the Ohio Public Works Commission SCIP or RLP loan requested for the Little-Portage East TR #112, Walbridge East TR #68, Curtice East & West TR #70 and Bier TR #97 Roads Resurfacing Project over a term of ten years.

Salem Township will collect loan payments from Allen Township and Carroll Township, co-applicants for this application, thirty days prior to the Ohio Public Works due date. Salem Township will submit payments to the Ohio Public Works Commission on the behalf of all three townships



Aaron Avery
Salem Township Fiscal Officer

08-18-2021

Date

Salem Township

Ottawa County, Ohio

PO Box 417
Oak Harbor, OH 43449

BOARD OF TRUSTEES

Ronald Buehler
Richard Lenke
Todd Winke

Aaron Avery, Fiscal Officer
Matt Chasteen, Zoning Inspector

I, Aaron Avery, Fiscal Officer of Salem Township, hereby certify that Salem Township will have the amount of \$47,992 in the Road and Bridge Fund and that this amount will be used to pay the local share for the Little-Portage East TR #112, Walbridge East TR #68, Curtice East & West TR #70 and Bier TR #97 Roads Resurfacing Project when it is required.



Aaron Avery
Salem Township Fiscal Officer

08-18-2021

Date

Allen Township Trustees
Ottawa County
P.O. Box 440
Williston, Ohio 43468-0440
(419) 836-4204

Ernest Cottrell
22095 West Honeysuckle Lane
Curtice, Ohio 43412 (419) 340-7013

Craig Blausey
4907 North Martin-Williston Road
Martin, Ohio 43445 (419) 855-9056

Scott Everhardt
22459 Bittersweet Lane
Curtice, Ohio 43412 (419) 836-9614

Jennifer Witt, Fiscal Officer
3432 N. Nissen Road
Martin, Ohio 43445 (419) 277-2761

I, Jennifer Witt, Fiscal Officer of Allen Township, hereby certify that Allen Township will have the amount of \$82,928 in the gas tax and/or road and bridge funds, and that this amount will be used to pay the local share for the Little-Portage East TR #112, Walbridge East TR #68, Curtice East & West TR #70 and Bier TR #97 Roads Resurfacing Project when it is required.



Jennifer Witt
Allen Township Fiscal Officer

8/4/2021

Date

I, Tina Biggert, Fiscal Officer of Carroll Township, hereby certify that Carroll Township will have the amount of \$77,970 in the Road & Bridge and that this amount will be used to pay the local share for the Little-Portage East TR #112, Walbridge East TR #68, Curtice East & West TR #70 and Bier TR #97 Roads Resurfacing Project when it is required.

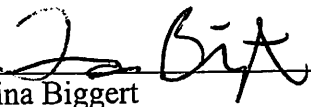
Tina Biggert
Carroll Township Fiscal Officer

Date

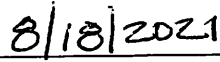

Allen Township Trustees
Ottawa County
P.O. Box 440
Williston, Ohio 43468-0440
(419) 836-4204

Ernest Cottrell
22095 West Honeysuckle Lane
Curtice, Ohio 43412 (419) 340-7013

Craig Blausey
4907 North Martin-Williston Road
Martin, Ohio 43445 (419) 855-9056

Scott Everhardt
22459 Bittersweet Lane
Curtice, Ohio 43412 (419) 836-9614

Jennifer Witt, Fiscal Officer
3432 N. Nissen Road
Martin, Ohio 43445 (419) 277-2761

I, Jennifer Witt, Fiscal Officer of Allen Township, hereby certify that Allen Township will collect the amount of \$19,849 in the gas tax and/or road and bridge funds, and that this amount will be used to repay the Ohio Public Works Commission SCIP or RLP loan requested for the Little-Portage East TR #112, Walbridge East TR #68, Curtice East & West TR #70 and Bier TR #97 Roads Resurfacing Project over a term of ten years.

Allen Township will submit loan payments to Salem Township, the lead applicant for this application, thirty days prior to the Ohio Public Works due date. Salem Township will submit payments to the Ohio Public Works Commission on our behalf.

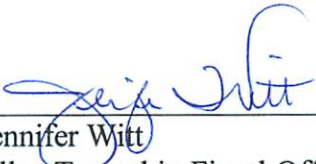

Jennifer Witt
Allen Township Fiscal Officer



Date

I, Tina Biggert, Fiscal Officer of Carroll Township, hereby certify that Carroll Township will collect the amount of \$18,663 in the Road & Bridge and that this amount will be used to repay the Ohio Public Works Commission SCIP or RLP loan requested for the Little-Portage East TR #112, Walbridge East TR #68, Curtice East & West TR #70 and Bier TR #97 Roads Resurfacing Project over a term of ten years.

Carroll Township will submit loan payments to Salem Township, the lead applicant for this application, thirty days prior to the Ohio Public Works due date. Salem Township will submit payments to the Ohio Public Works Commission on our behalf.



Tina Biggert
Carroll Township Fiscal Officer

Date 8/18/2029

Little Portage East TR #112, Walbridge East TR #68, Curtice East and West TR #70 and Bier TR #97 & Roads Resurfacing

Item	Qty	Units	Description	Unit Price	Total
Little Portage East Road TR #112 (Salem Twp)					
407	1349	GALS	TACK COAT	\$ 2.20	\$ 2,968.00
441	402	TON	0.75" ASPHALT CONCRETE INTERMEDIATE, TYPE 1	\$ 80.00	\$ 32,160.00
441	681	TON	1.25" ASPHALT CONCRETE SURFACE COURSE, TYPE 1, PG64	\$ 80.00	\$ 54,480.00
411	226	TON	BERM STONE	\$ 28.00	\$ 6,328.00
642	1.03	MILE	CENTERLINE, TYPE 1	\$ 1,600.00	\$ 1,648.00
614	LUMP	SUM	MAINTENANCE OF TRAFFIC	\$ 5,000.00	\$ 5,000.00
103.05	LUMP	SUM	CONTRACT BOND	\$ 1,539.00	\$ 1,539.00
Subtotal - Little Portage East Road					\$ 104,200.00
Percentage of Total Project Cost:					22.91%
Walbridge East Road TR #68 (Allen Twp)					
405	869	TONS	#67 STONE	\$ 52.00	\$ 45,188.00
405	64	TONS	CHOKE COAT, #9 STONE	\$ 60.00	\$ 3,840.00
405	10779	GALS	CM-150, BITUMINOUS MATERIAL	\$ 3.30	\$ 35,571.00
411	202	TONS	BERM STONE	\$ 28.00	\$ 5,656.00
407	560	GALS	TACK COAT	\$ 2.20	\$ 1,232.00
441	195	TONS	0.75" ASPHALT CONCRETE INTERMEDIATE (SCRATCH), TYPE 1	\$ 90.00	\$ 17,550.00
614	LUMP	SUM	MAINTENANCE OF TRAFFIC	\$ 3,000.00	\$ 3,000.00
103.05	LUMP	SUM	CONTRACT BOND	\$ 1,681.00	\$ 1,681.00
Subtotal - Walbridge East Road					\$ 113,800.00
Percentage of Total Project Cost:					25.02%
Curtice East and West Road TR #70 (Allen Twp)					
405	499	TONS	#67 STONE	\$ 52.00	\$ 25,948.00
405	37	TONS	CHOKE COAT, #9 STONE	\$ 60.00	\$ 2,220.00
405	6185	GALS	CM-150, BITUMINOUS MATERIAL	\$ 3.30	\$ 20,411.00
407	258	GALS	TACK COAT	\$ 2.20	\$ 568.00
441	90	TON	ASPHALT CONCRETE INTERMEDIATE (SCRATCH), TYPE 1	\$ 90.00	\$ 8,100.00
411	105	TONS	BERM STONE	\$ 28.00	\$ 2,940.00
614	LUMP	SUM	MAINTENANCE OF TRAFFIC	\$ 4,000.00	\$ 4,000.00
103.05	LUMP	SUM	CONTRACT BOND	\$ 963.00	\$ 963.00
Subtotal - Curtice East and West Road					\$ 65,200.00
Percentage of Total Project Cost:					14.33%

Little Portage East TR #112, Walbridge East TR #68, Curtice East and West TR #70 and Bier TR #97 & Roads Resurfacing

Bier Road TR #97 (Carroll Twp)					
253	54	CY	PAVEMENT REPAIR	\$ 200.00	\$ 10,800.00
407	2189	GALS	TACK COAT	\$ 2.20	\$ 4,816.00
441	652	TON	0.75" ASPHALT CONCRETE INTERMEDIATE, TYPE 1	\$ 78.00	\$ 50,856.00
441	1117	TON	1.25" ASPHALT CONCRETE SURFACE COURSE, TYPE 1, PG64-22	\$ 78.00	\$ 87,126.00
411	298	TON	BERM STONE	\$ 28.00	\$ 8,344.00
642	1.52	MILE	CENTERLINE, TYPE 1	\$ 1,400.00	\$ 2,128.00
614	LUMP	SUM	MAINTENANCE OF TRAFFIC	\$ 5,000.00	\$ 5,000.00
103.05	LUMP	SUM	CONTRACT BOND	\$ 2,537.00	\$ 2,537.00
Subtotal - Bier Road					\$ 171,700.00
Percentage of Total Project Cost:					37.74%
SUBTOTAL					\$ 454,900.00
ENGINEERING					\$ 15,000.00
PERMITS, LEGAL, ADVERTISING					\$ 2,000.00
CONTINGENCIES					10% \$ 45,490.00

Total \$ 517,390.00

This Estimate was Prepared by :



Ronald P. Lajti, Jr., P.E., P.S.
Ottawa County Engineer
Project Life will be 15 years



Little Portage East TR #112, Walbridge East TR #68, Curtice East and West TR #70 and Bier Road TR #97 Roads Resurfacing

Traffic Counts - Actual and Estimated
Ottawa County - Issue I 2021

Road Name	Road Number	Begin	End	Year	ADT actual	ADT 2041 est.
Little Portage East	TR #112	Muddy Creek North	Salem/Bay Twp line	2021	75	92
Walbridge East	TR #68	Martin-Williston	Opfer-Lentz	2021	178	217
Curtice East & West	TR #70	Wildacre	Genoa-Clay Center	2021	542	661
Bier	TR #97	Behlman	Atwater	2021	241	294
Total					1036	1264

Estimates are based on actual 2021 traffic counts.

Traffic Counts were obtained by the Ottawa County Engineer's Office using mechanical counters.
(see attached reports)



Ronald P. Lajti, Jr., P.E., P.S.
Ottawa County Engineer

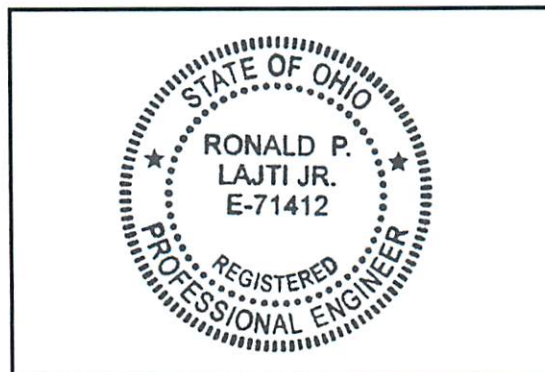

MetroCount Traffic Executive Vehicle Counts (Virtual Day)

Datasets:

Site: [SAL-TR112-0.50] SAL-TR112-0.50
Attribute: LITTLE PORTAGE EAST ROAD
Direction: 2 - East bound, A hit first. Lane: 0
Survey Duration: 14:52 Tuesday, June 22, 2021 => 9:07 Tuesday, June 29, 2021
Zone:
File: SAL-TR112-0.50 0 2021-06-29 0908.EC0 (Plus)
Identifier: DH68A3TH MC56-L5 [MC55] (c)Microcom 19Oct04
Algorithm: Factory default (v3.21 - 15275)
Data type: Axle sensors - Paired (Class/Speed/Count)

Profile:

Filter time: 0:00 Wednesday, June 23, 2021 => 0:00 Tuesday, June 29, 2021
Included classes: 1, 2, 3, 4, 5, 6, 7, 8, 9, 10, 11, 12, 13
Speed range: 5 - 100 mph.
Direction: North, East, South, West (bound)
Separation: All - (Gap)
Name: OCE Traffic Count
Scheme: Vehicle classification (Scheme F)
Units: Non metric (ft, mi, ft/s, mph, lb, ton)
In profile: Vehicles = 449 / 519 (86.51%)

* Virtual Day - Total=75, 15 minute drops

0000	0100	0200	0300	0400	0500	0600	0700	0800	0900	1000	1100	1200	1300	1400	1500	1600	1700	1800	1900	2000	2100	2200	2300
0	0	0	0	1	1	3	3	5	5	6	5	4	7	7	6	7	4	2	2	3	1	1	1
0	0	0	0	0	0	0	1	2	1	2	1	1	1	2	2	2	2	1	1	1	1	1	0
0	0	0	0	0	0	0	1	1	1	2	1	1	2	1	3	2	1	0	1	1	0	0	0
0	0	0	0	1	1	1	1	0	1	2	1	1	2	2	1	2	0	0	0	1	0	1	0
0	0	0	0	0	0	2	1	2	2	1	2	1	2	2	1	1	1	0	0	1	0	0	0

AM Peak 0945 - 1045 (7), AM PHF=0.83 PM Peak 1430 - 1530 (8), PM PHF=0.82

Numbers have been rounded to the nearest integer.

MetroCount Traffic Executive Vehicle Counts (Virtual Day)

Datasets:

Site: [ALL-TR68-1.25] ALL-TR68-1.25
Attribute: WALBRIDGE EAST ROAD
Direction: 2 - East bound, A hit first. Lane: 0
Survey Duration: 13:38 Tuesday, June 15, 2021 => 12:37 Monday, June 21, 2021
Zone:
File: ALL-TR68-1.25 0 2021-06-21 1237.EC0 (Plus)
Identifier: DH68A3TH MC56-L5 [MC55] (c)Microcom 19Oct04
Algorithm: Factory default (v3.21 - 15275)
Data type: Axle sensors - Paired (Class/Speed/Count)

Profile:

Filter time: 0:00 Wednesday, June 16, 2021 => 0:00 Monday, June 21, 2021
Included classes: 1, 2, 3, 4, 5, 6, 7, 8, 9, 10, 11, 12, 13
Speed range: 5 - 100 mph.
Direction: North, East, South, West (bound)
Separation: All - (Gap)
Name: OCE Traffic Count
Scheme: Vehicle classification (Scheme F)
Units: Non metric (ft, mi, ft/s, mph, lb, ton)
In profile: Vehicles = 889 / 1083 (82.09%)

* **Virtual Day - Total=178, 15 minute drops**

0000	0100	0200	0300	0400	0500	0600	0700	0800	0900	1000	1100	1200	1300	1400	1500	1600	1700	1800	1900	2000	2100	2200	2300
2	1	1	0	1	2	3	9	7	8	10	10	13	12	15	16	13	12	12	13	9	5	3	1
0	0	0	0	0	0	0	3	1	2	3	2	5	3	5	3	3	4	3	4	2	2	1	0
0	0	0	0	0	0	1	2	2	2	5	3	3	3	4	4	3	3	3	3	3	2	1	1
1	0	0	0	0	1	1	2	2	2	1	2	3	3	3	5	3	3	2	3	3	1	1	0
1	0	0	0	1	0	1	2	2	2	1	2	2	3	4	3	5	3	3	4	1	0	1	0

AM Peak 1145 - 1245 (13), AM PHF=0.72 PM Peak 1445 - 1545 (16), PM PHF=0.86

Numbers have been rounded to the nearest integer.

MetroCount Traffic Executive Vehicle Counts (Virtual Day)

Datasets:

Site: [C-E&W-TR-2.55] C-E&W-TR-2.55
Attribute: CURTICE E&W ROAD
Direction: 8 - East bound A>B, West bound B>A. **Lane:** 0
Survey Duration: 14:35 Tuesday, June 15, 2021 => 11:43 Monday, June 21, 2021
Zone:
File: C-E_W-TR-2.55 0 2021-06-21 1144.EC0 (Plus)
Identifier: DH81S60X MC56-L5 [MC55] (c)Microcom 19Oct04
Algorithm: Factory default (v3.21 - 15275)
Data type: Axle sensors - Paired (Class/Speed/Count)

Profile:

Filter time: 0:00 Wednesday, June 16, 2021 => 0:00 Monday, June 21, 2021
Included classes: 1, 2, 3, 4, 5, 6, 7, 8, 9, 10, 11, 12, 13
Speed range: 5 - 100 mph.
Direction: North, East, South, West (bound)
Separation: All - (Gap)
Name: OCE Traffic Count
Scheme: Vehicle classification (Scheme F)
Units: Non metric (ft, mi, ft/s, mph, lb, ton)
In profile: Vehicles = 2709 / 3035 (89.26%)

Virtual Day - Total=542, 15 minute drops																							
0000	0100	0200	0300	0400	0500	0600	0700	0800	0900	1000	1100	1200	1300	1400	1500	1600	1700	1800	1900	2000	2100	2200	2300
3	2	1	1	3	8	13	17	18	25	28	35	44	42	42	48	44	44	34	31	24	18	12	5
1	1	0	0	1	1	2	3	4	6	6	8	11	12	13	10	8	10	8	8	6	5	4	1
1	1	0	0	0	2	4	6	4	5	8	9	10	11	12	13	13	14	9	8	5	5	3	2
1	0	0	1	0	2	4	5	6	7	6	11	11	9	10	13	13	11	9	9	6	3	4	1
0	0	0	0	1	4	2	3	5	7	8	7	11	9	8	12	10	8	8	6	7	4	1	1

AM Peak 1145 - 1245 (40), AM PHF=0.87 PM Peak 1500 - 1600 (48), PM PHF=0.92

Numbers have been rounded to the nearest integer.

MetroCount Traffic Executive Vehicle Counts (Virtual Day)

Datasets:

Site: [CAR-TR98-3.80] CAR-TR98-3.80
Attribute: BIER ROAD
Direction: 8 - East bound A>B, West bound B>A. **Lane:** 0
Survey Duration: 15:39 Tuesday, June 22, 2021 => 9:32 Tuesday, June 29, 2021
Zone:
File: CAR-TR98-3.80 0 2021-06-29 0932.EC0 (Plus)
Identifier: DH81S60X MC56-L5 [MC55] (c)Microcom 19Oct04
Algorithm: Factory default (v3.21 - 15275)
Data type: Axle sensors - Paired (Class/Speed/Count)

Profile:

Filter time: 0:00 Wednesday, June 23, 2021 => 0:00 Tuesday, June 29, 2021
Included classes: 1, 2, 3, 4, 5, 6, 7, 8, 9, 10, 11, 12, 13
Speed range: 5 - 100 mph.
Direction: North, East, South, West (bound)
Separation: All - (Gap)
Name: OCE Traffic Count
Scheme: Vehicle classification (Scheme F)
Units: Non metric (ft, mi, ft/s, mph, lb, ton)
In profile: Vehicles = 1446 / 1643 (88.01%)

Virtual Day - Total=241, 15 minute drops		0000	0100	0200	0300	0400	0500	0600	0700	0800	0900	1000	1100	1200	1300	1400	1500	1600	1700	1800	1900	2000	2100	2200	2300
2	1	1	1	2	2	8	11	11	12	12	16	14	13	17	19	24	18	12	13	14	9	6	3		
1	0	0	1	1	0	2	3	3	3	3	4	4	3	3	4	5	4	3	3	5	3	1	1		
1	1	0	0	1	0	1	2	3	3	3	3	4	3	4	6	6	5	3	3	3	1	1	1		
1	0	0	1	0	1	1	2	2	2	3	6	3	3	4	5	7	4	4	3	5	3	2	0		
0	0	0	0	1	1	4	4	3	3	3	4	3	3	5	4	6	5	3	5	2	1	2	1		

AM Peak 1130 - 1230 (17), AM PHF=0.76 PM Peak 1600 - 1700 (24), PM PHF=0.84

Numbers have been rounded to the nearest integer.

SPECIAL FEATURES

OTTAWA COUNTY

COUNTY ENGINEERING DEPARTMENT

COUNTY AND TOWNSHIP ROAD SYSTEM CONSTRUCTION PROJECT AND LOG RECORD

ROAD NO. T-112
 ROAD NAME Little Portage East
 SECTION 0.00-3.69
 NET LENGTH 3.69/1.02/ODOT=1.03(Salem)
2.64/ODOT=2.57(Bay)
 R/W WIDTH 60'
 DATE ESTAB. _____

CARD OF _____

SCALE 1" = 1 MILE

LOCATION Begin at T-217 in Salem Twp.
thence east ending at S.R.#53

1.02 mi. to Twp. line

ODOT mileage as of April 2008

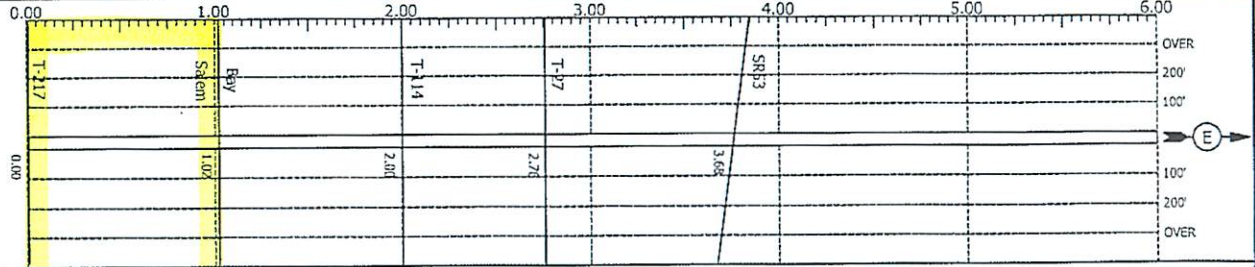

YEAR BUILT	DESCRIPTION OF WORK	COST	WIDTH TYPE LENGTH
1982	single seal 0.50gal RS-2 25lbs #8's	\$5,765.38	17' 1.02
1982	single seal 0.50gal RS-2 25lbs #8's	\$6,312.05	14' 1.02
1996	seal 0.50gal HFRS-2 30lbs #8's	\$8,575.39	16' 1.02
1997	drag coat #67 @150lb/S.Y. CM200 @1.10gal/S.Y. choke #9'S @12LBS/s.y.	\$40,108.98	17' 1.60
1998	drag coat #67 @150lb/S.Y. CM150 @1.0gal/S.Y. choke #9'S @12LBS/s.y.	\$16,971.40	17' 1.0
2005	Mill 2" item 404 w/18" berm	\$43,097.45	17' 1.60
2007	Slurry Seal-Type II-(18lbs)	\$25,920.97	19' 1.64
2018	Chip & seal 0.42 gal. HFR-S 22lbs 8's, Fog seal 0.15 gal./sy.	\$34,307.22	

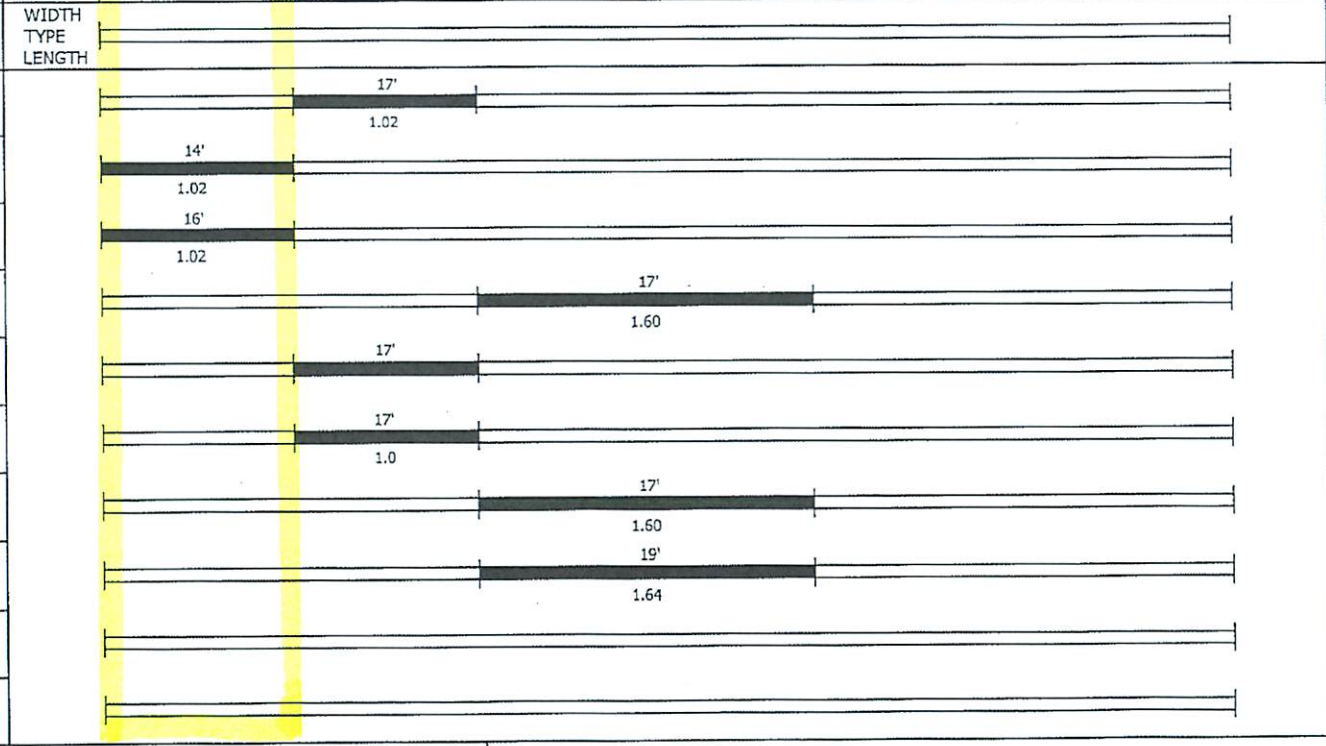

SYMBOLS FOR ROAD TYPES

PRIMITIVE
 UNIMPROVED
 GRADED AND DRAINED
 SOIL-SURFACED



GRAVEL OR STONE
 BIT. SURFACE-TREATED
 MIXED BITUMINOUS
 BITUMINOUS PENETRATION



BIT. CONC. OR SHEET ASPHALT
 CONCRETE
 BRICK
 BLOCK



REMARKS

SPECIAL FEATURES _____

OTTAWA COUNTY

COUNTY ENGINEERING DEPARTMENT

ROAD NO. T-112
 ROAD NAME Little Portage East
 SECTION 0-3.68
 NET LENGTH 3.68 St 1.02 Ra 2.64
 R/W WIDTH 60'
 DATE ESTAB. _____

COUNTY AND TOWNSHIP ROAD SYSTEM CONSTRUCTION PROJECT AND LOG RECORD

CARD 1 OF 1

SCALE 1" = 1 MILE

LOCATION Begin at T-217 in Salem Twp.
thence east ending at S.R.#53

1.02 mi. to Twp. line

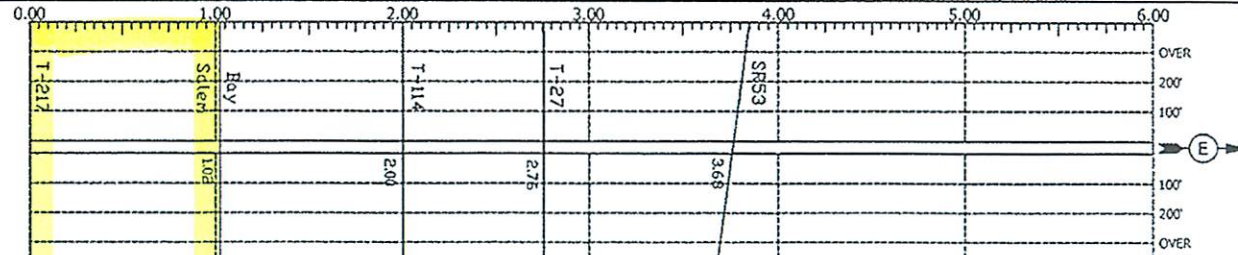

YEAR BUILT	DESCRIPTION OF WORK	COST	WIDTH TYPE	LENGTH
			13'	15'
			17'	16'
			14'	14'
			E2	3.68
1947	See over			16'
1956	drag CBAE RS-2	\$9,812.22		2.68 16'
1960	drag 0.85 MC-4 #46 95lbs #9 10lbs	\$3,487		14'
1961	seal 0.4 RS-2 30lbs #6	\$1,304		16' 1.0
1966	1 1/2' drag CBAE-3 @1.10 #67 @135lbs	\$9,426.36		16' 1.64
1967	0.85gal MC-800 100lbs #67	\$4,198.78		15' 1.02
1968	1.10gal CBAE 135lbs #67	\$6,342.40		17' 0.96
1969	30lb single seal MC-3000	\$2,419.81		16' 1.68
1971	single seal MC-3000 @0.50 #9 @30lbs	\$2,035.62		17' 0.96
1977	100lb drag CMS @1.10gal	\$11,513.73		14' 1.02
1981	seal	\$12,168.80		17' 1.64

SYMBOLS FOR ROAD TYPES

PRIMITIVE		GRAVEL OR STONE		BET. CONC. OR SHEET ASPHALT	
UNIMPROVED		BIT. SURFACE-TREATED		CONCRETE	
GRADED AND DRAINED		MIXED BITUMINOUS		BRICK	
SOIL-SURFACED		BITUMINOUS PENETRATION		BLOCK	

REMARKS _____

SPECIAL FEATURES

OTTAWA COUNTY

COUNTY ENGINEERING DEPARTMENT

COUNTY AND TOWNSHIP ROAD SYSTEM CONSTRUCTION PROJECT AND LOG RECORD

ROAD NO. T-68
ROAD NAME Walbridge East
SECTION 0.0-7.17
NET LENGTH 7.17/ ODOT Benton=4.03
ODOT Allen=3.06
R/W WIDTH _____
DATE ESTAB. _____

CARD ___ OF ___

LOCATION _____

ODOT mileage as of April 2008 _____

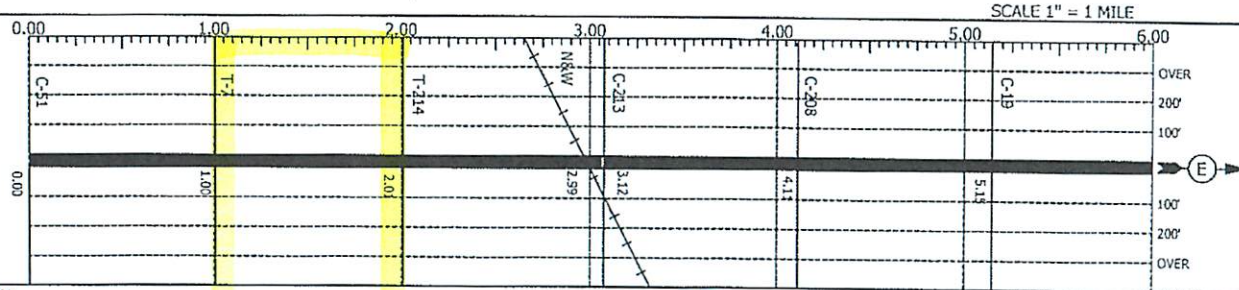

YEAR BUILT	DESCRIPTION OF WORK	COST	WIDTH TYPE LENGTH
1994	Seal by Twp.	Est. \$8,699.40	
1995	Seal by Twp.		
2001	Seal by Twp.		
2010	150lb drag w/#67 stone 0.93gal CM-150, w/choke coat 12lbs. #9	\$61,751.58	18.5' 0.99
2011	150lb drag w/#67 stone 0.93gal CM-150, w/choke coat 12lbs. #9	\$108,573.97	17.5' 1.00MI.
2015	150lb drag w/#67 stone 0.93gal CM-150, w/choke coat 12lbs. #9	\$177,527.60	18' 2.00

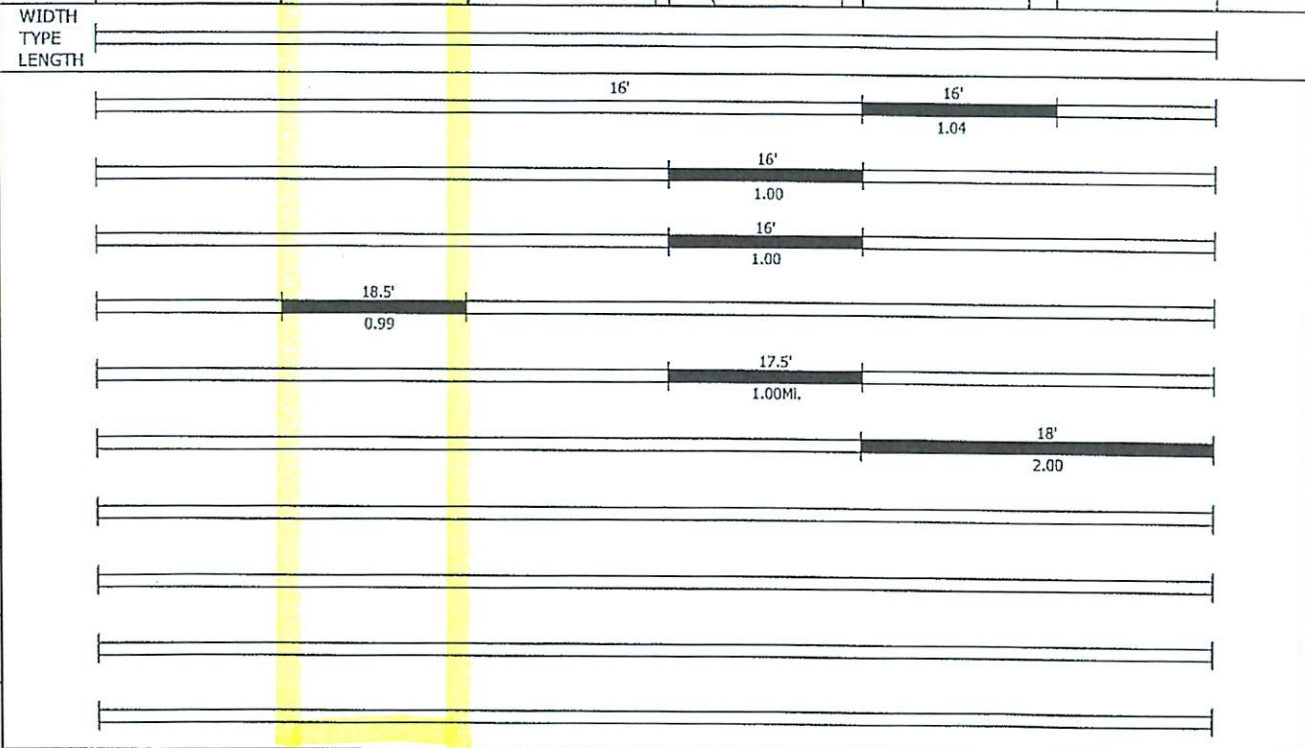

SYMBOLS FOR ROAD TYPES

PRIMITIVE UNIMPROVED		GRAVEL OR STONE		BIT. CONC. OR SHEET ASPHALT	
GRADED AND DRAINED		BIT. SURFACE-TREATED		CONCRETE	
SOIL-SURFACED		MIXED BITUMINOUS		BRICK	
		BITUMINOUS PENETRATION		BLOCK	

REMARKS _____

SPECIAL FEATURES _____

OTTAWA COUNTY

COUNTY ENGINEERING DEPARTMENT

COUNTY AND TOWNSHIP ROAD SYSTEM CONSTRUCTION PROJECT AND LOG RECORD

ROAD NO. T-68
 ROAD NAME Walbridge East
 SECTION 0.0-7.17
 NET LENGTH 7.17 Ben 4.03
 R/W WIDTH _____
 DATE ESTAB. _____

CARD 1 OF 2

LOCATION Begin at C-51 in Allen Twp.
thence east ending at S.R. 590

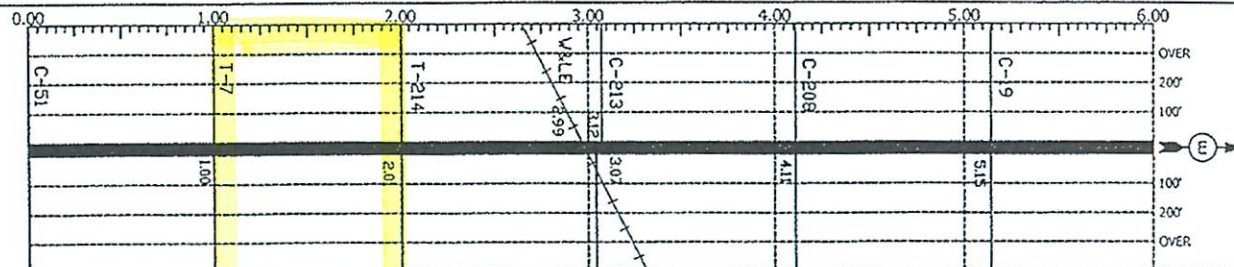

YEAR BUILT	DESCRIPTION OF WORK	COST
1948	Surface: 1' See back of card 2	\$4,410.45
1958	Surface: 1½' Base: 6"	
1959	Seal	
1959	(stoned)	
1960	Surface: 1½'	\$5,658.30
1969	Single seal by Twp. forces	
1970	Single seal by Twp.	
1970	100lb drag CBAE-3 #67 stone by Benton Twp. forces	
1971	single seal by Twp forces	
1984	Drag by Twp.	
1985	Drag by Twp.	

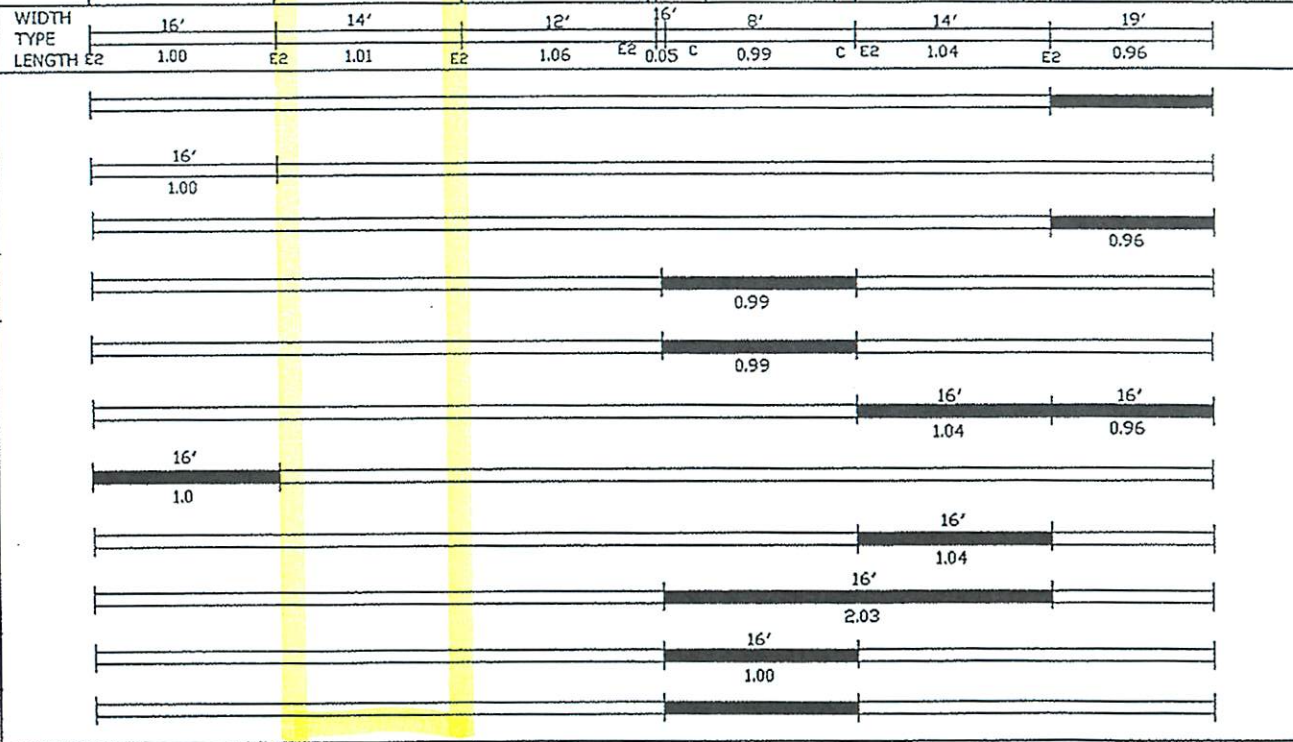

SYMBOLS FOR ROAD TYPES

PRIMITIVE UNIMPROVED		GRAVEL OR STONE		BIT. CONC. OR SHEET ASPHALT	
GRADED AND DRAINED		BIT. SURFACE-TREATED		CONCRETE	
SOIL-SURFACED		MIXED BITUMINOUS		BRICK	
		BITUMINOUS PENETRATION		BLOCK	

REMARKS _____

SPECIAL FEATURES

OTTAWA COUNTY

COUNTY ENGINEERING DEPARTMENT

COUNTY AND TOWNSHIP ROAD SYSTEM
CONSTRUCTION PROJECT AND LOG RECORD

ROAD NO. T-70
 ROAD NAME Curtice East & West
 SECTION 0.0-6.12
 NET LENGTH 6.02/ ODOT=6.0
 R/W WIDTH _____
 DATE ESTAB. _____

CARD 1 OF 2

LOCATION Begin at C-2 in Allen Twp.
thence east ending in C-213

ODOT mileage as of April 2008

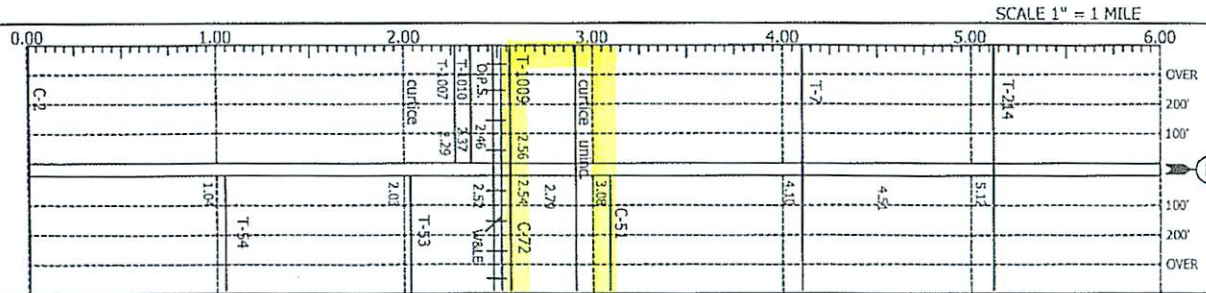

YEAR BUILT	DESCRIPTION OF WORK	COST
2007	150lb #67, 12lb #9, w/.93gal. CM-150	\$55,404.65
2008	150lb #67, 12lb #9, w/.93gal. CM-150	West mi.=482,299.56 East Mi.=79,577.81 Total=\$161,877.37
2019	150lb drag w/#67 stone 0.93gal CM-150, w/choke coat 12lbs. #9	\$71,277.80

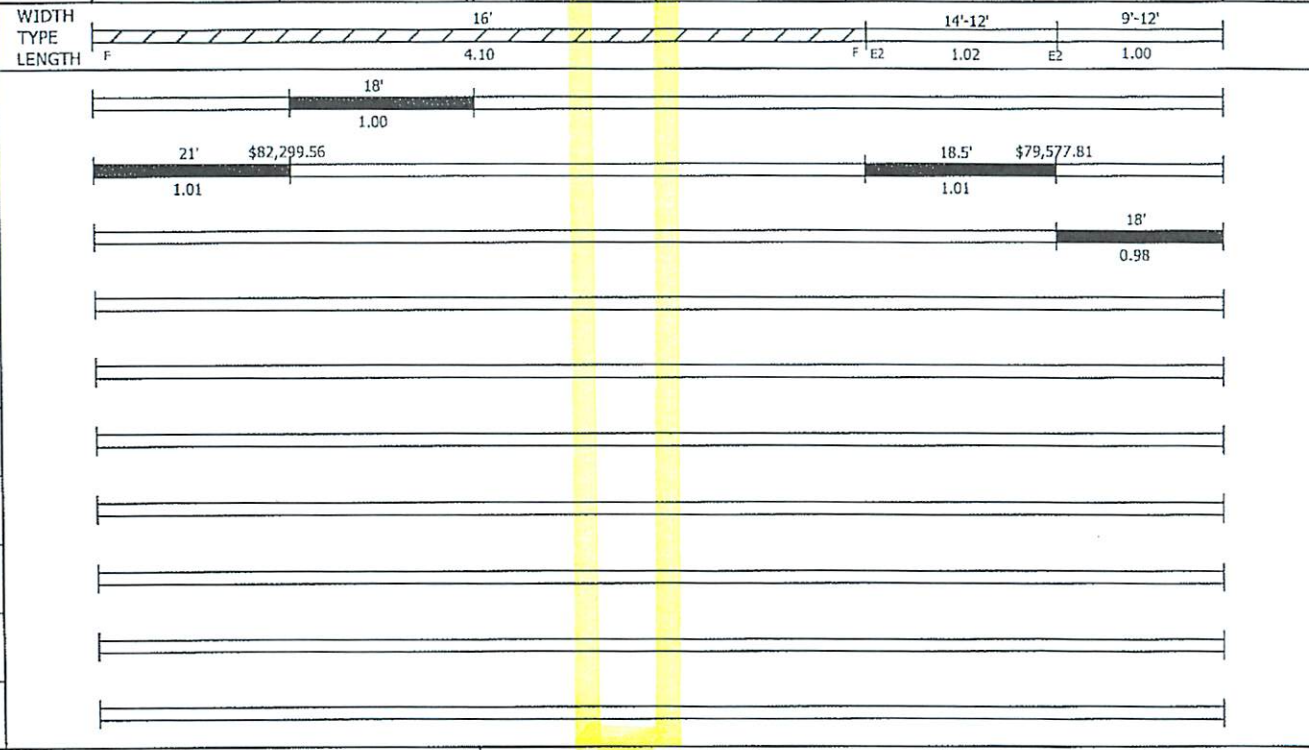

SYMBOLS FOR ROAD TYPES				REMARKS
PRIMITIVE UNIMPROVED GRADED AND DRAINED SOIL-SURFACED	 	 	 	

SPECIAL FEATURES

OTTAWA COUNTY

COUNTY ENGINEERING DEPARTMENT

COUNTY AND TOWNSHIP ROAD SYSTEM
CONSTRUCTION PROJECT AND LOG RECORD

ROAD NO. T-70
 ROAD NAME Curtice East & West
 SECTION 0.0-6.12
 NET LENGTH 6.02
 R/W WIDTH _____
 DATE ESTAB. _____

CARD 1 OF 2

LOCATION Begin at C-2 in Allen Twp.
thence east ending in C-213

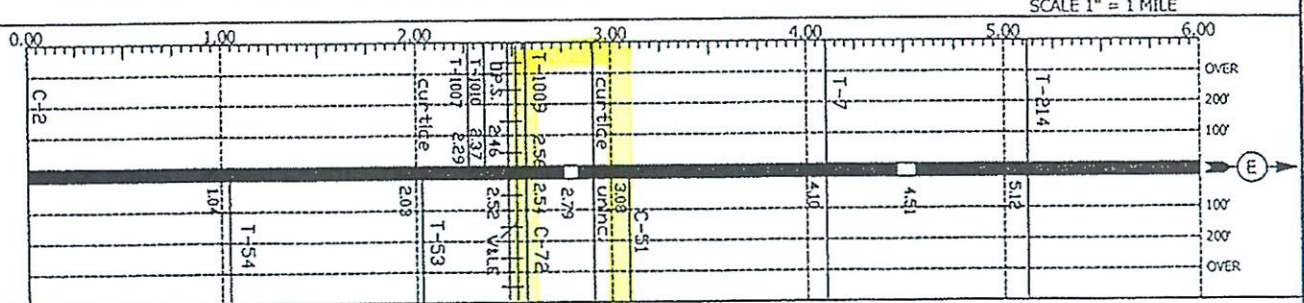

YEAR BUILT	DESCRIPTION OF WORK	COST	WIDTH TYPE LENGTH
			16' F 4.10 14'-12' F E2 1.02 9'-12' E2 1.00
1953		\$1,722.50	15' 2.07
1960	Seal		17' 1.02
1965	New Construction 1.0gal MC-5 130lbs #46	\$6,817.68	18' 1.00
1967	1.10gal CBAE 135lb #46 1½'	\$1,787.59	Bridge 18' 0.30
1968	1.10gal MC-800 135lbs #67 (4 sections)	\$17,257.92	18' 1.01 18' 0.48 18' 0.22 18' 1.01
1970	single seal by Twp.		18' 4.0
1975	100lb drag w/8's CBAE 1.10gal	\$6,379.13	18' 0.56
1994	150lb drag CM150 LTIP grant	\$29,871.87 + berns	18' 1.01
1996	seal 0.50gal HFRS-2 30lbs 8's	A=\$10,077.65 B=\$9,716.38	A=19' 1.00 B=18' 1.01
1998	200lb drag CM-150 1' berm each slide-town to creek 2' berm each slide-creek to T-51	\$18,860.20	18' 0.56

SYMBOLS FOR ROAD TYPES

PRIMITIVE		GRAVEL OR STONE		BIT. CONC. OR SHEET ASPHALT	
UNIMPROVED		BIT. SURFACE-TREATED		CONCRETE	
GRADED AND DRAINED		MIXED BITUMINOUS		BRICK	
SOIL-SURFACED		BITUMINOUS PENETRATION		BLOCK	

REMARKS

SPECIAL FEATURES

OTTAWA COUNTY

COUNTY ENGINEERING DEPARTMENT

COUNTY AND TOWNSHIP ROAD SYSTEM CONSTRUCTION PROJECT AND LOG RECORD

ROAD NO. T-97
 ROAD NAME Bier
 SECTION 0.00-6.00
 NET LENGTH 5.98/ODOT=6.00
 R/W WIDTH 60'
 DATE ESTAB. _____

CARD ___ OF ___

LOCATION Begin at C-23 in Carrol Twp.
thence east ending at T-26

ODOT mileage as of April 2008

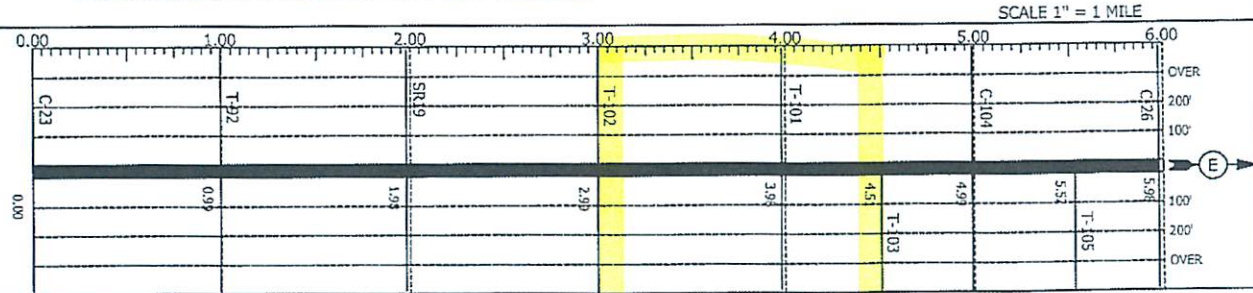

YEAR BUILT	DESCRIPTION OF WORK	COST	WIDTH TYPE LENGTH
1992	single seal w/30lbs #8 0.50gal MWS-90	\$8,828.25	18' 0.99
1995	2 3/4" hot mix AC-20	\$38,685.58	17' 1.00
1996	2 3/4" hot mix AC-20 24" berms	\$179,680.17	17' 5.00
2017	Asphalt Concrete Surface Coarse Type 1 (1.25") PG 64-22 (448) (1.5" Drives), Asphalt Concrete Intermediate Coarse Type 1 (1") PG 64-22	\$133,134.42	17' 0.98
2018	Chip & seal 0.42 gal. HFR-S 22lbs 8's, Fog seal 0.15 gal./sy.	\$36,321.49	17.5' 2.01
2018	Asphalt Concrete Surface Coarse Type 1 (1.5") PG 64-22 (448) (w/ Drives), (0.75") Intermediate Coarse Type 1 (scratch) 448	\$117,800.90	17.5' 0.98

SYMBOLS FOR ROAD TYPES

- | | | | | | |
|--------------------|--|------------------------|--|-----------------------------|--|
| PRIMITIVE | | GRAVEL OR STONE | | BIT. CONC. OR SHEET ASPHALT | |
| UNIMPROVED | | BIT. SURFACE-TREATED | | CONCRETE | |
| GRADED AND DRAINED | | MIXED BITUMINOUS | | BRICK | |
| SOIL-SURFACED | | BITUMINOUS PENETRATION | | BLOCK | |

REMARKS

SPECIAL FEATURES

OTTAWA COUNTY
 COUNTY ENGINEERING DEPARTMENT
 COUNTY AND TOWNSHIP ROAD SYSTEM
 CONSTRUCTION PROJECT AND LOG RECORD

ROAD NO. T-97
 ROAD NAME Bier
 SECTION 0.00-6.02
 NET LENGTH 5.98
 R/W WIDTH 60'
 DATE ESTAB _____

LOCATION Begin at C-23 in Carrol Twp.
 thence east ending at T-26

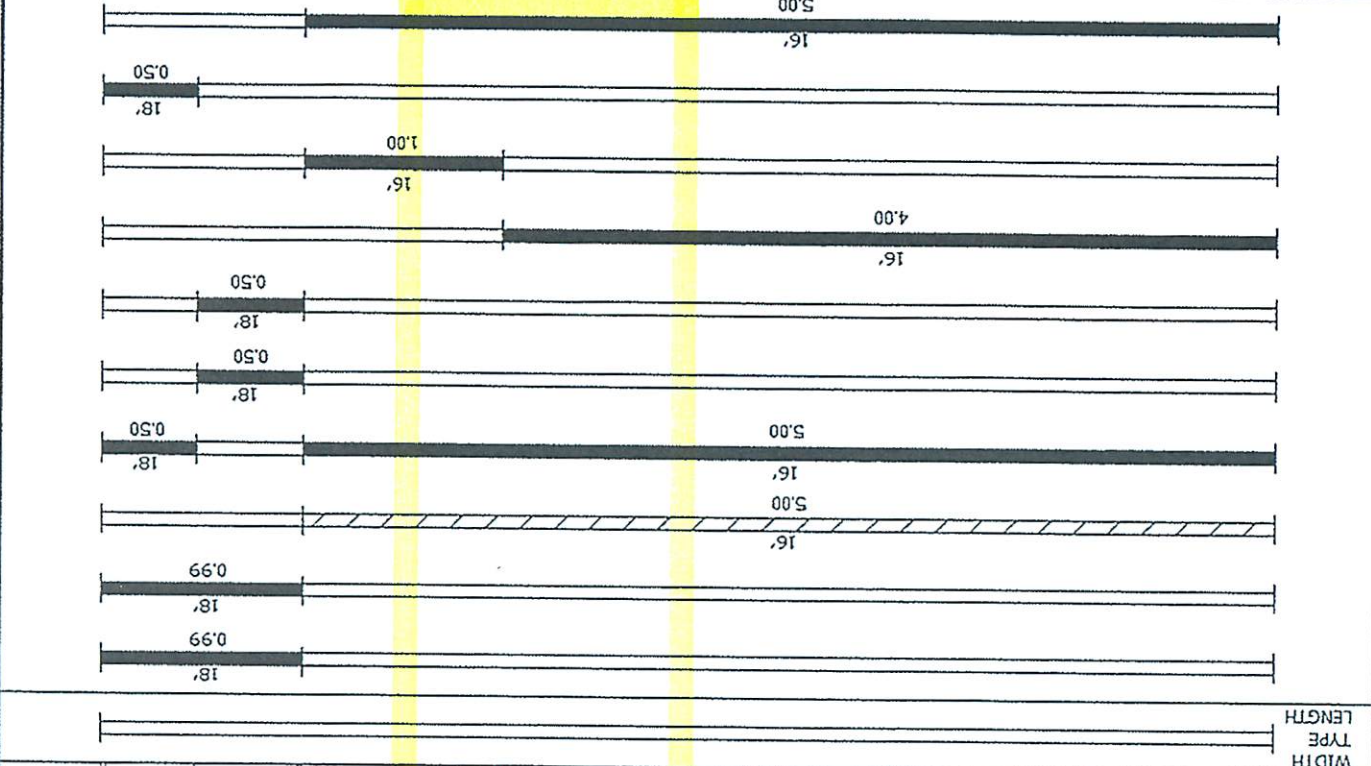
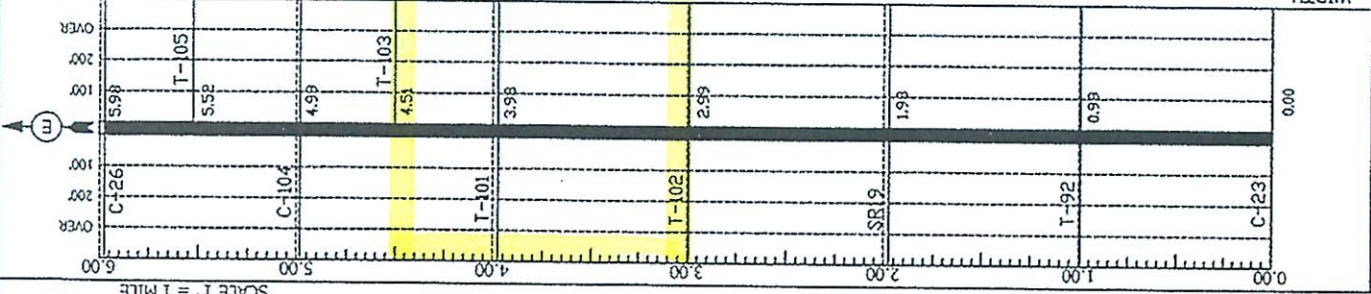

YEAR BUILT	DESCRIPTION OF WORK	COST
1973	New Constr. 135lbs drag MC-90 Prime MC-800 Mix	\$12,242.30
1976	Single seal 0.50gal GBAE & MWS 30lbs #8's	
1978	Seal by Twp forces	
1983	seal 5.0ml 0.50gal RS-2 25lbs #8's	\$30,212.05
1983	seal 0.50ml 0.50gal RS-2 25lbs 8's	\$3,593.67
1983	100lb drag 1.20gal CMS-2 w/8's	\$12,155.90
1985	single seal 0.50gal RS-2 25lbs #8's	\$3,342.80
1987	135lb drag w/67's 1.35gal CMS-2	\$96,939.07
1988	135lb drag w/67's 1.35gal CMS-2	\$25,373.16
1989	135lb drag 1.35gal CMS-2 12lbs #9 stone	\$14,613.20
1991	single seal w/30lbs 8's 0.50gal MWS-90	\$39,311.31

SYMBOLS FOR ROAD TYPES

- PRIMITIVE
- UNIMPROVED
- GRADED AND DRAINED
- SOIL-SURFACED
- GRAVEL OR STONE
- BRT. SURFACE-TREATED
- MIXED BITUMINOUS
- BITUMINOUS PENETRATION
- BIT. CONC. OR SHEET ASPHALT
- CONCRETE
- BRICK
- BLOCK

REMARKS

SPECIAL FEATURES

OTTAWA COUNTY

COUNTY ENGINEERING DEPARTMENT

COUNTY AND TOWNSHIP ROAD SYSTEM
CONSTRUCTION PROJECT AND LOG RECORD

ROAD NO. T-97
 ROAD NAME Bier
 SECTION 0-6.02
 NET LENGTH 6.02-5.98
 R/W WIDTH 60'
 DATE ESTAB. _____

CARD 1 OF 2

LOCATION Begin at C-23 in Carrol Twp.
thence east ending at T-26

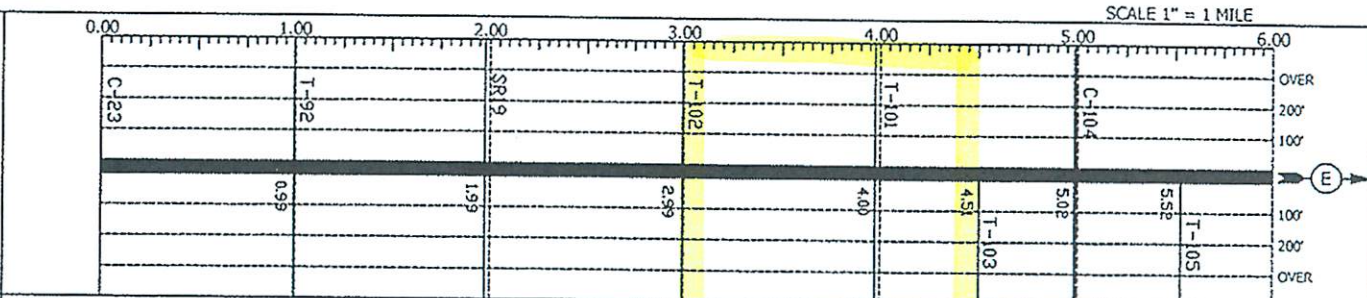

YEAR BUILT	DESCRIPTION OF WORK	COST
1946	Surface: 1' L.M.C.4 Sur. Tr.	\$1,691.62
1947		
1950	Seal	\$3,713
1963	Drag 135lbs MC-4	\$5,714
1964	Surface: 1½' 135lbs MC-5	\$4,995
1964	Surface: 1½' 135lbs MC-5 Prime MCI 0.50	\$5,782
1965	New 1½' drag MC-5 @1.10 #46 @135lbs	\$5,052.49
1966	1½' drag MC-800 @1.10 #67 @135lbs	\$5,261.01
1967	0.40gal MC-3000 30lbs #8 Seal	\$1,382.32
1970	single seal 0.40gal MC-3000 30lbs #8	A=\$1,411.91 B=\$4,677.02

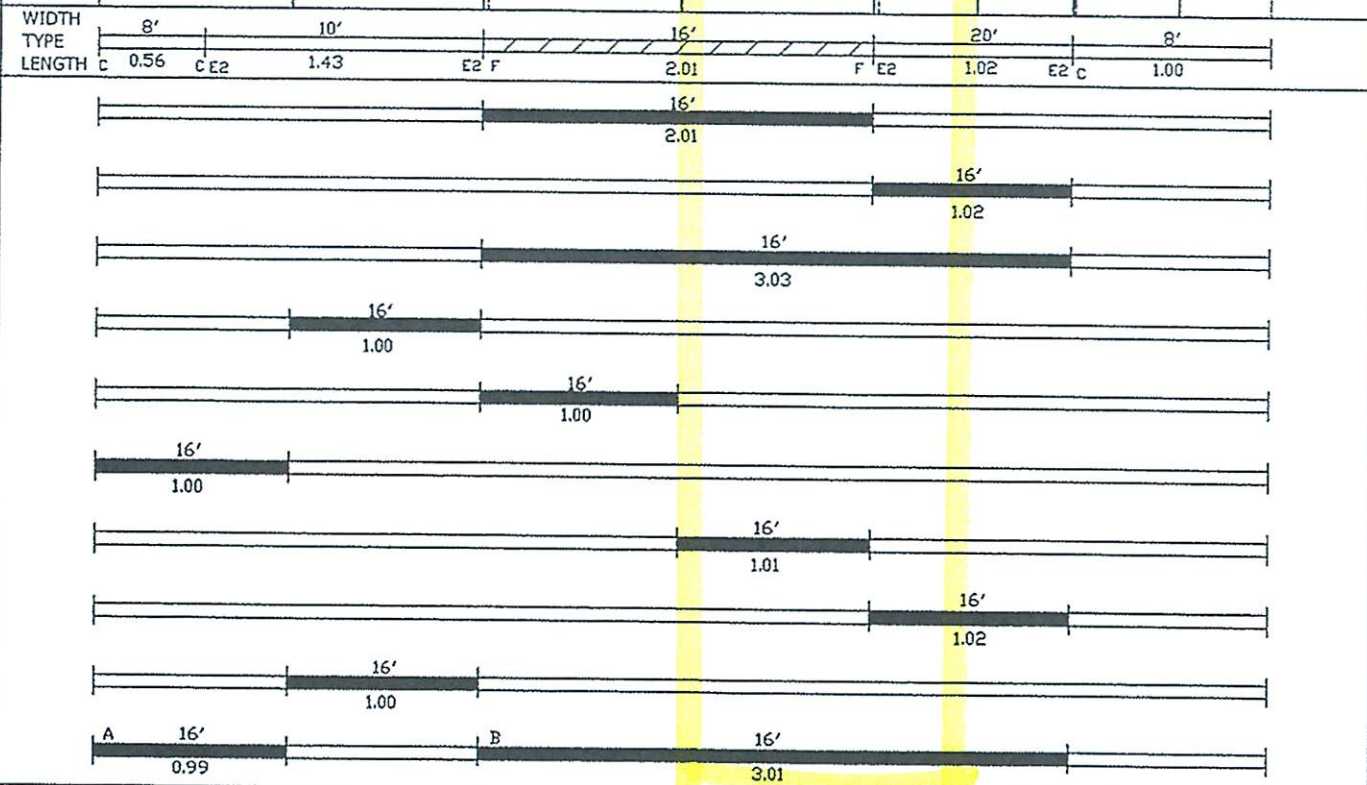

SYMBOLS FOR ROAD TYPES			
PRIMITIVE		GRAVEL OR STONE	
UNIMPROVED		BIT. SURFACE-TREATED	
GRADED AND DRAINED		MIXED BITUMINOUS	
SOIL-SURFACED		BITUMINOUS PENETRATION	
		BIT. CONC. OR SHEET ASPHALT	
		CONCRETE	
		BRICK	
		BLOCK	

REMARKS

Average PCR (By \$)

Little Portage East (22.91%)

$$69.35 \times 22.91\% = 15.89$$

Bier Road (37.74%)

$$65.85 \times 37.74\% = 24.85$$

Curtice E & W (14.33%) 64.66
Avg. PCR

$$63.20 \times 14.33\% = 9.06$$

Walbridge East (25.02%)

$$59.40 \times 25.02\% = 14.86$$

+ _____
64.66

PCR

Condition

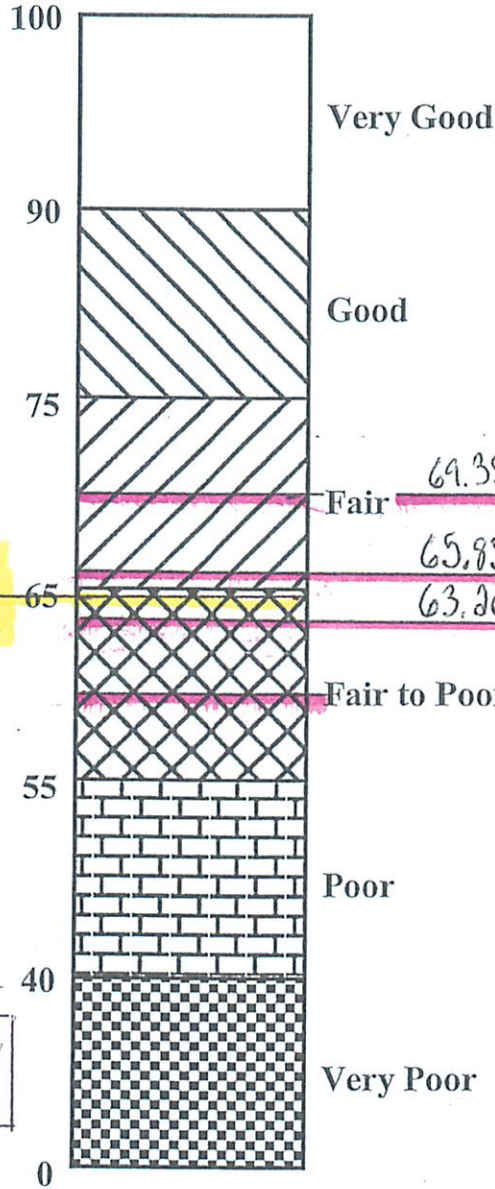

Figure 1. Pavement Condition Rating (PCR) Scale

ROAD NAME: LITTLE PORTAGE EAST RD
 LOG MILE: MUDDY CREEK NORTH RD
 TO: SALEM/BAY TOWNSHIP LINE

**FLEXIBLE PAVEMENT
 CONDITION RATING FORM**

DATE: 8/5/2021
 RATED BY: CRM

DISTRESS	DISTRESS WEIGHT	SEVERITY WT.*				EXTENT WT.*			DEDUCT POINTS***	
		L	M	H	O	F	E			
RAVELING	10	L	0.3	0.6	1	E	0.5	0.8	1	3.0
BLEEDING	5	-	0.8	0.8	1	-	0.6	0.9	1	
PATCHING	5	-	0.3	0.6	1	-	0.6	0.8	1	
POTHOLES/DEBONDING	10	L	0.4	0.7	1	O	0.5	0.8	1	2.0
CRACK SEALING DEFICIENCY	5	M	1	1	1	E	0.5	0.8	1	5.0
RUTTING	10	-	0.3	0.7	1	-	0.6	0.8	1	
SETTLEMENT	10	M	0.5	0.7	1	O	0.5	0.8	1	3.5
CORRUGATIONS	5	-	0.4	0.8	1	-	0.5	0.8	1	
WHEEL TRACK CRACKING	15	L	0.4	0.7	1	F	0.5	0.7	1	4.2
BLOCK AND TRANSVERSE CRACKING	10	M	0.4	0.7	1	E	0.5	0.7	1	7.0
LONGITUDINAL JOINT CRACKING	5	-	0.4	0.7	1	-	0.5	0.7	1	
EDGE CRACKING	5	M	0.4	0.7	1	E	0.5	0.7	1	3.5
RANDOM CRACKING	5	M	0.4	0.7	1	F	0.5	0.7	1	2
TOTAL DEDUCT =									30.65	
SUM OF STRUCTURAL DEDUCT (BOLD) =									15.65	
100 - TOTAL DEDUCT = PCR =									69.35	

*L = LOW
 M = MEDIUM
 H = HIGH
 **O = OCCASIONAL
 F = FREQUENT
 E = EXTENSIVE

***DEDUCT POINTS = DISTRESS WEIGHT x SEVERITY WT. x EXTENT WT.

NOTES: WIDESPREAD CRACKING, HEAVY TRANSVERSE AND EDGE CRACKING. SETTLEMENT IS PREVALENT ALONG THE PAVEMENT EDGES. PAVEMENT HAS RAVELED SLIGHTLY AND CRACKS ARE BEGINNING TO FORM POTHOLES IN ISOLATED LOCATIONS.

ROAD NAME: BIER ROAD
 LOG MILE: BEHLMAN ROAD
 TO: ATWATER ROAD

**FLEXIBLE PAVEMENT
 CONDITION RATING FORM**

DATE: 8/5/2021
 RATED BY: CRM

DISTRESS	DISTRESS WEIGHT	SEVERITY WT.*				EXTENT WT.*			DEDUCT POINTS***	
			L	M	H		O	F		E
RAVELING	10	M	0.3	0.6	1	E	0.5	0.8	1	6.0
BLEEDING	5	-	0.8	0.8	1	-	0.6	0.9	1	
PATCHING	5	M	0.3	0.6	1	F	0.6	0.8	1	2.4
POTHoles/DEBONDING	10	-	0.4	0.7	1	-	0.5	0.8	1	
CRACK SEALING DEFICIENCY	5	L	1	1	1	O	0.5	0.8	1	2.5
RUTTING	10	-	0.3	0.7	1	-	0.6	0.8	1	
SETTLEMENT	10	L	0.5	0.7	1	F	0.5	0.8	1	4.0
CORRUGATIONS	5	-	0.4	0.8	1	-	0.5	0.8	1	
WHEEL TRACK CRACKING	15	M	0.4	0.7	1	O	0.5	0.7	1	5.3
BLOCK AND TRANSVERSE CRACKING	10	M	0.4	0.7	1	E	0.5	0.7	1	7.0
LONGITUDINAL JOINT CRACKING	5	L	0.4	0.7	1	O	0.5	0.7	1	1.0
EDGE CRACKING	5	H	0.4	0.7	1	E	0.5	0.7	1	5.0
RANDOM CRACKING	5	L	0.4	0.7	1	O	0.5	0.7	1	1
TOTAL DEDUCT =									34.15	
SUM OF STRUCTURAL DEDUCT (BOLD) =									13.25	
100 - TOTAL DEDUCT = PCR =									65.85	

*L = LOW
 M = MEDIUM
 H = HIGH

**O = OCCASIONAL
 F = FREQUENT
 E = EXTENSIVE

***DEDUCT POINTS = DISTRESS WEIGHT x SEVERITY WT. x EXTENT WT.

NOTES: EDGE PAVEMENT IS SETTING AND FAILING IN VARIOUS LOCATIONS. BLOCK CRACKING IS PRESENT IN THESE LOCATIONS. TRANSVERSE CRACKING IS WIDESPREAD AND SEVERE. EDGE CRACKING IS EXTENSIVE.

ROAD NAME: CURTICE EAST & WEST RD
 LOG MILE: WILDACRE ROAD
 TO: GENOA-CLAY CENTER RD

FLEXIBLE PAVEMENT CONDITION RATING FORM

DATE: 8/5/2021
 RATED BY: CRM

DISTRESS	DISTRESS WEIGHT	SEVERITY WT.*			EXTENT WT.*			DEDUCT POINTS***		
		L	M	H	O	F	E			
RAVELING	10	-	0.3	0.6	1	-	0.5	0.8	1	
BLEEDING	5	L	0.8	0.8	1	F	0.6	0.9	1	3.6
PATCHING	5	M	0.3	0.6	1	O	0.6	0.8	1	1.8
POTHOLES/DEBONDING	10	M	0.4	0.7	1	O	0.5	0.8	1	3.5
CRACK SEALING DEFICIENCY	5	L	1	1	1	E	0.5	0.8	1	5.0
RUTTING	10	M	0.3	0.7	1	F	0.6	0.8	1	5.6
SETTLEMENT	10	M	0.5	0.7	1	E	0.5	0.8	1	7.0
CORRUGATIONS	5	-	0.4	0.8	1	-	0.5	0.8	1	
WHEEL TRACK CRACKING	15	L	0.4	0.7	1	O	0.5	0.7	1	3.0
BLOCK AND TRANSVERSE CRACKING	10	L	0.4	0.7	1	F	0.5	0.7	1	2.8
LONGITUDINAL JOINT CRACKING	5	-	0.4	0.7	1	-	0.5	0.7	1	
EDGE CRACKING	5	M	0.4	0.7	1	E	0.5	0.7	1	3.5
RANDOM CRACKING	5	L	0.4	0.7	1	O	0.5	0.7	1	1
TOTAL DEDUCT =									36.8	
SUM OF STRUCTURAL DEDUCT (BOLD) =									15.9	
100 - TOTAL DEDUCT = PCR =									63.2	

*L = LOW
 M = MEDIUM
 H = HIGH

**O = OCCASIONAL
 F = FREQUENT
 E = EXTENSIVE

***DEDUCT POINTS = DISTRESS WEIGHT x SEVERITY WT. x EXTENT WT.

NOTES: EDGE PAVEMENT IS SETTING AND FAILING IN VARIOUS LOCATIONS. BLOCK CRACKING IS PRESENT IN THESE LOCATIONS. TRANSVERSE CRACKING IS WIDESPREAD AND SEVERE. EDGE CRACKING IS EXTENSIVE. RIDE QUALITY IS POOR, PAVEMENT EDGES HAVE SETTLED AND FAILED IN MANY LOCATIONS.

ROAD NAME: WALBRIDGE EAST ROAD
 LOG MILE: MARTIN-WILLISTON ROAD
 TO: OPFER-LENTZ ROAD

FLEXIBLE PAVEMENT CONDITION RATING FORM

DATE: 8/5/2021
 RATED BY: CRM

DISTRESS	DISTRESS WEIGHT	SEVERITY WT.*				EXTENT WT.*			DEDUCT POINTS***	
			L	M	H		O	F		E
RAVELING	10	H	0.3	0.6	1	E	0.5	0.8	1	10.0
BLEEDING	5	-	0.8	0.8	1	-	0.6	0.9	1	
PATCHING	5	H	0.3	0.6	1	E	0.6	0.8	1	5.0
POTHoles/DEBONDING	10	H	0.4	0.7	1	E	0.5	0.8	1	10.0
CRACK SEALING DEFICIENCY	5	-	1	1	1	-	0.5	0.8	1	
RUTTING	10	M	0.3	0.7	1	F	0.6	0.8	1	5.6
SETTLEMENT	10	H	0.5	0.7	1	E	0.5	0.8	1	10.0
CORRUGATIONS	5	-	0.4	0.8	1	-	0.5	0.8	1	
WHEEL TRACK CRACKING	15	-	0.4	0.7	1	-	0.5	0.7	1	
BLOCK AND TRANSVERSE CRACKING	10	-	0.4	0.7	1	-	0.5	0.7	1	
LONGITUDINAL JOINT CRACKING	5	-	0.4	0.7	1	-	0.5	0.7	1	
EDGE CRACKING	5	-	0.4	0.7	1	-	0.5	0.7	1	
RANDOM CRACKING	5	-	0.4	0.7	1	-	0.5	0.7	1	
TOTAL DEDUCT =									40.6	
SUM OF STRUCTURAL DEDUCT (BOLD) =									15.6	
100 - TOTAL DEDUCT = PCR =									59.4	

*L = LOW
 M = MEDIUM
 H = HIGH

**O = OCCASIONAL
 F = FREQUENT
 E = EXTENSIVE

***DEDUCT POINTS = DISTRESS WEIGHT x SEVERITY WT. x EXTENT WT.

NOTES: PAVEMENT IS RAVELING VERY BADLY. WIDESPREAD POTHoles THROUGHOUT. PATCHING PRESENT THROUGHOUT. RIDE QUALITY IS POOR, PAVEMENT EDGES HAVE SETTLED AND FAILED IN MANY LOCATIONS.

FARMLAND PRESERVATION REVIEW LETTER

FARMLAND PRESERVATION REVIEW
FOR THE OHIO PUBLIC WORKS COMMISSION

**Little Portage E TR #112, Walbridge East TR #68,
Curtice E & W TR #70, & Bier TR #97 Roads Resurfacing**

This review is to comply with Farmland Preservation Review Advisory of the Ohio Public Works Commission and the Governor's Executive Order 98-IIV. This review was accomplished by [insert name of subdivision / agency that conducted the review].

1. The immediate impact the project will have on productive agricultural and grazing land related to land acquisition.

none

2. Indirect impact that will result in the loss of productive agricultural and grazing land from development related to the project.

none

3. Mitigation measures that could be implemented when alternative sites or locations are not feasible.

n/a



Ronald P. Lajti, Jr., P.E., P.S.,
Ottawa County Engineer

Date

8/26/21

Salem Township

Ottawa County, Ohio

PO Box 417

Oak Harbor, OH 43449

BOARD OF TRUSTEES

Ronald Buehler

Richard Lenke

Todd Winke

Aaron Avery, Fiscal Officer

Matt Chasteen, Zoning Inspector

August 30, 2021

Ohio Public Works Commission

District 5 Committee

Issue 1 Round 34

Re: Resolution #SAC-2021-01

Dear Committee Members:

The Board of Trustees of Salem Township are pleased to submit an OPWC Issue1, Round 36 Grant/Loan application for financial assistance for road resurfacing within the township. Salem Township is submitting this narrative for the resurfacing of Little Portage East Rd TR #112. The road area to be resurfaced begins at Muddy Creek North Rd and extends eastward to the Township boundary, totaling 1.02 miles.

LITTLE PORTAGE EAST (TR # 112)

Little Portage East from Muddy Creek North Rd East to the Township boundary is need of major repair work. The most recent substantial resurfacing work was completed in 2005. The current problems that need to be remedied include shoulder degradation, widespread alligator crack patterns, loss of fine aggregate particles and numerous base failures. Additionally, Little Portage East Rd is prone to frequent high water and flooding. This resurfacing is expected to raise the surface of the road by 2 inches, which should lessen the prevalence and severity of flooding of the road surface. This paving project is expected to remedy these issues going forward for the next 15 years.

The Township has received letters of support from the Ottawa County Sheriff and Benton-Carroll-Salem School District, which are included with this application.

Please don't hesitate to contact me at 419-351-9006, or by email at SalemTwp@cros.net.

Thank you for your time and consideration,



Aaron Avery

Salem Township Fiscal Officer

Ottawa County, Ohio

Allen Township Trustees
Ottawa County
P.O. Box 440
Williston, Ohio 43468-0440
(419) 836-4204

Ernest E. Cottrell
22095 West Honeysuckle
Curtice, Ohio 43412 (419) 340-7013

Scott R. Everhardt
22459 Bittersweet Lane
Curtice, Ohio 43412 (419) 836-9614

Craig Blausey
4907 N. Martin Williston Road
Martin, Ohio 43445 (419) 855-9056

Jennifer Witt
3432 North Nissen Road
Martin, Ohio 43445 (419) 277-2761

August 17, 2021

Ohio Public Works Commission
District 5 Committee
Issue 1 Round 36

Dear Committee Members,

The Allen Township Trustees are pleased to submit an OPWC Issue I, Round 36 Grant/Loan application for financial assistance to resurface approximately 1.50 miles of road work resurfacing within the township. Allen Township is submitting the narrative for the CM-150 resurfacing of 1 mile of Walbridge East Road TR#68. The road area to be resurfaced begins on Walbridge Road East from Opfer-Lentz to Martin Williston Road and .5 miles of EW Curtice Road TR#70 from Genoa Clay Center Road to Wildacre Road. The balance of this grant application narrative will include miles in Carol and Salem Townships.

Walbridge Road East (TR#68 1.00 mile) is in extremely poor condition with spider cracking throughout (see pictures). The road has several potholes that are continuously cleaned and filled. The road is also experiencing major edge peel erosion on the south edge. The road has a poor base and is failing in several locations. The road is completely unraveling near the intersection of Opfer-Lentz Road. The township will chip seal the road one year after the repaving is completed. A CM-150 overlay will add a seven to ten-year solution for road use without incurring additional repair costs. Genoa School's, OCTA buses and residential traffic serves this road daily to serve students, elderly residents in Allen Township.

EW Curtice Road (TR#70 .5 miles) EW Curtice Road between GCC and Wildacre is a main artery for local residential and school bus traffic. Both north and south edges are dipping and retaining water for days after any rain fall. There is also spider cracking and edge surface unraveling on both sides. We also starting to incur potholes in various sections. A CM-150 overlay will add a seven to ten-year solution for road use without incurring additional repair costs. The township will chip seal the road one year after the CM-150 repaving is completed.

The township received letters of support from The Ottawa County Sheriff, The Allen-Clay Joint Fire District and The Genoa Schools. I have included the original letters within the application for your consideration. The township is applying for a grant and the township will appropriate the additional matching monies from the township's 2021 budget for this project.

If you have any questions, please contact either Ernie Cottrell at 419-340-7013 or by email at ecottrell@amplex.net.

Best Regards,

A handwritten signature in blue ink that reads "Scott R. Everhardt". The signature is fluid and cursive, with the first name "Scott" and last name "Everhardt" clearly legible.

Scott R. Everhardt
Allen Township Trustee,
Ottawa County, Ohio

August 16, 2021

Ohio Public Works Commission

Issue I Round 36

Dear Committee Members,

The Carroll Township Trustees are pleased to submit an OPWC Issue I, Round 36 Grant application for financial assistance to complete capital improvements to 1.52 miles of road within the township. Carroll Township is submitting the narrative for the resurfacing of the section of Bier Road (TR#97) between Behlman and Atwater roads. The balance of this grant application will include miles in both Salem and Allen Townships.

Bier Road (TR-97/1.52 miles) is a section of road that is next in line in Carroll Township's resurfacing program. Sections of this road to the west have already been resurfaced, and continued progress east is a priority. The road surface is 25 years old, even with our excellent crack seal program it has started to deteriorate with age. The road has extensive raveling as well as some thermal cracking. The entire length of this section is edge cracking and in many spots there is severe block and transverse cracking.

The Township received letters of support from the Ottawa County Sheriff, as well as the Carroll Township Fire and Police Departments. I have included the letters within the application for your consideration. The Township is applying for a grant/loan combination, and the Township will appropriate required monies for this project in the 2023 budget cycle.

If you have any questions, please contact me at (419)346-0029 or by email at jmoore@carrolltownship.net.

Regards,

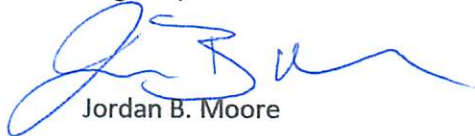

Jordan B. Moore



PROJECT LOCATION - STATE MAP
SALEM-ALLEN-CARROLL TWP. ROAD RESURFACINGS

3200 feet = 1 mile
 1760 yards = 1 mile
 1 Twp. = 36 miles sq.

40 Chains = 160 Rods = 2460'
 80 Rods = 1320'
 S.W. CORNER SOUTH QUARTER POST 80 Chains = 320 Rods = 1 Mile S.E. CORNER

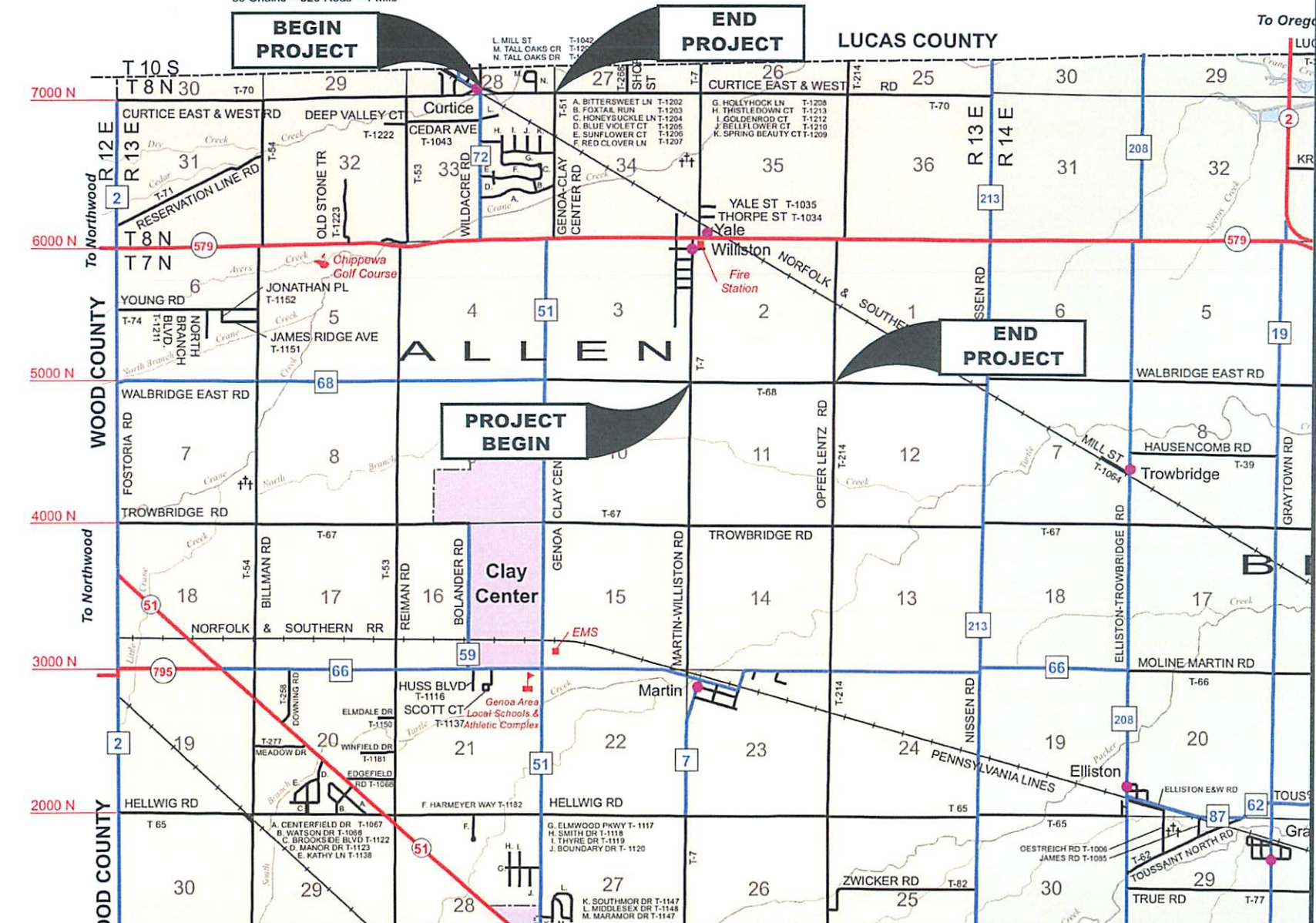

PROJECT LOCATION - COUNTY MAP - ALLEN TWP.
WALBRIDGE EAST ROAD (TR-68) & CURTICE EAST & WEST ROAD (TR-70) RESURFACING



PROJECT LOCATION - COUNTY MAP - CARROLL TWP. BIER ROAD (TR-97) RESURFACING

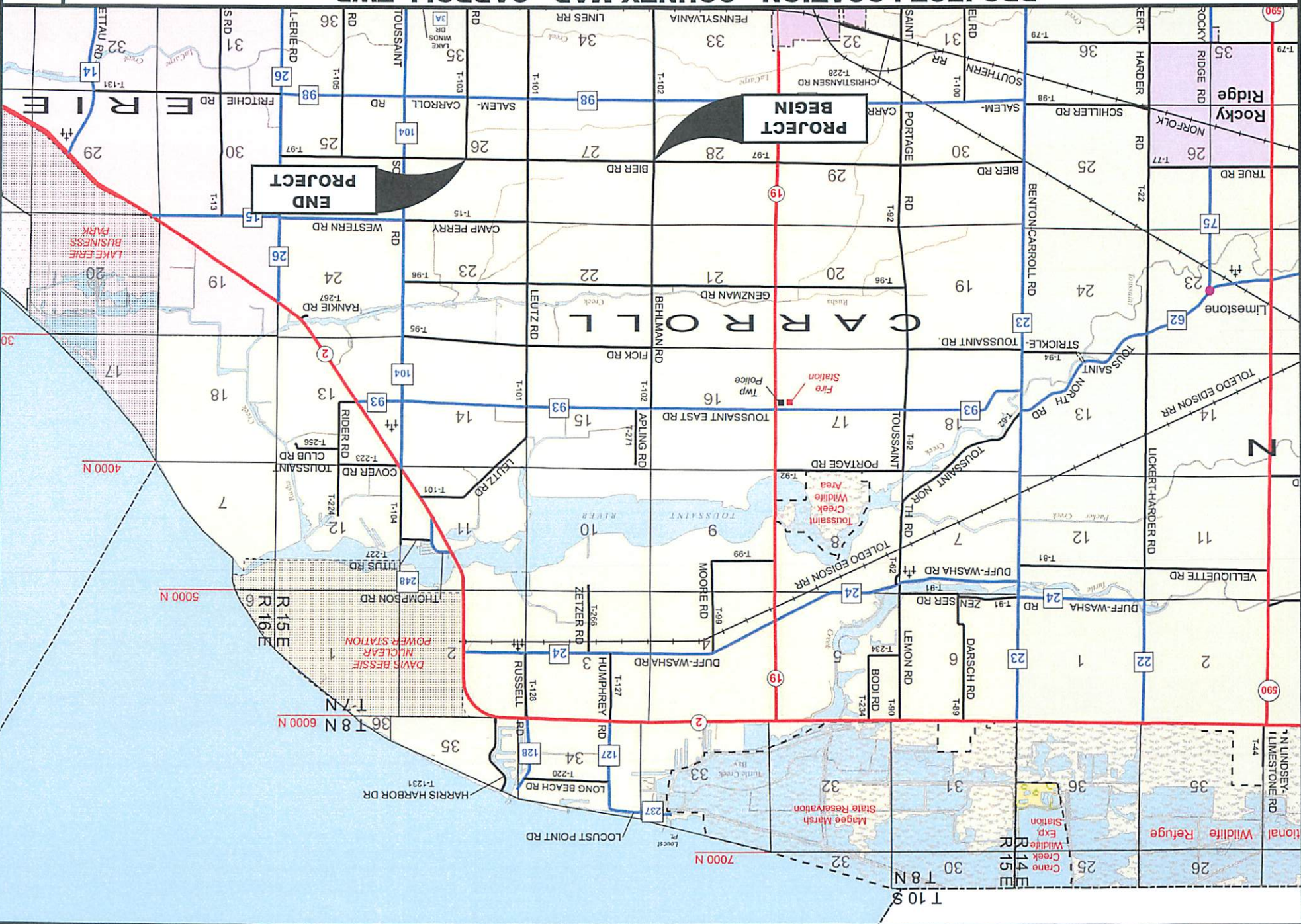

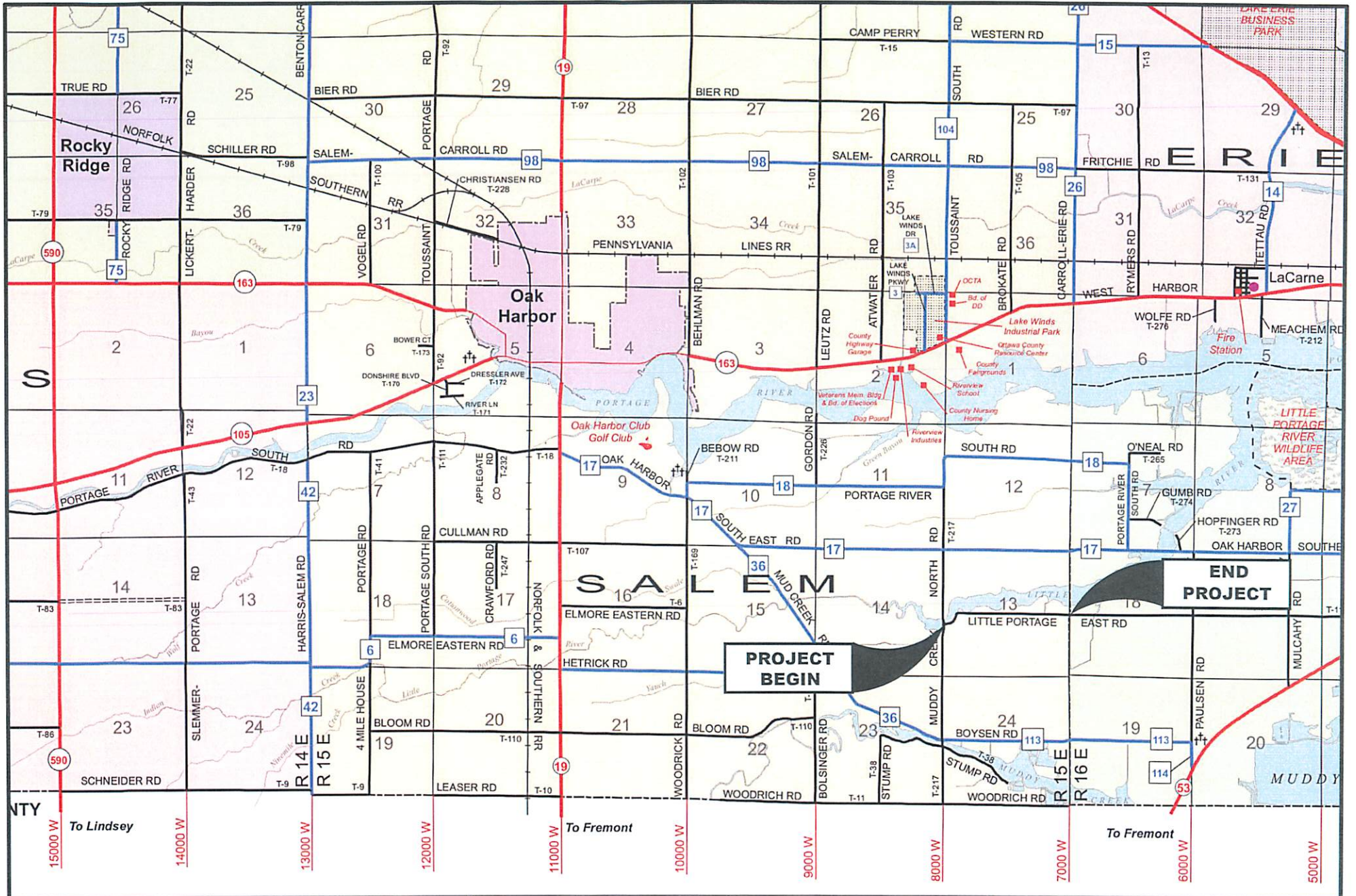

**PROJECT LOCATION - COUNTY MAP - SALEM TWP.
LITTLE PORTAGE EAST ROAD (TR-112) RESURFACING**



Little Portage East Road TR #112

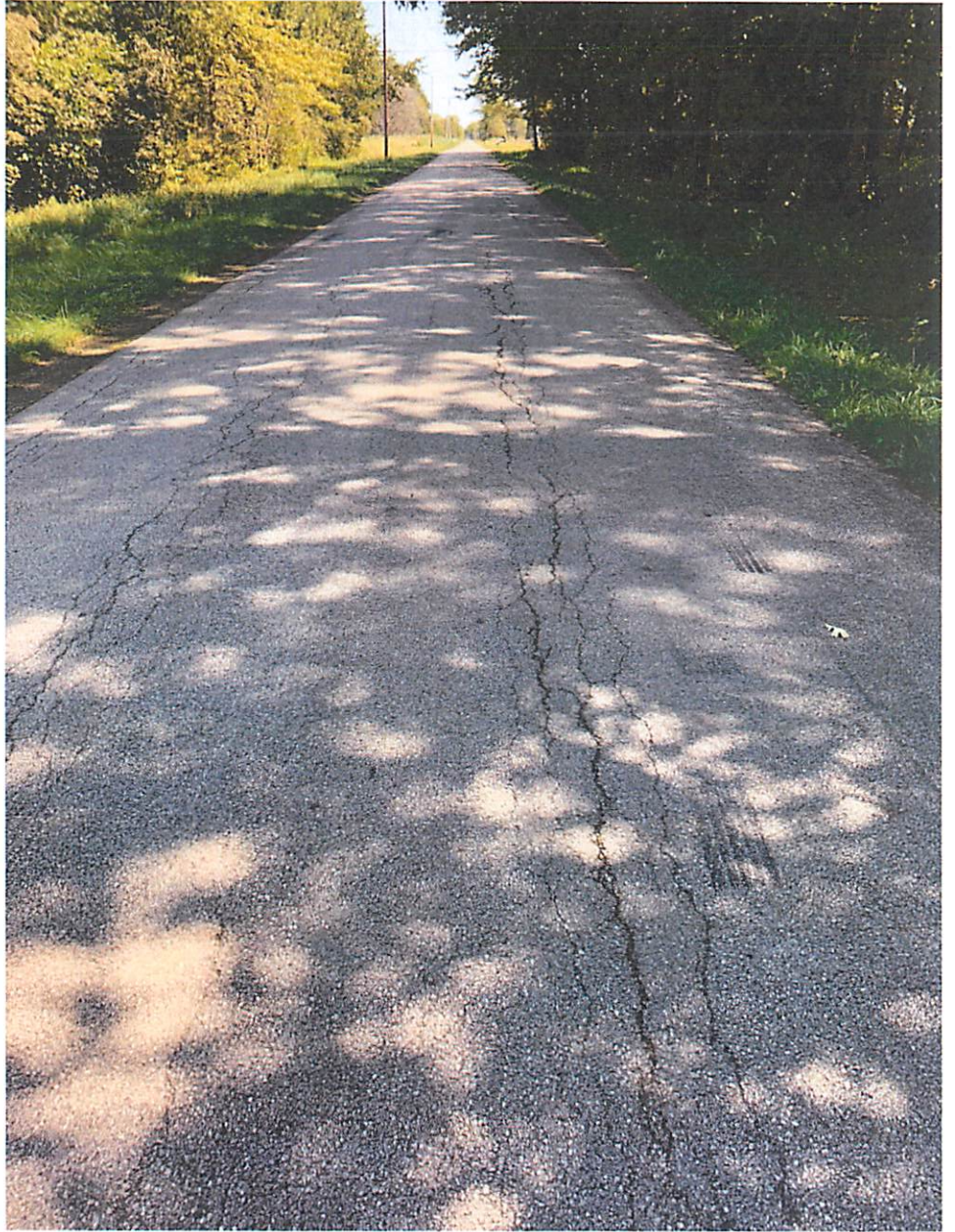

Photos 1 & 2 –Widespread Cracking and Raveling

Little Portage East Road TR #112

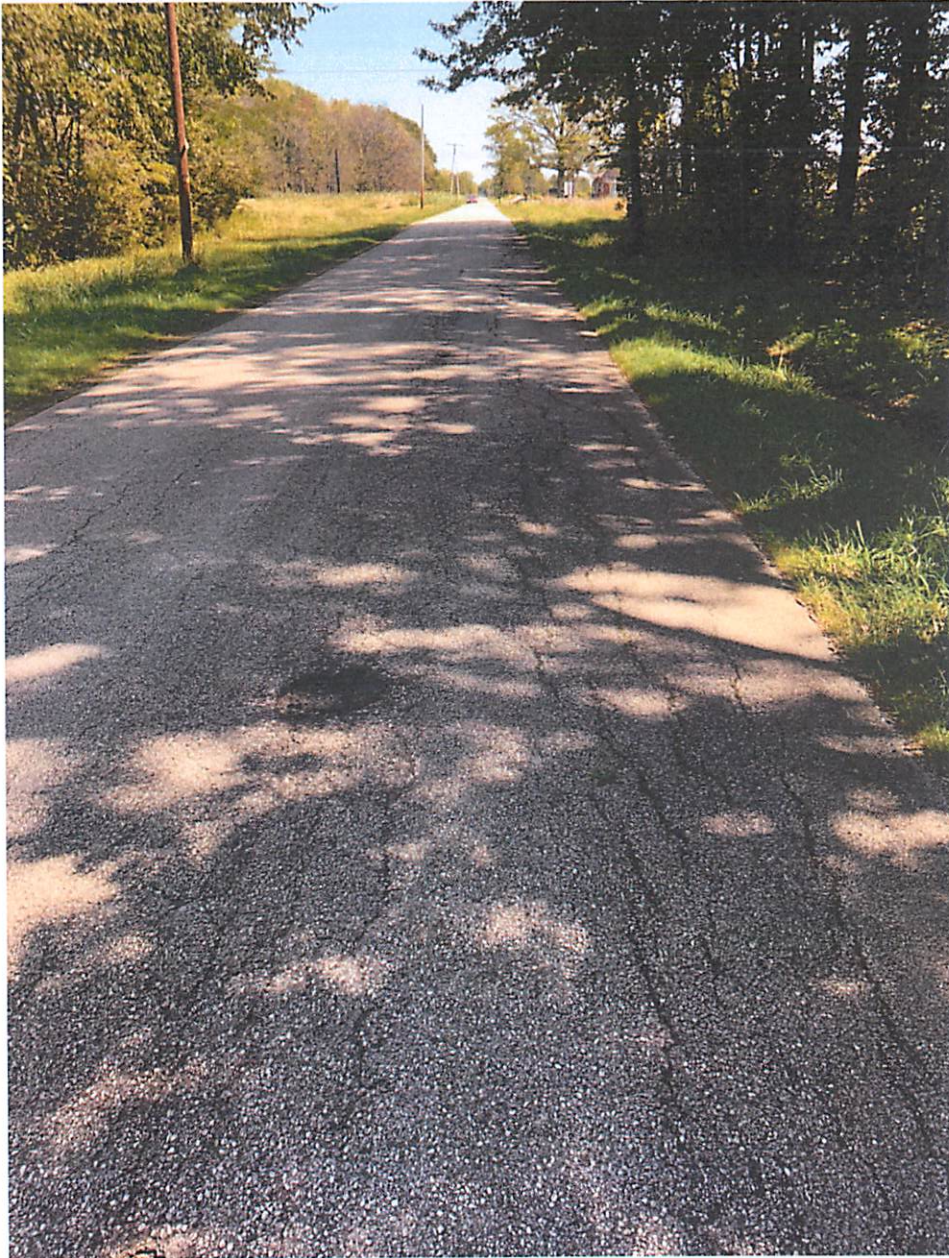

Photos 3 & 4 – Widespread Cracking, Isolated Potholing, Etc.

Walbridge East Road TR #68

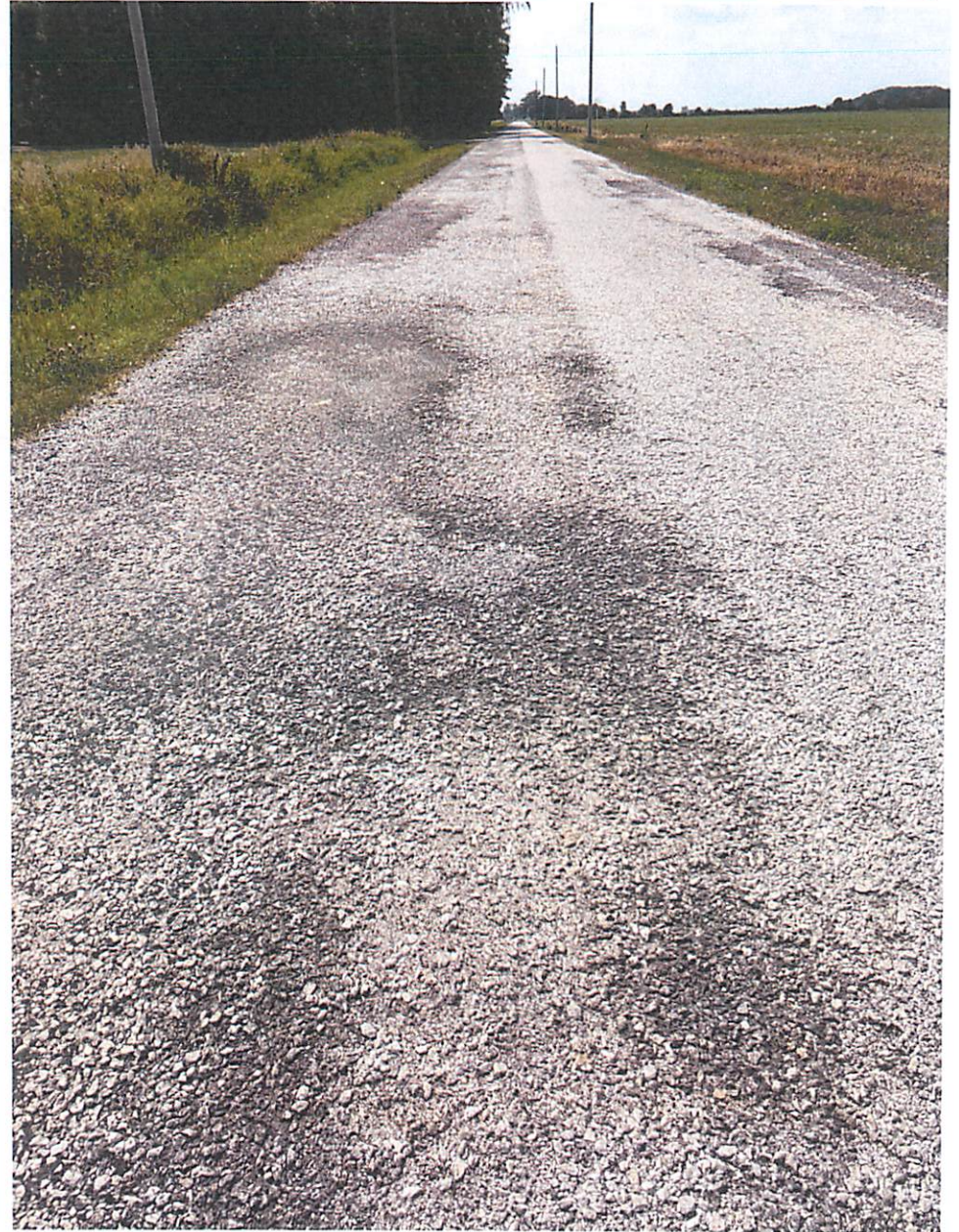

Photos 1 & 2 – Excessive Raveling, Pavement Deterioration and Potholing
Page 1 of 2

Walbridge East Road TR #68



Photos 3 & 4 – Raveling, Pavement Deterioration, Potholing & Patching

Curtice East & West Road TR #70



Photos 1 & 2 – Edge Failures, Extensive Cracking & Patching

Curtice East & West Road TR #70



Photos 3 & 4 – Pavement Failures, Raveling & Block Cracking

Bier Road TR #97



Photos 1 & 2 – Edge Failures, Extensive Cracking & Patching

Bier Road TR #97

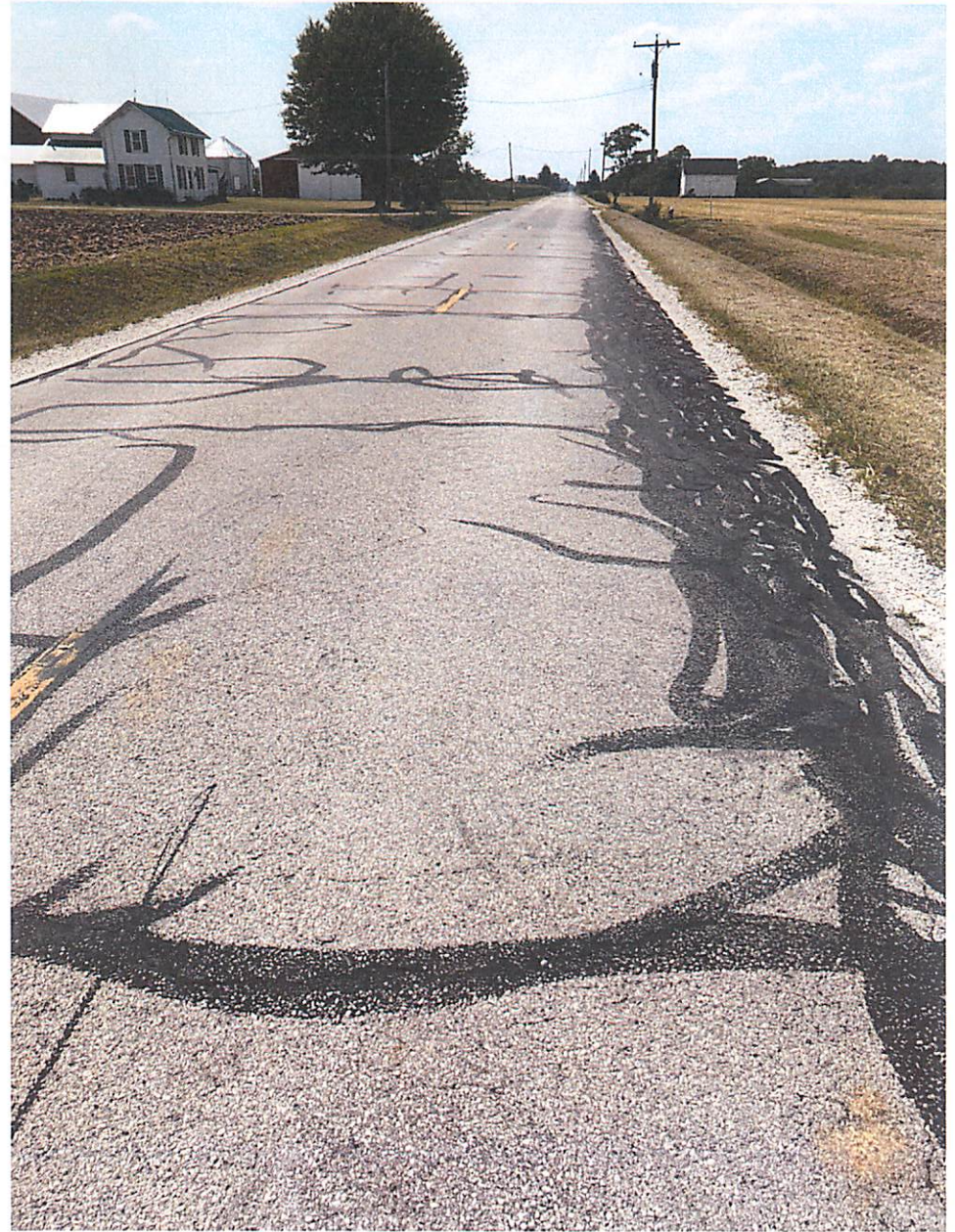

Photos 3 & 4 – Severe Edge Failure and Patching

ROAD RESURFACING 2023 - COST ESTIMATE

SALEM TOWNSHIP - LITTLE PORTAGE EAST ROAD (TR#112)
 ESTIMATOR: CRM
 DATE: 5/14/21

ROAD NAME	LENGTH		AREA		BITUMINOUS MATERIAL				AGGREGATE, MATERIAL OR PROCESS						REMARKS				
	MILES	LENGTH (FT)	WIDTH (FT)	SQ YDS	KINDS	APPLIED RATE	TOTAL GALLONS	UNIT COST	APPLIED COST	STONE SIZE	LBS PER SQ YD	THICKNESS (IN)	TOTAL CU YDS	TOTAL / TOTAL TONS		UNIT COST	APPLIED COST	TOTAL COST	
LITTLE PORTAGE EAST ROAD FROM MUDDY CREEK NORTH ROAD TO SALEM/BAY TOWNSHIP LINE	1.03	5420	16.0	9636	Tack	0.080	770.84	\$ 2.20	\$ 1,695.86							\$	1,695.86	407 - TACK COAT (SCRATCH)	
	1.03	5420	16.0	9636	Tack	0.060	578.13	\$ 2.20	\$ 1,271.89							\$	1,271.89	407 - TACK COAT (SURFACE)	
	1.03	5420	16.0	9636	PG64-22					448-1	0.75		401.48	\$ 80.00	\$ 32,118.52	\$	32,118.52	441 - 0.75" INTERMEDIATE, TYPE 1, PG64-22	
				107	PG64-22					448-1	2.00		11.89	\$ 80.00	\$ 951.11	\$	951.11	441 - SURFACE TYPE 1, PG64-22 (DRIVES & MAILBOX)	
	1.03	5420	16.0	9636	PG64-22					448-1	1.25		669.14	\$ 80.00	\$ 53,530.86	\$	53,530.86	441 - 1.25" 448 SURFACE TYPE 1, PG64-22	
	2.05	10840	1.5	1806.7							411	2.25		225.8	\$ 28.00	\$ 6,323.33	\$	6,323.33	COMPACTED AGGREGATE (411 BERM)
	1.03														\$ 1,600.00	\$ 1,648.00	\$	1,648.00	CENTER LINE, 4"
															\$ 5,000.00	\$ 5,000.00	\$	5,000.00	614 - MAINTENANCE OF TRAFFIC
															\$ 1,539.00	\$ 1,539.00	\$	1,539.00	103.05 - CONTRACT BOND
																	\$	104,079.00	ROAD TOTAL

NOTICE TO BIDDERS:

DRIVEWAY APRONS AND MAILBOX APPROACHES SHALL BE MILLED AND PAVED UP TO 6 FEET FROM THE EDGE OF PAVEMENT. ESTIMATE INCLUDES MILLING OF ABUTTING JOINTS AT ALL ASPHALT DRIVES. THIS WILL NOT BE A SEPARATELY PAID ITEM. THERE ARE A TOTAL OF 18 DRIVES AND MAILBOX APPROACHES. QUANTITIES ON ESTIMATE WERE COMPUTED AS FOLLOWS:

TOTAL LENGTH	WIDTH (AVG)	SY
240	4	106.7

QUANTITIES FOR DRIVES WILL BE LUMPED TOGETHER WITH ROADWAY QUANTITIES IN PROPOSAL. THEY ARE SHOWN SEPARATE IN THIS ESTIMATE SHEET FOR QUANTITY CLARITY.

PAVEMENT WIDTHS VARY SLIGHTLY, 16' IS THE AVERAGE WIDTH. 15.5' IS THE MINIMUM. PAVEMENT WIDENS SLIGHTLY AT MUDDY CREEK NORTH ROAD INTERSECTION APPROACH.

QUANTITIES ON PROPOSAL ARE SLIGHTLY HIGHER THAN ON COST ESTIMATE DUE TO ROUNDING

ROAD TO BE CLOSED TO THROUGH TRAFFIC DURING PAVING. LOCAL TRAFFIC SHALL BE MAINTAINED DURING CONSTRUCTION. FLAGGERS WILL BE REQUIRED.

TRUCKS SHALL ENTER AND EXIT FROM MUDDY CREEK NORTH ROAD. NECESSARY TRAFFIC CONTROL SHALL BE IN PLACE ON MUDDY CREEK NORTH ROAD DURING TRUCK STAGING AND BACKING. THE BRIDGE NEAR THE INTERSECTION OF MUDDY CREEK NORTH AND LITTLE-PORTAGE EAST REDUCES SIGHT DISTANCES.

SEE SUPPLEMENTAL SPECIFICATIONS FOR ASPHALT CONCRETE PAVEMENT

ROAD RESURFACING 2023 - COST ESTIMATE

ALLEN TOWNSHIP - WALBRIDGE EAST ROAD (TR#68)
 ESTIMATOR: CRM
 DATE: 6/16/2021

ROAD NAME	LENGTH		AREA		BITUMINOUS MATERIAL				AGGREGATE, MATERIAL OR PROCESS						REMARKS		
	MILES	LENGTH (FT)	WIDTH (FT)	SQ YDS	KINDS	APPLIED RATE	TOTAL GALLONS	UNIT COST	APPLIED COST	STONE SIZE	LBS PER SQ YD	THICKNESS (IN)	TOTAL CU YDS	TOTAL TONS		UNIT COST	APPLIED COST
WALBRIDGE EAST ROAD FROM MARTIN-WILLISTON ROAD TO OPFER-LENTZ ROAD	1.00	5300	19.5	11483	CM-150	0.93	10679.5	\$ 3.30	\$ 35,242.35	#67	150		861	\$ 52.00	\$ 44,785.00	\$ 80,027.35	DRAG COAT
	1.00	5300	19.5	11483						#9	11		63.2	\$ 60.00	\$ 3,789.50	\$ 3,789.50	CHOKE COAT
				107	CM-150	0.93	99.5	\$ 3.30	\$ 328.38	#67	150		8	\$ 52.00	\$ 417.30	\$ 745.68	DRAG COAT (INTERSECTION AND DRIVES)
				107						#9	11		0.6	\$ 60.00	\$ 35.31	\$ 35.31	CHOKE COAT (INTERSECTION AND DRIVES)
	1.33	7000	9.0	7000	Tack	0.080	560	\$ 2.20	\$ 1,232.00							\$ 1,232.00	407 - TACK COAT (SCRATCH)
	1.33	7000	9.0	7000							0.50		194.44	\$ 90.00	\$ 17,500.00	\$ 17,500.00	441 ASPHALT CONCRETE INTERMEDIATE COURSE, TYPE 1, (448)
	2.01	10600	1.5	1813.8							411	2.00	201.5	\$ 28.00	\$ 5,642.86	\$ 5,642.86	COMPACTED AGGREGATE (411 BERM)
																\$ 3,000.00	MAINTENANCE OF TRAFFIC
																\$ 1,680.00	BOND PREMIUM
																\$ 113,653.00	ROAD TOTAL

NOTICE TO BIDDERS:

DRIVEWAY APRONS AND MAILBOX APPROACHES SHALL BE MILLED AND PAVED UP TO 6 FEET FROM THE EDGE OF PAVEMENT. ESTIMATE INCLUDES MILLING OF ABUTTING JOINTS AT ALL ASPHALT & CONCRETE DRIVES, THIS WILL NOT BE A SEPARATELY PAID ITEM. THERE ARE A TOTAL OF 46 DRIVES, QUANTITIES ON ESTIMATE WERE COMPUTED AS FOLLOWS:

TOTAL LENGTH	WIDTH	SY
240	4	107

ESTIMATE ALSO TO INCLUDE THE MILLING OF ABUTTING JOINTS AT ALL INVOLVED INTERSECTIONS. JOINTS SHALL BE THE FULL WIDTH OF PAVEMENT, 10 FEET IN LENGTH IN INTERSECTIONS, AND AT A DEPTH EQUAL TO THE DEPTH OF PROPOSED ASPHALT OVERLAYMENT.

QUANTITIES FOR DRIVES WILL BE LUMPED TOGETHER WITH ROADWAY QUANTITIES IN PROPOSAL. THEY ARE SHOWN SEPARATE IN THIS ESTIMATE SHEET FOR QUANTITY CLARITY.

DRAG COAT LISTED ABOVE SHALL BE MIXED IN A PUGMILL AT THE CONTRACTOR'S SITE. INSPECTOR SHALL BE NOTIFIED OF DATE, TIME, AND LOCATION, 48 HOUR IN ADVANCE OF MIXING. MATERIAL IS TO BE PLACED WITH A CONVENTIONAL PAVER WITH A 3/16" PER FOOT CROSS SLOPE.

448 SURFACE TYPE 1, SCRATCH COURSE LISTED ABOVE WILL BE LAID IN VARIOUS LOCATIONS TO CORRECT SEVERE CROSS-SECTIONAL SLOPE ISSUES. THE ESTIMATED AMOUNT ABOVE IS FOR ESTIMATING PURPOSES ONLY AND THE ENTIRE QUANTITY IS NOT GUARANTEED. EXACT LOCATIONS WILL BE MARKED OUT ONSITE BY THE ENGINEER AT THE TIME OF CONSTRUCTION. ESTIMATE INCLUDES 7000 LF OF LANE WIDTH SCRATCH COURSE WITH AN AVERAGE THICKNESS OF 0.50". APPROXIMATELY 4500 LF IN THE EAST BOUND LANE AND 2500' IN THE WEST BOUND LANE.

PAVEMENT IS ON AN AVERAGE OF 18.5' IN WIDTH. 19.5' WAS USED FOR MATERIAL PADDING DUE TO INCONSISTENCIES IN THE CROSS-SECTIONAL SLOPE OF THE EXISTING PAVEMENT. FINISH PAVEMENT WIDTH WILL VARY SLIGHTLY.

LOCAL TRAFFIC SHALL BE MAINTAINED. ROAD CAN BE CLOSED TO THROUGH TRAFFIC DURING PAVING OPERATIONS.

SEE OTTAWA COUNTY SUPPLEMENTAL SPECIFICATIONS FOR COLD MIX AND HOT MIX.

ROAD RESURFACING 2023 - COST ESTIMATE

ALLEN TOWNSHIP - CURTICE EAST & WEST ROAD (TR#70)
 ESTIMATOR: CRM
 DATE: 6/16/2021

ROAD NAME	LENGTH		AREA		BITUMINOUS MATERIAL					AGGREGATE, MATERIAL OR PROCESS						REMARKS		
	MILES	LENGTH (FT)	WIDTH (FT)	SQ YDS	KINDS	APPLIED RATE	TOTAL GALLONS	UNIT COST	APPLIED COST	STONE SIZE	LBS PER SQ YD	THICKNESS (IN)	TOTAL CU YDS	TOTAL TONS	UNIT COST		APPLIED COST	TOTAL COST
CURTICE EAST AND WEST ROAD FROM WILDACRE ROAD TO GENOA-CLAY CENTER ROAD (EAST SIDE OF INTERSECTION)	0.52	2750	20.5	6263.9	CM-150	0.93	5825.4	\$ 3.30	\$ 19,223.88	#67	150		470	\$ 52.00	\$ 24,429.17	\$ 43,653.04	DRAG COAT	
	0.52	2750	20.5	6263.9						#9	11		34.5	\$ 60.00	\$ 2,067.08	\$ 2,067.08	CHOKE COAT	
				387	CM-150	0.93	359.9	\$ 3.30	\$ 1,187.70	#67	150		29	\$ 52.00	\$ 1,509.30	\$ 2,697.00	DRAG COAT (INTERSECTION AND DRIVES)	
				387						#9	11		2.1	\$ 60.00	\$ 127.71	\$ 127.71	CHOKE COAT (INTERSECTION AND DRIVES)	
		0.55	2900	10.0	3222	Tack	####	257.8	\$ 2.20	\$ 567.11						\$ 567.11	\$ 567.11	407 - TACK COAT (SCRATCH)
		0.55	2900	10.0	3222.2							0.50		89.51	\$ 90.00	\$ 8,055.56	\$ 8,055.56	441 ASPHALT CONCRETE INTERMEDIATE COURSE, TYPE 1, (448)
		1.04	5500	1.5	941.11						411	2.00		104.6	\$ 28.00	\$ 2,927.90	\$ 2,927.90	COMPACTED AGGREGATE (411 BERM)
																\$ 4,000.00	\$ 4,000.00	MAINTENANCE OF TRAFFIC
																\$ 962.00	\$ 962.00	BOND PREMIUM
																\$ 65,058.00	\$ 65,058.00	ROAD TOTAL

NOTICE TO BIDDERS:

DRIVEWAY APRONS AND MAILBOX APPROACHES SHALL BE MILLED AND PAVED UP TO 6 FEET FROM THE EDGE OF PAVEMENT. ESTIMATE INCLUDES MILLING OF ABUTTING JOINTS AT ALL ASPHALT & CONCRETE DRIVES, THIS WILL NOT BE A SEPARATELY PAID ITEM. THERE ARE A TOTAL OF ±29 DRIVES, QUANTITIES ON ESTIMATE WERE COMPUTED AS FOLLOWS:

TOTAL LENGTH	WIDTH	SY
870	4	387

ESTIMATE ALSO TO INCLUDE THE MILLING OF ABUTTING JOINTS AT ALL INVOLVED INTERSECTIONS. JOINTS SHALL BE THE FULL WIDTH OF PAVEMENT, 10 FEET IN LENGTH IN INTERSECTIONS, AND AT A DEPTH EQUAL TO THE DEPTH OF PROPOSED ASPHALT OVERLAYMENT.

QUANTITIES FOR DRIVES WILL BE LUMPED TOGETHER WITH ROADWAY QUANTITIES IN PROPOSAL. THEY ARE SHOWN SEPARATE IN THIS ESTIMATE SHEET FOR QUANTITY CLARITY.

DRAG COAT LISTED ABOVE SHALL BE MIXED IN A PUGMILL AT THE CONTRACTOR'S SITE. INSPECTOR SHALL BE NOTIFIED OF DATE, TIME, AND LOCATION, 48 HOUR IN ADVANCE OF MIXING. MATERIAL IS TO BE PLACED WITH A CONVENTIONAL PAVER WITH A 3/16" PER FOOT CROSS SLOPE.

448 SURFACE TYPE 1, SCRATCH COURSE LISTED ABOVE WILL BE LAID IN VARIOUS LOCATIONS TO CORRECT SEVERE CROSS-SECTIONAL SLOPE ISSUES. THE ESTIMATED AMOUNT ABOVE IS FOR ESTIMATING PURPOSES ONLY AND THE ENTIRE QUANTITY IS NOT GUARANTEED. EXACT LOCATIONS WILL BE MARKED OUT ONSITE BY THE ENGINEER AT THE TIME OF CONSTRUCTION. ESTIMATE INCLUDES 2900 LF OF LANE WIDTH SCRATCH COURSE WITH AN AVERAGE THICKNESS OF 0.50". APPROXIMATELY 2350 LF IN THE EAST BOUND LANE AND 550' IN THE WEST BOUND LANE.

PAVEMENT IS ON AN AVERAGE OF 20.0' IN WIDTH. 20.5' WAS USED FOR MATERIAL PADDING DUE TO INCONSISTENCIES IN THE CROSS-SECTIONAL SLOPE OF THE EXISTING PAVEMENT. FINISH PAVEMENT WIDTH WILL VARY SLIGHTLY.

TRAFFIC SHALL BE MAINTAINED.

SEE OTTAWA COUNTY SUPPLEMENTAL SPECIFICATIONS FOR COLD MIX AND HOT MIX.

ROAD RESURFACING 2023 - COST ESTIMATE

CARROLL TOWNSHIP - BIER ROAD (TR#97)
 ESTIMATOR: CRM
 DATE: 6/22/21

ROAD NAME	LENGTH		AREA		BITUMINOUS MATERIAL				AGGREGATE, MATERIAL OR PROCESS						REMARKS		
	MILES	LENGTH (FT)	WIDTH (FT)	SQ YDS	KINDS	APPLIED RATE	TOTAL GALLONS	UNIT COST	APPLIED COST	STONE SIZE	LBS PER SQ YD	THICKNESS (IN)	TOTAL CU YDS	TOTAL / TOTAL TONS		UNIT COST	APPLIED COST
BIER ROAD FROM BEHLMAN ROAD TO ATWATER ROAD	1075.0	4.0	478						301	4	53.1			\$ 200.00	\$ 10,617.28	\$ 10,617.28	253 - PAVEMENT REPAIR
	1.52	8040	17.5	15633	Tack	0.080	1250.7	\$ 2.20	\$ 2,751.47							\$ 2,751.47	407 - TACK COAT (SCRATCH)
	1.52	8040	17.5	15633	Tack	0.060	938	\$ 2.20	\$ 2,063.60							\$ 2,063.60	407 - TACK COAT (SURFACE)
	1.52	8040	17.5	15633	PG64-22					448-1	0.75		651.39	\$ 78.00	\$ 50,808.33	\$ 50,808.33	441 - 0.75" INTERMEDIATE, TYPE 1, PG64-22
				280	PG64-22					448-1	2.00		31.11	\$ 78.00	\$ 2,426.67	\$ 2,426.67	441 - SURFACE TYPE 1, PG64-22 (DRIVES & MAILBOX)
	1.52	8040	17.5	15633	PG64-22					448-1	1.25		1085.65	\$ 78.00	\$ 84,680.56	\$ 84,680.56	441 - 1.25" 448 SURFACE TYPE 1, PG64-22
	3.05	16080	1.5	2680						411	2		297.8	\$ 28.00	\$ 8,337.78	\$ 8,337.78	COMPACTED AGGREGATE (411 BERM)
	1.52													\$ 1,400.00	\$ 2,128.00	\$ 2,128.00	CENTER LINE, 4"
														\$ 5,000.00	\$ 5,000.00	\$ 5,000.00	614 - MAINTENANCE OF TRAFFIC
														\$ 2,533.00	\$ 2,533.00	\$ 2,533.00	103.05 - CONTRACT BOND
														\$ 171,347.00	\$ 171,347.00	\$ 171,347.00	ROAD TOTAL

NOTICE TO BIDDERS:

DRIVEWAY APRONS AND MAILBOX APPROACHES SHALL BE MILLED AND PAVED UP TO 6 FEET FROM THE EDGE OF PAVEMENT. ESTIMATE INCLUDES MILLING OF ABUTTING JOINTS AT ALL ASPHALT DRIVES. THIS WILL NOT BE A SEPARATELY PAID ITEM. THERE ARE A TOTAL OF ±28 DRIVES AND MAILBOX APPROACHES. QUANTITIES ON ESTIMATE WERE COMPUTED AS FOLLOWS:

TOTAL LENGTH WIDTH (AVG) SY
 840 3 280

QUANTITIES FOR DRIVES WILL BE LUMPED TOGETHER WITH ROADWAY QUANTITIES IN PROPOSAL. THEY ARE SHOWN SEPARATE IN THIS ESTIMATE SHEET FOR QUANTITY CLARITY.

PAVEMENT WIDTHS VARY SLIGHTLY, 17.5' IS THE AVERAGE WIDTH. 17.0' IS THE MINIMUM.

QUANTITIES ON PROPOSAL ARE SLIGHTLY HIGHER THAN ON COST ESTIMATE DUE TO ROUNDING

ROAD TO BE CLOSED DURING PAVING TO ALLOW FOR FULL WIDTH PAVING. LOCAL TRAFFIC SHALL BE MAINTAINED DURING CONSTRUCTION.

SEE SUPPLEMENTAL SPECIFICATIONS FOR ASPHALT CONCRETE PAVEMENT

THE USE OF THE ENTIRE PAVEMENT REPAIR ITEM IS NOT GUARANTEED. QUANTITIES AND LOCATIONS WILL BE DETERMINED ON SITE AFTER MILLING IS COMPLETED. THIS IS NOT GUARANTEED ITEM AND IT MAY NOT BE PERFORMED. REPAIRS WILL BE LAID OUT AT 4' IN WIDTH. NO ADDITIONAL COMPENSATION WILL BE MADE FOR A REDUCTION IN QUANTITY.



Ottawa County Sheriff's Office

Stephen J. Levorchick
Sheriff

Brad M. York
Chief Deputy

ADDRESS/PHONE/FAX

315 Madison Street, Room 110
Port Clinton, Ohio 43452
Phone (419) 734-4404
FAX (419) 732-8311
www.ottawacountysheriff.org

SHERIFF

Stephen J. Levorchick
Phone (419) 734-6877

CHIEF DEPUTY

Brad M. York
Phone (419) 734-6826

CAPTAIN OF OPERATIONS

Zach Bowling
Phone (419) 734-6827

JAIL ADMINISTRATOR

Captain Kent Davis
Full Service Facility
Phone (419) 734-6828

MSJ Facility

Phone (419) 734-6995

COMMUNICATIONS

Sergeant James Lucas
Corporal John Knecht
Phone (419) 734-4404

DIRECTOR OF ADMINISTRATION

Deputy Heather K. Moss
Phone (419) 734-6823

DIRECTOR OF FINANCE

Deputy Callie D. McConahay
Phone (419) 734-6829

CIVIL

Deputy Rhonda Reiter
Deputy Kendra Berlin
Phone (419) 734-6824

Carroll Township Trustees
Allen Township Trustees
Salem Township Trustees

August 6, 2021

Dear Trustees,

I am submitting this letter as support of your efforts to make Carroll, Salem, and Allen Townships very safe communities and a great place to raise a family.

It is my understanding that you are currently attempting to receive funding from outside grant sources to assist in your highway paving projects throughout Carroll, Salem and Allen Townships. Without those grant opportunities, all three townships would be unable to commit to making the roadways within your township as safe as you would with the funding.

Your three townships together are key farming communities within Ottawa County. As township trustees, it is obvious that you are doing everything that you can to keep the residents of your respective townships safe, at home, at work, on their farms, and in their cars.

As Sheriff of Ottawa County, I am honored to write this letter of support in your efforts to maintain the high quality of safety within Carroll, Salem and Harris Townships. Through the established partnerships that you have in place in your townships, the residents should take great pride in their community and also have a peace of mind that their township trustees are attempting to keep their community safe.

Sincerely,

Stephen J. Levorchick,
Sheriff of Ottawa County

Benton-Carroll-Salem

School District

www.bcssd.com



Board of Education Office

11685 W. State Route 163

Oak Harbor, OH 43449

Phone: (419) 898-6210

August 30, 2021

To Whom It May Concern:

I am writing this letter in strong support of Salem Township's grant application to pave Little Portage East Road. I believe that re-paving this road would greatly benefit the students and stakeholders of Benton-Carroll-Salem School District by making the road safer. Re-paving this road would also greatly benefit school bus transportation.

If you have any questions, please do not hesitate to reach out to me at (419) 898-6210.

Sincerely,

Guy L. Parmigian
Superintendent

HOME OF THE OAK HARBOR ROCKETS

Guy L. Parmigian, Ph.D.
Superintendent

Cajon H. Keeton
Treasurer



Genoa Area Local Schools

2810 N. Genoa-Clay Center Road
Genoa, Ohio 43430

Superintendent, Michael Ferguson
Treasurer, J. William Nye
Director of Business Services,
Lisa Cruickshank
Director of Curriculum/Instruction,
Courtney Cannon

Telephone: 419.855.7741
Fax: 419.855.4030
www.genoaschools.com

August 11, 2021

Allen Township Trustees

As discussed, this letter supports your efforts to apply and receive additional grants/funding to improve our township roads. Specifically, the Trustees seek funding for:

Repaving of- Walbridge EW (1 Mile)
Repaving of – EW Curtice Road (1/2 Mile)

As Superintendent of the Genoa Area Local Schools, I can confirm the need to repair, resurface and improve the roads within the community and school district. Our bus drivers, students and staff drive these roads daily and the need to resurface, widen and repair the roads is imperative to our student's safety. We appreciate your efforts for the safety and well-being of all the children who ride or drive the township roads on a daily basis. Thank you.

Regards,

Michael G. Ferguson, Superintendent
Genoa Area Local Schools

Empowering our Students to be Future Ready

Genoa Area High School
2980 N. Genoa-Clay Center Rd.
Genoa, Ohio 43430
Principal, Benjamin Ohlemacher
419.855.7741

Genoa Area Middle School
2950 N. Genoa-Clay Center Rd.
Genoa, Ohio 43430
Principal, Dir. of Transportation, Kevin Katafias
Dir. of Student Services,
Lauren Scheanwald
Director of Technology, Tom Baker
419.855.7741

Genoa Area Elementary School
2820 N. Genoa-Clay Center Rd.
Genoa, Ohio 43430
Principal, Yolanda Mies
Assistant Principal, Cody McPherson
419.855.7741



ALLEN-CLAY JOINT FIRE DISTRICT

Headquarters

3155 N. Genoa-Clay Center Rd.
Genoa, OH 43430
District Chief Michael T. Musolf

Phone: 419-855-4733
Fax: 419-855-1074

LETTER OF SUPPORT ALLEN TOWNSHIP TRUSTEES AUGUST 10, 2021

This letter is in response to the Allen Township, Ottawa County, Trustees' request for funding through the OPWC grant to resurface the following roads in Allen Township:

Walbridge Road between Martin Williston Road and Opfer-Lentz Road (1 mile)

Curtice East & West Road between Genoa-Clay Center Road and Wildacre Road (½ mile)

The Allen-Clay Joint Fire District provides fire and EMS service to all of Allen Township. As such we often use township roads and know that they require attention to make them safer for our citizens as well as provide safe and rapid emergency vehicle access to any emergencies that occur to the residents that live on or commute via these roads.

We ask that you give high consideration to this request and ultimately fund it.

Thank you!

Michael T. Musolf
District Fire Chief
Allen-Clay Joint Fire District



Carroll Township Emergency Medical & Fire Service Inc.

11080 W. Toussaint East Road Oak Harbor, Ohio 43449

MIKE MCGINNIS
Asst. E.M.S. Chief

Telephone: 419-898-9621
Fax: 419-898-0366

JOHN BROUGH
Fire Chief

LETTER OF SUPPORT CARROLL TOWNSHIP TRUSTEES AUGUST 16, 2021

This letter is in response to the Carroll Township, Ottawa County, and Trustees' request for funding through OPWC grant to resurface the following road in Carroll Township:

Bier Rd. from Behlman Rd to Atwater Rd.

The Carroll Township Emergency Medical & Fire Service provides EMS and fire service to all of Carroll Township. As such we often use this road and know that it requires attention to make it safer for our citizens as well as provide safe and rapid emergency vehicle access to any emergencies that occur to the residents that live on named road.

We ask that you give high consideration to this request and ultimately fund it.

THANK YOU!

John Brough
Fire Chief



CARROLL TOWNSHIP POLICE DEPARTMENT
11080 W. Toussaint East Rd – Oak Harbor, OH – 43449
Robert Paulsen, Chief

419-898-4906, *Dispatch*
419-898-0841, *Fax*

August 16, 2021

Carroll Township Trustees
11080 W. Toussaint East Rd.
Oak Harbor, Ohio 43449

Dear Trustees,

I am writing this letter to support your efforts to make Carroll Township as safe as possible for our residents. Carroll Township is a great community to raise a family.

I recently heard that you were attempting to receive funding from a grant to assist in paving of our township roads. In my travels one of the first items I notice is the conditions of roads, streets, or alleys. Good updated roadways are a sign of priority that a local government puts the safety of their residents. Updated roads usually disperse water off of them quickly, making any evasive driving more functional.

Carroll Township has a large influx of tourism, due to the many areas. First and foremost would be access to Lake Erie. This leads to our population expanding in the summer to over three times what we have in the winter. Clean updated roads lead to not only protecting our permanent residents but also those choosing Carroll Township for their summer fun.

As Chief of Police for Carroll Township, I am honored to write this letter in support of your efforts to maintain the high quality of safety within our township. Part of this safety is the condition of our roadways. Carroll Township residents should take great pride in their community and your efforts to their continued safety.

Sincerely,

A handwritten signature in black ink, appearing to read "R. W. Paulsen", written in a cursive style.

Robert W Paulsen
Chief of Police

**DISTRICT 5
CAPITAL IMPROVEMENT PROJECTS
QUESTIONNAIRE
ROUND 36**

Name of Applicant: Salem Township

Project Title: Little Portage East, Walbridge East, Curtice East 7 West, Bier Roads Resurfacing

The following questions are to be answered for each application submitted for State Issue II SCIP, LTIP and Loan Projects. Please provide specific information using the best documentation available to you. Justification of your responses to these questions will be required if your project is selected for funding, so please provide correct and accurate responses. **Villages and Townships under 5,000 in population should also complete the Small Government Criteria.**

1. What percentage of the project in repair A= 100 %, replacement B= %, expansion C= %, and new D= %? (Use dollar amounts of project to figure percentages and make sure the total equals one hundred(100) percent) A+B= 100 % C+D= % **ORC Reference(s):164.06(B)(1); 164.14(E)(10)**

Repair/Replacement = Repair or Replacement of public facilities owned by the government (any subdivision of the state).

New/Expansion = Replacement of privately owned wells, septic systems, private water or wastewater systems, etc.

- 2a. Existing Physical Condition of Infrastructure **ORC Reference(s):164.06(B)(2);164.14(E)(9);164.14(E)(2); 164.14(E)(8)**

Points	Category	Description	Examples
10	Failing	Infrastructure has reached a point where it requires replacement, reconstruction or reconfiguration to fulfill its purpose	-Intersection Reconfiguration due to accident problem- Structural paving of 3.5" or greater of additional pavement - Pavement Widening to meet ODOT L&D Standards - Complete Pavement Reconstruction -Water or Sewer Line Replacement - Water or Sewer Plant Replacement - Widening graded shoulder width to ODOT L&D Standard -Complete Bridge or Culvert replacement-Replacement of a major component of a water and/or sewer treatment plant which would result in a failure in meeting WQ Standards

8	Poor	The condition is substandard and requires repair or restoration in order to return to the intended level of service and comply with current design standards. Infrastructure contains deficiency and is functioning at a diminished capacity.	-Multiple course of paving - Structural Culvert Lining - Bridge Deck Replacement - Replacement of a component such as a control mechanism, pumps, hydrants, valves, filters, etc of a water or sewer plant - Single course of paving with 25% base repair-Widening graded shoulder width to less than ODOT L&D Standard
6	Fading	The condition requires reconditioning to continue to function as originally intended.	-Single course of paving -Sewer Lining Projects -Water tower painting -Repair of a tank to maintain structural integrity in existing water and sewer systems-Widening aggregate berm on existing graded shoulder width
4	Fair	The condition is average, not good or poor. The infrastructure is still functioning as originally intended. Minor deficiencies exist requiring repair to continue to function as originally intended and/or to meet current design standards	
2	Good	The condition is safe and suitable to purpose. Infrastructure is functioning as originally intended, but requires minor repairs and/or upgrades to meet current design standards	
0	Excellent	The condition is new or requires no repair. Or, no supporting documentation has been submitted	

2b. Age of Infrastructure **ORC Reference(s):164.06(B)(2)**

Life	20	30	50
Project Type	Road	Wastewater and Water Treatment	Bridge/Culvert, Sanitary Sewer, Water Supply, Storm Water, Solid Waste
Points			
0	0-4 Years	0-6 Years	0-10 Years
1	5-8 Years	7-12 Years	11-20 Years
2	9-12 Years	13-18 Years	21-30 Years
3	13-16 Years	19-24 Years	31-40 Years
4	17-20 Years	25-30 Years	41-50 Years
5	20+ Years	30+ Years	50+ Years

3. Health and Safety Rating: **ORC Reference(s):164.06(B)(4),164.14(E)(1); 164.14(E)(10)**

If the proposed project is not approved what category would best represent the impact on the general health and/or public safety?

ROADS

Extremely Critical: Resurfacing, Restoration, Rehabilitation and Reconstruction (4R) of a Major Access Road.*

Critical: Resurfacing, Restoration and Rehabilitation (3R) of a Major Access Road.*

Major: Resurfacing, Restoration, Rehabilitation and Reconstruction (4R) of a Minor Access Road.*

Moderate: Resurfacing, Restoration and Rehabilitation (3R) of a Minor Access Road.*

Minimal: Preventative Maintenance of a Major Access Road.

No Impact: Preventative Maintenance of a Minor Access Road.

Projects that have a variety of work will be scored in the LOWEST category of work contained in the Construction Estimate.

Road/Street Classifications:

Major Access Road:

Roads or streets that have a dual function of providing access to adjacent properties and providing through or connecting service between other roads.

Minor Access Road:

Roads or streets that primarily provide access to adjacent properties without through continuity, such as cul-de-sacs or loop roads or streets.

Preventative Maintenance:

Non Structural Pavement work such as chip sealing, cape sealing, micro-surfacing, crack sealing, etc.

*(3R) Resurfacing, Restoration and Rehabilitation - Improvements to existing roadways, which have as their main purpose, the restoration of the physical features (pavement, curb, guardrail, etc.) without altering the original design elements. (Surface and Intermediate layer Mill and Fills, overlays with less than or equal to 3.5" of additional pavement, etc....)

*(4R) Resurfacing, Restoration, Rehabilitation and Reconstruction - Much like 3R, except that 4R allows for the complete reconstruction of the roadway and alteration of certain design elements (i.e., lane widths, shoulder width, SSD, overlays with greater than 3.5" of additional pavement. etc.).

BRIDGES SUFFICIENCY RATING

Extremely Critical: 0-25, or a General Appraisal rating of 3 or less.

Critical: 27-50, or a General Appraisal rating of 4.

Major: 51-65 or a General Appraisal rating of 5 or 6.

- Moderate: 66-80 or a General Appraisal rating of 7.
- Minimal: 81-100 or a General Appraisal rating of more than 7.
- No Impact: Bridge on a new roadway.

WASTEWATER TREATMENT PLANTS

- Extremely Critical: Improvements required by the Environmental Protection Agency (EPA) in the form of a consent decree, finding and orders or court order, and Health Department Construction Ban.
- Critical: Improvements required by the Environmental Protection Agency (EPA) in the form of NPDES permit requirements or Notice of Violations.
- Major: Replace deficient appurtenances. Update existing processes due to EPA recommendations.
- Moderate: Increase capacity to meet current needs or update processes to improve effluent quality.
- Minimal: New/Expansion project to meet a specific development proposal.
- No Impact: New/Expansion to meet future or projected needs.

WATER TREATMENT PLANT

- Extremely Critical: EPA orders in the form of a consent decree, findings and orders or court order.
- Critical: Improvements to meet Environmental Protection Agency (EPA) Safe Drinking Water Regulations and/or Notice of Violations.
- Major: Replace deficient appurtenances. Update existing processes due to EPA recommendations.
- Moderate: Increase capacity to meet current needs or update processes to improve water quality.
- Minimal: New/Expansion project to meet a specific development proposal.
- No Impact: New/Expansion to meet future or projected needs.

COMBINED SEWER SEPARATIONS (May be construction of either new storm or sanitary sewer as long as the result is two separate sewer systems.)

- Extremely Critical: EPA orders in the form of a consent decree, findings and orders or court order. Health Department Construction Ban.
- Critical: Separate, due to chronic backup or flooding in basements.
- Major: Separate, due to documented water quality impairment, or due to EPA recommendations.
- Moderate: Separate, due to specific development proposal within or upstream of the combined system area.
- Minimal: Separate, to conform to current design standards.

No Impact: No positive health effect.

STORM SEWERS

Extremely Critical: Improvements ordered by the Environmental Protection Agency (EPA) in the form of a consent decree, findings and orders or court order.

Critical: Chronic flooding (structure damage) or improvements required by the Environmental Protection Agency (EPA) in the form of NPDES permit requirements or Notice of Violations.

Major: Inadequate capacity (land damage).

Moderate: Inadequate capacity with no associated damage.

Minimal: New/Expansion to meet current needs.

No Impact: New/Expansion to meet future or project needs.

CULVERTS

Extremely Critical: Structurally deficient or functionally obsolete. Deterioration has already caused a critical safety hazard to the public.

Critical: Inadequate capacity with land damage and the existing or high probability of property damage.

Major: Inadequate capacity (land damage).

Moderate: Inadequate capacity with no associated damage.

Minimal: New/Expansion to meet current needs.

No Impact: New/Expansion to meet future or projected needs.

SANITARY SEWERS

Extremely Critical: EPA orders in the form of a consent decree, findings and orders or court order. Health Department Construction Ban.

Critical: Replace, due to chronic pipe failure, chronic backup or flooding in basements, sewer system overflows, and/or improvements required by the Environmental Protection Agency (EPA) in the form of NPDES permit requirements or Notice of Violations.

Major: Replace, due to inadequate capacity or infiltration, or due to EPA recommendations.

Moderate: Rehabilitate to increase capacity to meet current needs or to reduce inflow and infiltration.

Minimal: New/Expansion project to meet a specific development proposal.

No Impact: New/Expansion to meet future or projected needs.

SANITARY LIFT STATIONS AND FORCE MAINS

Extremely Critical: Structurally deficient. Deterioration has already caused a safety/health hazard to

the public, or; EPA orders in the form of a consent decree, findings and orders or court order.

- Critical:** Inadequate capacity with actual or a high probability of property damage; or improvements required by the Environmental Protection Agency (EPA) in the form of NPDES permit requirements.
- Major:** EPA recommendations, or; reduces a probable health and/or safety problem.
- Moderate:** Rehabilitate to increase capacity to meet current needs.
- Minimal:** New/Expansion to meet a specific development proposal.
- No Impact:** New/Expansion to meet future or projected needs.

WATER PUMP STATIONS

- Extremely Critical:** Structurally deficient. Deterioration has already caused a safety hazard to the public, or, EPA orders in the form of a consent decree, findings and orders or court order.
- Critical:** Inadequate capacity with the inability to maintain pressure required for fire flows.
- Major:** Replace due to inadequate capacity or EPA recommendations.
- Moderate:** Rehabilitate to increase capacity to meet current needs.
- Minimal:** New/Expansion to meet a specific development proposal.
- No Impact:** New/Expansion to meet future or projected needs.

WATER LINES/WATER TOWERS

- Extremely Critical:** Replace to solve low potable water pressure or excessive incidents of main breaks in project area.
- Critical:** Replacement/Rehabilitation due to structural deficiency such as excessive corrosion and/or safety upgrades, etc.
- Major:** Replace undersized water mains as part of an overall upgrade process. Replace water meters that have exceeded their useful life.
- Moderate:** Increase capacity to meet current needs. Spot repairs/recoating to restore moderate corrosion of water components.
- Minimal:** New/Expansion project to meet a specific development proposal.
- No Impact:** New/Expansion to meet future or projected needs.

OTHER

- Extremely Critical: There is a present health and/or safety threat.
- Critical: The project will provide immediate health and/or safety benefit.
- Major: The project will reduce a probable health and/or safety problem.
- Moderate: The project will delay a health and/or safety problem.
- Minimal: A possible future health and/or safety problem mitigation.
- No Impact: No health and/or safety effect.

NOTE: Combined projects that can be rated in more than one subset may be rated in the other category at the discretion of the District 5 Executive Committee. In general, the majority of the cost or scope of the project shall determine the category under which the project will be scored.

(Submittals without supporting documentation will receive 0 Points for this question.)

Extremely Critical ____, Critical X, Major ____, Moderate ____, Minimal ____, No Impact ____. Explain your answer.

(Additional narrative, charts and/or pictures should be attached to questionnaire)

4. Identify the amount of local funds that will be used on the project as a percentage of the total project cost. **ORC Reference 164.06(B)(6); ORC 164.06(B)(7); ORC 164.06(B)(3); ORC 164.14(E)(4)**

A.) Amount of Local Funds = \$ 258,890.00

B.) Total Project Cost = \$ 517,390.00

RATIO OF LOCAL FUNDS DIVIDED by TOTAL PROJECT COSTS (A/B)= 50 %

Note: Local funds should be considered funds derived from the applicant budget or loans funds to be paid back through local budget, assessments, rates or tax revenues collected by the applicant.

5. Identify the amount of other funding sources to be used on the project, excluding SCIP or LTIP Funds, as a percentage of the total project cost. **ORC Reference(s): 164.06(B)(7); 164.14(E)(4)**

Grants __% Gifts __%, Contributions __%

Other __% (explain) _____ , Total 0 %

Note: Grant funds and other revenues not contributed or collected through taxes by the applicant should be considered other funds. The Scope of Work for each Funding Source must be the same.

6. Total Amount of SCIP and Loan Funding Requested- An Applicant can request a grant per the categories below for points as indicated on the Priority Rating Sheet. If the Applicant is including a loan

request equal to, but not exceeding 50% of the OPWC funding amounts listed below, there will be no point penalty. If loan funds requested are more than 50%, points as listed in the Priority Rating Sheet will apply. **ORC Reference(s):164.14(E)(10);164.06(B)(5)**

_____	\$500,001 or More
_____	\$400,001-\$500,000
_____	\$325,001-\$400,000
_____	\$275,001-\$325,000
<u> X </u>	\$175,001-\$275,000
_____	\$175,000 or Less

There are times when the District spends all of the grant money and has loan money remaining. When this happens, the district makes a loan offer in the amount of the requested grant to the communities that were not funded. The offers are made in the order of scoring. We need to know if you are not successful in obtaining grant dollars for your project if you would be interested in loan money:

YES NO X .

(This will only be considered if you are not funded with grant money and there is remaining loan money.) **Please note: if you answer “no” you will not be contacted, only if you answer “yes” will an offer be made in the event that there is loan money remaining.**

7. If the proposed project is funded, will its completion directly result in the creation of permanent full-time equivalent (FTE) jobs (FTE jobs shall be defined as 36 hours/week) ? Yes No X . If yes, how many jobs within eighteen months? Will the completed project retain jobs that would otherwise be permanently lost? Yes No X . If yes, how many jobs **will be created/retrained** within 18 months **following the completion of the improvements?**

ORC Reference(s): 164.14(E)(3);164.14(E)(10)

(Supporting documentation in the form of letter from affected industrial or commercial enterprises that specify full time equivalent jobs that will be retained or created directly by the installation or improvement of Public infrastructure. Additional items such as; 1) newspaper articles or other media news accounts, 2) public meeting minutes, and/or 3) a letter from the County Economic Development Director or State of Ohio Economic Development Professional that alludes to the requirement for the infrastructure improvement to support the business. Submittals without supporting documentation will receive 0 points for this question.)

8. What is the total number of existing users that will directly benefit from the proposed project if completed? 1,036 Average Daily Traffic Count (Use households served, traffic counts, etc. and explain the basis by which you arrived at your number.) **_ORC Reference 164.14(E)(7); 164.06(B)(10)**

9. Economic Distress Criteria **ORC Reference 164.06(B)(8)**

What is the Local Median Household Income as a percentage of the District Median Household Income?

144.48 %. Please utilize the Economic Distress Scoring Criteria based on ACS 2013-2017 Data provided in Exhibit A.

10. Readiness to Proceed Criteria **ORC Reference 164.06(B)(9); ORC 164.14(E)(5)**

Please categorize the status of planning and design elements for the project.

 Plans have not begun yet (0 Points)

 Preliminary Engineering Complete (1 Point)

 X Final Design Complete (2 Points)

11. Base Score Total for Questions 1-10= 89

12. County Subcommittee Priority Points=

(25-20-15 Points for each of the SCIP and LTIP Project Categories)

13. DISCRETIONARY POINTS (BY DISTRICT COMMITTEE ONLY)

13a. A **District Discretionary Point** may be awarded to projects that demonstrate significant Area-wide, County, or Community Impact. (Include documentation to support the claim of significance) (Maximum of 1 Point at the discretion of the District Executive Committee) _____

ORC Reference 164.14(E)(7)

13b. A **District Discretionary Point** may be awarded to projects that demonstrate that the entity has maximized local financial resources including assessments. Provide a Fund Status Report and/or the water and sanitary waste utility rate structures are at least 2.5% of area median household income for combined systems and 1.5% of the area median household income for water and sanitary only systems. Please provide rate ordinances for water and sanitary sewer to be considered for discretionary points. (Maximum of 1 Point at the discretion of the District 5 Executive Committee) _____ **ORC Reference 164.06(B)(3)**

14. **Grand Total of Points** _____

15. Is subdivision's population less than 5,000 Yes No ___ If yes, continue. You may want to design your project per Small Government Project Evaluation Criteria, released for the current OPWC Round to assist in evaluating your project for potential Small Government Funding. The Small Government Criteria is available on the OPWC website at

<https://www.pwc.ohio.gov/Portals/0/Data/SmallGovernment%20Round%2036%20Methodology.pdf?ver=2019-08-07-071749-143>

16. **OHIO PUBLIC WORKS COMMISSION SMALL GOVERNMENT PROGRAM GUIDELINES**

All projects that are sponsored by a subdivision with a population of 5,000 or less, and not earning enough points for District Funding from SCIP or LTIP Funds, are then rated using the Small Government Program Rating Criteria for the corresponding funding round. In order to be rated the entity must submit the Small Government Supplement and their required budgets with their application.

Only infrastructure that is village- or township- owned is eligible for assistance. The following policies have been adopted by the Small Government Commission:

- District Integrating Committees may submit up to seven (7) applications for consideration by the Commission. All 7 must be ranked, however, only the top five (5) will be scored. The remaining two (2) will be held as contingency projects should an application be withdrawn.
- Grants are limited to \$500,000. Any assistance above that amount must be in the form of a loan.
- Grants for new or expanded infrastructure cannot exceed 50% of the project estimate.
- The Commission may deny funding for water and sewer systems that are deemed to be more cost-effective if regionalized.
- If a water or sewer project is determined to be affordable, the project will be offered a loan rather than

a grant. Pay special attention to the **Water & Wastewater Affordability Supplemental** and the **Small Government Water & Wastewater Affordability Calculation Worksheet**. Both are available on the **Small Government Program Tab** at <https://www.pwc.ohio.gov/Programs/Infrastructure-Programs/Small-Government>

- Should there be more projects that meet the “annual score” than there is funding, the tie breaker is those projects which scored highest under Health & Safety, with the second tie breaker being Condition. If multiple projects have equivalent Health & Safety and Condition scores they are arranged according to the amount of assistance from low to high. Once the funded projects are announced, “contingency projects” may be funded from project under-runs by continuing down the approved project list.

- Supplemental assistance is not provided to projects previously funded by the Commission.

- Applicants have 30 days from receipt of application by OPWC without exception to provide additional documentation to make the application more competitive under the Small Government criteria. Applications will be scored after the 30-day period has expired. The applicants for each District's two (2) contingency projects will have the same 30-day period to submit supplemental information but these applications will not be scored unless necessary to do so. **It is each applicant's responsibility for determining the need for supplemental material. The applicant will not be asked for or notified of missing information unless the Commission has changed the project type and it affects the documentation required. Important information may include, but is not limited to: age of infrastructure, traffic counts or utility users, median income information, user rates ordinances, and the Auditor's Certificate of Estimated Revenues or documentation from the Auditor of State that subdivision is in a state of fiscal emergency.**

If you desire to have your Round 36 project considered for Small Government Funding please download the Small Government Evaluation Criteria applicable to Round 36 by accessing the OPWC Website at

<https://www.pwc.ohio.gov/Portals/0/Data/SmallGovernment%20Round%2036%20Methodology.pdf?ver=2019-08-07-071749-143>. Please follow the Small Government Evaluation Criteria and

include supporting documentation to receive points. Specifically, include the Auditor's Certification of funds for your entity and documentation supporting the age of the infrastructure.

Please complete the Small Government Evaluation Criteria and attach all required supporting documentation and attach it to the District 5 Questionnaire for Round 36.

Date: 09-07-2021
Signature: Richard Lenke
Title: Richard Lenke Salem Township Trustee
Address: P. O. Box 417 Oak Harbor, Ohio 43449
Phone: (419) 898-4576
FAX: (419) 898-4126
Email: LenkeFarms@outlook.com

District 5
Capital Improvement Project
Priority Rating Sheet, Round 36

Revised 06/29/2021

COUNTY:	Ottawa	PROJECT NUMBER:
PROJECT:	Little Portage E, Walbridge E, Curtice E & W and Bier Roads Resurfacing	
EST. COST:	\$517,390	

No.	"A" WEIGHT FACTOR	CRITERIA TO BE CONSIDERED	"B" PRIORITY FACTORS					"A" x "B"	PRIORITY FACTORS						No.
			0	2	4	6	8		10	0	2	4	6	8	
1	1	(REPAIR OR REPLACE) vs. (NEW OR EXPANSION)						10	0% +	20% +	40% +	60%+	80%+	100%+	1
2A	1	EXISTING PHYSICAL CONDITION <small>Please refer to Criteria #2 of the Round 36 Scoring Methodology. Must submit substantiating documentation. (100% New or Expansion = 0 Points)</small>						8	Excellent	Good	Fair	Fading	Poor	Failing	2A
2B	1	AGE						5	Type						2B
									Road	0-4 Yrs	5-8 Yrs	9-12 Yrs	13-16 Yrs	17-20 Yrs	20+ Yrs
									Wastewater	0-6 Yrs	7-12 Yrs	13-18 Yrs	19-24 Yrs	25-30 Yrs	30+ Yrs
									Bridge/Culvert, Sanitary Sewer, Water Supply, Storm Water, Solid Waste	0-10 Yrs	11-20 Yrs	21-30 Yrs	31-40 Yrs	41-50 Yrs	50+ Yrs
3	2	PUBLIC HEALTH AND/OR SAFETY CONCERNS <small>Submittals without supporting documentation will receive 0 points for this question.</small>						16	No Impact	Minimal	Moderate	Major	Critical	Extremely Critical	3
4	2	LOCAL MATCHING FUNDS <small>Percentage of Local Share (Local funds are funds derived from the applicant budget or a loan to be paid back through the applicant budget, assessments, rates or tax revenues) *</small>						20	0%	10%	20%	30%	40%	50%	4
5	1	OTHER FUNDING <small>(Excluding Issue II Funds) (Grants and other revenues not contributed or collected through taxes by the applicant, including Gifts, Contributions, etc. - must submit copy of award or status letter.)</small>						0	0%	10%	20%	30%	40%	50%	5
6	2	OPWC GRANT AND LOAN FUNDS REQUESTED <small>Please refer to Criteria #6 of the Round 36 Methodology for clarification.</small>						18	-9	-8	0	8	9	10	6
		Grant or Loan Only							\$500,001 or more	\$400,001 to \$500,000	\$325,001 to \$400,000	\$275,001 to \$325,000	\$175,001 to \$275,000	\$175,000 or less	6
		Grant/Loan Combination							\$750,000 or more	\$600,001 to \$750,000	\$487,501 to \$600,000	\$412,501 to \$487,500	\$262,501 to \$412,500	\$262,500 or less	6
When scoring a project that is only grant or only loan. Please use the chart labeled "Grant or Loan Only". When scoring a grant/loan combination, score the project for the grant in the first chart, then use the second chart labeled "Grant/Loan Combination" to score the total (grant and loan combined). Use the lower of the two as the score.															
7	1	JOB CREATION/RETENTION <small>Indicate full time equivalent jobs, include supporting documentation in the form of a commitment letter from business or third party entity.</small>						0	0-6 Jobs	7-14 Jobs	15-24 Jobs	25+ Jobs			7
8	1	BENEFIT TO EXISTING USERS <small>(households or traffic counts) Equivalent dwelling unit direct connections. Traffic Counts within three years with certified documentation, etc.</small>						10	0 -99 Users	100 - 349 Users	350 - 499 Users	500 - 749 Users	750 - 1000 Users	1000+ Users	8
9	1	ECONOMIC DISTRESS <small>Local MHI as a percentage of the District Median MHI</small>						0	100%+	80%-100%	Less Than 80%				9
10	1	READINESS TO PROCEED						2	Plans Not Begun Yet	Preliminary Engineering Complete	Final Design Complete				10
11		SUBTOTAL RANKING POINTS (MAX. = 115)						89	Other Info: Does this project have a significant impact on productive farmland? YES NO Attach impact statement if yes. Is the Applicant ready to proceed to bids after State Approval within 6 months? YES NO						
12		COUNTY SUBCOMMITTEE PRIORITY POINTS (25-20-15)													
13A		DISCRETIONARY POINTS (BY DISTRICT ONLY) (MAX.=1)							District Discretionary Point may be awarded to projects that demonstrate significant Area-wide, County, or Community Impact. Include documentation to support the claim of significance.						
13B		DISCRETIONARY POINTS (BY DISTRICT ONLY) (MAX.=1)							District Discretionary Point may be awarded to projects that demonstrate that the entity has maximized financial resources including assessments and utility rate structure.						
14		GRAND TOTAL RANKING POINTS													

* Applicants must certify local and other share contributions. Specify, all funding sources to be utilized as local share at the time of application submittal.



Ohio Public Works Commission

Small Government
Capital Improvements Program

FY 23 / Round 36 Methodology - Rating Scales
(July 1, 2021 Agreement Release)

Approved May 13, 2021

Ohio Public Works Commission
65 East State Street, Suite 312
Columbus, Ohio 43215
<http://www.pwc.ohio.gov>

Complete and compliant support documentation must be provided for a criterion to be awarded points. See Applicant Manual for more information.

1. Ability and Effort of the Applicant to Finance the Project (Maximum 10 points)

A. Roads, Bridges/Culverts, Storm Water, Solid Waste Projects Only – “Auditor’s Certificate of Estimated Resources” showing fund detail, as provided in ORC sections 5705.35 and 5705.36 is used to determine potential financial resources available for the project. Score is based on the project’s total cost as a percentage of financial resources.

- 0 Total project cost represents 0 to 20% of subdivision's total combined funds legally eligible for infrastructure type
- 2 Total project cost represents 21 to 40% of subdivision's total combined funds legally eligible for infrastructure type
- 4 Total project cost represents 41 to 60% of subdivision's total combined funds legally eligible for infrastructure type
- 6 Total project cost represents 61 to 80% of subdivision's total combined funds legally eligible for infrastructure type
- 8 Total project cost represents 81 to 100% of subdivision's total combined funds legally eligible for infrastructure type
- 10 Total project cost exceeds 100% of subdivision's total combined funds legally eligible for infrastructure type, or subdivision is in fiscal emergency

B. Water and Wastewater Projects Only – Determined by SG Administrator according to the Water & Wastewater Ability & Effort calculation described in Applicants Manual. Information is obtained from both water and wastewater rate ordinances, Small Government Water & Wastewater Ability & Effort Supplemental, and data from the *U.S. Census Bureau*. Points are provided for the hours worked to pay for water and wastewater services according to the highest of two variances as a percentage above or below State Averages: weighted average of household income or percentage of households making less than \$25,000.

- 0 More than 50% above state average
- 2 25.1% - 50% above state average
- 4 0 - 25% above state average
- 6 0.1% - 25% below state average
- 8 25.1% to 50% below state average
- 10 More than 50% below state average

2. Importance of Project to Health and Safety of Citizens – Score is assigned according to the application project description and any pertinent supplemental documentation. (Maximum 10 points)

A. Road, Bridge, Culvert

- 0 New infrastructure to meet future or projected needs
- 2 New infrastructure to meet current needs; Roadway surface paving less than 2 inches; Bridges with General Appraisal of 6 or above or with a Sufficiency Rating of 81-100

- 4 Roadway surface paving equal to or greater than 2 inches with/without milling; Replace or install signal where warranted; Bridges with a General Appraisal of 5 or Sufficiency Rating of 66-80; Culvert replacement with no associated damage
- 6 Road widening to add paved shoulders or for safe passage, and/or roadway paving with full-depth base repair equal to or greater than 5% of roadway surface area; Intersection improvement to add turn lanes or realignment; Bridges with a General Appraisal of 4 or Sufficiency Rating of 51-65; Culverts with inadequate flow capacity
- 8 Complete roadway full-depth reconstruction (includes removal/replacement of base) or reclamation with/without drainage; Widening to add travel lanes; Intersection improvements to address excessive accident rate and/or inadequate level of service with Crash Reduction Factor ($0.0 < CRF < 0.2$); Bridges with a General Appraisal of 3 or Sufficiency Rating of 26-50; Culverts with inadequate flow capacity and property damage (i.e. flooding)
- 10 Complete roadway reconstruction or reclamation with/without drainage with widening to add travel lanes; Intersection improvement to address excessive accident rate and/or inadequate level of service with Crash Reduction Factor ($CRF \geq 0.2$); Bridges with General Appraisal of 2 or less, or Sufficiency Rating of less than 26; Culverts that are structurally deficient

B. Water, Wastewater, Storm Water, Solid Waste

- 0 Infrastructure to meet future or projected needs
- 2 Expanded infrastructure to meet specific development proposal
- 4 Infrastructure to meet current needs; Update processes to improve effluent or water quality; To remain in compliance with permit due to increased standards; Increase storm sewer capacity in which there is no associated land damage; Increase sanitary sewer capacity; Replace water meters as part of an upgrade
- 6 OEPA recommendations; District health board recommendations; Increase storm sewer capacity that has associated land damage; Replace undersized waterlines as part of upgrade; Install new meters or replace meters that have exceeded useful life
- 8 Replacement of storm or sanitary sewers due to chronic flooding, back-up, or property damage; Inflow and/or Infiltration; Inadequate capacity to maintain pressure required for fire flows; Replacement of waterlines or towers due to excessive corrosion
- 10 OEPA Findings & Orders, OEPA orders contained in permit, Consent Decree or Court Order; Structural separations (CSOs) Age and Condition of System to be repaired or replaced. This is a two-part criterion. (Maximum 10 points)

3. Age & Condition of System to be repaired or replaced

Part I – Age: This uses provided documentation for existing infrastructure. Documentation pertains to source documentation or from a compliant letter written by an eligible local official who can vouch for the time period during his/her term in office. If no documentation the default score is 1 point. (Maximum 5 points)

Life	20	30	50
Project Type	Road	Wastewater	Bridge/Culvert. Sanitary Sewer, Water, Storm Water, Solid Waste
Points			
0	New / Expansion	New / Expansion	New / Expansion
1	2016-2021	2013-2021	2006-2021
2	2011-2015	2006-2012	1995-2005
3	2006-2010	1998-2005	1983-1994
4	2001-2005	1991-1997	1971-1982
5	2000 or before	1990 or before	1970 or before

Part II – Condition (Maximum 5 points)

- 1 New/Expansion: New or expansion project components represent at least 50% of improvements
- 2 Expansion: New or expansion project components represent between 25% and 49% of improvements
- 3 Poor: Infrastructure requires repair to continue functioning as originally intended and/or upgrade to meet current design standards.
- 4 Critical: Infrastructure requires replacement to continue functioning as originally intended.
- 5 Failed: Not functioning

4. Leveraging Ratio – Local and all non-OPWC funding sources as a percentage of total funding. (Maximum 10 points)

	Repair/Replacement (Poor/Critical/Failed in Criterion 3)	New/Expansion (New/Expansion &/or Expansion in Criterion 3)
0	10 or less	50 or less
1	11-15	51-55
2	16-20	56-60
3	21-25	61-65
4	26-30	66-70
5	31-35	71-75
6	36-40	76-80
7	41-45	81-85
8	46-50	86-90
9	51-55	91-95
10	56 or more	96 or more

5. **Population Benefit** – Number of those to benefit directly from the improvement as a percentage of applicant’s total population. (Maximum 5 points)

- 0 10% or less
- 1 25% - 11%
- 2 35% - 26%
- 3 45% - 36%
- 4 55% - 46%
- 5 56% or more

6. **District Priority Ranking as provided by District** (Maximum 10 points)

- 6 5th ranked district project
- 7 4th ranked district project
- 8 3rd ranked district project
- 9 2nd ranked district project
- 10 1st ranked district project

7. **Amount of OPWC funding requested** (Maximum 10 points)

- 0 \$500,000 or more
- 5 \$250,000 - \$499,999
- 10 249,999 or less

8. **Loan Request as a percentage of OPWC assistance** (Maximum 10 points)

- 1 15 - 29% of OPWC assistance
- 5 30 - 49% of OPWC assistance
- 10 50 - 100% of OPWC assistance

9. **Useful Life of Project** – Taken from engineer’s useful life statement. (Maximum 5 points)

- 1 7 - 9 years
- 2 10 - 14 years
- 3 15 - 19 years
- 4 20 - 24 years
- 5 25 years or more

10. **Median Household Income** – Applicant’s MHI as a percentage of the statewide MHI. Information derived from the most recent 5-year American Community Survey as published by the Ohio Development Services Agency. (Maximum 10 points)

- 2 110% or more
- 4 100% - 109%
- 6 90% - 99%
- 8 80% – 89%
- 10 79% or less

11. Readiness to Proceed (Maximum 10 points)

Part I – Status of Plans – This uses the Small Government Commission’s Engineer’s Plan Status Certification. (Maximum 5 points)

- 0 Plans not yet begun
- 2 Surveying through Preliminary Design Completed (Items A-C)
- 5 Surveying through final construction plans, and secured permits and right-of-way as appropriate (Items A-H)

Part II – Status of Funding Sources – This uses source documentation including CFO certifications and loan letters. (Maximum 5 points)

- 0 All funds not yet committed
- 3 Applications submitted to funding entities
- 5 All funding committed

AMENDED OFFICIAL CERTIFICATE OF ESTIMATED RESOURCES

Office of Budget Commission, OTTAWA County, Ohio
 PORT CLINTON, Ohio, January 4, 2021

To the TAXING AUTHORITY of SALEM TOWNSHIP

The following is the amended official certificate of estimated resources for the fiscal year beginning January 1, 2021, as revised by the Budget Commission of said County, which shall govern the total appropriations made at any time during such fiscal year:

FUND	Unencumbered Balance Jan. 1st, 2021	Taxes	Other Sources	Total
General Fund	\$ 236,145.29	\$ 79,700.00	\$ -	\$ 315,845.29
Special Revenue Funds	\$ 816,790.93	\$ 314,600.00	\$ 177,700.00	\$ 1,309,090.93
Debt Service Funds	\$ -	\$ -	\$ -	\$ -
Capital Projects Funds	\$ -	\$ -	\$ -	\$ -
Special Assessment Funds	\$ -	\$ -	\$ -	\$ -
Enterprise Funds	\$ -	\$ -	\$ -	\$ -
Internal Service Funds	\$ -	\$ -	\$ -	\$ -
Fiduciary Funds	\$ -	\$ -	\$ -	\$ -
TOTAL	\$ 1,052,936.22	\$ 394,300.00	\$ 177,700.00	\$ 1,624,936.22







 Ottawa County Budget Commission

FUND	Unencumbered Balance Jan. 1st, 2021	Taxes	Other Sources	Total
Special Revenue Funds				
MVL Tax Fund	\$ 60,078.32	\$ -	\$ 13,000.00	\$ 73,078.32
Gasoline Tax Fund	\$ 173,190.78	\$ -	\$ 125,000.00	\$ 298,190.78
Road and Bridge Fund	\$ 382,070.28	\$ 220,400.00	\$ -	\$ 602,470.28
Cemetery	\$ 82,256.24	\$ 94,200.00	\$ 20,000.00	\$ 196,456.24
Permissive Tax	\$ 113,291.02	\$ -	\$ 19,700.00	\$ 132,991.02
Fire District		\$ -	\$ -	\$ -
Coronavirus Relief Fund	\$ 5,904.29	\$ -	\$ -	\$ 5,904.29
TOTAL SPECIAL REVENUE	\$ 816,790.93	\$ 314,600.00	\$ 177,700.00	\$ 1,309,090.93
Debt Service Funds				
	\$ -		\$ -	\$ -
TOTAL DEBT SERVICE	\$ -	\$ -	\$ -	\$ -
Capital Project Funds				
				\$ -
TOTAL CAPITAL PROJECT	\$ -	\$ -	\$ -	\$ -
Special Assessment Funds				
				\$ -
TOTAL SPECIAL ASSESSMENT	\$ -	\$ -	\$ -	\$ -

FUND	Unencumbered Balance Jan. 1st, 2021	Taxes	Other Sources	Total
Enterprise Funds				
				\$ -
				\$ -
TOTAL ENTERPRISE FUND	\$ -	\$ -	\$ -	\$ -
Internal Service Funds				
				\$ -
				\$ -
TOTAL INTERNAL SERVICE	\$ -	\$ -	\$ -	\$ -
Fiduciary Funds				
				\$ -
				\$ -
TOTAL FIDUCIARY FUNDS	\$ -	\$ -	\$ -	\$ -

AMENDED OFFICIAL CERTIFICATE OF ESTIMATED RESOURCES

Office of Budget Commission, OTTAWA County, Ohio
 PORT CLINTON, Ohio, January 4, 2021

To the TAXING AUTHORITY of ALLEN TOWNSHIP

The following is the amended official certificate of estimated resources for the fiscal year beginning January 1, 2021, as revised by the Budget Commission of said County, which shall govern the total appropriations made at any time during such fiscal year:

FUND	Unencumbered Balance Jan. 1st, 2021	Taxes	Other Sources	Total
General Fund	\$ 161,397.57	\$ 222,620.00	\$ 93,735.00	\$ 477,752.57
Special Revenue Funds	\$ 460,340.37	\$ 270,800.00	\$ 262,045.00	\$ 993,185.37
Debt Service Funds	\$ -	\$ -	\$ -	\$ -
Capital Projects Funds	\$ -	\$ -	\$ 48,000.00	\$ 48,000.00
Special Assessment Funds	\$ 43,721.64	\$ -	\$ 30,660.00	\$ 74,381.64
Enterprise Funds	\$ -	\$ -	\$ -	\$ -
Internal Service Funds	\$ -	\$ -	\$ -	\$ -
Fiduciary Funds	\$ -	\$ -	\$ -	\$ -
TOTAL	\$ 665,459.58	\$ 493,420.00	\$ 434,440.00	\$ 1,593,319.58



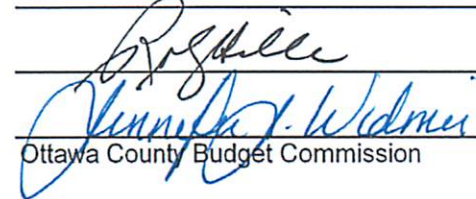

Ottawa County Budget Commission

FUND	Unencumbered Balance Jan. 1st, 2021	Taxes	Other Sources	Total
Special Revenue Funds				
2011 MVL Tax Fund	\$ 50,644.52	\$ -	\$ 51,115.00	\$ 101,759.52
2021 Gasoline Tax Fund	\$ 55,424.15	\$ -	\$ 152,130.00	\$ 207,554.15
2031 Road and Bridge Fund	\$ 151,616.43	\$ 178,200.00	\$ 25,000.00	\$ 354,816.43
2041 Cemetery Fund	\$ 38,857.29	\$ 36,500.00	\$ 26,500.00	\$ 101,857.29
2081 Police District Fund	\$ 163,797.98	\$ 56,100.00	\$ 7,300.00	\$ 227,197.98
2111 Fire District Fund	\$ -	\$ -		\$ -
TOTAL SPECIAL REVENUE	\$ 460,340.37	\$ 270,800.00	\$ 262,045.00	\$ 993,185.37
Debt Service Funds				
3901 Note Retirement	\$ -		\$ -	\$ -
	\$ -		\$ -	\$ -
TOTAL DEBT SERVICE	\$ -	\$ -	\$ -	\$ -
Capital Project Funds				
OPWC LOAN	\$ -	\$ -	\$ 48,000.00	\$ 48,000.00
OPWC GRANT	\$ -	\$ -	\$ -	\$ -
4901 Issue II	\$ -	\$ -	\$ -	\$ -
Capital Project Funds	\$ -		\$ -	\$ -
TOTAL CAPITAL PROJECT	\$ -	\$ -	\$ 48,000.00	\$ 48,000.00
Special Assessment Funds				
Curtice Lighting	\$ 1,065.15	\$ -	\$ 3,900.00	\$ 4,965.15
Williston Lighting	\$ 15,875.04	\$ -	\$ 5,600.00	\$ 21,475.04
Wildflower Plat I	\$ 8,927.50	\$ -	\$ 2,500.00	\$ 11,427.50
Wildflower Plat II	\$ 6,310.45	\$ -	\$ 3,500.00	\$ 9,810.45
Wildflower Plat III	\$ 3,254.94	\$ -	\$ 3,360.00	\$ 6,614.94
Wildflower Plat IV	\$ 758.80	\$ -	\$ 3,120.00	\$ 3,878.80
Wildflower Plat V & VI	\$ 7,529.76	\$ -	\$ 8,680.00	\$ 16,209.76
Allen Twp. Cleanup	\$ -	\$ -	\$ -	\$ -
TOTAL SPECIAL ASSESSMENT	\$ 43,721.64	\$ -	\$ 30,660.00	\$ 74,381.64

FUND	Unencumbered Balance Jan. 1st, 2021	Taxes	Other Sources	Total
Enterprise Funds				
				\$ -
				\$ -
TOTAL ENTERPRISE FUND	\$ -	\$ -	\$ -	\$ -
Internal Service Funds				
Unclaimed	\$ -			\$ -
				\$ -
TOTAL INTERNAL SERVICE	\$ -	\$ -	\$ -	\$ -
Fiduciary Funds				
				\$ -
TOTAL FIDUCIARY FUNDS	\$ -	\$ -	\$ -	\$ -

**Certificate of County Auditor That the Total Appropriations from Each
Fund**

Do Not Exceed the Official Estimate of Resources

Rev. Code, Section 5705.39

County Auditor's Office, Ottawa County, Ohio, Port Clinton, Ohio, January 15, 2021

Carroll Township

I, Jennifer J. Widmer, County Auditor of Ottawa County, Ohio, do hereby certify the total appropriations from each fund taken together with all other outstanding appropriations, **does not** exceed the last amended official estimate of resources for the fiscal year beginning January 1st, 2021, as determined by the Budget Commission of said county.



County Auditor, Ottawa County, Ohio

AMENDED OFFICIAL CERTIFICATE OF ESTIMATED RESOURCES

Office of Budget Commission, OTTAWA County, Ohio
 PORT CLINTON, Ohio, January 15, 2021

To the TAXING AUTHORITY of CARROLL TOWNSHIP

The following is the amended official certificate of estimated resources for the fiscal year beginning January 1, 2021, as revised by the Budget Commission of said County, which shall govern the total appropriations made at any time during such fiscal year:

FUND	Unencumbered Balance Jan. 1st, 2021	Taxes	Other Sources	Total
General Fund	\$ 2,087,912.00	\$ 605,900.00	\$ 661,600.00	\$ 3,355,412.00
Special Revenue Funds	\$ 1,466,858.00	\$ 605,400.00	\$ 500,700.00	\$ 2,572,958.00
Debt Service Funds	\$ -	\$ -	\$ -	\$ -
Capital Projects Funds	\$ 351,976.00	\$ -	\$ 126,000.00	\$ 477,976.00
Special Assessment Funds	\$ -	\$ -	\$ -	\$ -
Enterprise Funds	\$ -	\$ -	\$ -	\$ -
Internal Service Funds	\$ -	\$ -	\$ -	\$ -
Fiduciary Funds	\$ -	\$ -	\$ -	\$ -
TOTAL	\$ 3,906,746.00	\$ 1,211,300.00	\$ 1,288,300.00	\$ 6,406,346.00







 Ottawa County Budget Commission

FUND	Unencumbered Balance Jan. 1st, 2021	Taxes	Other Sources	Total
Special Revenue Funds				
MVL	\$ 82,454.00	\$ -	\$ 25,500.00	\$ 107,954.00
Gasoline Tax Fund	\$ 277,551.00	\$ -	\$ 105,000.00	\$ 382,551.00
Road and Bridge Fund	\$ 697,197.00	\$ 201,900.00	\$ 253,100.00	\$ 1,152,197.00
Cemetery Fund	\$ 13,140.00	\$ -	\$ 5,500.00	\$ 18,640.00
Dock Tax Toussaint	\$ 17,684.00	\$ -	\$ 6,000.00	\$ 23,684.00
Dock Tax Turtle Creek	\$ 47,625.00	\$ -	\$ 2,000.00	\$ 49,625.00
Locust Point Cemetery	\$ 9,430.00	\$ -	\$ -	\$ 9,430.00
Fire and Rescue, Amb. and EMS	\$ 57,784.00	\$ -	\$ 50,000.00	\$ 107,784.00
Police Levy	\$ 263,993.00	\$ 403,500.00	\$ 53,600.00	\$ 721,093.00
TOTAL SPECIAL REVENUE	\$ 1,466,858.00	\$ 605,400.00	\$ 500,700.00	\$ 2,572,958.00
Debt Service Funds				
Note Retirement	\$ -		\$ -	\$ -
TOTAL DEBT SERVICE	\$ -	\$ -	\$ -	\$ -
Capital Project Funds				
Permanent Improvement	\$ 283,102.00		\$ 1,000.00	\$ 284,102.00
Public Works-Project Beir	\$ -	\$ -	\$ -	\$ -
Misc. Capital Projects	\$ 68,874.00	\$ -	\$ 125,000.00	\$ 193,874.00
TOTAL CAPITAL PROJECT	\$ 351,976.00	\$ -	\$ 126,000.00	\$ 477,976.00
Special Assessment Funds				
				\$ -
				\$ -
TOTAL SPECIAL ASSESSMENT	\$ -	\$ -	\$ -	\$ -

FUND	Unencumbered Balance Jan. 1st, 2021	Taxes	Other Sources	Total
Enterprise Funds				
				\$ -
				\$ -
TOTAL ENTERPRISE FUND	\$ -	\$ -	\$ -	\$ -
Internal Service Funds				
				\$ -
				\$ -
TOTAL INTERNAL SERVICE	\$ -	\$ -	\$ -	\$ -
Fiduciary Funds				
Rupp Memorial Fund				\$ -
				\$ -
TOTAL FIDUCIARY FUNDS	\$ -	\$ -	\$ -	\$ -

**Small Government Commission
Engineer's Plan Status Certification
Required for Criterion No. 11, Part I**

Applicant: Salem Township

District No.: 5

Project Name: Little Portage E, Walbridge E, Curtice E & W and Bier Roads Resurfacing

Item	Necessary for project?	Status	Completion Date
Met Completion dates for Items A - C (2 points)			
A	Surveying	Y <input type="checkbox"/> N/A <input checked="" type="checkbox"/>	
B	R/W Acquisition Identified	Y <input type="checkbox"/> N/A <input checked="" type="checkbox"/>	
C	Preliminary Design	Y <input type="checkbox"/> N/A <input checked="" type="checkbox"/>	
Met Completion dates for Items A - H (5 points)			
D	Final Construction Plans	Y <input type="checkbox"/> N/A <input checked="" type="checkbox"/>	
E	Permit to Install Issued	Y <input type="checkbox"/> N/A <input checked="" type="checkbox"/>	
F	NPDES Issued	Y <input type="checkbox"/> N/A <input checked="" type="checkbox"/>	
G	Other Permits Issued	Y <input type="checkbox"/> N/A <input checked="" type="checkbox"/>	
H	Executed Right of Way Option or Agreement	Y <input type="checkbox"/> N/A <input checked="" type="checkbox"/>	

I hereby certify that the information above is true and correct to the best of my knowledge and belief.

Ronald P Lajti Jr, PE, PS, Ottawa County Engineer
Engineer's Printed Name

Engineer's Signature

8/26/21
Date



Engineer's Stamp/Seal

Small Government Self-Score
(Input Score in box for each criterion; will total automatically)

Applicant: Salem Township

		SCORE
1	Ability & Effort (Use A or B according to project type)	
A.	<i>Roads, Bridges/Culverts, Storm Water, Solid Waste Projects ONLY</i> 0 2 4 6 8 10	<input type="text" value="4"/>
B.	<i>Water & Wastewater Projects ONLY</i> Calculated by Administrator	<input type="text" value="N/A"/>
2	Health & Safety (Use A or B according to project type)	
A.	<i>Road, Bridge, Culvert</i> 0 2 4 6 8 10	<input type="text" value="4"/>
B.	<i>Water, Wastewater, Storm Water, Solid Waste</i> 0 2 4 6 8 10	<input type="text"/>
3	Age & Condition	
I.	<i>Age</i> 0 1 2 3 4 5	<input type="text" value="5"/>
II.	<i>Condition</i> 1 2 3 4 5	<input type="text" value="3"/>
4	Leveraging Ratio 0 1 2 3 4 5 6 7 8 9 10	<input type="text" value="6"/>
5	Population Benefit 0 1 2 3 4 5	<input type="text" value="1"/>
6	District Priority Ranking - Completed by Administrator	<input type="text" value="N/A"/>
7	OPWC Funds Requested 0 5 10	<input type="text" value="5"/>
8	Loan Request (Default 0 points if no loan requested) 1 5 10	<input type="text" value="1"/>
9	Useful Life 1 2 3 4 5	<input type="text" value="3"/>
10	Median Household Income 2 4 6 8 10	<input type="text" value="2"/>
11	Readiness to Proceed	
I.	<i>Status of Plans</i> 0 2 5	<input type="text" value="5"/>
II.	<i>Status of Funding</i> 0 3 5	<input type="text" value="5"/>
TOTAL		<input type="text" value="44"/>