



State of Ohio
Public Works Commission
Application for Financial Assistance

IMPORTANT: Please consult "Instructions for Financial Assistance for Capital Infrastructure Projects" for guidance in completion of this form.

Applicant

Applicant: Amboy Township Subdivision Code: 051-01728
 District Number: 5 County: Fulton Date: 08/31/2018
 Contact: Hayley Dockery Phone: (419) 335-3816
(The individual who will be available during business hours and who can best answer or coordinate the response to questions)
 Email: hdockery@fultoncountyoh.com FAX: (419) 335-1091

Project

Project Name: Amboy Road 4-1 and Gorham Road S Zip Code: 43540/ 43521

Subdivision Type	Project Type	Funding Request Summary
<small>(Select one)</small>	<small>(Select single largest component by \$)</small>	<small>(Automatically populates from page 2)</small>
<input type="checkbox"/> 1. County	<input checked="" type="checkbox"/> 1. Road	Total Project Cost: <u>471,000 .00</u>
<input type="checkbox"/> 2. City	<input type="checkbox"/> 2. Bridge/Culvert	1. Grant: <u>235,500 .00</u>
<input checked="" type="checkbox"/> 3. Township	<input type="checkbox"/> 3. Water Supply	2. Loan: <u>117,750 .00</u>
<input type="checkbox"/> 4. Village	<input type="checkbox"/> 4. Wastewater	3. Loan Assistance/ Credit Enhancement: <u>0 .00</u>
<input type="checkbox"/> 5. Water (6119 Water District)	<input type="checkbox"/> 5. Solid Waste	Funding Requested: <u>353,250 .00</u>
	<input type="checkbox"/> 6. Stormwater	

District Recommendation (To be completed by the District Committee)

Funding Type Requested <small>(Select one)</small>	SCIP Loan - Rate: _____ % Term: _____ Yrs	Amount: _____ .00
<input type="checkbox"/> State Capital Improvement Program	RLP Loan - Rate: _____ % Term: _____ Yrs	Amount: _____ .00
<input type="checkbox"/> Local Transportation Improvement Program	Grant:	Amount: _____ .00
<input type="checkbox"/> Revolving Loan Program	LTIP:	Amount: _____ .00
<input type="checkbox"/> Small Government Program	Loan Assistance / Credit Enhancement:	Amount: _____ .00
District SG Priority: _____		

For OPWC Use Only

STATUS	Grant Amount: _____ .00	Loan Type: <input type="checkbox"/> SCIP <input type="checkbox"/> RLP
Project Number: _____	Loan Amount: _____ .00	Date Construction End: _____
_____	Total Funding: _____ .00	Date Maturity: _____
Release Date: _____	Local Participation: _____ %	Rate: _____ %
OPWC Approval: _____	OPWC Participation: _____ %	Term: _____ Yrs

1.0 Project Financial Information (All Costs Rounded to Nearest Dollar)

1.1 Project Estimated Costs

Engineering Services

Preliminary Design:	_____	.00	
Final Design:	_____	.00	
Construction Administration:	_____	.00	
Total Engineering Services:	a.) _____	0 .00	_____ 0 %
Right of Way:	b.) _____	.00	
Construction:	c.) _____	471,000 .00	
Materials Purchased Directly:	d.) _____	.00	
Permits, Advertising, Legal:	e.) _____	.00	
Construction Contingencies:	f.) _____	.00	_____ 0 %
Total Estimated Costs:	g.) _____	471,000 .00	

1.2 Project Financial Resources

Local Resources

Local In-Kind or Force Account:	a.) _____	.00	
Local Revenues:	b.) _____	117,750 .00	
Other Public Revenues:	c.) _____	.00	
ODOT / FHWA PID: _____	d.) _____	.00	
USDA Rural Development:	e.) _____	.00	
OEPA / OWDA:	f.) _____	.00	
CDBG:	g.) _____	.00	
<input type="checkbox"/> County Entitlement or Community Dev. "Formula"			
<input type="checkbox"/> Department of Development			
Other: _____	h.) _____	.00	
Subtotal Local Resources:	i.) _____	117,750 .00	_____ 25 %

OPWC Funds (Check all requested and enter Amount)

Grant: _____ 67 % of OPWC Funds	j.) _____	235,500 .00	
Loan: _____ 33 % of OPWC Funds	k.) _____	117,750 .00	
Loan Assistance / Credit Enhancement:	l.) _____	0 .00	
Subtotal OPWC Funds:	m.) _____	353,250 .00	_____ 75 %
Total Financial Resources:	n.) _____	471,000 .00	_____ 100 %

1.3 Availability of Local Funds

Attach a statement signed by the Chief Financial Officer listed in section 5.2 certifying all local resources required for the project will be available on or before the earliest date listed in the Project Schedule section. The OPWC Agreement will not be released until the local resources are certified. Failure to meet local share may result in termination of the project. Applicant needs to provide written confirmation for funds coming from other funding sources.

2.0 Repair / Replacement or New / Expansion

2.1 Total Portion of Project Repair / Replacement:	_____ 471,000 .00	_____ 100 %
2.2 Total Portion of Project New / Expansion:	_____ 0 .00	_____ 0 %
2.3 Total Project:	_____ 471,000 .00	_____ 100 %

A Farmland Preservation letter is required for any impact to farmland

3.0 Project Schedule

3.1 Engineering / Design / Right of Way	Begin Date: _____ 01/01/2019 _____	End Date: _____ 03/01/2020 _____
3.2 Bid Advertisement and Award	Begin Date: _____ 03/01/2019 _____	End Date: _____ 05/01/2020 _____
3.3 Construction	Begin Date: _____ 07/01/2019 _____	End Date: _____ 11/30/2020 _____

Construction cannot begin prior to release of executed Project Agreement and issuance of Notice to Proceed. Failure to meet project schedule may result in termination of agreement for approved projects. Modification of dates must be requested in writing by project official of record and approved by the Commission once the Project Agreement has been executed.

4.0 Project Information

If the project is multi-jurisdictional, information must be consolidated in this section.

4.1 Useful Life / Cost Estimate / Age of Infrastructure

Project Useful Life: _____ 21 _____ Years Age: _____ 1993 _____ (Year built or year of last major improvement)

Attach Registered Professional Engineer's statement, with seal or stamp and signature confirming the project's useful life indicated above and detailed cost estimate.

4.2 User Information

Road or Bridge: Current ADT _____ 458 _____ Year _____ 2018 _____ Projected ADT _____ 577 _____ Year _____ 2039 _____

Water / Wastewater: Based on monthly usage of 4,500 gallons per household; attach current ordinances.

Residential Water Rate Current \$ _____ Proposed \$ _____

Number of households served: _____

Residential Wastewater Rate Current \$ _____ Proposed \$ _____

Number of households served: _____

Stormwater: Number of households served: _____

4.3 Project Description

- A: SPECIFIC LOCATION (Supply a written location description that includes the project termini; a map does not replace this requirement.) 500 character limit.

Amboy Road 4-1 between Road S and Road T
Gorham Road S between Road 23 and the Village of Fayette Limits

- B: PROJECT COMPONENTS (Describe the specific work to be completed; the engineer's estimate does not replace this requirement) 1,000 character limit.

Amboy Road 4-1
Complete reclamation of entire road with an intermediate and surface course

Gorham Road S
A few deep repairs, widening and an intermediate and surface course

- C: PHYSICAL DIMENSIONS (Describe the physical dimensions of the existing facility and the proposed facility. Include length, width, quantity and sizes, mgd capacity, etc in detail.) 500 character limit.

Amboy Road 4-1: 5,270' in length x 20.5' wide
Gorham Road S: 3,250' in length x 20'8" wide, existing 18'8" wide

5.0 Project Officials

Changes in Project Officials must be submitted in writing from an officer of record.

5.1 Chief Executive Officer (Person authorized in legislation to sign project agreements)

Name: Jeff Simon
Title: Amboy Township Trustee
Address: P.O. Box 172

City: Metamora State: OH Zip: 43540
Phone: (419) 644-5581
FAX: (419) 644-2070
E-Mail: villagefarm1@yahoo.com

5.2 Chief Financial Officer (Can not also serve as CEO)

Name: Suzanne Holland
Title: Fiscal Officer
Address: P.O. Box 172

City: Metamora State: OH Zip: 43540
Phone: (419) 644-5581
FAX: (419) 644-2070
E-Mail: amboypwp@yahoo.com

5.3 Project Manager

Name: Frank T. Onweller
Title: Fulton County Engineer
Address: 9120 County Road 14

City: Wauseon State: OH Zip: 43567
Phone: (419) 335-3816
FAX: (419) 335-1091
E-Mail: fonweller@fultoncountyoh.com

6.0 Attachments / Completeness review

Confirm in the boxes below that each item listed is attached (Check each box)

- A certified copy of the legislation by the governing body of the applicant authorizing a designated official to sign and submit this application and execute contracts. This individual should sign under 7.0, Applicant Certification, below.
- A certification signed by the applicant's chief financial officer stating the amount of all local share funds required for the project will be available on or before the dates listed in the Project Schedule section. If the application involves a request for loan (RLP or SCIP), a certification signed by the CFO which identifies a specific revenue source for repaying the loan also must be attached. Both certifications can be accomplished in the same letter.
- A registered professional engineer's detailed cost estimate and useful life statement, as required in 164-1-13, 164-1-14, and 164-1-16 of the Ohio Administrative Code. Estimates shall contain an engineer's seal or stamp and signature.
- A cooperative agreement (if the project involves more than one subdivision or district) which identifies the fiscal and administrative responsibilities of each participant.
- Farmland Preservation Review - The Governor's Executive Order 98-IV, "Ohio Farmland Protection Policy" requires the Commission to establish guidelines on how it will take protection of productive agricultural and grazing land into account in its funding decision making process. Please include a Farm Land Preservation statement for projects that have an impact on farmland.
- Capital Improvements Report. CIR Required by O.R.C. Chapter 164.06 on standard form.
- Supporting Documentation: Materials such as additional project description, photographs, economic impact (temporary and/or full time jobs likely to be created as a result of the project), accident reports, impact on school zones, and other information to assist your district committee in ranking your project. Be sure to include supplements which may be required by your local District Public Works Integrating Committee.

7.0 Applicant Certification

The undersigned certifies: (1) he/she is legally authorized to request and accept financial assistance from the Ohio Public Works Commission as identified in the attached legislation; (2) to the best of his/her knowledge and belief, all representations that are part of this application are true and correct; (3) all official documents and commitments of the applicant that are part of this application have been duly authorized by the governing body of the applicant; and, (4) should the requested financial assistance be provided, that in the execution of this project, the applicant will comply with all assurances required by Ohio Law, including those involving Buy Ohio and prevailing wages.

Applicant certifies that physical construction on the project as defined in the application has NOT begun, and will not begin until a Project Agreement for this project has been executed with the Ohio Public Works Commission. Action to the contrary will result in termination of the agreement and withdrawal of Ohio Public Works Commission funding from the project.

Jeff Simon, Amboy Township Trustee

Certifying Representative (Printed form, Type or Print Name and Title)

Jeff Simon 8/31/18
Original Signature / Date Signed

Revised: April 17, 2018

**DISTRICT 5
CAPITAL IMPROVEMENT PROJECTS
QUESTIONNAIRE
ROUND 33**

Name of Applicant: Amboy Township

Project Title: Amboy Road 4-1 and Gorham Road S

The following questions are to be answered for each application submitted for State Issue II SCIP, LTIP and Loan Projects. Please provide specific information using the best documentation available to you. Justification of your responses to these questions will be required if your project is selected for funding, so please provide correct and accurate responses. **Communities and Townships under 5,000 in population should also complete the Small Government Criteria.**

1. What percentage of the project in repair A= 100%, replacement B= %, expansion C= %, and new D= %? (Use dollar amounts of project to figure percentages and make sure the total equals one hundred(100) percent) A+B= 100% C+D= %

Repair/Replacement = Repair or Replacement of public facilities owned by the government (any subdivision of the state).

New/Expansion = Replacement of privately owned wells, septic systems, private water or wastewater systems, etc.

2. Give the physical condition rating:

Closed or Not Operating: The condition is unusable, dangerous and unsafe. The primary components have failed. The infrastructure is not functioning at all.

✓ Critical: The condition is causing or contributing to a serious non-compliance situation and is threatening the intended design level of service. The infrastructure is functioning at seriously diminished capacity. Imminent failure is anticipated within 18 months. Repair and/or replacement is required to eliminate the critical condition and meet current design standards. **(For Road Projects structural repair items would represent a minimum of 25% of the total Project Cost).**

Poor: The condition is substandard and requires repair/replacement in order to return to the intended level of service and comply with current design standards. Infrastructure contains a major deficiency and is functioning at a diminished capacity.

Fair: The condition is average, not good or poor. The infrastructure is still functioning as originally intended. Minor deficiencies exist requiring repair to continue to function as originally intended and/or to meet current design standards.

- Good: The condition is safe and suitable to purpose. Infrastructure is functioning as originally intended, but requires minor repairs and/or upgrades to meet current design standards.
- Excellent: The condition is new, or requires no repair. Or, no supporting documentation has been submitted.

*** In order to receive points provide supporting documentation (e.g. photos, a narrative, maintenance history, or third party findings) to justifying the rating.**

3. If the proposed project is not approved what category would best represent the impact on the general health and/or public safety?

ROADS

- ✓ Extremely Critical: Resurfacing, Restoration, Rehabilitation and Reconstruction (4R) of a Major Access Road.*
- Critical: Resurfacing, Restoration and Rehabilitation (3R) of a Major Access Road.*
- Major: Resurfacing, Restoration, Rehabilitation and Reconstruction (4R) of a Minor Access Road.*
- Moderate: Resurfacing, Restoration and Rehabilitation (3R) of a Minor Access Road.*
- Minimal: Preventative Maintenance of a Major Access Road.
- No Impact: Preventative Maintenance of a Minor Access Road.

Projects that have a variety of work will be scored in the LOWEST category of work contained in the Construction Estimate.

Road/Street Classifications:

- Major Access Road:* Roads or streets that have a dual function of providing access to adjacent properties and providing through or connecting service between other roads.
- Minor Access Road:* Roads or streets that primarily provide access to adjacent properties without through continuity, such as cul-de-sacs or loop roads or streets.
- Preventative Maintenance:* Non Structural Pavement work such as chip sealing, cape sealing, microsurfacing, crack sealing, etc.

*(3R) Resurfacing, Restoration and Rehabilitation - Improvements to existing roadways, which have as their main purpose, the restoration of the physical features (pavement, curb, guardrail, etc.) without altering the original design elements.

*(4R) Resurfacing, Restoration, Rehabilitation and Reconstruction - Much like 3R, except that 4R allows for the complete reconstruction of the roadway and alteration of certain design elements (i.e., lane widths, shoulder

width, SSD, etc.).

BRIDGES SUFFICIENCY RATING

- Extremely Critical: 0-25, or a General Appraisal rating of 3 or less.
- Critical: 27-50, or a General Appraisal rating of 4.
- Major: 51-65 or a General Appraisal rating of 5 or 6.
- Moderate: 66-80 or a General Appraisal rating of 7.
- Minimal: 81-100 or a General Appraisal rating of more than 7.
- No Impact: Bridge on a new roadway.

WASTEWATER TREATMENT PLANTS

- Extremely Critical: Environmental Protection Agency (EPA) orders in the form of a consent decree, findings and orders or court order. Health Department Construction Ban.
- Critical: Improvements ordered by the Environmental Protection Agency (EPA) in the form of NPDES Orders.
- Major: Replace deficient appurtenances. Update existing processes due to EPA recommendations.
- Moderate: Increase capacity to meet current needs or update processes to improve effluent quality.
- Minimal: New/Expansion project to meet a specific development proposal.
- No Impact: New/Expansion to meet future or projected needs.

WATER TREATMENT PLANT

- Extremely Critical: EPA orders in the form of a consent decree, findings and orders or court order.
- Critical: Improvements to meet Environmental Protection Agency (EPA) Safe Drinking Water Regulations and/or NPDES Orders.
- Major: Replace deficient appurtenances. Update existing processes due to EPA recommendations.
- Moderate: Increase capacity to meet current needs or update processes to improve water quality.
- Minimal: New/Expansion project to meet a specific development proposal.
- No Impact: New/Expansion to meet future or projected needs.

COMBINED SEWER SEPARATIONS (May be construction of either new storm or sanitary sewer as long as the result is two separate sewer systems.)

- Extremely Critical: EPA orders in the form of a consent decree, findings and orders or court order. Health Department Construction Ban.
- Critical: Separate, due to chronic backup or flooding in basements.
- Major: Separate, due to documented water quality impairment, or due to EPA recommendations.
- Moderate: Separate, due to specific development proposal within or upstream of the combined system area.
- Minimal: Separate, to conform to current design standards.
- No Impact: No positive health effect.

STORM SEWERS

- Extremely Critical: EPA orders in the form of a consent decree, findings and orders or court order.
- Critical: Chronic flooding (structure damage).
- Major: Inadequate capacity (land damage).
- Moderate: Inadequate capacity with no associated damage.
- Minimal: New/Expansion to meet current needs.
- No Impact: New/Expansion to meet future or project needs.

CULVERTS

- Extremely Critical: Structurally deficient or functionally obsolete. Deterioration has already caused a safety Critical: hazard to the public.
- Critical: Inadequate capacity with land damage and the existing or high probability of property damage.
- Major: Inadequate capacity (land damage).
- Moderate: Inadequate capacity with no associated damage.
- Minimal: New/Expansion to meet current needs.
- No Impact: New/Expansion to meet future or projected needs.

SANITARY SEWERS

- Extremely Critical: EPA orders in the form of a consent decree, findings and orders or court order. Health Department Construction Ban.
- Critical: Replace, due to chronic pipe failure, chronic backup or flooding in basements. Improvements ordered by the Environmental Protection Agency (EPA) in the form of NPDES Orders.
- Major: Replace, due to inadequate capacity or infiltration, or due to EPA recommendations.
- Moderate: Rehabilitate to increase capacity to meet current needs or to reduce inflow and infiltration.
- Minimal: New/Expansion project to meet a specific development proposal.
- No Impact: New/Expansion to meet future or projected needs.

SANITARY LIFT STATIONS AND FORCE MAINS

- Extremely Critical: Structurally deficient. Deterioration has already caused a safety/health hazard to the public, or, EPA orders in the form of a consent decree, findings and orders or court order.
- Critical: Inadequate capacity with actual or a high probability of property damage. Improvements ordered by the Environmental Protection Agency (EPA) in the form of NPDES Orders.
- Major: EPA recommendations, or, reduces a probable health and/or safety problem.
- Moderate: Rehabilitate to increase capacity to meet current needs.
- Minimal: New/Expansion to meet a specific development proposal.
- No Impact: New/Expansion to meet future or projected needs.

WATER PUMP STATIONS

- Extremely Critical: Structurally deficient. Deterioration has already caused a safety hazard to the public, or, EPA orders in the form of a consent decree, findings and orders or court order.
- Critical: Inadequate capacity with the inability to maintain pressure required for fire flows.
- Major: Replace due to inadequate capacity or EPA recommendations.
- Moderate: Rehabilitate to increase capacity to meet current needs.

Minimal: New/Expansion to meet a specific development proposal.

No Impact: New/Expansion to meet future or projected needs.

WATER LINES/WATER TOWERS

Extremely Critical: Solve low water pressure or excessive incidents of main breaks in project area.

Critical: Replace, due to deficiency such as excessive corrosion, etc.

Major: Replace undersized water lines as upgrading process.

Moderate: Increase capacity to meet current needs.

Minimal: New/Expansion project to meet a specific development proposal.

No Impact: New/Expansion to meet future or projected needs.

OTHER

Extremely Critical: There is a present health and/or safety threat.

Critical: The project will provide immediate health and/or safety benefit.

Major: The project will reduce a probable health and/or safety problem.

Moderate: The project will delay a health and/or safety problem.

Minimal: A possible future health and/or safety problem mitigation.

No Impact: No health and/or safety effect.

NOTE: Combined projects that can be rated in more than one subset may be rated in the other category at the discretion of the District 5 Executive Committee. In general, the majority of the cost or scope of the project shall determine the category under which the project will be scored.

(Submittals without supporting documentation will receive 0 Points for this question.)

Extremely Critical , Critical , Major , Moderate , Minimal , No Impact . Explain your answer.

Windening on Road S and Reclamation on Road 4-1, both major access roads

(Additional narrative, charts and/or pictures should be attached to questionnaire)

4. Identify the amount of local funds that will be used on the project as a percentage of the total project cost.

A.) Amount of Local Funds = \$ 235,500

B.) Total Project Cost = \$ 471,000

RATIO OF LOCAL FUNDS DIVIDED by TOTAL PROJECT COSTS (A/B)= 50 %

Note: Local funds should be considered funds derived from the applicant budget or loans funds to be paid back through local budget, assessments, rates or tax revenues collected by the applicant.

5. Identify the amount of other funding sources to be used on the project, excluding State Issue II or LTIP Funds, as a percentage of the total project cost.

Grants ___% Gifts ___%, Contributions ___%

Other ___% (explain) _____ , Total 0 %

Note: Grant funds and other revenues not contributed or collected through taxes by the applicant should be considered other funds. The Scope of Work for each Funding Source must be the same.

6. Total Amount of SCIP and Loan Funding Requested- An Applicant can request a grant per the categories below for points as indicated on the Priority Rating Sheet. If the Applicant is including a loan request equal to, but not exceeding 50% of the OPWC funding amounts listed below, there will be no point penalty. If loan funds requested are more than 50%, points as listed in the Priority Rating Sheet will apply.

- _____ \$500,001 or More
- _____ \$400,001-\$500,000
- _____ \$325,001-\$400,000
- _____ \$275,001-\$325,000
- ✓ _____ \$175,001-\$275,000
- _____ \$175,000 or Less

There are times when the District spends all of the grant money and has loan money remaining. When this happens, the district makes a loan offer in the amount of the requested grant to the communities that were not funded. The offers are made in the order of scoring. We need to know if you are not successful in obtaining grant dollars for your project if you would be interested in loan money:

YES ✓ NO _____

(This will only be considered if you are not funded with grant money and there is remaining loan money.) **Please note: if you answer “no” you will not be contacted, only if you answer “yes” will an offer be made in the event that there is loan money remaining.**

7. If the proposed project is funded, will its completion directly result in the creation of permanent full-time equivalent (FTE) jobs (FTE jobs shall be defined as 35 hours/week)? Yes ___ No ✓. If yes, how many jobs within eighteen months? ___ Will the completed project retain jobs that would otherwise be

permanently lost? Yes ___ No ___. If yes, how many jobs ___ **will be created/retrained** within 18 months **following the completion of the improvements?**

(Supporting documentation in the form of letter from affected industrial or commercial enterprises that specify full time equivalent jobs that will be retained or created directly by the installation or improvement of Public infrastructure. Additional items such as; 1) newspaper articles or other media news accounts, 2) public meeting minutes, and/or 3) a letter from the County Economic Development Director or State of Ohio Economic Development Professional that alludes to the requirement for the infrastructure improvement to support the business. Submittals without supporting documentation will receive 0 points for this question.)

8. What is the total number of existing users that will directly benefit from the proposed project if completed? 458 (Use households served, traffic counts, etc. and explain the basis by which you arrived at your number.)

9. Is subdivision's population less than 5,000 Yes No ___

If yes, continue. You may want to design your project per Small Government Project Evaluation Criteria, released for the current OPWC Round to assist in evaluating your project for potential Small Government Funding. The Small Government Criteria is available on the OPWC website at <http://www.pwc.state.oh.us/Meth.SG.PDF> If No, skip to Question 11.

10. **OHIO PUBLIC WORKS COMMISSION SMALL GOVERNMENT PROGRAM GUIDELINES**

All projects that are sponsored by a subdivision with a population of 5,000 or less, and not earning enough points for District Funding from SCIP or LTIP Funds, are then rated using the Small Government Program Rating Criteria for the corresponding funding round. In order to be rated the entity must submit the Small Government Supplement and their required budgets with their application.

Only infrastructure that is village- or township- owned is eligible for assistance. The following policies have been adopted by the Small Government Commission:

- District Integrating Committees may submit up to seven (7) applications for consideration by the Commission. All 7 must be ranked, however, only the top five (5) will be scored. The remaining two (2) will be held as contingency projects should an application be withdrawn.
- Grants are limited to \$500,000. Any assistance above that amount must be in the form of a loan.
 - Grants for new or expanded infrastructure cannot exceed 50% of the project estimate.
- The Commission may deny funding for water and sewer systems that are deemed to be more

cost-effective if regionalized.

- If a water or sewer project is determined to be affordable, the project will be offered a loan rather than a grant. Pay special attention to the **Water & Wastewater Affordability Supplemental and the Small Government Water & Wastewater Affordability Calculation Worksheet. Both are available on the Small Government Program Tab at <http://www.pwc.state.oh.us/SmallGovernment.html>**

- Should there be more projects that meet the “annual score” than there is funding, the tie breaker is those projects which scored highest under Health & Safety, with the second tie breaker being Condition. If multiple projects have equivalent Health & Safety and Condition scores they are arranged according to the amount of assistance from low to high. Once the funded projects are announced, “contingency projects” may be funded from project under-runs by continuing down the approved project list.

- Supplemental assistance is not provided to projects previously funded by the Commission.

- Applicants have 30 days from receipt of application by OPWC without exception to provide additional documentation to make the application more competitive under the Small Government criteria. Applications will be scored after the 30-day period has expired. The applicants for each District's two (2) contingency projects will have the same 30-day period to submit supplemental information but these applications will not be scored unless necessary to do so. **It is each applicant’s responsibility for determining the need for supplemental material. The applicant will not be asked for or notified of missing information unless the Commission has changed the project type and it affects the documentation required. Important information may include, but is not limited to: age of infrastructure, traffic counts or utility users, median income information, user rates ordinances, and the Auditor’s Certificate of Estimated Revenues or documentation from the Auditor of State that subdivision is in a state of fiscal emergency.**

If you desire to have your Round 33 project considered for Small Government Funding please download the Small Government Evaluation Criteria applicable to Round 33 by accessing the OPWC Website at <http://www.pwc.state.oh.us/Meth.SG.PDF>. Please complete the Small Government Evaluation Criteria and attach all required supporting documentation and attach it to the District 5 Questionnaire for Round 32.

11. MANDATORY INFORMATION, DISTRICT 5, DISCRETIONARY RANKING POINTS

List all specific user fees: Amount or
ROAD & BRIDGE PROJECTS:(OHIO REVISED CODE) Percentage

Permissive license fee	4504.02 or 4504.06 _____
	4504.15 or 4504.17 _____
	4504.16 or 4504.171 _____
	4504.172 _____
	4504.18 _____

Special property taxes	5555.48 _____
	5555.49 _____

Municipal Income Tax _____

County Sales Tax _____

Others _____

(DO NOT INCLUDE SCHOOL TAXES)

SPECIFIC PROJECT AREA INFORMATION.

Median household income _____

Monthly utility rate: Water _____

Sewer _____

Other _____

List any special user fees or assessment (be specific)

POLITICAL SUBDIVISION= Amboy Township

COUNTY= Fulton

DISCRETIONARY POINTS (BY DISTRICT COMMITTEE ONLY)= _____

(25-20-15)

Date: 8/31/18

Signature: Jeff Amis

Title: Amboy Township Trustee

Address: P.O. Box 172, Metamora, Ohio 43540

Phone: 419-644-5625

FAX: 419-644-2070

Email: villagefarm1@yahoo.com

District 5

Capital Improvement Project

Priority Rating Sheet, Round 33

Revised 04/17/18

COUNTY: Fulton		PROJECT NUMBER														
PROJECT: Amboy Road 4-1 and Gotham Road S																
EST. COST: \$471,000																
No.	"A" WEIGHT FACTOR	CRITERIA TO BE CONSIDERED	"B" PRIORITY FACTORS					"A" x "B"	Priority Factors						No.	
			0	2	4	6	8		10	0	2	4	6	8		10
1	1	(Repair or Replace) vs. (New or Expansion)	0	2	4	6	8	10	10	0% + Repair or Replacement	20% + Repair or Replacement	40% + Repair or Replacement	60%+ Repair or Replacement	80%+ Repair or Replacement	100%+ Repair or Replacement	1
2	1.5	Existing Physical Condition: Must submit substantiating documentation and CIR (100% New or Expansion = 0 Points)	0	2	4	6	8	10	12	Excellent	Good	Fair	Poor	Critical	Closed or Not Operating	2
3	2	Public Health and/or Public Safety Concerns Submittals without supporting documentation will receive 0 points for this question.	0	2	4	6	8	10	20	No Impact	Minimal	Moderate	Major	Critical	Extremely Critical	3
4	2	Percentage of Local Share (Local funds are funds derived from the applicant budget or a loan to be paid back through the applicant budget, assessments, rates or tax revenues) *	0	2	4	6	8	10	20	0%+	10%+	20%+	30%+	40%+	50%+	4
5	1	OTHER FUNDING SOURCES (Excluding Issue II Funds) (Grants and other revenues not contributed or collected through taxes by the applicant; including Gifts, Contributions, etc. - must submit copy of award or status letter.)	0	2	4	6	8	10	0	0%+	10%+	20%+	30%+	40%+	50%+	5
No.	"A" WEIGHT FACTOR	CRITERIA TO BE CONSIDERED	"B" PRIORITY FACTORS					"A" x "B"	Priority Factors						No.	
			-9	-8	0	8	9		10	-9	-8	0	8	9		10
6	2	OPWC Grant and Loan Funding Requested; Please refer to Item 6 on Questionnaire for Clarification.	-9	-8	0	8	9	10	18	Grant or Loan Only \$500,001	\$400,001 to	\$325,001	\$275,001	\$175,001	\$175,000	6
	2		-9	-8	0	8	9	10	18	Grant/Loan Combination \$750,000	\$600,001 to	\$487,501 to	\$412,501 to	\$262,501 to	\$262,500	6
When scoring a project that is only grant or only loan, please use the chart labeled "Grant or Loan Only". When scoring a grant/loan combination, score the project for the grant in the first chart, then use the second chart labeled "Grant/Loan Combination" to score the total (grant and loan combined). Use the lower of the two as the score.																
No.	"A" WEIGHT FACTOR	CRITERIA TO BE CONSIDERED	"B" PRIORITY FACTORS					"A" x "B"	Priority Factors						No.	
			0	2	4	6	8		10	0+ jobs	7+ jobs	15+ jobs	25+ jobs	50+ jobs		100+ jobs
7	1	Will the Proposed Project Create Permanent jobs or retain jobs that would otherwise be permanently lost (Written Documentation Required)	0	2	4	6	8	10	0	0+ jobs	7+ jobs	15+ jobs	25+ jobs	50+ jobs	100+ jobs	8
8	1	Benefits to Existing Users such as households, (Equivalent dwelling units), traffic Counts, etc.	0	2	4	6	8	10	4	0+	100+	350+	500+	750+	1000+	9
9		SUBTOTAL RANKING POINTS (MAX = 115)						84	Other Info: Does this project have a significant impact on productive farmland? YES <input type="radio"/> NO <input checked="" type="radio"/> Attach impact statement if yes. Is the Applicant ready to proceed to bids after State Approval within 6 months? YES <input type="radio"/> NO <input checked="" type="radio"/>							
10		COUNTY PRIORITY POINTS (25-20 18)														
11		DISCRETIONARY POINTS (BY DISTRICT ONLY) (MAX=12)														
12		GRAND TOTAL RANKING POINTS														

* Applicants must certify local share contribution. Specify, all funding sources to be utilized as local share at the time of application submittal.

**ENGINEER'S CERTIFICATION
FOR
INFRASTRUCTURE PROJECT APPLICATION
8/31/2018**

To: Mr. Michael Miller
Ohio Public Work's Commission
Columbus, Ohio

Please accept this certification that I, Frank T. Onweller, Fulton County Engineer, have examined the project application listed in the attached document, and in my opinion the estimated total cost of \$471,000.00 is reasonable and appropriate. I further certify a useful life of 10 years for the Road S resurfacing and a useful life of 25 years for the Road 4-1 reclamation and resurfacing. The weighted useful life is 21 years.

This project does not require plans, permits or right of way and is ready to proceed with bidding upon approval of funding.

- (1) **Title of Project:** Amboy Road 4-1 and Gorham Road S
- (2) **Political Subdivision Submitting this Project:** AMBOY TOWNSHIP
- (3) **Type of Project:** RESURFACING AND RECLAMATION WITH RESURFACING
- (4) **Request from Issue II Funds:** \$353,250.00



Respectfully,

Frank T. Onweller
Fulton County Engineer

*CHIEF FINANCIAL OFFICER'S
CERTIFICATION OF LOCAL FUNDS*

I, Suzi Holland, Fiscal Officer of Amboy Township, hereby certify that Amboy Township has/will have/will collect the amount of \$90,250.00 in the Road and Bridge fund and or the Gas Tax Fund and that this amount will be used to pay the local share for Road 4-1 (S to T) when it is required.

*CHIEF FINANCIAL OFFICER'S
CERTIFICATION OF LOAN REPAYMENT*

I, Suzi Holland, Fiscal Officer of Amboy Township, hereby certify that Amboy Township has/will have/will collect the amount of \$90,250.00 in the Road and Bridge fund and or the Gas Tax Fund and that this amount will be used to repay the SCIP or RLP loan requested for Road 4-1 (S to T) over a 10 yr term.

 7/30/18

Suzi Holland

Date

Amboy Township Fiscal Officer

*CHIEF FINANCIAL OFFICER'S
CERTIFICATION OF LOCAL FUNDS*

I, Melanie Fruchey, Fiscal Officer of Gorham Township, hereby certify that Gorham Township will have the amount of \$27,500.00 in the Road and Bridge fund (2031-330-360-0000) and Gasoline fund (2021-330-360-0000) and that this amount will be used to pay the local share for Road S (23 to Fayette) when it is required.

*CHIEF FINANCIAL OFFICER'S
CERTIFICATION OF LOAN REPAYMENT*

I, Melanie Fruchey, Fiscal Officer of Gorham Township, hereby certify that Gorham Township will have the amount of \$27,500.00 in the Road and Bridge fund (2031-330-360-0000) and Gasoline fund (2021-330-360-0000) and that this amount will be used to repay the SCIP or RLP loan requested for Road S (23 to Fayette) over a 10-year term.

Melanie Fruchey 8-6-18

Melanie Fruchey
Gorham Township Fiscal Officer

Aug. 6, 2018

OFFICE OF THE FULTON COUNTY ENGINEER

**Frank T. Onweller, P.E., P.S.,
County Engineer**

**Rod Creager, P.E., P.S.,
Chief Deputy Engineer**

9120 Co. Rd. 14
Wauseon, OH 43567-9669
Telephone: 419-335-3816 Fax: 419-335-1091

OPWC ESTIMATE			
Project : Amboy Township Road 4-1 (S to T)			
Estimate Date : December 22, 2017			
BY: Hayley Dockery			

REF. ITEM	UNIT	ESTIMATED
NO. NO. QUANTITY UNITS	DESCRIPTION	PRICE COST

Amboy Township

Road 4-1 (Road S to Road T)

Reclamation, Intermediate & Surface Overlays

5,270' x 20'5"

1	202	230	S.Y.	Pavement Removed for Buttjoints.....	\$ 16.00	\$ 3,680.00
2	202	24	S.Y.	Concrete Drive/Sidewalk Removed.....	\$ 30.00	\$ 720.00
3	Special	1	LUMP	Reclamation Mix Design.....	\$10,000.00	\$ 10,000.00
4	Special	12004	S.Y.	Reclamation.....	\$ 4.00	\$ 48,016.00
5	Special	300	TON	Cement.....	\$ 165.00	\$ 49,500.00
6	407	960	GAL.	Tack Coat.....	\$ 2.25	\$ 2,160.00
7	408	4802	GAL.	Prime Coat.....	\$ 3.50	\$ 16,807.00
8	408	72	TON	Choke Aggregate.....	\$ 55.00	\$ 3,960.00
9	441	850	C.Y.	AC Intermediate Course, Type 1 (448), PG 64-22, 2.5".....	\$ 140.00	\$ 119,000.00
10	441	510	C.Y.	AC Surface Course, Type 2 (448), PG 64-22, 1.5".....	\$ 145.00	\$ 73,950.00
11	452	24	S.Y.	Non-Reinforced Concrete Pavement.....	\$ 80.00	\$ 1,920.00
12	617	220	C.Y.	Aggregate Shoulder Reconditioning, 1.5' x 4.5".....	\$ 65.00	\$ 14,300.00
13	203	73	C.Y.	Embankment Shoulder Reconditioning, 2' x 2.25".....	\$ 80.00	\$ 5,840.00
14	659	2340	S.Y.	Seeding and Mulching.....	\$ 1.50	\$ 3,510.00
15	642	1	MILE	Center Line	\$ 500.00	\$ 500.00
16	642	2	MILE	Edge Line	\$ 400.00	\$ 800.00
17	103	1	LUMP	Premium for Contract Performance & Maintenance Guarantee Bond..	\$ 3,837.00	\$ 3,837.00
18	614	1	LUMP	Maintaining Traffic.....	\$ 2,500.00	\$ 2,500.00
Section Total						\$ 361,000.00

OFFICE OF THE FULTON COUNTY ENGINEER

**Frank T. Onweller, P.E., P.S.,
County Engineer**

**Rod Creager, P.E., P.S.,
Chief Deputy Engineer**

9120 Co. Rd. 14
Wauseon, OH 43567-9669
Telephone: 419-335-3816 Fax: 419-335-1091

<p>OPWC ESTIMATE Gorham Township Road S (Road 23 to Village Limit) Repairs, Widening, Intermediate and Surface Course BY: Mike Burkholder</p>
--

REF. NO.	ITEM NO.	QUANTITY	UNITS	DESCRIPTION	UNIT PRICE	ESTIMATED COST
1	202	150	S.Y.	Pavement Removed for Butt Joints.....	\$ 20.00	\$ 3,000.00
2	203	101	C.Y.	Excavation for Pavement Widening, one side, 3,250' x 2' x 5"....	\$ 40.00	\$ 4,040.00
3	204	722	S.Y.	Subgrade Compaction of Widening Trench	\$ 1.00	\$ 722.00
4	407	1,200	GAL.	Tack Coat.....	\$ 2.25	\$ 2,700.00
5	253	30	C.Y.	Pavement Repair.....	\$ 250.00	\$ 7,500.00
6	441	330	C.Y.	Asphalt Concrete, Intermediate Course, Type 1, 1.5".....	\$ 140.00	\$ 46,200.00
7	441	215	C.Y.	Asphalt Concrete, Surface Course, Type 1, 1".....	\$ 145.00	\$ 31,175.00
8	617	75	C.Y.	Compacted Aggregate for Shoulders.....	\$ 65.00	\$ 4,875.00
9	103	1	LUMP	Premium for Contract Performance and Maintenance Bond.....	\$ 4,296.00	\$ 4,296.00
10	614	1	LUMP	Maintaining Traffic.....	\$ 4,500.00	\$ 4,500.00
11	642	0.62	MILE	Center Line, Type 1.....	\$ 600.00	\$ 372.00
12	642	1.24	MILE	Edge Line, Type 1.....	\$ 500.00	\$ 620.00
Estimated Total						\$ 110,000.00

Fulton County Engineer's Office Daily Vehicle Volume Report

Study Date: Thursday, 06/28/2018 / Friday, 06/29/2018

Unit ID:

Location: 4-1 BETWEEN S & T

	Total Volume
12:00 - 12:59	7
13:00 - 13:59	5
14:00 - 14:59	10
15:00 - 15:59	6
16:00 - 16:59	4
17:00 - 17:59	12
18:00 - 18:59	7
19:00 - 19:59	1
20:00 - 20:59	4
21:00 - 21:59	3
22:00 - 22:59	1
23:00 - 23:59	1
00:00 - 00:59	0
01:00 - 01:59	0
02:00 - 02:59	0
03:00 - 03:59	0
04:00 - 04:59	0
05:00 - 05:59	1
06:00 - 06:59	3
07:00 - 07:59	3
08:00 - 08:59	6
09:00 - 09:59	3
10:00 - 10:59	5
11:00 - 11:59	8
Totals	90
AM Peak Time	10:32 - 11:31
AM Peak Volume	10
PM Peak Time	13:37 - 14:36
PM Peak Volume	12



Fulton County Engineer's Office Daily Vehicle Volume Report

Study Date: Tuesday, 06/26/2018 / Wednesday, 06/27/2018

Unit ID:

Location: S 23 and corp line

	Total Volume
03:00 - 03:59	4
04:00 - 04:59	6
05:00 - 05:59	7
06:00 - 06:59	15
07:00 - 07:59	28
08:00 - 08:59	16
09:00 - 09:59	11
10:00 - 10:59	15
11:00 - 11:59	12
12:00 - 12:59	16
13:00 - 13:59	18
14:00 - 14:59	24
15:00 - 15:59	25
16:00 - 16:59	41
17:00 - 17:59	36
18:00 - 18:59	27
19:00 - 19:59	21
20:00 - 20:59	19
21:00 - 21:59	10
22:00 - 22:59	9
23:00 - 23:59	5
00:00 - 00:59	1
01:00 - 01:59	1
02:00 - 02:59	1
Totals	368
AM Peak Time	07:20 - 08:19
AM Peak Volume	35
PM Peak Time	15:40 - 16:39
PM Peak Volume	43



9/4/18



Amboy Road 4-1 (S to T)

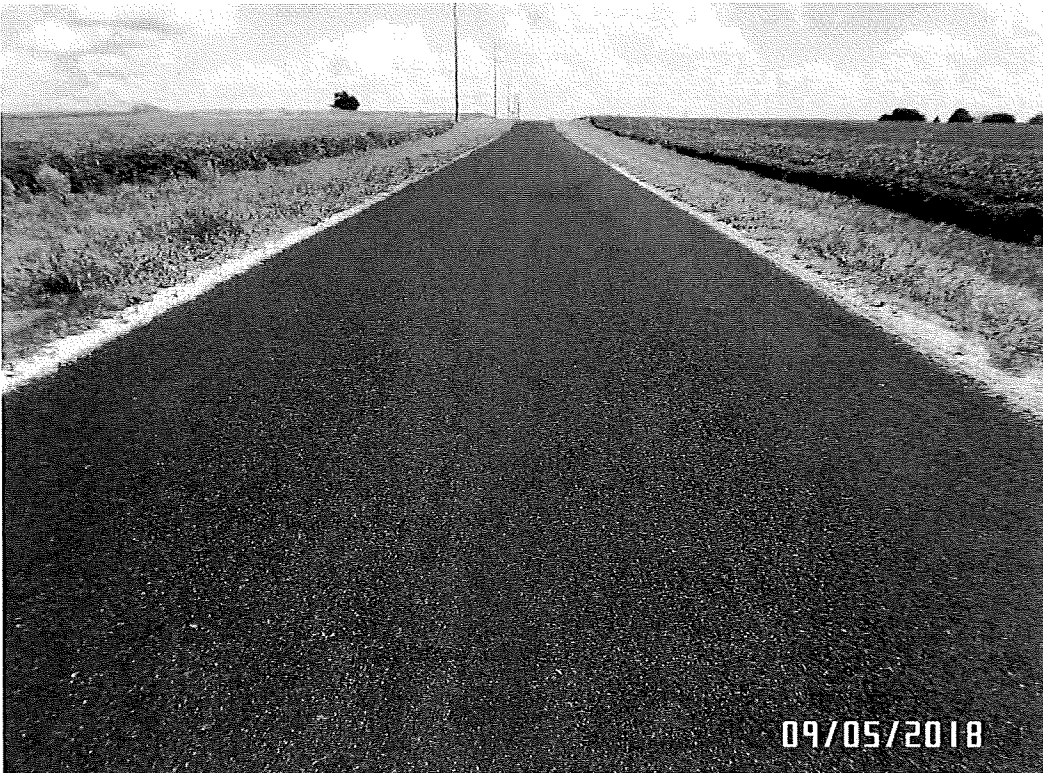

Gorham Road S (23 to Fayette)

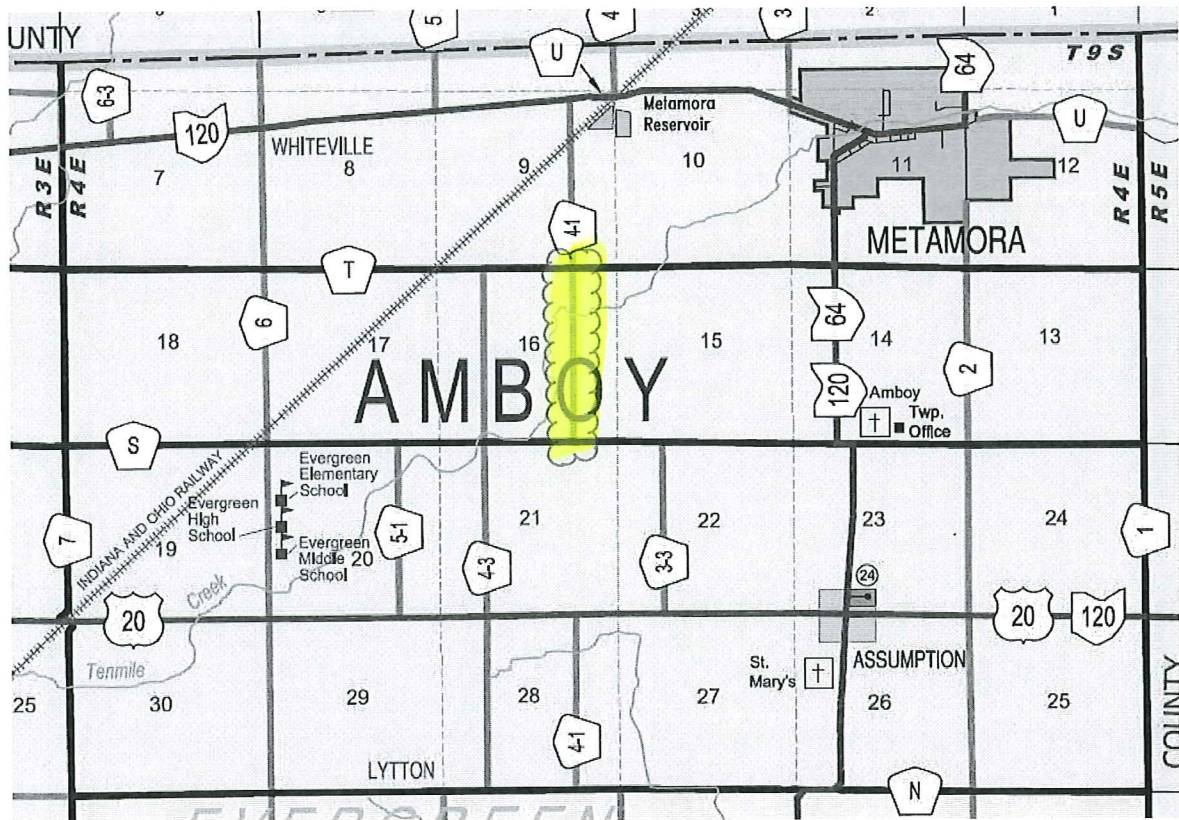

Amboy Road 4-1 (S to T)

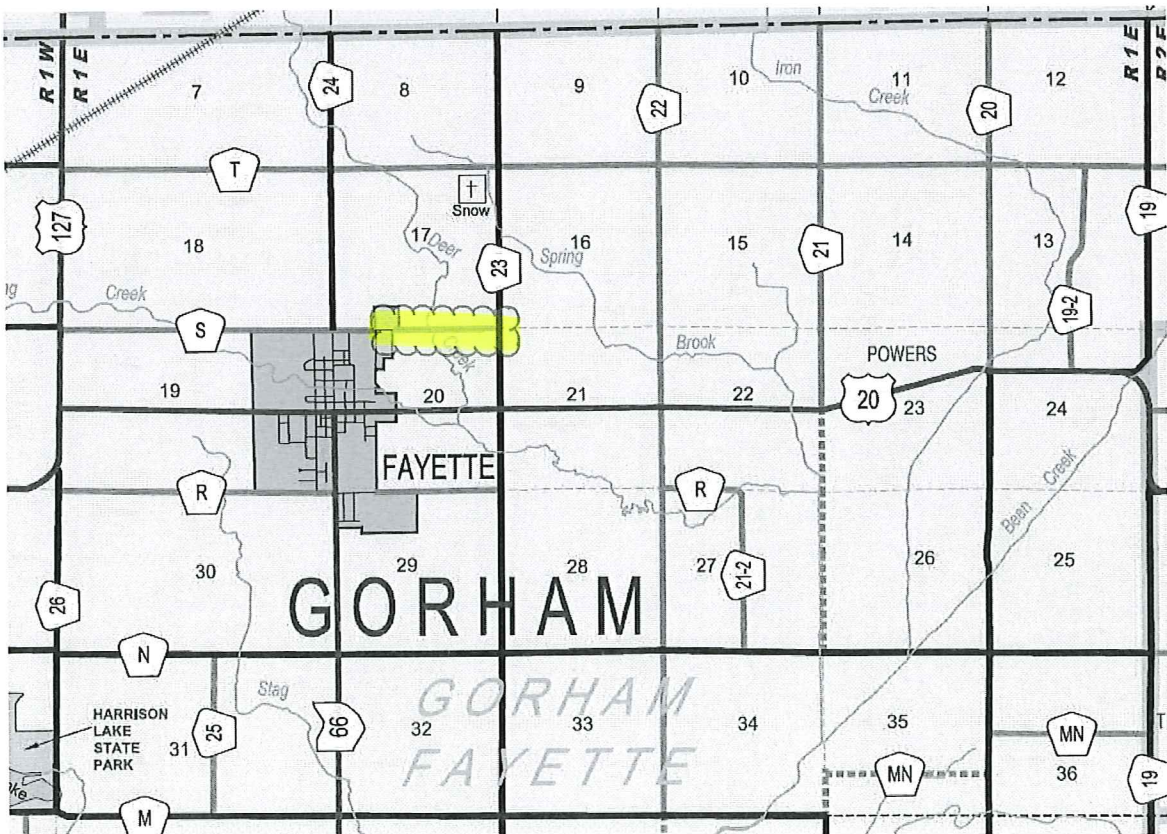

Gorham Road S (23 to Village Limits)

Resolution # 2018-07-02 / July 30th

A RESOLUTION AUTHORIZING FRANK T. ONWELLER, FULTON COUNTY ENGINEER AND JEFF SIMON, TRUSTEE OF AMBOY TOWNSHIP TO PREPARE AND SUBMIT AN APPLICATION TO PARTICIPATE IN THE OHIO PUBLIC WORKS COMMISSION STATE CAPITAL IMPROVEMENT AND/OR LOCAL TRANSPORTATION IMPROVEMENT PROGRAM(S) AND TO EXECUTIVE CONTRACTS AS REQUIRED

WHEREAS, the State Capital Improvement Program and the Local Transportation Improvement Program both provide financial assistance to political subdivisions for capital improvements to public infrastructure, and

WHEREAS, Amboy and Gorham Townships are planning to make capital improvements to Road 4-1 (S to T) and Road S (23 to Fayette), and

WHEREAS, the infrastructure improvement herein above described is considered to be a priority need for the community and is a qualified project under the OPWC programs,

NOW THEREFORE, BE IT RESOLVED by Amboy Township:

Section 1: Jeff Simon, Trustee of Amboy Township is hereby authorized to apply to the OPWC for funds as described above.

Section 2: Jeff Simon, Trustee of Amboy Township is further authorized to enter into any agreements as may be necessary and appropriate for obtaining this financial assistance.

Passed: July 30, 2018

Trustees Signatures:

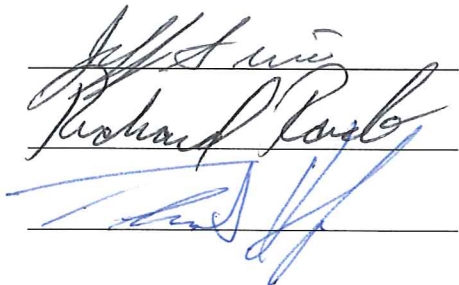

AMBOY TOWNSHIP

PO Box 172 Metamora, Ohio 43540

419-644-5581 fax 419-644-2070

Trustees: Tom Herr Jr., Jeff Simon, Richard Raab

Fiscal Officer: Suzanne Holland

July 30,2018

To Whom It May Concern,

Amboy Township Trustee Thomas Herr Jr. has been on the Board since 1992 and no work has been done on Road 4-1 since 1993.

Sincerely,

A handwritten signature in black ink, appearing to read 'T. Herr Jr.', with a long horizontal stroke extending to the left.

Thomas Herr Jr.

AMENDED OFFICIAL CERTIFICATE OF ESTIMATED RESOURCES

Revised Code Section 5705.36

8-Jan-18

Office of the Budget Commission of Fulton County, Ohio

To the Taxing Authority of Amboy Township

The following is the amended official certificate of estimated resources for the fiscal year beginning January 1st, 2018, as revised by the Budget Commission of said County, which shall govern the total of appropriations made at any time during such fiscal year..

FUND	Unencumbered Bal. Jan.1, 2018	Taxes	Other Sources	Total
General Fund	\$288,993.90	\$61,128.00	\$13,972.00	\$364,093.90
Special Revenue Funds	\$1,294,643.57	\$223,481.00	\$322,905.00	\$1,841,029.57
Debt Service Funds	\$0.00	\$0.00	\$0.00	\$0.00
Capital Projects Funds	\$0.00	\$0.00	\$0.00	\$0.00
Special Assessment Funds	\$0.00	\$0.00	\$0.00	\$0.00
Enterprise Funds	\$0.00	\$0.00	\$0.00	\$0.00
Internal Service Funds	\$0.00	\$0.00	\$0.00	\$0.00
Fiduciary Funds	\$27,509.31	\$0.00	\$40.00	\$27,549.31

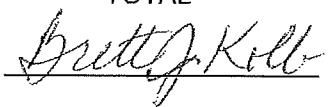
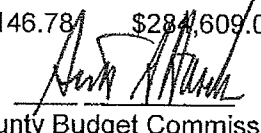
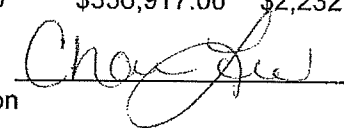
TOTAL	\$1,611,146.78	\$284,609.00	\$336,917.00	\$2,232,672.78
				
	Fulton County Budget Commission			

Fund	Unencumbered Bal. Jan 1, 2018	Taxes	Other Sources	Total
General Fund	\$288,993.90	\$61,128.00	\$13,972.00	\$364,093.90
Special Revenue Funds	XX			XXXXXXXXXXXX
Motor Veh. License	\$30,683.30	\$0.00	\$6,500.00	\$37,183.30
Gasoline Tax	\$120,275.39	\$0.00	\$85,000.00	\$205,275.39
Road & Bridge	\$350,246.66	\$98,381.00	\$1,619.00	\$450,246.66
Cemetery	\$95,193.99	\$33,100.00	\$0.00	\$128,293.99
Fire	\$290,017.45	\$92,000.00	\$0.00	\$382,017.45
Amb & EMS	\$334,603.36	\$0.00	\$215,786.00	\$550,389.36
	\$0.00	\$0.00	\$0.00	\$0.00
Permissive MVL	\$73,623.42	\$0.00	\$14,000.00	\$87,623.42
	\$0.00	\$0.00	\$0.00	\$0.00
	\$0.00	\$0.00	\$0.00	\$0.00
	\$0.00	\$0.00	\$0.00	\$0.00
	\$0.00	\$0.00	\$0.00	\$0.00
TOTALS	\$1,294,643.57	\$223,481.00	\$322,905.00	\$1,841,029.57
Debt Service	\$0.00	\$0.00	\$0.00	\$0.00

**COOPERATIVE AGREEMENT
BETWEEN AMBOY TOWNSHIP AND GORHAM TOWNSHIP**

RESOLUTION # 2018-07-03 / July 30, 2018

Amboy Township and Gorham Township enter into a cooperative agreement to submit an application to the Ohio Public Works Commission for the resurfacing of Road 4-1 (S to T) and Road S (23 to Fayette).

Amboy Township will provide funds for the resurfacing of Road 4-1 (S to T) equal to approximately 77% of the total application. Amboy Township agrees to pay its portion of the resurfacing of Road 4-1 as invoices are due.

Gorham Township will provide funds for the resurfacing of Road S (23 to Fayette) equal to approximately 23% of the total application. Gorham Township agrees to pay its portion of the resurfacing of Road S as invoices are due.

Funds for the Amboy Township local share will come from Road and Bridge fund and or the Gas Tax Fund.

Gorham Township authorizes Amboy Township to serve as lead applicant and to sign all necessary documents. Amboy Township agrees to be the lead applicant and sign all necessary documents.

Signatures for Amboy Township Trustees



7-30-18

Date



7-30-18

Date



7/30/18

Date

**COOPERATIVE AGREEMENT
BETWEEN AMBOY TOWNSHIP AND GORHAM TOWNSHIP**

RESOLUTION NUMBER 002 / AUG. 6, 2018

Amboy Township and Gorham Township enter into a cooperative agreement to submit an application to the Ohio Public Works Commission for the resurfacing of Road 4-1 (S to T) and Road S (23 to Fayette).

Amboy Township will provide funds for the resurfacing of Road 4-1 (S to T) equal to approximately 77% of the total application. Amboy Township agrees to pay its portion of the resurfacing of Road 4-1 as invoices are due.

Gorham Township will provide funds for the resurfacing of Road S (23 to Fayette) equal to approximately 23% of the total application. Gorham Township agrees to pay its portion of the resurfacing of Road S as invoices are due.

Funds for the Gorham Township local share will come from the Road and Bridge fund 2031-330-360-0000 and the Gas fund 2021-330-360-0000.

Gorham Township authorizes Amboy Township to serve as lead applicant and to sign all necessary documents. Amboy Township agrees to be the lead applicant and sign all necessary documents.

Signatures for Gorham Township Trustees



8-6-18

Date



8-6-18

Date

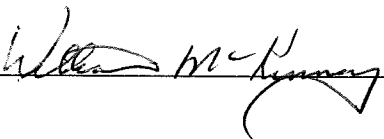

8-6-18

Date



**OHIO PUBLIC WORKS COMMISSION
SMALL GOVERNMENT PROGRAM**

PY 33 METHODOLOGY

May 2018

EVALUATION CRITERIA

Complete and appropriate support documentation must be provided for a criterion in order to be awarded points. See Applicants Manual for guidance, forms and checklist.

1. Ability and Effort of the Applicant to Finance the Project (Maximum 10 points)

A. Roads, Bridges/Culverts, Storm Water, Solid Waste Projects Only – “Auditor’s Certificate of Estimated Resources” showing fund detail, as provided in ORC sections 5705.35 and 5705.36 is used to determine potential financial resources available for the project. Score is based on the project’s total cost as a percentage of financial resources.

0 Total project cost represents 0 to 20% of subdivision's total combined funds legally eligible for infrastructure type

2 Total project cost represents 21 to 40% of subdivision's total combined funds legally eligible for infrastructure type

$\$471,000 \div \$1,045,945.67$
 $= 45\%$

4 Total project cost represents 41 to 60% of subdivision's total combined funds legally eligible for infrastructure type

6 Total project cost represents 61 to 80% of subdivision's total combined funds legally eligible for infrastructure type

8 Total project cost represents 81 to 100% of subdivision's total combined funds legally eligible for infrastructure type

10 Total project cost exceeds 100% of subdivision's total combined funds legally eligible for infrastructure type, or subdivision is in fiscal emergency

B. Water and Wastewater Projects Only – Determined by SG Administrator according to the Water & Wastewater Ability & Effort calculation described in Applicants Manual. Information is obtained from both water and wastewater rate ordinances and the Small Government Water & Wastewater Ability & Effort Supplemental.

0 +2 or more standard deviations above Average Variance

2 +1 to +2 standard deviations above Average Variance

4 0 to +1 standard deviations above Average Variance

6 0 to -1 standard deviations below Average Variance

8 -1 to -2 standard deviations below Average Variance

10 -2 or more standard deviations below Average Variance, or subdivision is in fiscal emergency

2. Importance of Project to Health and Safety of Citizens – Score is assigned according to the application project description and any pertinent supplemental documentation. (Maximum 10 points)

A. Road, Bridge, Culvert

- 0 New infrastructure to meet future or projected needs
- 2 New infrastructure to meet current needs; Roadway surface paving less than 2 inches; Bridges with General Appraisal of 6 or above or with a Sufficiency Rating of 81-100
- 4 Roadway surface paving equal to or greater than 2 inches with/without milling; Replace or install signal where warranted; Bridges with a General Appraisal of 5 or Sufficiency Rating of 66-80; Culvert replacement with no associated damage
- 6 Road widening to add paved shoulders or for safe passage, and/or roadway paving with full-depth base repair equal to or greater than 5% of roadway surface area; Intersection improvement to add turn lanes or realignment; Bridges with a General Appraisal of 4 or Sufficiency Rating of 51-65; Culverts with inadequate flow capacity
- 8 Complete roadway full-depth reconstruction (includes removal/replacement of base) or reclamation with/without drainage; Widening to add travel lanes; Intersection improvements to address excessive accident rate and/or inadequate level of service with Crash Reduction Factor ($0.0 < CRF < 0.2$); Bridges with a General Appraisal of 3 or Sufficiency Rating of 26-50, or posted load reduction; Culverts with inadequate flow capacity and property damage (i.e. flooding)
- 10 Complete roadway reconstruction or reclamation with/without drainage with widening to add travel lanes; Intersection improvement to address excessive accident rate and/or inadequate level of service with Crash Reduction Factor ($CRF \geq 0.2$); Bridges with General Appraisal of 2 or less, or Sufficiency Rating of less than 26; Culverts that are structurally deficient

B. Water, Wastewater, Storm Water, Solid Waste

- 0 Infrastructure to meet future or projected needs
- 2 Expanded infrastructure to meet specific development proposal
- 4 Infrastructure to meet current needs; Update processes to improve effluent or water quality; To remain in compliance with permit due to increased standards; Increase storm sewer capacity in which there is no associated land damage; Increase sanitary sewer capacity; Replace water meters as part of an upgrade
- 6 OEPA recommendations; District health board recommendations; Increase storm sewer capacity that has associated land damage; Replace undersized waterlines as part of upgrade; Install new meters or replace meters that have exceeded useful life
- 8 Replacement of storm or sanitary sewers due to chronic flooding, back-up, or property damage; Inflow and/or Infiltration; Inadequate capacity to maintain pressure required for fire flows; Replacement of waterlines or towers due to excessive corrosion
- 10 OEPA Findings & Orders, OEPA orders contained in permit, Consent Decree or Court Order; Structural separations (CSOs)

3. Age and Condition of System to be repaired or replaced. This is a two-part criterion. (Maximum 10 points)

Part I – Age: This uses provided documentation for existing infrastructure. Documentation pertains to source documentation or from a compliant letter written by an eligible local official who can vouch for the time period during his/her term in office. If no documentation the default score is 1 point. (Maximum 5 points)

Life	20	30	50
Project Type	Road	Wastewater	Bridge/Culvert. Sanitary Sewer, Water, Storm Water, Solid Waste
Points			
0	New / Expansion	New / Expansion	New / Expansion
1	2013-2018	2010-2018	2004-2018
2	2008-2012	2003-2009	1992-2003
3	2003-2007	1995-2002	1980-1991
4	1998-2002	1988-1994	1968-1979
5	Before 1998 or closed	Before 1988 or out of service	Before 1968 or closed

Part II – Condition (Maximum 5 points)

- 1 New/Expansion: New or expansion project components represent at least 50% of improvements
- 3 Poor: Infrastructure requires repair to continue functioning as originally intended and/or upgrade to meet current design standards.
- 5 Failed: Not functioning

4. Leveraging Ratio – Local and all non-OPWC funding sources as a percentage of total funding. (Maximum 10 points)

	Repair/Replacement	New/Expansion
0	10 or less	50 or less
1	11-15	51-55
2	16-20	56-60
3	21-25	61-65
4	26-30	66-70
5	31-35	71-75
6	36-40	76-80
7	41-45	81-85
8	46-50	86-90
9	51-55	91-95
10	56 or more	96 or more

5. Population Benefit – Number of those to benefit directly from the improvement as a percentage of applicant’s total population. (Maximum 5 points)

0	10% or less
①	25% - 11%
2	35% - 26%
3	45% - 36%
4	55% - 46%
5	56% or more

6. District Priority Ranking as provided by District (Maximum 10 points)

6	5 th ranked district project
7	4 th ranked district project
8	3 rd ranked district project
9	2 nd ranked district project
10	1 st ranked district project

7. Amount of OPWC grant and loan funds requested (Maximum 10 points)

0	\$500,000 or more
2	\$400,000 - \$499,999
④	\$300,000 - \$399,999
6	\$200,000 - \$299,999
8	\$100,000 - \$199,999
10	\$ 99,999 or less

8. Loan request – Amount of loan funds as a percentage of total OPWC assistance. (Maximum 10 points)

1	15 - 29% of OPWC assistance
⑤	30 - 49% of OPWC assistance
10	50 - 100% of OPWC assistance

9. Useful Life of Project – Taken from engineer’s useful life statement. (Maximum 5 points)

1	7 - 9 years
2	10 - 14 years
3	15 - 19 years
④	20 - 24 years
5	25 years or more

10. Median Household Income – Applicant’s MHI as a percentage of the statewide MHI. Information derived from the most recent 5-year American Community Survey as published by the Ohio Development Services Agency. (Maximum 10 points)

2	110% or more
4	100% - 109%
6	90% - 99%
8	80% - 89%
10	79% or less

11. Readiness to proceed. This is a two-part criterion. (Maximum 10 points)

Part I – Status of Plans – This uses the Small Government Commission’s Engineer’s Plan Status Certification. (Maximum 5 points)

- 0 Plans not yet begun
- 2 Surveying through Preliminary Design Completed (Items A-C)
- 5 Surveying through final construction plans, and secured permits and right-of-way as appropriate (Items A-H)

Part II – Status of Funding Sources – This uses source documentation including CFO certifications and loan letters. (Maximum 5 points)

- 0 All funds not yet committed
- 3 Applications submitted to funding entities
- 5 All funding committed

Small Government Self-Score
(Input Score in box for each criterion; will total automatically)

Applicant:

SCORE

1 Ability & Effort (Use A or B according to project type)

A. *Roads, Bridges/Culverts, Storm Water, Solid Waste Projects ONLY*

0 2 4 6 8 10

B. *Water & Wastewater Projects ONLY*

Cannot be self-scored; uses blind factor based on all project applications

2 Health & Safety (Use A or B according to project type)

A. *Road, Bridge, Culvert*

0 2 4 6 8 10

B. *Water, Wastewater, Storm Water, Solid Waste*

0 2 4 6 8 10

3 Age & Condition

I. *Age*

0 1 2 3 4 5

II. *Condition*

1 3 5

4 Leveraging Ratio

0 1 2 3 4 5 6 7 8 9 10

5 Population Benefit

0 1 2 3 4 5

6 District Priority Ranking - Completed by Administrator

7 OPWC Funds Requested

0 2 4 6 8 10

8 Loan Request (Default 0 points if no loan requested)

1 5 10

9 Useful Life

1 2 3 4 5

10 Median Household Income

2 4 6 8 10

11 Readiness to Proceed

I. *Status of Plans*

0 2 5

II. *Status of Funding*

0 3 5

TOTAL

**Small Government Commission
 Engineer's Plan Status Certification
 Required for Criterion No. 11, Part I**

Applicant: Amboy Township

District No.: 5

Project Name: Amboy Road 4-1 and Gorham Road S

Item	Necessary for project?	Status	Completion Date
Met Completion dates for Items A - C (2 points)			
A	Surveying	Y <input type="checkbox"/> N/A <input checked="" type="checkbox"/>	
B	R/W Acquisition Identified	Y <input type="checkbox"/> N/A <input checked="" type="checkbox"/>	
C	Preliminary Design	Y <input checked="" type="checkbox"/> N/A <input type="checkbox"/>	completed 5/1/2018
Met Completion dates for Items A - H (5 points)			
D	Final Construction Plans	Y <input checked="" type="checkbox"/> N/A <input type="checkbox"/>	Ready to prepare final proposal for bidding. No plans required. 3/29/2019
E	Permit to Install Issued	Y <input type="checkbox"/> N/A <input checked="" type="checkbox"/>	
F	NPDES Issued	Y <input type="checkbox"/> N/A <input checked="" type="checkbox"/>	
G	Other Permits Issued	Y <input type="checkbox"/> N/A <input checked="" type="checkbox"/>	
H	Executed Right of Way Option or Agreement	Y <input type="checkbox"/> N/A <input checked="" type="checkbox"/>	

I hereby certify that the information above is true and correct to the best of my knowledge and belief.

Frank T. Onweller, P.E., P.S.

Engineer's Printed Name

Frank Onweller

Engineer's Signature

9/6/18

Date



Engineer's Stamp/Seal