



State of Ohio Public Works Commission

Application for Financial Assistance

IMPORTANT: Please consult "Instructions for Financial Assistance for Capital Infrastructure Projects" for guidance in completion of this form.

Applicant

Applicant: City of Fremont Subdivision Code: 043-28826

District Number: 5 County: Sandusky County Date: 09/06/2018

Contact: Tucker Fredericksen Phone: (419) 334-8963
(The individual who will be available during business hours and who can best answer or coordinate the response to questions)

Email: tfredericksen@fremontohio.org FAX: (419) 552-5029

Project Name: 2019 Street Improvements Zip Code: 43420

Project

Subdivision Type	Project Type	Funding Request Summary
<small>(Select one)</small>	<small>(Select single largest component by \$)</small>	<small>(Automatically populates from page 2)</small>
<input type="checkbox"/> 1. County	<input checked="" type="checkbox"/> 1. Road	Total Project Cost: <u>813,769.00</u>
<input checked="" type="checkbox"/> 2. City	<input type="checkbox"/> 2. Bridge/Culvert	1. Grant: <u>275,000.00</u>
<input type="checkbox"/> 3. Township	<input type="checkbox"/> 3. Water Supply	2. Loan: <u>0.00</u>
<input type="checkbox"/> 4. Village	<input type="checkbox"/> 4. Wastewater	3. Loan Assistance/ Credit Enhancement: <u>0.00</u>
<input type="checkbox"/> 5. Water (6119 Water District)	<input type="checkbox"/> 5. Solid Waste	Funding Requested: <u>275,000.00</u>
	<input type="checkbox"/> 6. Stormwater	

District Recommendation (To be completed by the District Committee)

Funding Type Requested	SCIP Loan - Rate: _____ % Term: _____ Yrs	Amount: _____ .00
<small>(Select one)</small>		
<input type="checkbox"/> State Capital Improvement Program	RLP Loan - Rate: _____ % Term: _____ Yrs	Amount: _____ .00
<input type="checkbox"/> Local Transportation Improvement Program	Grant:	Amount: _____ .00
<input type="checkbox"/> Revolving Loan Program	LTIP:	Amount: _____ .00
<input type="checkbox"/> Small Government Program	Loan Assistance / Credit Enhancement:	Amount: _____ .00
District SG Priority: _____		

For OPWC Use Only

STATUS	Grant Amount: _____ .00	Loan Type: <input type="checkbox"/> SCIP <input type="checkbox"/> RLP
Project Number: _____	Loan Amount: _____ .00	Date Construction End: _____
	Total Funding: _____ .00	Date Maturity: _____
Release Date: _____	Local Participation: _____ %	Rate: _____ %
OPWC Approval: _____	OPWC Participation: _____ %	Term: _____ Yrs

1.0 Project Financial Information (All Costs Rounded to Nearest Dollar)

1.1 Project Estimated Costs

Engineering Services

Preliminary Design:	_____	.00	
Final Design:	_____	.00	
Construction Administration:	_____	.00	
Total Engineering Services:	a.) _____	0 .00	___ 0 %
Right of Way:	b.) _____	.00	
Construction:	c.) _____	813,769 .00	
Materials Purchased Directly:	d.) _____	.00	
Permits, Advertising, Legal:	e.) _____	.00	
Construction Contingencies:	f.) _____	.00	___ 0 %
Total Estimated Costs:	g.) _____	813,769 .00	

1.2 Project Financial Resources

Local Resources

Local In-Kind or Force Account:	a.) _____	.00	
Local Revenues:	b.) _____	538,769 .00	
Other Public Revenues:	c.) _____	.00	
ODOT / FHWA PID: _____	d.) _____	.00	
USDA Rural Development:	e.) _____	.00	
OEPA / OWDA:	f.) _____	.00	
CDBG:	g.) _____	.00	
<input type="checkbox"/> County Entitlement or Community Dev. "Formula"			
<input type="checkbox"/> Department of Development			
Other: _____	h.) _____	.00	
Subtotal Local Resources:	i.) _____	538,769 .00	___ 66 %

OPWC Funds (Check all requested and enter Amount)

Grant: <u>100</u> % of OPWC Funds	j.) _____	275,000 .00	
Loan: <u>0</u> % of OPWC Funds	k.) _____	.00	
Loan Assistance / Credit Enhancement:	l.) _____	0 .00	
Subtotal OPWC Funds:	m.) _____	275,000 .00	___ 34 %
Total Financial Resources:	n.) _____	813,769 .00	___ 100 %

1.3 Availability of Local Funds

Attach a statement signed by the Chief Financial Officer listed in section 5.2 certifying all local resources required for the project will be available on or before the earliest date listed in the Project Schedule section. The OPWC Agreement will not be released until the local resources are certified. Failure to meet local share may result in termination of the project. Applicant needs to provide written confirmation for funds coming from other funding sources.

2.0 Repair / Replacement or New / Expansion

2.1 Total Portion of Project Repair / Replacement:	<u>813,769 .00</u>	<u>100 %</u>
2.2 Total Portion of Project New / Expansion:	<u>0 .00</u>	<u>0 %</u>
2.3 Total Project:	<u>813,769 .00</u>	<u>100 %</u>

A Farmland Preservation letter is required for any impact to farmland.

3.0 Project Schedule

3.1 Engineering / Design / Right of Way	Begin Date: <u>10/01/2018</u>	End Date: <u>05/31/2019</u>
3.2 Bid Advertisement and Award	Begin Date: <u>06/01/2019</u>	End Date: <u>06/30/2019</u>
3.3 Construction	Begin Date: <u>08/01/2019</u>	End Date: <u>11/15/2019</u>

Construction cannot begin prior to release of executed Project Agreement and issuance of Notice to Proceed.

Failure to meet project schedule may result in termination of agreement for approved projects. Modification of dates must be requested in writing by project official of record and approved by the Commission once the Project Agreement has been executed.

4.0 Project Information

If the project is multi-jurisdictional, information must be consolidated in this section.

4.1 Useful Life / Cost Estimate / Age of Infrastructure

Project Useful Life: 15 Years Age: 1995 (Year built or year of last major improvement)

Attach Registered Professional Engineer's statement, with seal or stamp and signature confirming the project's useful life indicated above and detailed cost estimate.

4.2 User Information

Road or Bridge: Current ADT 4,177 Year 2017 Projected ADT 4,594 Year 2033

Water / Wastewater: Based on monthly usage of 4,500 gallons per household; attach current ordinances.

Residential Water Rate Current \$ _____ Proposed \$ _____

Number of households served: _____

Residential Wastewater Rate Current \$ _____ Proposed \$ _____

Number of households served: _____

Stormwater: Number of households served: _____

4.3 Project Description

- A: **SPECIFIC LOCATION** (Supply a written location description that includes the project termini; a map does not replace this requirement.) 500 character limit.

Park Avenue - W. State Street to Tiffin Street
N. Fifth Street - RR Tracks to Countryside Drive
N. Prospect Street - Pine Street to E. State Street
Wayne Place - Rawson Avenue to Wood Street

- B: **PROJECT COMPONENTS** (Describe the specific work to be completed; the engineer's estimate does not replace this requirement) 1,000 character limit.

Work Includes:
Asphalt Milling
Pavement Repair
Curb Inlet removal & replacement
Catch Basin Work
Top Coat Application
Resurfacing ODOT #448 Intermediate Course, Type 2
Resurfacing ODOT #448 Surface Course, Type 1
Joint Sealing & Pavement Painting

- C: **PHYSICAL DIMENSIONS** (Describe the physical dimensions of the existing facility and the proposed facility. Include length, width, quantity and sizes, mgd capacity, etc. in detail.) 500 character limit.

Park Avenue 3525 ft. long X 40 ft. wide
N. Fifth Street 910 ft. long X 25 ft. wide
N. Prospect Street 970 ft. long X 24 ft. wide
Wayne Place 70 ft. long X 17 ft. wide

5.0 Project Officials

Changes in Project Officials must be submitted in writing from an officer of record.

5.1 Chief Executive Officer (Person authorized in legislation to sign project agreements)

Name: Daniel Sanchez
Title: Mayor
Address: 323 S. Front Street

City: Fremont State: OH Zip: 43420
Phone: (419) 334-5900
FAX: (419) 334-8434
E-Mail: dsanchez@fremontohio.org

5.2 Chief Financial Officer (Can not also serve as CEO)

Name: Paul D. Grahl
Title: Auditor
Address: 323 S. Front Street

City: Fremont State: OH Zip: 43420
Phone: (419) 334-3867
FAX: (419) 334-8434
E-Mail: pgrahl@fremontohio.org

5.3 Project Manager

Name: Tucker Fredericksen
Title: City Engineer
Address: 323 S. Front Street

City: Fremont State: OH Zip: 43420
Phone: (419) 334-8963
FAX: (419) 552-5029
E-Mail: tfredericksen@fremontohio.org

6.0 Attachments / Completeness review

Confirm in the boxes below that each item listed is attached (Check each box)

- A certified copy of the legislation by the governing body of the applicant authorizing a designated official to sign and submit this application and execute contracts. This individual should sign under 7.0, Applicant Certification, below.
- A certification signed by the applicant's chief financial officer stating the amount of all local share funds required for the project will be available on or before the dates listed in the Project Schedule section. If the application involves a request for loan (RLP or SCIP), a certification signed by the CFO which identifies a specific revenue source for repaying the loan also must be attached. Both certifications can be accomplished in the same letter.
- A registered professional engineer's detailed cost estimate and useful life statement, as required in 164-1-13, 164-1-14, and 164-1-16 of the Ohio Administrative Code. Estimates shall contain an engineer's seal or stamp and signature.
- A cooperative agreement (if the project involves more than one subdivision or district) which identifies the fiscal and administrative responsibilities of each participant.
- Farmland Preservation Review - The Governor's Executive Order 98-IV, "Ohio Farmland Protection Policy" requires the Commission to establish guidelines on how it will take protection of productive agricultural and grazing land into account in its funding decision making process. Please include a Farm Land Preservation statement for projects that have an impact on farmland.
- Capital Improvements Report. CIR Required by O.R.C. Chapter 164.06 on standard form.
- Supporting Documentation: Materials such as additional project description, photographs, economic impact (temporary and/or full time jobs likely to be created as a result of the project), accident reports, impact on school zones, and other information to assist your district committee in ranking your project. Be sure to include supplements which may be required by your local District Public Works Integrating Committee.

7.0 Applicant Certification

The undersigned certifies: (1) he/she is legally authorized to request and accept financial assistance from the Ohio Public Works Commission as identified in the attached legislation; (2) to the best of his/her knowledge and belief, all representations that are part of this application are true and correct; (3) all official documents and commitments of the applicant that are part of this application have been duly authorized by the governing body of the applicant; and, (4) should the requested financial assistance be provided, that in the execution of this project, the applicant will comply with all assurances required by Ohio Law, including those involving Buy Ohio and prevailing wages.

Applicant certifies that physical construction on the project as defined in the application has NOT begun, and will not begin until a Project Agreement for this project has been executed with the Ohio Public Works Commission. Action to the contrary will result in termination of the agreement and withdrawal of Ohio Public Works Commission funding from the project.

Daniel R Sanchez, Mayor
Certifying Representative (Printed form, Type or Print Name and Title)

Original Signature / Date Signed

RESOLUTION NO. 2018- 2056

A RESOLUTION AUTHORIZING THE MAYOR TO PREPARE, SIGN, AND ENTER INTO CONTRACTS FOR SUBMISSION TO THE OHIO PUBLIC WORKS COMMISSION FOR THE STATE CAPITAL IMPROVEMENT PROGRAM (SCIP) AND THE LOCAL TRANSPORTATION IMPROVEMENT PROGRAM (LTIP) FOR 2019 FUNDING AND DECLARING AN EMERGENCY.

WHEREAS, the State of Ohio has State Capital Improvement Program ("SCIP") and Local Transportation Improvement Program ("LTIP") funds available through the Ohio Public Works Commission for allocation to eligible counties, townships, and municipalities; and

WHEREAS, Council finds that public infrastructure and capital improvements are essential in the preservation of Fremont. By taking steps to promote public health, safety, and welfare the economic vitality of Fremont is fostered; and

WHEREAS, the Ohio Public Works Commission is accepting applications for these counties, townships, and municipalities to access funds;

NOW, THEREFORE, BE IT RESOLVED BY THE COUNCIL OF THE CITY OF FREMONT, STATE OF OHIO:

SECTION 1. The Mayor is authorized to prepare, sign, and enter into contracts for submission to the Ohio Public Works Commission for SCIP and LTIP funding.

SECTION 2. The immediate operation of the provisions of this resolution is necessary for the immediate preservation of the public peace, health, safety and welfare of the citizens of the City of Fremont. Said emergency being the need to meet the application deadline of September 7, 2018.

This resolution, provided it receives a two-thirds yea or nay vote of all the members elected to the Fremont City Council, is hereby declared to be an emergency measure and this resolution shall be in full force and effect from and after its passage by the Council of the City of Fremont, approval by the Mayor, and publication and posting as required by law.

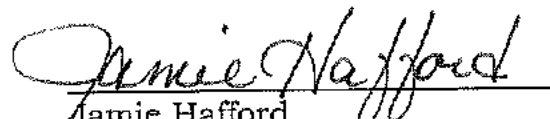
Jamie Hafford
President of Council

PASSED: 6-21-2018

Effective date: 6-21-2018

YEAS: 7 NAYS: 0

Amanda M. Sears
~~Stephanie L. Martin~~, City Council Clerk
Amanda M. Sears

[Signature]
Daniel R. Sanchez, Mayor

RES553

Approved as to form:

[Signature]
James F. Melle, Director of Law
City of Fremont, Ohio

**2019 STREET IMPROVEMENTS
CERTIFICATE OF OWNER'S FINANCIAL OFFICER**

September 6, 2018

ATTEST:

I, City Auditor of the City of Fremont, hereby certify that the City of Fremont has the amount of \$813,769.00 in the Capital Improvement Fund and that this amount will be used to pay the local share for the 2019 Street Improvements when it is required.

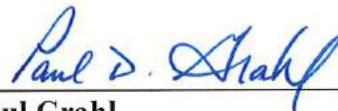

**Paul Grahl
City Auditor**

**2019 STREET IMPROVEMENTS
ENGINEER'S ESTIMATE**

To do and perform all work and other service, to furnish all necessary equipment, and to do all things required for the conformance of said Contract.

Total ----- **\$813,769.00**

See attached for breakdown by item.

9/7/18

Date

Tucker Fredericksen

Tucker Fredericksen, P.E.

City Engineer

P.E. License #E-67639



N. FIFTH STREET, PROSPECT STREET, PARK AVENUE, & WAYNE PLACE							
ITEM NO	EST QTY	UNIT	DESCRIPTION	MATERIAL & LABOR	UNIT PRICE	TOTAL ITEM PRICE IN WORDS & FIGURES	
1	1	Lump Sum	#624 Mobilization		\$ 10,000.00	\$	10,000.00
2	34	Each	#611 Catch Basin and Curb Inlet Removal and Replacement with Type 2-4 Park Avenue		\$ 2,500.00	\$	85,000.00
3	4636	Lin Ft	#609 Concrete Curb, Type 6, Removal & Replacement		\$ 20.00	\$	92,720.00
4 5	3980	Sq Ft	#452 Plain Concrete Six (6) Thickness Driveway Approach		\$ 6.00	\$	23,880.00
5	42	Each	#698 Curb Ramp including Sidewalk Repair & Detectable Warning Panels		\$ 400.00		\$16,800
6	24000	Sq Yds	#254 Cold Planing Three (3) inch Average Thickness per Specifications, includes hauling millings to City Yard, Tiffin St.		\$ 4.00	\$	96,000.00
7	100	Sq Yds	#255 Full Depth Pavement Repair and Rigid Replacement with Class QC MS		\$ 100.00	\$	10,000.00
8	60	Lin Ft	#255 Full Depth Pavement Sawing		\$ 1.50	\$	90.00
9	200	Lin Ft	Special Curb Removal & Replacement Park Avenue		\$ 35.00	\$	7,000.00
10	150	Lin Ft	Special Removal of Retaining Wall including grading and restoration as required Park Avenue		\$ 35.00	\$	5,250.00
11	4750	Gal	#407 Tack Coat 0.10 Gallon per Square Yard		\$ 3.00	\$	14,250.00
12	1950	Tons	#448 Asphalt Concrete 1 1/2 inch Average Intermediate Course Type 2, PG 64-22, Tiffin St.		\$ 75.00	\$	146,250.00

ITEM NO	EST QTY	UNIT	DESCRIPTION	MATERIAL & LABOR	UNIT PRICE	TOTAL ITEM PRICE IN WORDS & FIGURES
13	1950	Tons	#448 Asphalt Concrete 1 1/2 inch Thickness Surface Course, Type 1, PG 64-22, Tiffin St.		\$ 75.00	\$ 146,250.00
14	14	Each	Special - Manhole to be Adjusted to Grade with Concrete Collar		\$ 500.00	\$ 7,000.00
15	45	Each	Special - Catch Basins to be Adjusted to Grade with Concrete Collar		\$ 500.00	\$ 22,500.00
16	19	Each	Special - Water Valves to be Adjusted to Grade with Concrete Collar		\$ 150.00	\$ 2,850.00
17	215	Tons	#617 Berm Stone per Specifications for N. 5th St. & Wayne Place		\$ 30.00	\$ 6,450.00
18	1	Lump Sum	#641 Pavement Painting, Striping		\$ 27,500.00	\$ 27,500.00
19	1	Lump Sum	#659, Seeding and Mulching Disturbed Grass Areas		\$ 10,000.00	\$ 10,000.00
20	1	Lump Sum	#614 Maintaining Traffic		\$ 10,000.00	\$ 10,000.00
			TOTAL CONSTRUCTION COST			\$ 739,790.00
			CONTINGENCY 10%			\$ 73,979.00
			GRAND TOTAL			\$ 813,769.00



Michael T. Fredericksen
9/7/18

**2019 STREET IMPROVEMENTS
DESIGN USEFUL LIFE**

This project includes improvements to Park Avenue, North and South Prospect Street, Wayne Place, and North Fifth Street. Plans include the following: planing of existing deteriorated surfaces, repair of any damaged sub-base, and paving new asphalt intermediate and surface course. Existing traffic counts will be projected into the future for design ADT including truck traffic. Design of the resurfacing pavement will provide these streets with approximately fifteen (15) years of additional useful life.

The City of Fremont utilizes funds available thru the Ohio Public Works Commission to help repair and replace aging infrastructure. As the owners and operators for the public roads, it is our responsibility to maintain safety. Park Avenue, North and South Prospect Street, Wayne Place and North Fifth Street are all located in the vicinity to public schools and are in very poor condition.

Based on experience with similar streets, past performance of existing pavement, and current typical maintenance practices, the estimated useful life of this proposal is fifteen (15) years.

9/7/18
Date

Tucker Frederickson
Tucker Frederickson, P. E.
City Engineer
P. E. License #E-67639



**2019 STREET IMPROVEMENTS
DESIGN SERVICE CAPACITY**

Since 1988, the City of Fremont has been involved with large Reconstruction Projects. List includes the following: (1) 1988, West State Street from West Corporation Limit to Wayne Street and May Street from Wood Street to Park Avenue; (2) 1989, North Street from Dickinson Street to Rawson Avenue and May Street from Park Avenue to Front Street; (3) 1990, West State Street from Wayne Street to Sandusky River Bridge (First SPIC Project) and Morrison Street from Thompson Street to Harmon Street; (4) 1991, North and Front Street Intersection (First LTIP Project); (5) 1992, Heinz Access Road (Second SCIP Project); (6) 1993, East State Street from Sandusky River Bridge to Fifth Street (Third SCIP Project); (7) 1994, Morrison Street from Thompson Street to State Street (Fourth SCIP Project); (8), 1995, Front Street from Tiffin Street to State Street (Fourth LTIP Project); (9) 1997, Bridge Replacements (Sixth LTIP Project); and (10) 2003, Front Street Improvement (Ninth SCIP Project). This carries on with the 2014 Street Improvements, the last LTIP funding was provided in 2017.

At the same time, budget restraints have limited the pavement improvements for various City Streets and we continue to fall behind on proper roadway improvement and maintenance work. Since the early 90's, several street improvement projects have been completed within the City of Fremont utilizing OPWC Funds. At the present time, there are many more streets requiring pavement improvements than the City can afford to do. Although not requiring reconstruction, many of these streets need planing of existing deteriorated surfaces, asphalt repairs of existing damaged surfaces, reinforcement, strengthening with asphalt base course, grading with leveling and scratch courses of asphalt, and new asphalt surface course. This project will afford the City the opportunity to perform much needed roadway improvements that it otherwise will not be able to.

These miscellaneous streets have had gradual increases in traffic volume over the years. The proposed improvements take into account all elements of design for the streets. With the above proposals, the streets will be able to handle further increasing traffic loads for approximately fifteen (15) years with typical maintenance.

9/7/18
Date

Tucker Fredericksen, P. E.
City Engineer
P. E. License #E-67639



MetroCount Traffic Executive Adjusted Flow

AADT-65 -- English (ENU)

Datasets:

Site: [N. Fifth Street] N. Fifth St. (between RR & Countryside Drive)
Attribute: [+51.477222 +0.000000]
Direction: 3 - South bound, A trigger first. Lane: 0
Survey Duration: 10:08 Tuesday, September 05, 2017 => 11:21 Thursday, September 07, 2017,
Zone:
File: N. Fifth Street 0 2017-09-07 1122.EC0 (Plus)
Identifier: MJ50X5T4 MC56-L5 [MC55] (c)Microcom 19Oct04
Algorithm: Factory default axle (v4.06)
Data type: Axle sensors - Paired (Class/Speed/Count)

Profile:

Filter time: 10:09 Tuesday, September 05, 2017 => 11:21 Thursday, September 07, 2017 (2.05065)
Included classes: 1, 2, 3, 4, 5, 6, 7, 8, 9, 10, 11, 12, 13
Speed range: 0 - 99 mph.
Direction: North, East, South, West (bound), P = South
Separation: Headway > 0 sec, Span 0 - 328.084 ft
Name: Default Profile
Scheme: Vehicle classification (Scheme F3)
Units: Non metric (ft, mi, ft/s, mph, lb, ton)
In profile: Vehicles = 5735 / 5738 (99.95%)

Day	Hits	RawVol	DayFac	MonFac	AdjVol	Date
0						Tuesday, September 05, 2017
1	1	2930.000	1.000	1.000	2930.000	Wednesday, September 06, 2017
2						Thursday, September 07, 2017

Total days = 1, Coverage = 0.27%

ADT = 2930.000, SD = -1.#IO

AAAT = 2930.000, SD = -1.#IO

Weekdays = 1, Coverage = 0.27%

AWDT = 2930.000, SD = -1.#IO

AAWDT = 2930.000, SD = -1.#IO

ADT and adjustment factor by month

Jan

Feb

Mar

Apr

May

Jun

Jul

Aug

Sep - Vol = 2930.000, Days = 1, ADT = 2930.000, Adjust = 1.00000, 1/Adjust = 1.00000

Oct

Nov

Dec

ADT and adjustment factor by day of week

Mon

Tue

Wed - Vol = 2930.000, Days = 1, ADT = 2930.000, Adjust = 1.00000, 1/Adjust = 1.00000

Thu

Fri

Sat

Sun

MetroCount Traffic Executive Adjusted Flow

AADT-58 -- English (ENU)

Datasets:

Site: [Tiffin Street] Park Avenue (between W. State & Birchard)
Attribute: [+51.477222 +0.000000]
Direction: 1 - North bound, A trigger first. Lane: 0
Survey Duration: 9:33 Tuesday, August 29, 2017 => 11:47 Friday, September 01, 2017,
Zone:
File: Tiffin Street 0 2017-09-01 1148.EC0 (Plus)
Identifier: KY41KF5A MC56-L5 [MC55] (c)Microcom 19Oct04
Algorithm: Factory default axle (v4.06)
Data type: Axle sensors - Paired (Class/Speed/Count)

Profile:

Filter time: 9:34 Tuesday, August 29, 2017 => 11:47 Friday, September 01, 2017 (3.09272)
Included classes: 1, 2, 3, 4, 5, 6, 7, 8, 9, 10, 11, 12, 13
Speed range: 6 - 99 mph.
Direction: North, East, South, West (bound), P = North
Separation: Headway > 0 sec, Span 0 - 328.084 ft
Name: Default Profile
Scheme: Vehicle classification (Scheme F3)
Units: Non metric (ft, mi, ft/s, mph, lb, ton)
In profile: Vehicles = 3703 / 3706 (99.92%)

Day	Hits	RawVol	DayFac	MonFac	AdjVol	Date
0						Tuesday, August 29, 2017
1	1	1679.000	1.000	1.000	1679.000	Wednesday, August 30, 2017
2	1	815.000	1.000	1.000	815.000	Thursday, August 31, 2017
3						Friday, September 01, 2017

Total days = 2, Coverage = 0.55%

ADT = 1247.000, SD = 610.940

AADT = 1247.000, SD = 610.940

Weekdays = 2, Coverage = 0.55%

AWDT = 1247.000, SD = 610.940

AAWDT = 1247.000, SD = 610.940

ADT and adjustment factor by month

Jan

Feb

Mar

Apr

May

Jun

Jul

Aug - Vol = 2494.000, Days = 2, ADT = 1247.000, Adjust = 1.00000, 1/Adjust = 1.00000

Sep

Oct

Nov

Dec

ADT and adjustment factor by day of week

Mon

Tue

Wed - Vol = 1679.000, Days = 1, ADT = 1679.000, Adjust = 0.74270, 1/Adjust = 1.34643

Thu - Vol = 815.000, Days = 1, ADT = 815.000, Adjust = 1.53006, 1/Adjust = 0.65357

Fri

Sat

Sun

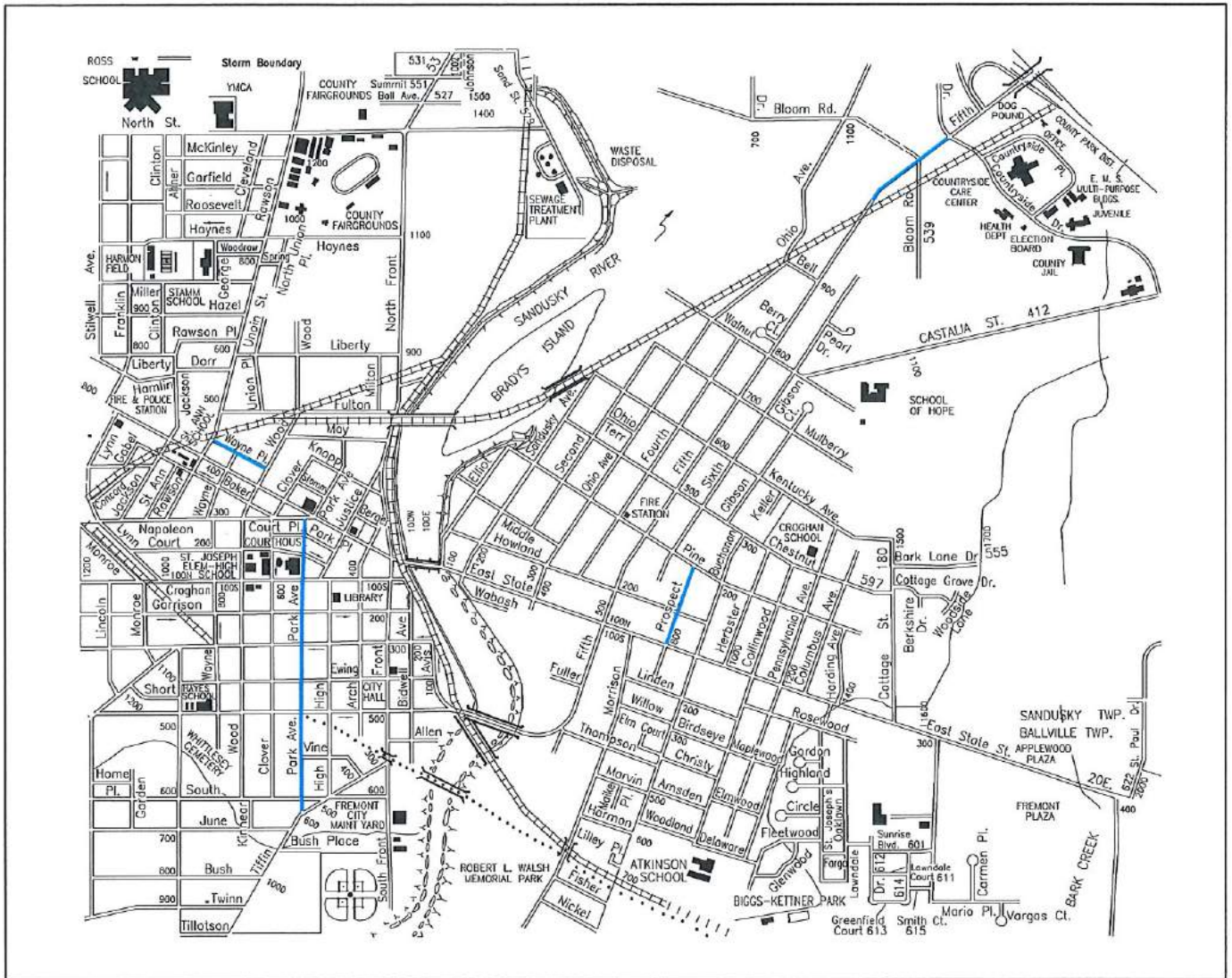

2019 STREET IMPROVEMENTS

CITY ENGINEER'S DEPARTMENT
 FREMONT, OHIO
 TUCKER FREDERICKSEN P.E.
 CITY ENGINEER

SEPTEMBER 2018

8/30/2017
Park Ave near
intersection with
Vine St



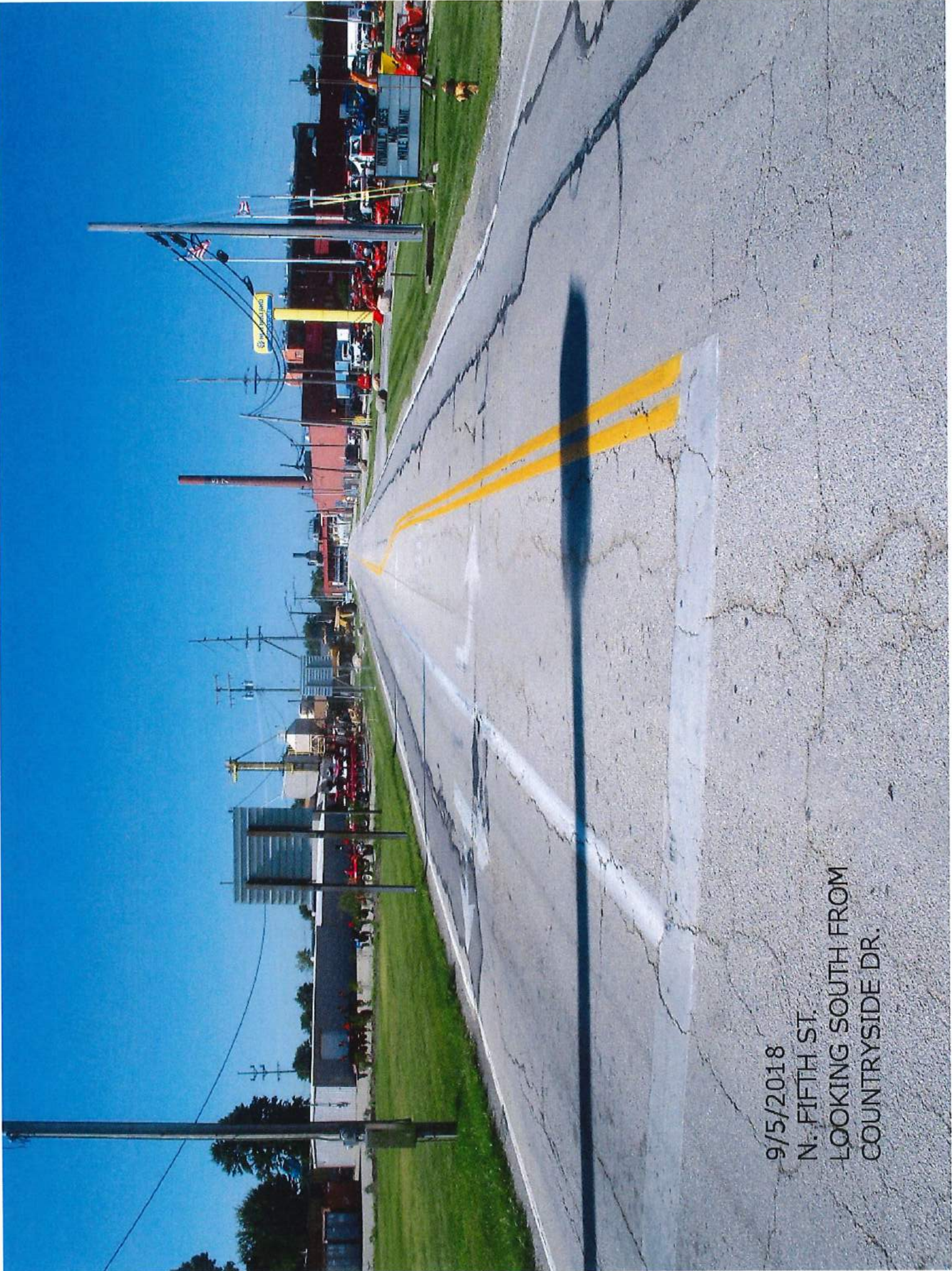

9/5/2018
N. FIFTH ST.
LOOKING SOUTH FROM
COUNTRYSIDE DR.

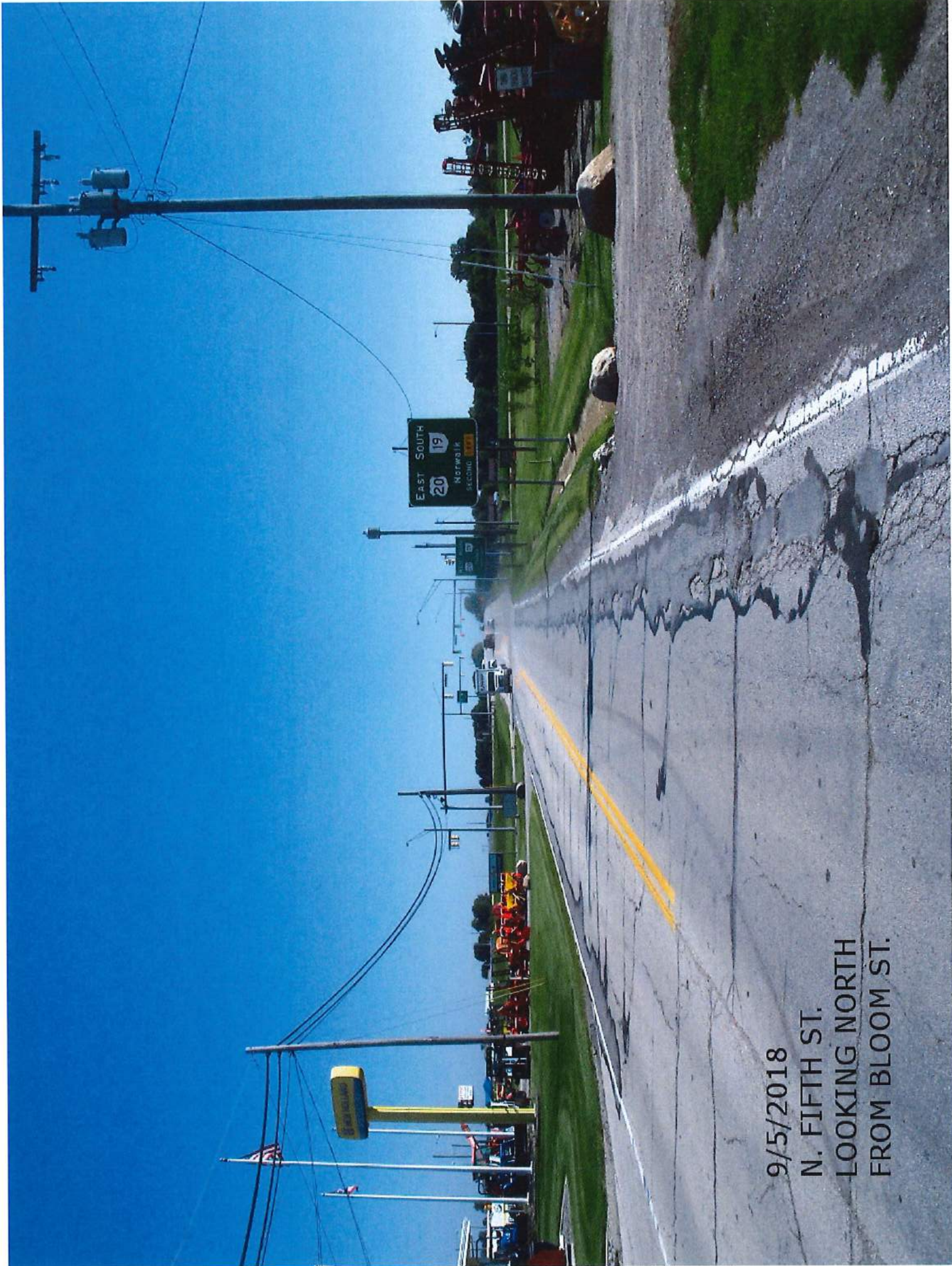

9/5/2018
N. FIFTH ST.
LOOKING NORTH
FROM BLOOM ST.

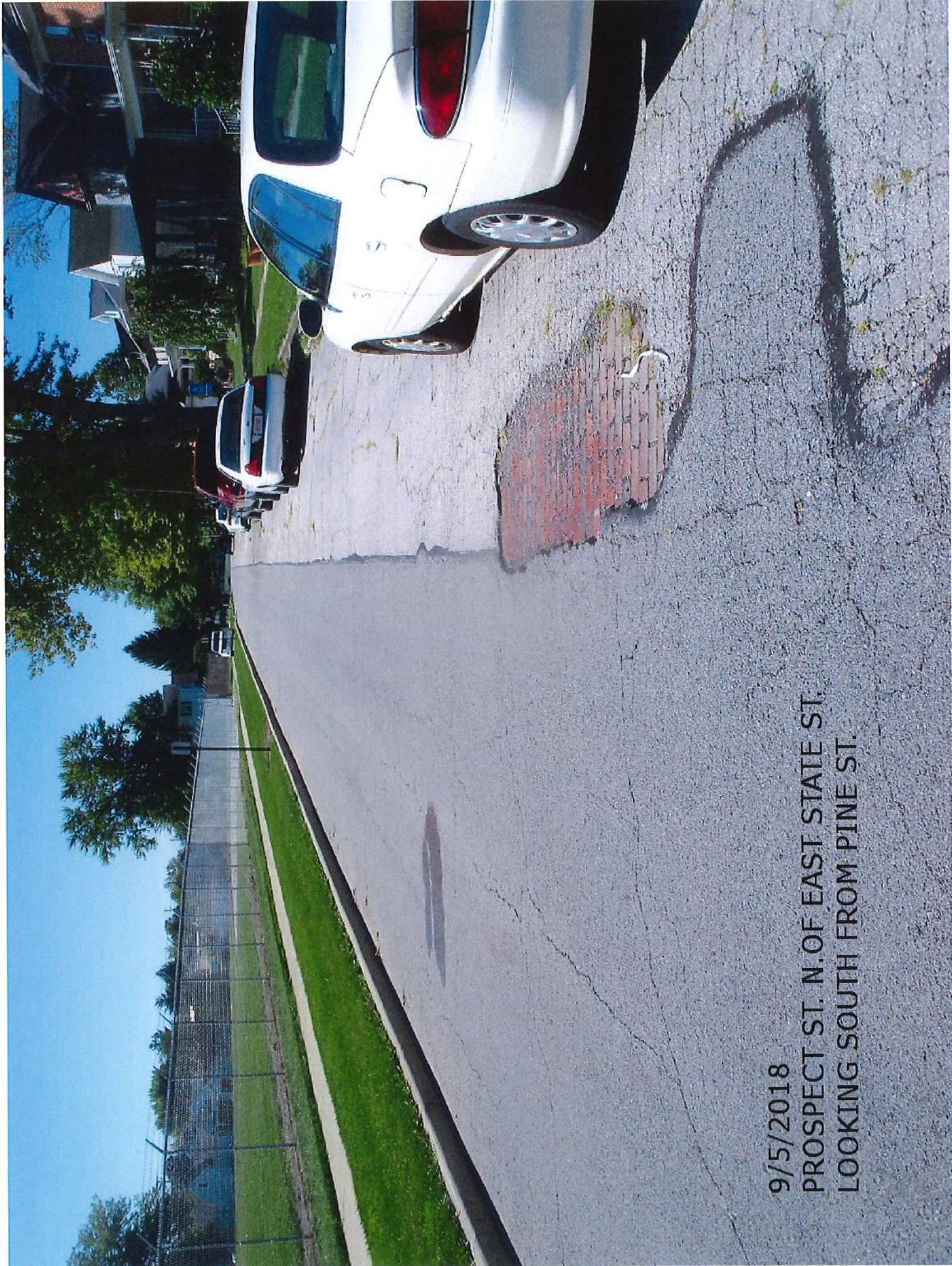

9/5/2018
PROSPECT ST. N.OF EAST STATE ST.
LOOKING SOUTH FROM PINE ST.

9/5/2018
PROSPECT ST. N. OF EAST STATE ST.
LOOKING SOUTH

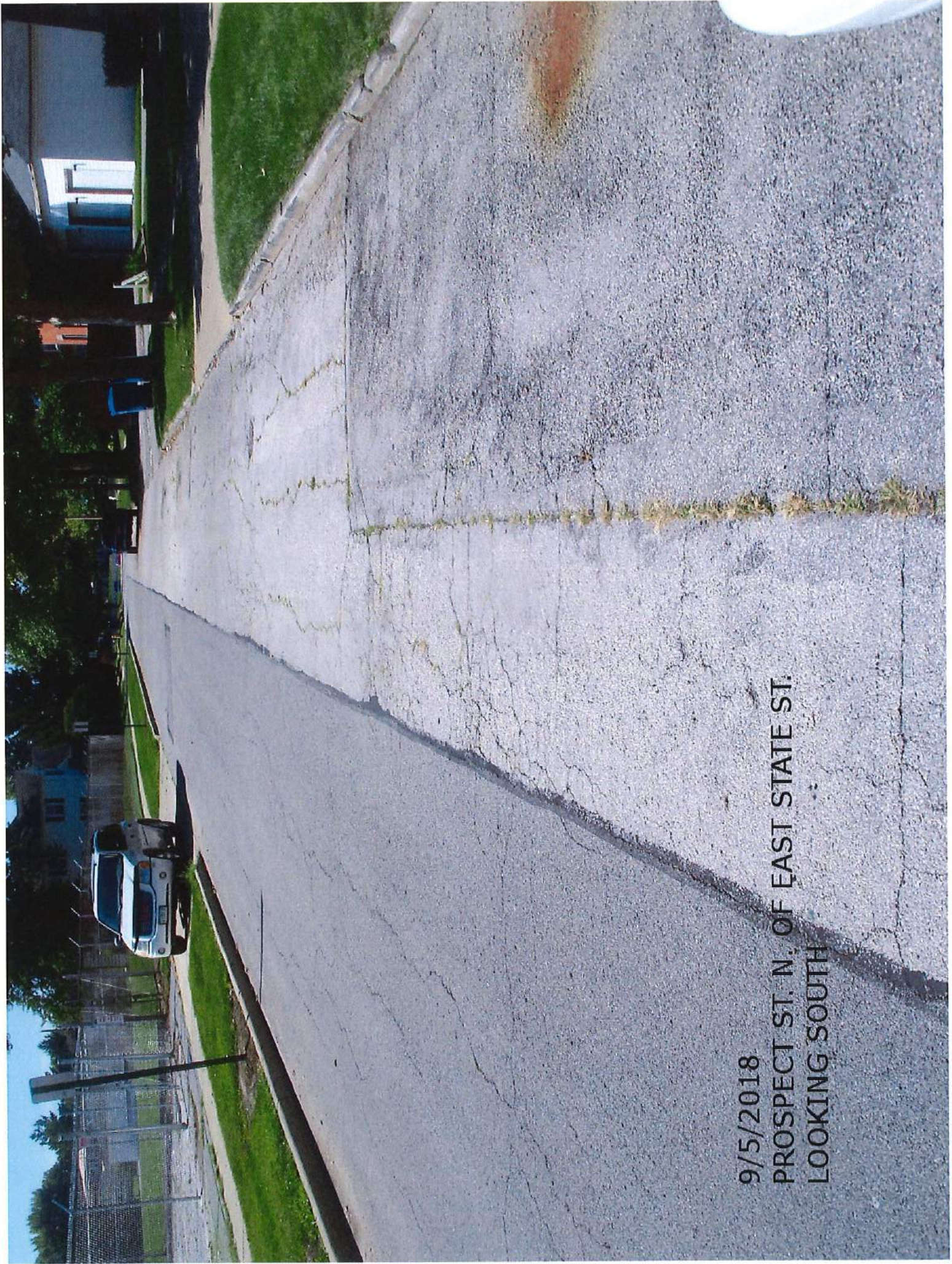

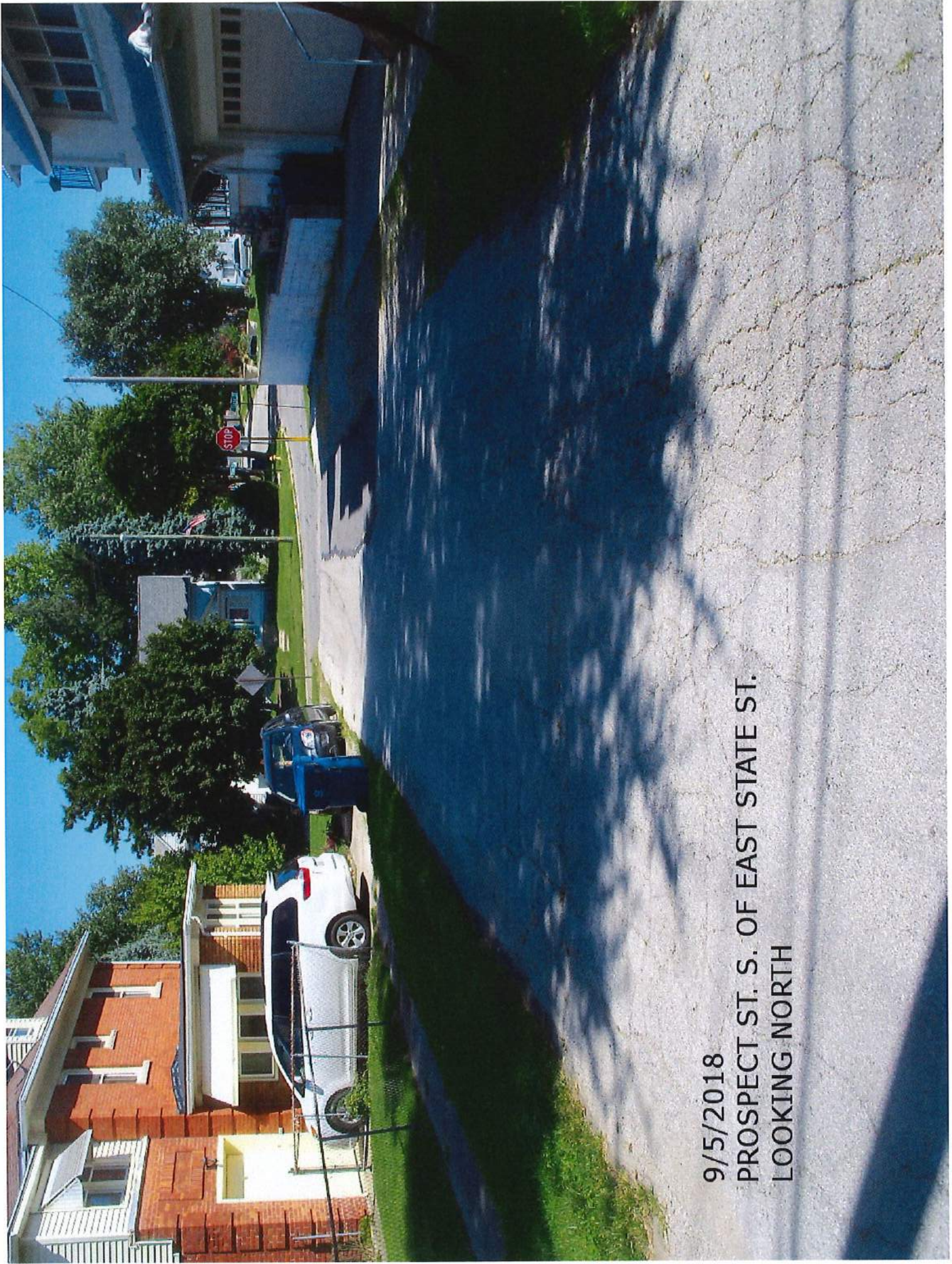

9/5/2018
PROSPECT ST. S. OF EAST STATE ST.
LOOKING NORTH

8/30/2017
Park Ave at intersection
with South St.



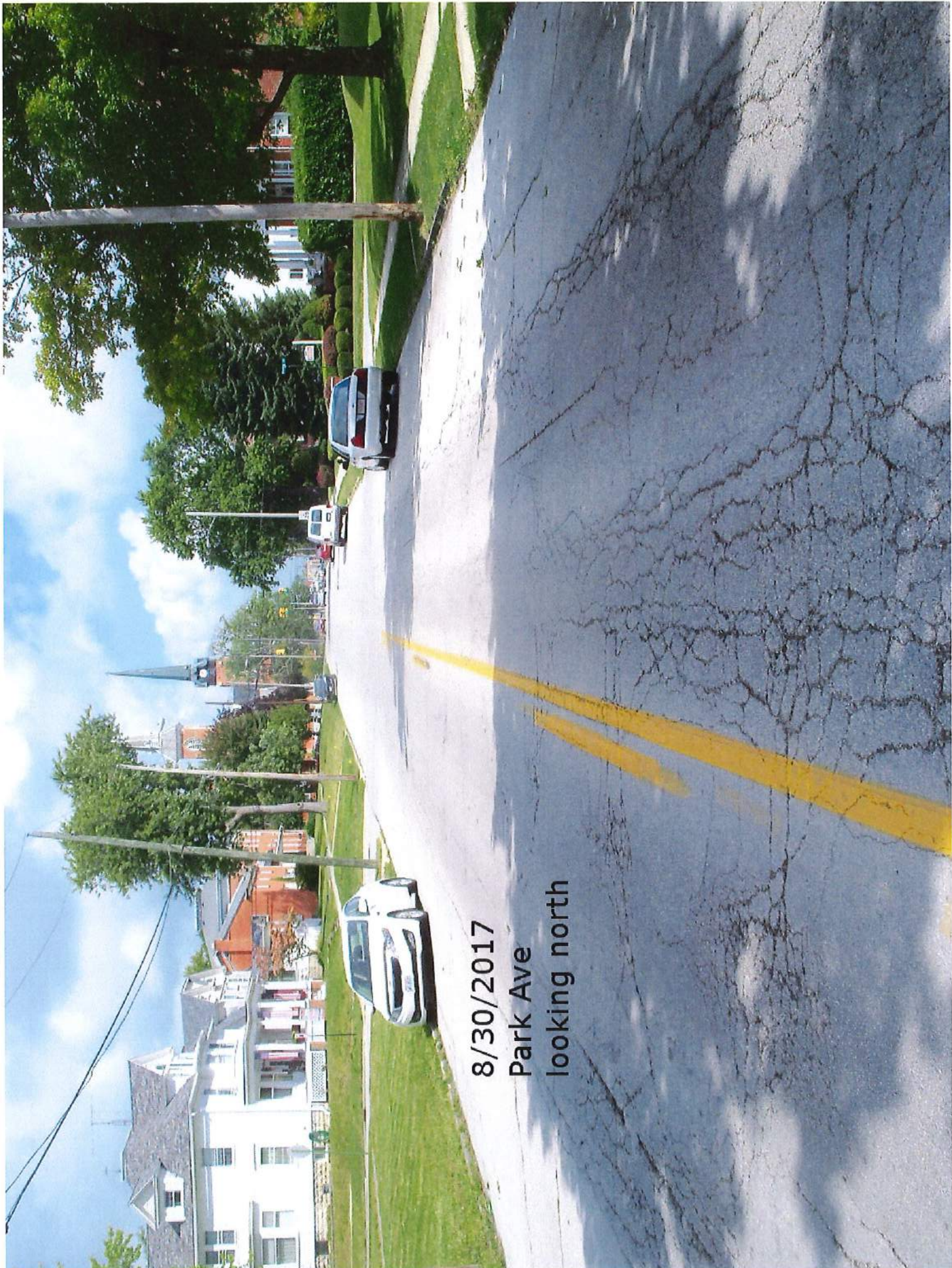

8/30/2017

Park Ave
looking north



8/30/2017
Park Ave just north
of intersection with
Croghan St.

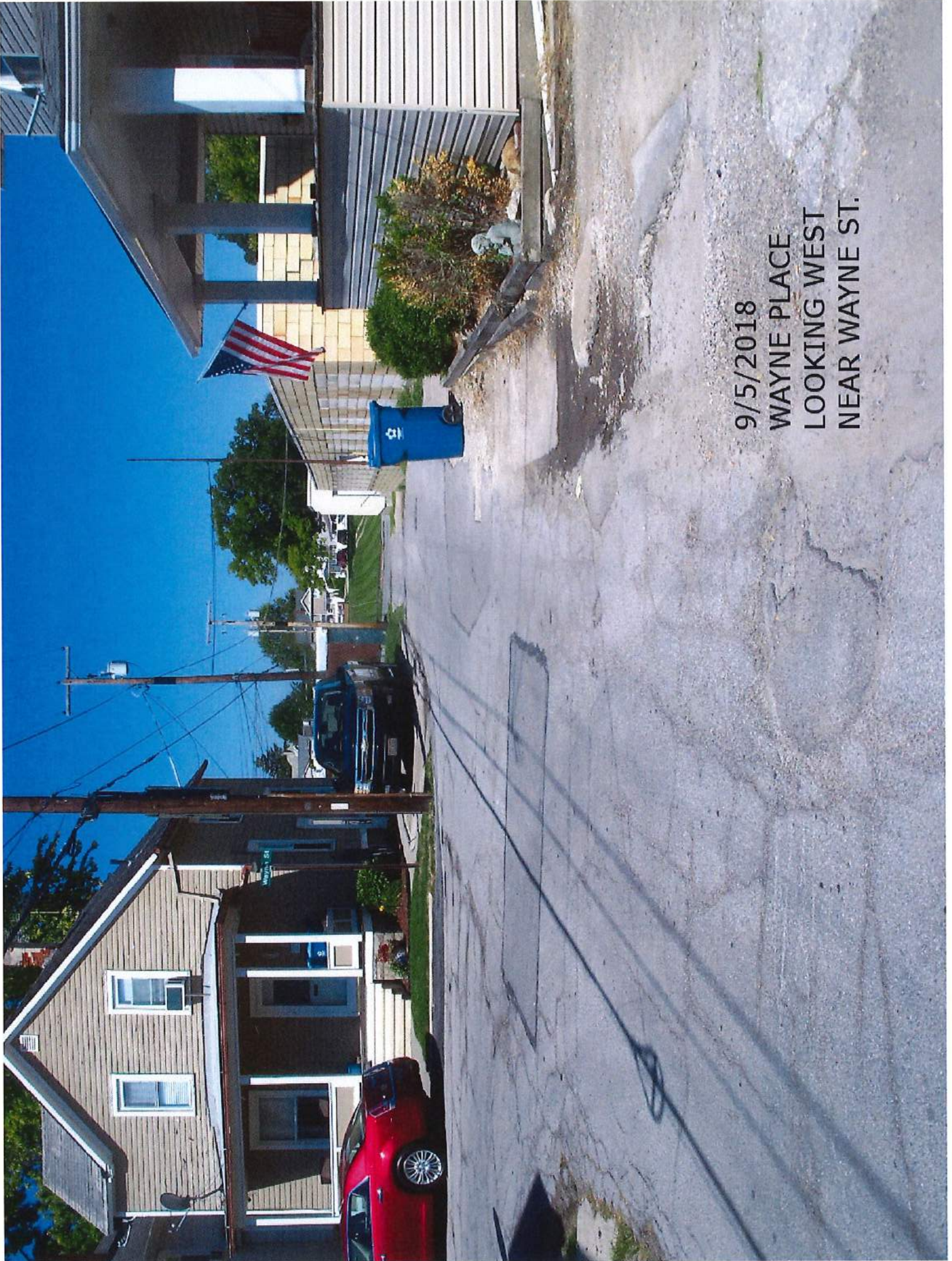

9/5/2018
WAYNE PLACE
LOOKING WEST
NEAR WAYNE ST.

Revised: April 17, 2018

**DISTRICT 5
CAPITAL IMPROVEMENT PROJECTS
QUESTIONNAIRE
ROUND 33**

Name of Applicant: City of Fremont

Project Title: 2019 Street Improvements

The following questions are to be answered for each application submitted for State Issue II SCIP, LTIP and Loan Projects. Please provide specific information using the best documentation available to you. Justification of your responses to these questions will be required if your project is selected for funding, so please provide correct and accurate responses. **Communities and Townships under 5,000 in population should also complete the Small Government Criteria.**

1. What percentage of the project in repair A= 50%, replacement B= 50%, expansion C= %, and new D= %? (Use dollar amounts of project to figure percentages and make sure the total equals one hundred(100) percent) A+B= % C+D= %

Repair/Replacement = Repair or Replacement of public facilities owned by the government (any subdivision of the state).

New/Expansion = Replacement of privately owned wells, septic systems, private water or wastewater systems, etc.

2. Give the physical condition rating:

Closed or Not Operating: The condition is unusable, dangerous and unsafe. The primary components have failed. The infrastructure is not functioning at all.

Critical: The condition is causing or contributing to a serious non-compliance situation and is threatening the intended design level of service. The infrastructure is functioning at seriously diminished capacity. Imminent failure is anticipated within 18 months. Repair and/or replacement is required to eliminate the critical condition and meet current design standards. **(For Road Projects structural repair items would represent a minimum of 25% of the total Project Cost).**

Poor: The condition is substandard and requires repair/replacement in order to return to the intended level of service and comply with current design standards. Infrastructure contains a major deficiency and is functioning at a diminished capacity.

Fair: The condition is average, not good or poor. The infrastructure is still functioning as originally intended. Minor deficiencies exist requiring repair to continue to function as originally intended and/or to meet current design standards.

- Good: The condition is safe and suitable to purpose. Infrastructure is functioning as originally intended, but requires minor repairs and/or upgrades to meet current design standards.
- Excellent: The condition is new, or requires no repair. Or, no supporting documentation has been submitted.

* **In order to receive points provide supporting documentation (e.g. photos, a narrative, maintenance history, or third party findings) to justifying the rating.**

3. If the proposed project is not approved what category would best represent the impact on the general health and/or public safety?

ROADS

- Extremely Critical: Resurfacing, Restoration, Rehabilitation and Reconstruction (4R) of a Major Access Road.*
- Critical: Resurfacing, Restoration and Rehabilitation (3R) of a Major Access Road.*
- Major: Resurfacing, Restoration, Rehabilitation and Reconstruction (4R) of a Minor Access Road.*
- Moderate: Resurfacing, Restoration and Rehabilitation (3R) of a Minor Access Road.*
- Minimal: Preventative Maintenance of a Major Access Road.
- No Impact: Preventative Maintenance of a Minor Access Road.

Projects that have a variety of work will be scored in the LOWEST category of work contained in the Construction Estimate.

Road/Street Classifications:

Major Access Road: Roads or streets that have a dual function of providing access to adjacent properties and providing through or connecting service between other roads.

Minor Access Road: Roads or streets that primarily provide access to adjacent properties without through continuity, such as cul-de-sacs or loop roads or streets.

Preventative Maintenance: Non Structural Pavement work such as chip sealing, cape sealing, microsurfacing, crack sealing, etc.

*(3R) Resurfacing, Restoration and Rehabilitation - Improvements to existing roadways, which have as their main purpose, the restoration of the physical features (pavement, curb, guardrail, etc.) without altering the original design elements.

*(4R) Resurfacing, Restoration, Rehabilitation and Reconstruction - Much like 3R, except that 4R allows for the complete reconstruction of the roadway and alteration of certain design elements (i.e., lane widths, shoulder

width, SSD, etc.).

BRIDGES SUFFICIENCY RATING

Extremely Critical: 0-25, or a General Appraisal rating of 3 or less.

Critical: 27-50, or a General Appraisal rating of 4.

Major: 51-65 or a General Appraisal rating of 5 or 6.

Moderate: 66-80 or a General Appraisal rating of 7.

Minimal: 81-100 or a General Appraisal rating of more than 7.

No Impact: Bridge on a new roadway.

WASTEWATER TREATMENT PLANTS

Extremely Critical: Environmental Protection Agency (EPA) orders in the form of a consent decree, findings and orders or court order. Health Department Construction Ban.

Critical: Improvements ordered by the Environmental Protection Agency (EPA) in the form of NPDES Orders.

Major: Replace deficient appurtenances. Update existing processes due to EPA recommendations.

Moderate: Increase capacity to meet current needs or update processes to improve effluent quality.

Minimal: New/Expansion project to meet a specific development proposal.

No Impact: New/Expansion to meet future or projected needs.

WATER TREATMENT PLANT

Extremely Critical: EPA orders in the form of a consent decree, findings and orders or court order.

Critical: Improvements to meet Environmental Protection Agency (EPA) Safe Drinking Water Regulations and/or NPDES Orders.

Major: Replace deficient appurtenances. Update existing processes due to EPA recommendations.

Moderate: Increase capacity to meet current needs or update processes to improve water quality.

Minimal: New/Expansion project to meet a specific development proposal.

No Impact: New/Expansion to meet future or projected needs.

COMBINED SEWER SEPARATIONS (May be construction of either new storm or sanitary sewer as long as the result is two separate sewer systems.)

- Extremely Critical: EPA orders in the form of a consent decree, findings and orders or court order. Health Department Construction Ban.
- Critical: Separate, due to chronic backup or flooding in basements.
- Major: Separate, due to documented water quality impairment, or due to EPA recommendations.
- Moderate: Separate, due to specific development proposal within or upstream of the combined system area.
- Minimal: Separate, to conform to current design standards.
- No Impact: No positive health effect.

STORM SEWERS

- Extremely Critical: EPA orders in the form of a consent decree, findings and orders or court order.
- Critical: Chronic flooding (structure damage).
- Major: Inadequate capacity (land damage).
- Moderate: Inadequate capacity with no associated damage.
- Minimal: New/Expansion to meet current needs.
- No Impact: New/Expansion to meet future or project needs.

CULVERTS

- Extremely Critical: Structurally deficient or functionally obsolete. Deterioration has already caused a safety Critical: hazard to the public.
- Critical: Inadequate capacity with land damage and the existing or high probability of property damage.
- Major: Inadequate capacity (land damage).
- Moderate: Inadequate capacity with no associated damage.
- Minimal: New/Expansion to meet current needs.
- No Impact: New/Expansion to meet future or projected needs.

SANITARY SEWERS

- Extremely Critical: EPA orders in the form of a consent decree, findings and orders or court order. Health Department Construction Ban.
- Critical: Replace, due to chronic pipe failure, chronic backup or flooding in basements. Improvements ordered by the Environmental Protection Agency (EPA) in the form of NPDES Orders.
- Major: Replace, due to inadequate capacity or infiltration, or due to EPA recommendations.
- Moderate: Rehabilitate to increase capacity to meet current needs or to reduce inflow and infiltration.
- Minimal: New/Expansion project to meet a specific development proposal.
- No Impact: New/Expansion to meet future or projected needs.

SANITARY LIFT STATIONS AND FORCE MAINS

- Extremely Critical: Structurally deficient. Deterioration has already caused a safety/health hazard to the public, or, EPA orders in the form of a consent decree, findings and orders or court order.
- Critical: Inadequate capacity with actual or a high probability of property damage. Improvements ordered by the Environmental Protection Agency (EPA) in the form of NPDES Orders.
- Major: EPA recommendations, or, reduces a probable health and/or safety problem.
- Moderate: Rehabilitate to increase capacity to meet current needs.
- Minimal: New/Expansion to meet a specific development proposal.
- No Impact: New/Expansion to meet future or projected needs.

WATER PUMP STATIONS

- Extremely Critical: Structurally deficient. Deterioration has already caused a safety hazard to the public, or, EPA orders in the form of a consent decree, findings and orders or court order.
- Critical: Inadequate capacity with the inability to maintain pressure required for fire flows.
- Major: Replace due to inadequate capacity or EPA recommendations.
- Moderate: Rehabilitate to increase capacity to meet current needs.

Minimal: New/Expansion to meet a specific development proposal.

No Impact: New/Expansion to meet future or projected needs.

WATER LINES/WATER TOWERS

Extremely Critical: Solve low water pressure or excessive incidents of main breaks in project area.

Critical: Replace, due to deficiency such as excessive corrosion, etc.

Major: Replace undersized water lines as upgrading process.

Moderate: Increase capacity to meet current needs.

Minimal: New/Expansion project to meet a specific development proposal.

No Impact: New/Expansion to meet future or projected needs.

OTHER

Extremely Critical: There is a present health and/or safety threat.

Critical: The project will provide immediate health and/or safety benefit.

Major: The project will reduce a probable health and/or safety problem.

Moderate: The project will delay a health and/or safety problem.

Minimal: A possible future health and/or safety problem mitigation.

No Impact: No health and/or safety effect.

NOTE: Combined projects that can be rated in more than one subset may be rated in the other category at the discretion of the District 5 Executive Committee. In general, the majority of the cost or scope of the project shall determine the category under which the project will be scored.

(Submittals without supporting documentation will receive 0 Points for this question.)

Extremely Critical ____, Critical X__, Major ____, Moderate ____, Minimal ____, No Impact ____. Explain your answer.

Major deterioration, alligator cracking and sub base failure has made these high volume roads a priority

(Additional narrative, charts and/or pictures should be attached to questionnaire)

4. Identify the amount of local funds that will be used on the project as a percentage of the total project cost.

A.) Amount of Local Funds = \$ 538,769.00

B.) Total Project Cost = \$ 813,769.00

RATIO OF LOCAL FUNDS DIVIDED by TOTAL PROJECT COSTS (A/B)= 66 %

Note: Local funds should be considered funds derived from the applicant budget or loans funds to be paid back through local budget, assessments, rates or tax revenues collected by the applicant.

5. Identify the amount of other funding sources to be used on the project, excluding State Issue II or LTIP Funds, as a percentage of the total project cost.

Grants ___% Gifts ___%, Contributions ___%

Other ___% (explain) _____, Total ___%

Note: Grant funds and other revenues not contributed or collected through taxes by the applicant should be considered other funds. The Scope of Work for each Funding Source must be the same.

6. Total Amount of SCIP and Loan Funding Requested- An Applicant can request a grant per the categories below for points as indicated on the Priority Rating Sheet. If the Applicant is including a loan request equal to, but not exceeding 50% of the OPWC funding amounts listed below, there will be no point penalty. If loan funds requested are more than 50%, points as listed in the Priority Rating Sheet will apply.

_____	\$500,001 or More
_____	\$400,001-\$500,000
_____	\$325,001-\$400,000
_____	\$275,001-\$325,000
<u> X </u>	\$175,001-\$275,000
_____	\$175,000 or Less

There are times when the District spends all of the grant money and has loan money remaining. When this happens, the district makes a loan offer in the amount of the requested grant to the communities that were not funded. The offers are made in the order of scoring. We need to know if you are not successful in obtaining grant dollars for your project if you would be interested in loan money:

YES _____ NO X

(This will only be considered if you are not funded with grant money and there is remaining loan money.) **Please note: if you answer "no" you will not be contacted, only if you answer "yes" will an offer be made in the event that there is loan money remaining.**

7. If the proposed project is funded, will its completion directly result in the creation of permanent full-time equivalent (FTE) jobs (FTE jobs shall be defined as 35 hours/week) ? Yes ___ No X . If yes, how many jobs within eighteen months? ___ Will the completed project retain jobs that would otherwise be

permanently lost? Yes ___ No X. If yes, how many jobs ___ **will be created/retrained** within 18 months **following the completion of the improvements?**

(Supporting documentation in the form of letter from affected industrial or commercial enterprises that specify full time equivalent jobs that will be retained or created directly by the installation or improvement of Public infrastructure. Additional items such as; 1) newspaper articles or other media news accounts, 2) public meeting minutes, and/or 3) a letter from the County Economic Development Director or State of Ohio Economic Development Professional that alludes to the requirement for the infrastructure improvement to support the business. Submittals without supporting documentation will receive 0 points for this question.)

8. What is the total number of existing users that will directly benefit from the proposed project if completed? 4177 (Use households served, traffic counts, etc. and explain the basis by which you arrived at your number.) This number is based on 2017 & 2018 traffic counts

9. Is subdivision's population less than 5,000 Yes ___ No X

If yes, continue. You may want to design your project per Small Government Project Evaluation Criteria, released for the current OPWC Round to assist in evaluating your project for potential Small Government Funding. The Small Government Criteria is available on the OPWC website at <http://www.pwc.state.oh.us/Meth.SG.PDF> If No, skip to Question 11.

10. **OHIO PUBLIC WORKS COMMISSION SMALL GOVERNMENT PROGRAM GUIDELINES**

All projects that are sponsored by a subdivision with a population of 5,000 or less, and not earning enough points for District Funding from SCIP or LTIP Funds, are then rated using the Small Government Program Rating Criteria for the corresponding funding round. In order to be rated the entity must submit the Small Government Supplement and their required budgets with their application. **Only infrastructure that is village- or township- owned is eligible for assistance.** The following policies have been adopted by the Small Government Commission:

- District Integrating Committees may submit up to seven (7) applications for consideration by the Commission. All 7 must be ranked, however, only the top five (5) will be scored. The remaining two (2) will be held as contingency projects should an application be withdrawn.
- Grants are limited to \$500,000. Any assistance above that amount must be in the form of a loan.
 - Grants for new or expanded infrastructure cannot exceed 50% of the project estimate.
- The Commission may deny funding for water and sewer systems that are deemed to be more

cost-effective if regionalized.

• If a water or sewer project is determined to be affordable, the project will be offered a loan rather than a grant. Pay special attention to the **Water & Wastewater Affordability Supplemental and the Small Government Water & Wastewater Affordability Calculation Worksheet. Both are available on the Small Government Program Tab at <http://www.pwc.state.oh.us/SmallGovernment.html>**

• Should there be more projects that meet the “annual score” than there is funding, the tie breaker is those projects which scored highest under Health & Safety, with the second tie breaker being Condition. If multiple projects have equivalent Health & Safety and Condition scores they are arranged according to the amount of assistance from low to high. Once the funded projects are announced, “contingency projects” may be funded from project under-runs by continuing down the approved project list.

• Supplemental assistance is not provided to projects previously funded by the Commission.

• Applicants have 30 days from receipt of application by OPWC without exception to provide additional documentation to make the application more competitive under the Small Government criteria. Applications will be scored after the 30-day period has expired. The applicants for each District's two (2) contingency projects will have the same 30-day period to submit supplemental information but these applications will not be scored unless necessary to do so. **It is each applicant's responsibility for determining the need for supplemental material. The applicant will not be asked for or notified of missing information unless the Commission has changed the project type and it affects the documentation required. Important information may include, but is not limited to: age of infrastructure, traffic counts or utility users, median income information, user rates ordinances, and the Auditor's Certificate of Estimated Revenues or documentation from the Auditor of State that subdivision is in a state of fiscal emergency.**

If you desire to have your Round 33 project considered for Small Government Funding please download the Small Government Evaluation Criteria applicable to Round 33 by accessing the OPWC Website at <http://www.pwc.state.oh.us/Meth.SG.PDF>. Please complete the Small Government Evaluation Criteria and attach all required supporting documentation and attach it to the District 5 Questionnaire for Round 32.

11. MANDATORY INFORMATION, DISTRICT 5, DISCRETIONARY RANKING POINTS

List all specific user fees: Amount or

ROAD & BRIDGE PROJECTS:(OHIO REVISED CODE) Percentage

Permissive license fee	4504.02 or 4504.06	<u>5.00</u>
	4504.15 or 4504.17	<u> </u>
	4504.16 or 4504.171	<u> </u>
	4504.172	<u> </u>
	4504.18	<u> </u>
Special property taxes	5555.48	<u> </u>
	5555.49	<u> </u>

Municipal Income Tax 1.5%

County Sales Tax 7.25%

Others _____

(DO NOT INCLUDE SCHOOL TAXES)

SPECIFIC PROJECT AREA INFORMATION.

Median household income \$36,903.00

Monthly utility rate: Water \$43.56

Sewer _____

Other _____

List any special user fees or assessment (be specific)

POLITICAL SUBDIVISION= 143-28826

COUNTY= Sandusky

DISCRETIONARY POINTS (BY DISTRICT COMMITTEE ONLY)= _____

(25-20-15)

Date: 9/7/18

Signature: *Tusha Fredrick*

Title: City Engineer

Address: 323 S. Front St. Fremont, Ohio 43420

Phone: 419-334-8963

FAX: 419-552-5029

Email: tfredericksen@fremontohio.org

District 5

Capital Improvement Project

Priority Rating Sheet, Round 33

Revised 04/17/18

COUNTY: Sandusky		PROJECT NUMBER														
PROJECT: 2018 Street Improvements																
EST. COST: \$813,769.00																
No.	WEIGHT FACTOR	CRITERIA TO BE CONSIDERED	PRIORITY FACTORS					A x B	Priority Factors						No.	
			1	2	3	4	5		1	2	3	4	5	6		
1	1	(Repair or Replace) vs. (New or Expand)	0	2	4	6	8	10	10	0%+ Repair or Reinforcement	20%+ Repair or Replacement	40%+ Repair or Replacement	60%+ Repair or Replacement	80%+ Repair or Replacement	100%+ Repair or Replacement	1
2	1.5	Existing Physical Condition: Must submit substantiating documentation and CIR (100% New or Expansion = 0 Points)	0	2	4	6	8	10	9	Excellent	Good	Fair	Poor X	Critical	Closed or Not Operating	2
3	2	Public Health and/or Public Safety Concerns Submittals without supporting documentation will receive 0 points for this criterion	0	2	4	6	8	10	16	No Impact	Minimal	Moderate	Major	Critical X	Extremely Critical	3
4	2	Percentage of Local Share (Local funds are funds derived from the applicant budget or a loan to be paid back through the applicant budget, not through State or local revenues)	0	2	4	6	8	10	20	0%+	10%+	20%+	30%+	40%+	50%+	4
5	1	OTHER FUNDING SOURCES (Excluding Issues F Funds) (Grants and other revenues not contributed or collected through taxes by the applicant, including Gifts, Contributions, etc. - must submit copy of award or status when.)	0	2	4	6	8	10	0	0%+ X	10%+	20%+	30%+	40%+	50%+	5
No.		WEIGHT FACTOR	PRIORITY FACTORS					A x B	Priority Factors						No.	
6	2	GPWC Grant and Loan Funding Requested. Please refer to Item 6 on Questionnaire for Clarification.	-9	-8	0	8	9	10	18	Grant or Loan Only \$500,001 or more	\$400,001 to \$500,000	\$325,001 to \$400,000	\$275,001 to \$325,000	\$175,001 to \$275,000 X	\$175,000 or less	6
2			-9	-8	0	8	9	10		Grant/Loan Combination \$750,000 or more	\$600,001 to \$750,000	\$487,501 to \$600,000	\$412,501 to \$487,500	\$262,501 to \$412,500	\$262,500 or less	6
When scoring a project that is only grant or only loan, please use the chart labeled "Grant or Loan Only". When scoring a grant/loan combination, score the project for the grant in the first chart, then use the second chart labeled "Grant/Loan Combination" to score the total (grant and loan combined). Use the lower of the two as the score.																
No.	WEIGHT FACTOR	CRITERIA TO BE CONSIDERED	PRIORITY FACTORS					A x B	Priority Factors						No.	
			1	2	3	4	5		1	2	3	4	5	6		
7	1	Will the Proposed Project Create Permanent jobs or retain jobs that would otherwise be permanently lost (Written Documentation Required)	0	2	4	6	8	10	0	0+ jobs X	7+ jobs	15+ jobs	25+ jobs	50+ jobs	100+ jobs	6
8	1	Benefits to Existing Users such as Households, (Equipment, dwelling units), Traffic Counts, etc.	0	2	4	6	8	10	10	0+	100+	350+	500+	750+	1000+ X	9
9		SUBTOTAL RANKING POINTS (MAX = 119)						83	Other Info: Does this project have a significant impact on productive farmland? YES NO Attach impact statement if yes. Is the Applicant ready to proceed to bids after State Approval within 6 months? YES NO							
10		COUNTY PRIORITY POINTS (25-20)														
11		DISCRETIONARY POINTS (BY DISTRICT ONLY) (MAX = 12)														
12		GRAND TOTAL RANKING POINTS														

* Applicants must certify local share contribution. Specify all funding sources to be utilized as local share at the time of application submittal.